

# OFF-WHITE UPHOLSTERED FULL PLATFORM BED

## ASSEMBLY INSTRUCTIONS



### BOX#1

A. HEADBOARD

1 PC

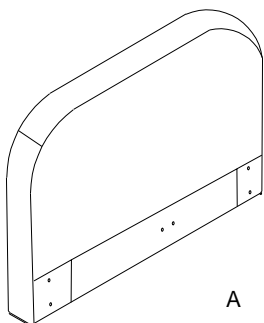

A

### BOX#2

B. FOOTBOARD

1 PC

E. SLAT ROLL

1 SET

H. CENTER SLAT SUPPORT CLEAT

2 PCS

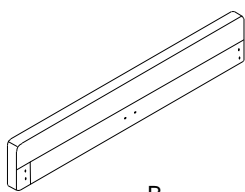

B

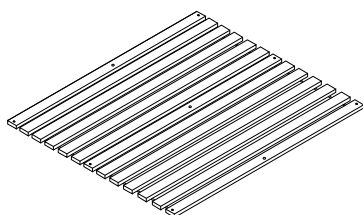

E



H

### BOX#3

C. LEFT SIDE RAIL

1 PC

D. RIGHT SIDE RAIL

1 PC

F. CENTER SLAT SUPPORT

1 PC

G. SUPPORT LEG

4 PCS

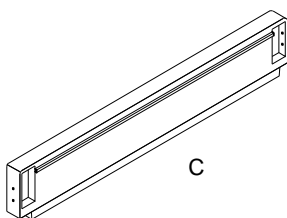

C

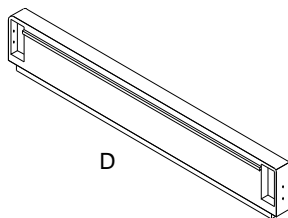

D

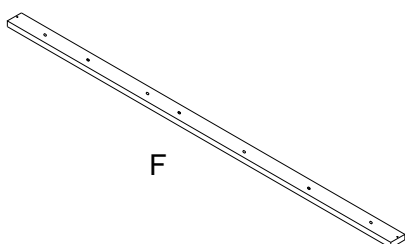

F



G

### HARDWARE KIT PACKED IN BOX #2

No.	Description	Image	Quantity
1	THREADED BOLT (8 x 90mm)		8 PCS
2	ALLEN BOLT (6 x 50mm)		4 PCS
3	ALLEN BOLT (6 x 30mm)		3 PCS
4	FLAT WASHER (8 x 22mm)		8 PCS
5	FLAT WASHER (6 x 16mm)		7 PCS
6	LOCK WASHER (8 x 22mm)		8 PCS
7	LOCK WASHER (6 x 16mm)		7 PCS
8	HEX NUT (8mm)		8 PCS
9	PHILLIPS SCREW (7 x 35mm)		8 PCS
10	ALLEN KEY (6mm)		1 PC
11	WRENCH		1 PC
12	CONNECTING BRACKET		4 PCS

### FULLY ASSEMBLED

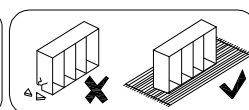
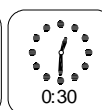
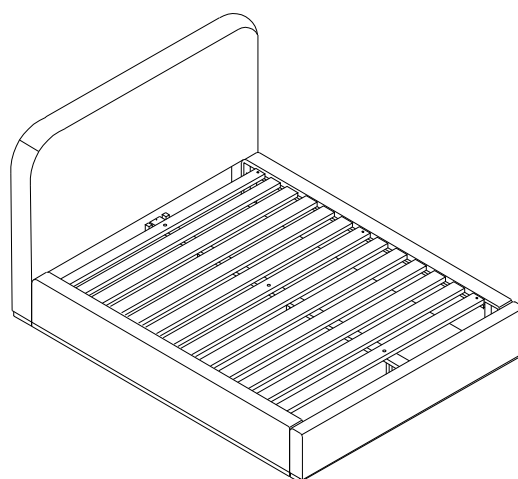

# OFF-WHITE UPHOLSTERED FULL PLATFORM BED

## ASSEMBLY INSTRUCTIONS



### STEP 1:

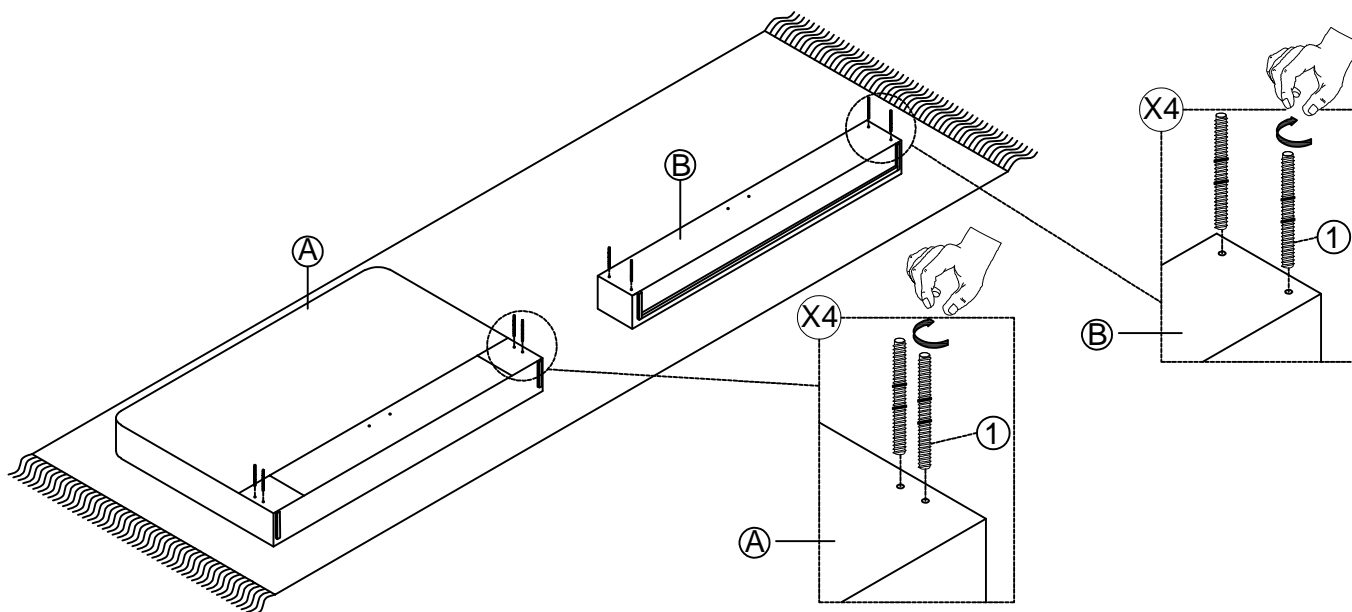

### STEP 2:

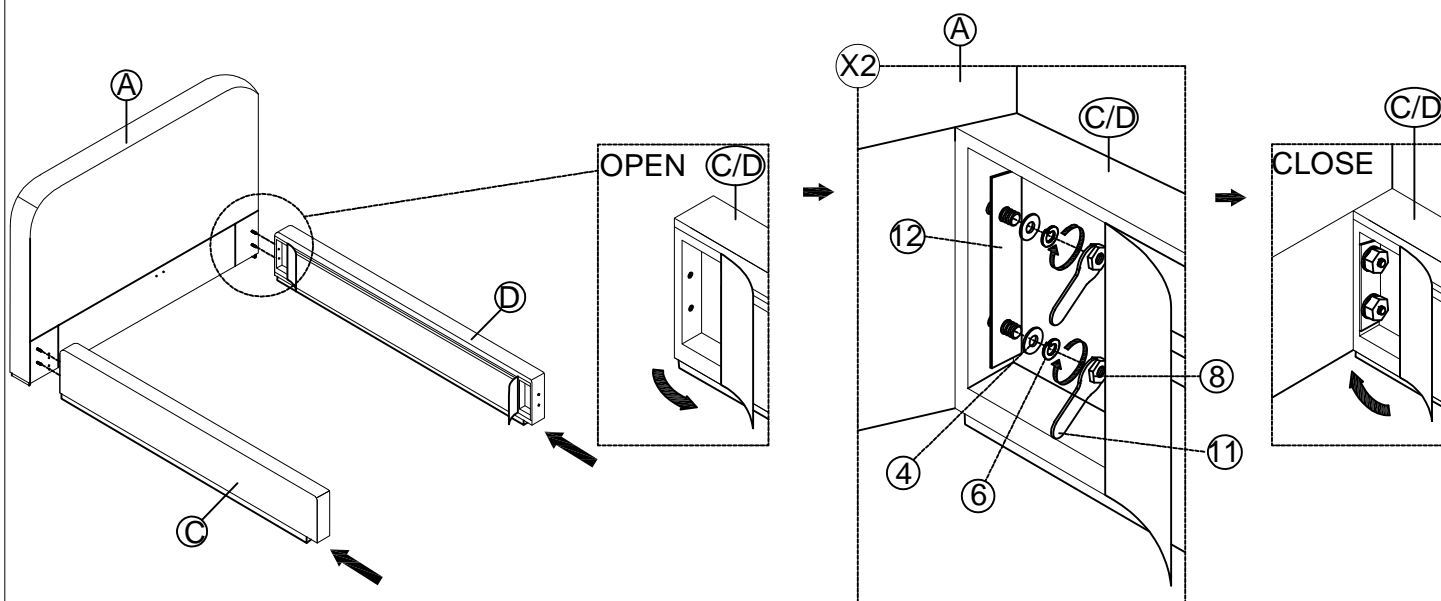

# OFF-WHITE UPHOLSTERED FULL PLATFORM BED

## ASSEMBLY INSTRUCTIONS



### STEP 3:

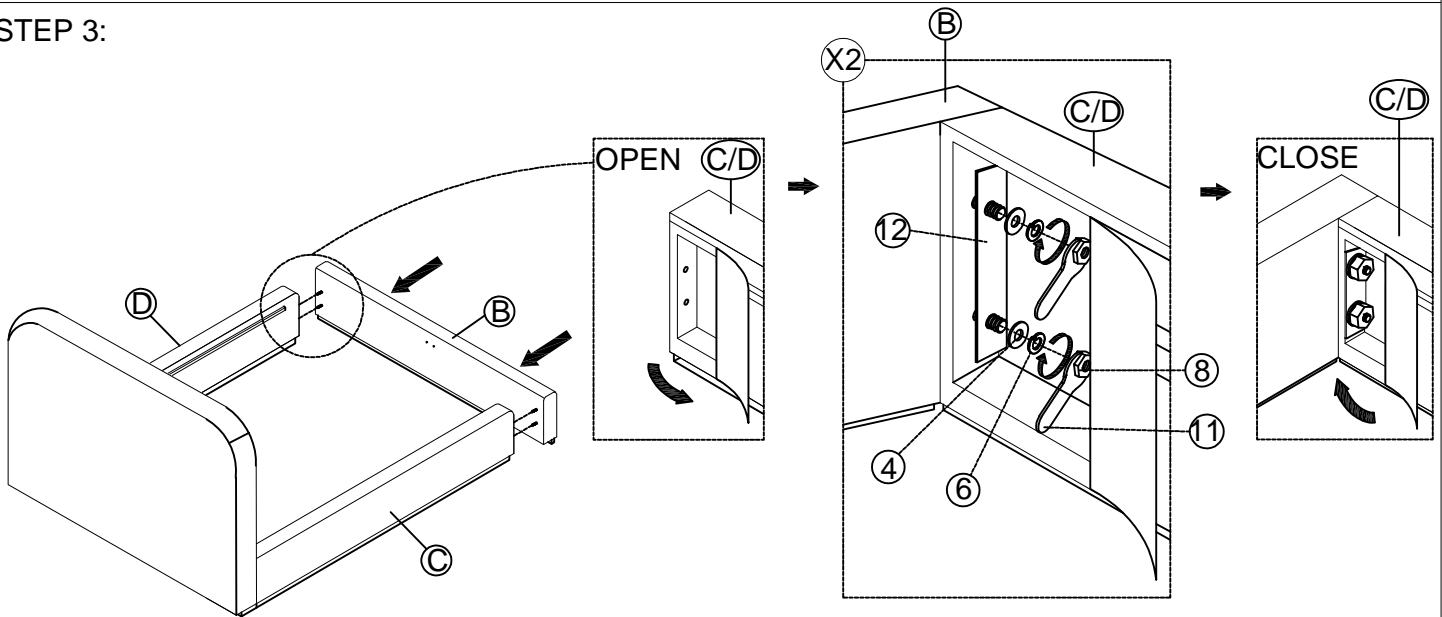

### STOP

- IF USING BED WITH AN ADJUSTABLE MATTRESS BASE, SKIP STEPS 4~8 AND REFERENCE APPENDIX A: ADJUSTABLE MATTRESS BASE ASSEMBLY SUPPLEMENT.
- IF USING BED FRAME WITH STANDARD BOX SPRING OR FOUNDATION, CONTINUE TO STEP 4.

### STEP 4:

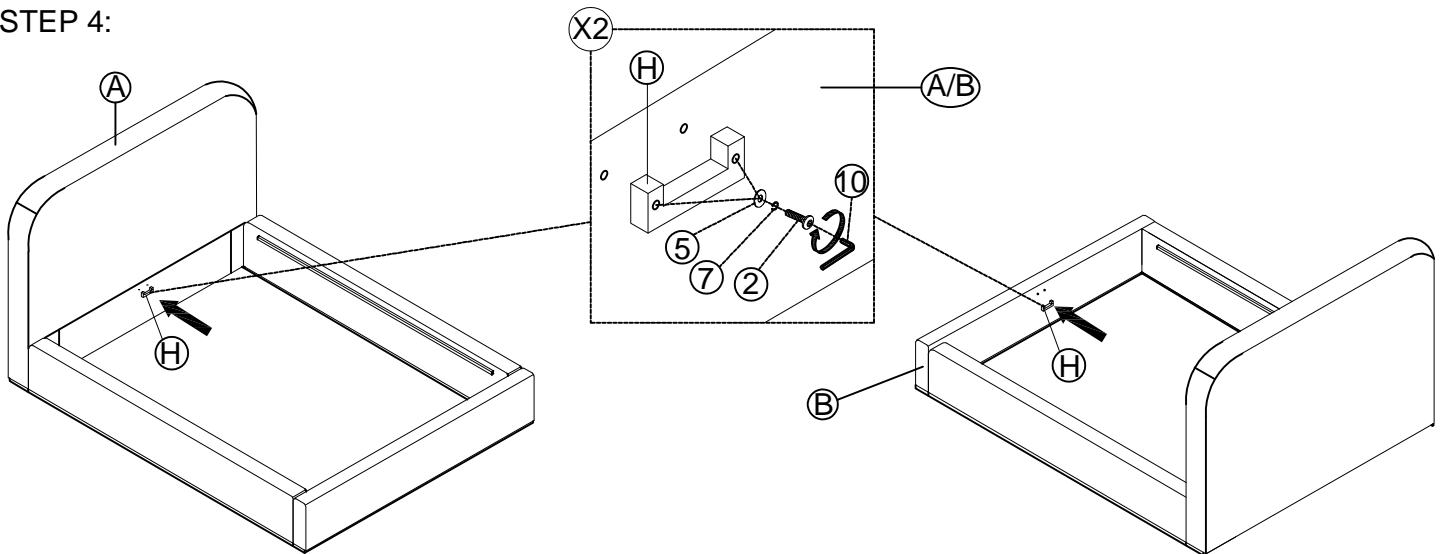

### STEP 5:

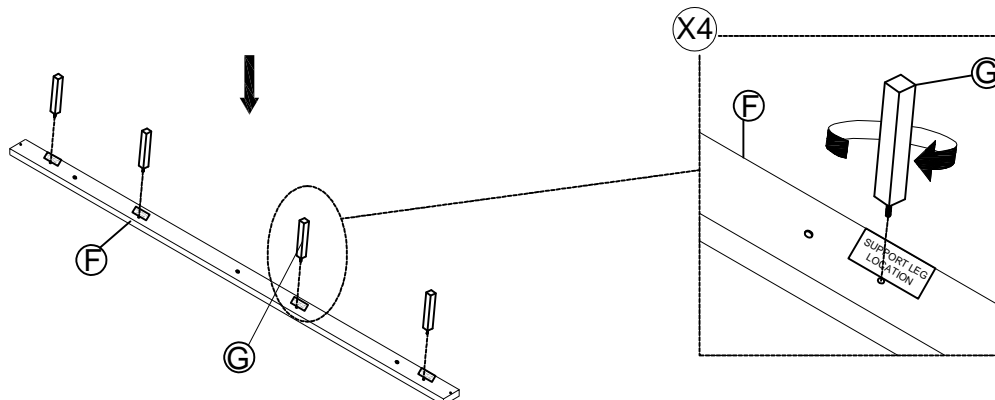

# OFF-WHITE UPHOLSTERED FULL PLATFORM BED

## ASSEMBLY INSTRUCTIONS



### STEP 6:

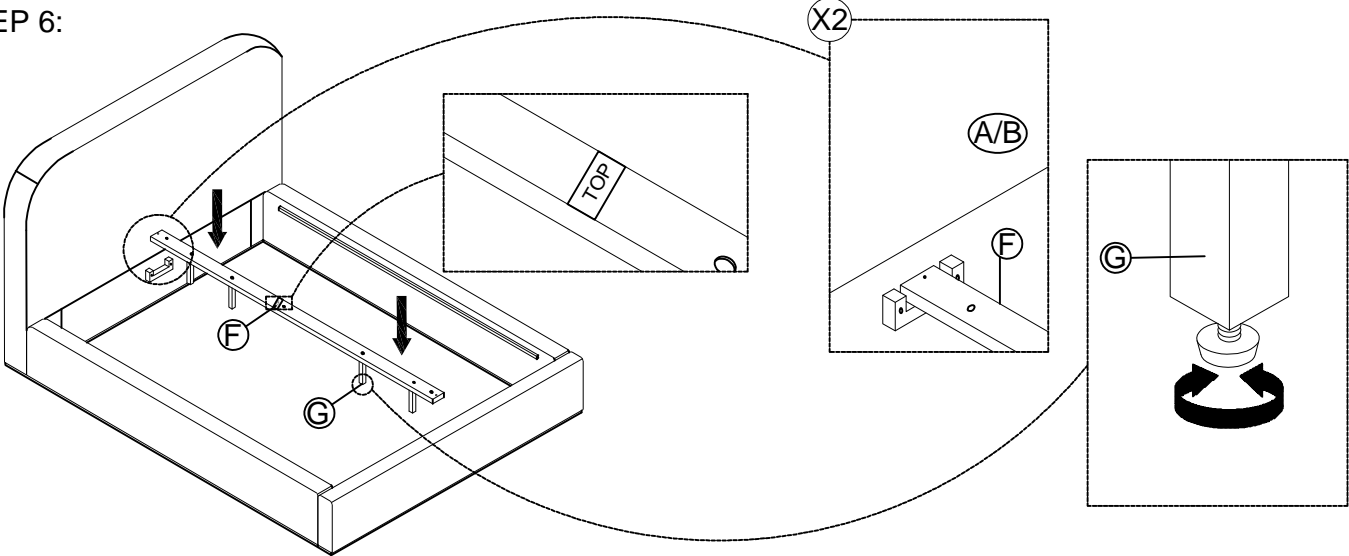

### STEP 7:

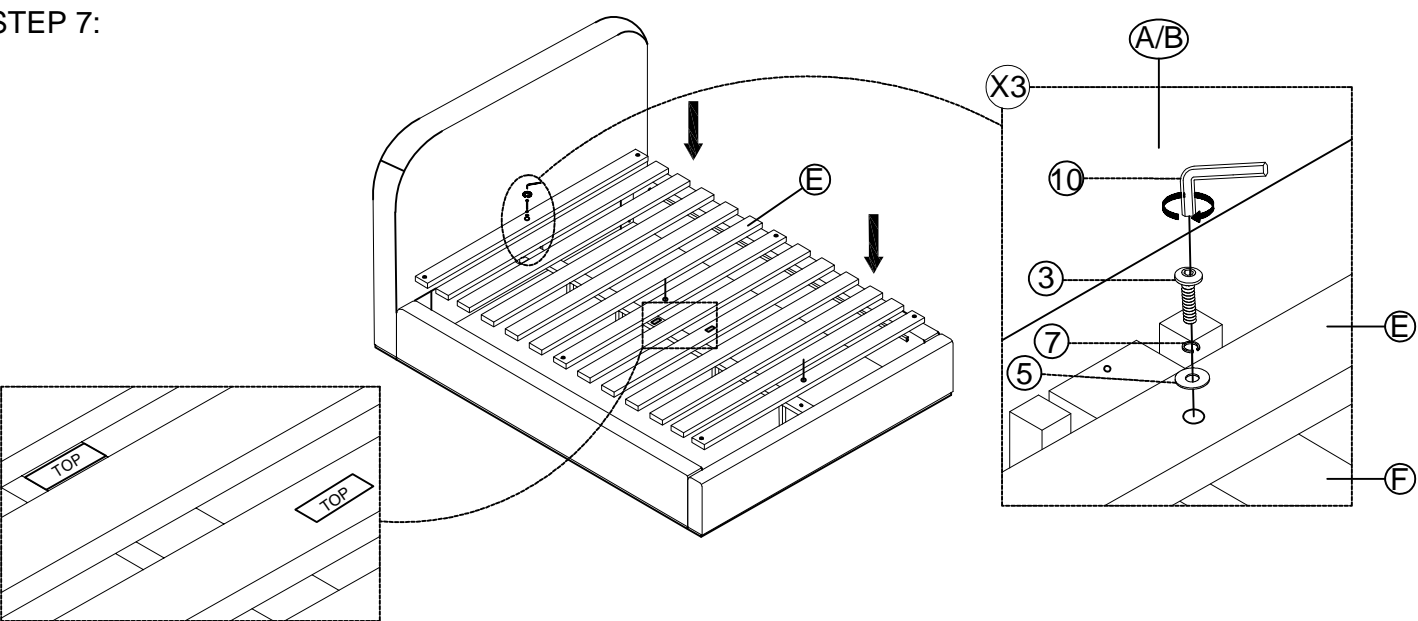

### STEP 8:

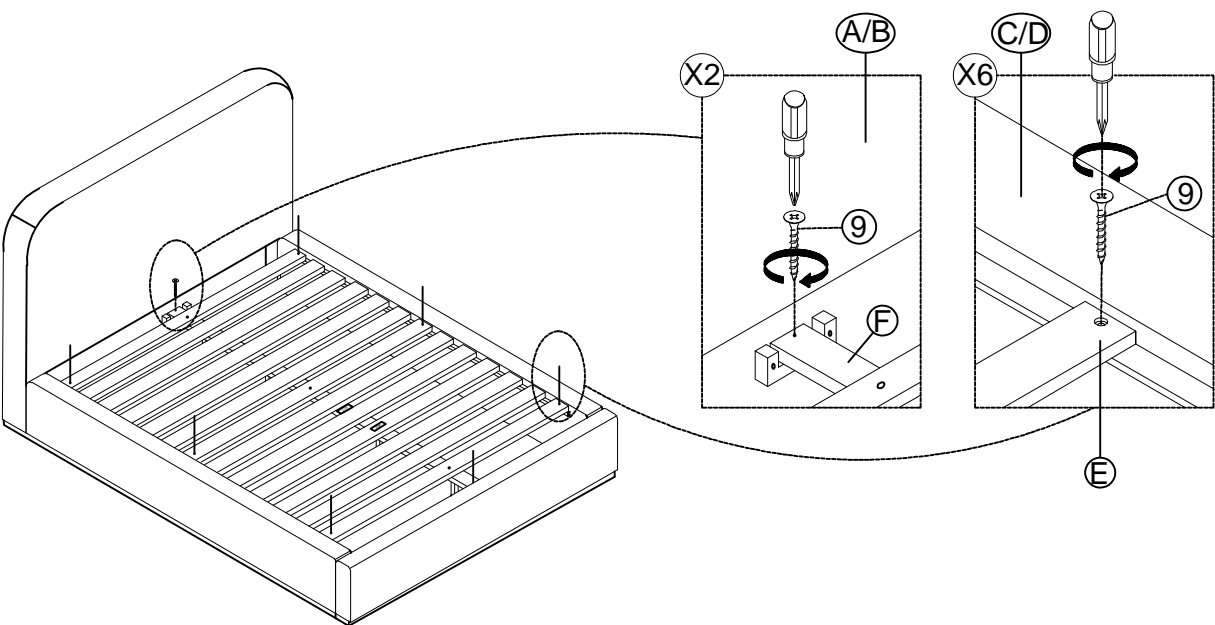

# OFF-WHITE UPHOLSTERED FULL PLATFORM BED

## ASSEMBLY INSTRUCTIONS

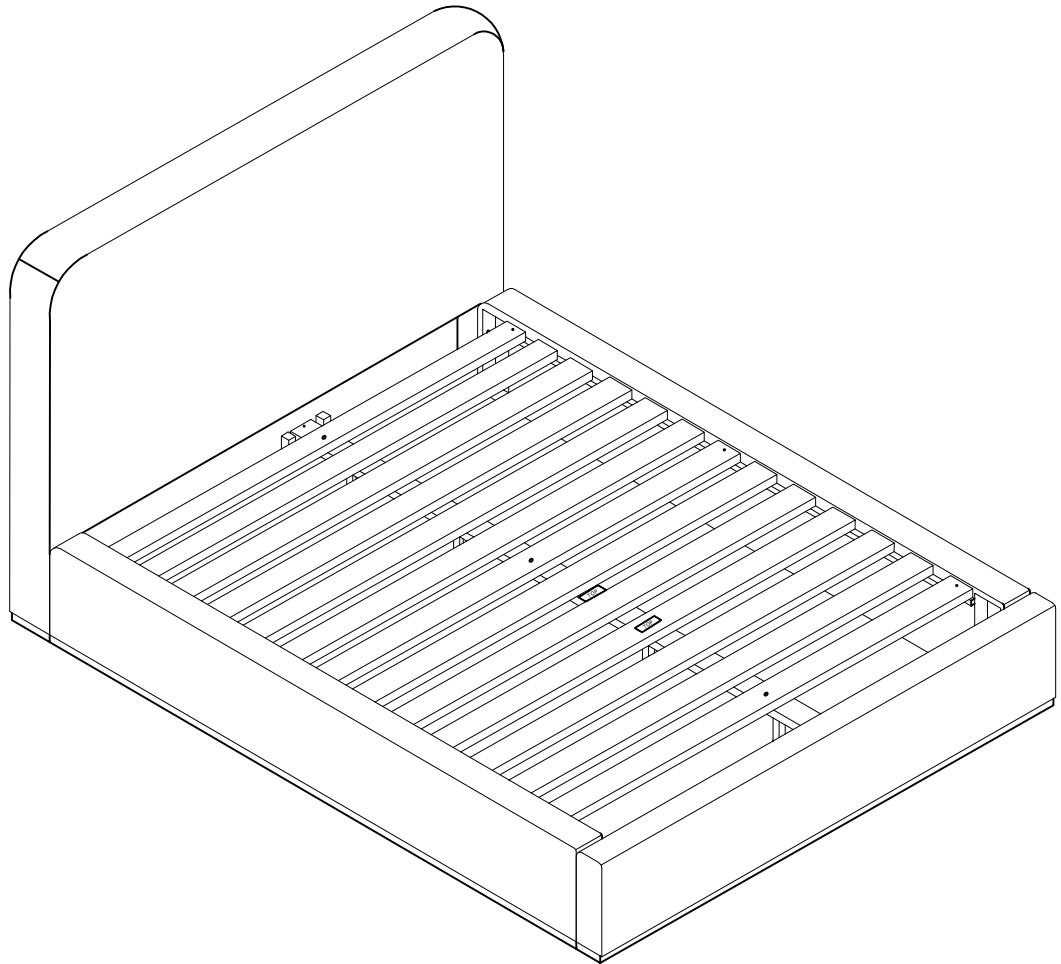

ASSEMBLY COMPLETE

### INSTRUCTIONS FOR ADJUSTING LEVELERS:

Position the bed in your space and locate the leveler under each support leg.

Turn the leveler counter-clockwise to extend the leveler and clockwise to retract it.

Adjust each leveler until each support leg is applying equal, upward pressure on the support slat.

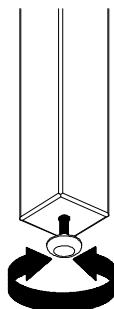

### MAINTENANCE INSTRUCTIONS:

- Periodically check all fittings and tighten if necessary, as they can loosen over time.
- Always remove box spring and mattress before moving the bed.
- Lift the bed when moving it. Dragging the bed can damage the center support.
- Readjust levelers after moving the bed.

# OFF-WHITE UPHOLSTERED FULL PLATFORM BED

## ASSEMBLY INSTRUCTIONS



### APPENDIX A: ADJUSTABLE MATTRESS BASE ASSEMBLY SUPPLEMENT

AN ADJUSTABLE MATTRESS BASE IS A FREESTANDING MATTRESS SUPPORT THAT SITS WITHIN THE PERIMETER OF THE BED FRAME.

IF USING THIS BED FRAME WITH A STANDARD BOX SPRING OR FOUNDATION THESE INSTRUCTIONS DO NOT APPLY.

PRE-ASSEMBLED SIDE RAIL CLEATS OBSTRUCT ADJUSTABLE BASE INSTALLATION AND OPERATION. FOLLOW THESE INSTRUCTIONS TO REMOVE THEM.

#### THE FOLLOWING PARTS ARE NOT REQUIRED FOR ADJUSTABLE MATTRESS BASE INSTALLATION:

E. SLAT ROLL	1 SET
F. CENTER SLAT SUPPORT	1 PC
G. SUPPORT LEG	4 PCS
H. CENTER SLAT SUPPORT CLEAT	2 PCS

#### STEP 1:

USE ALLEN KEY (10) TO UNSCREW ALLEN BOLTS AND REMOVE PRE-ASSEMBLED SIDE RAIL CLEATS.

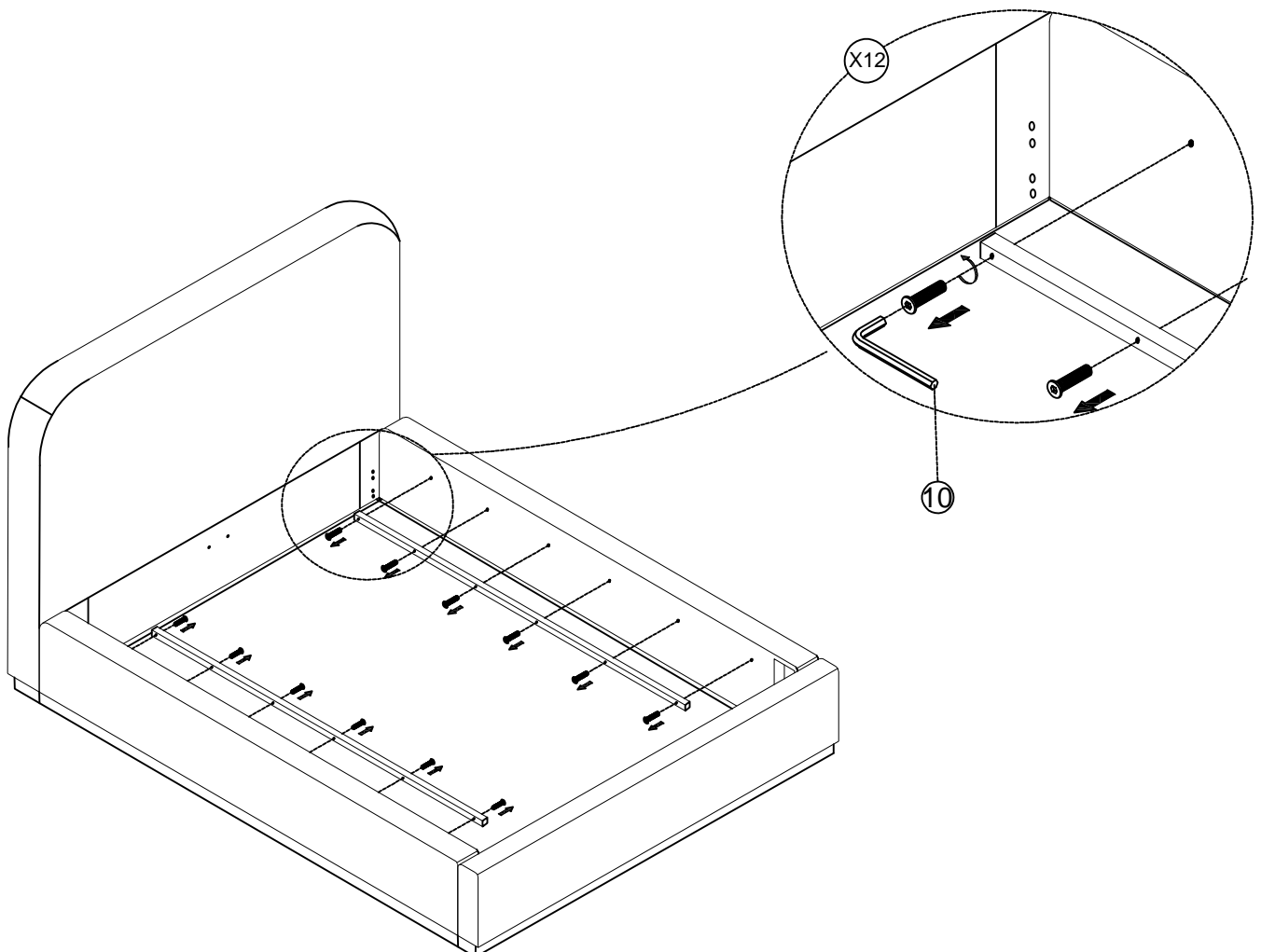

NOTE: YOU MAY WISH TO RETAIN UNUSED PARTS IF IN THE FUTURE YOU INTEND TO USE THE BED FRAME WITH A STANDARD BOX SPRING OR FOUNDATION