

B E R N H A R D T

ASSEMBLY INSTRUCTIONS FOR 305-265-266-776 ROUND DINING TABLE

Thank you for purchasing Bernhardt Furniture. Be sure to check all packing materials carefully to ensure proper assembly.

Please read all instructions carefully before starting the assembly process. Some parts are large and heavy and require at least two people to assemble, in order to prevent possible injury and/or damage to the furniture.

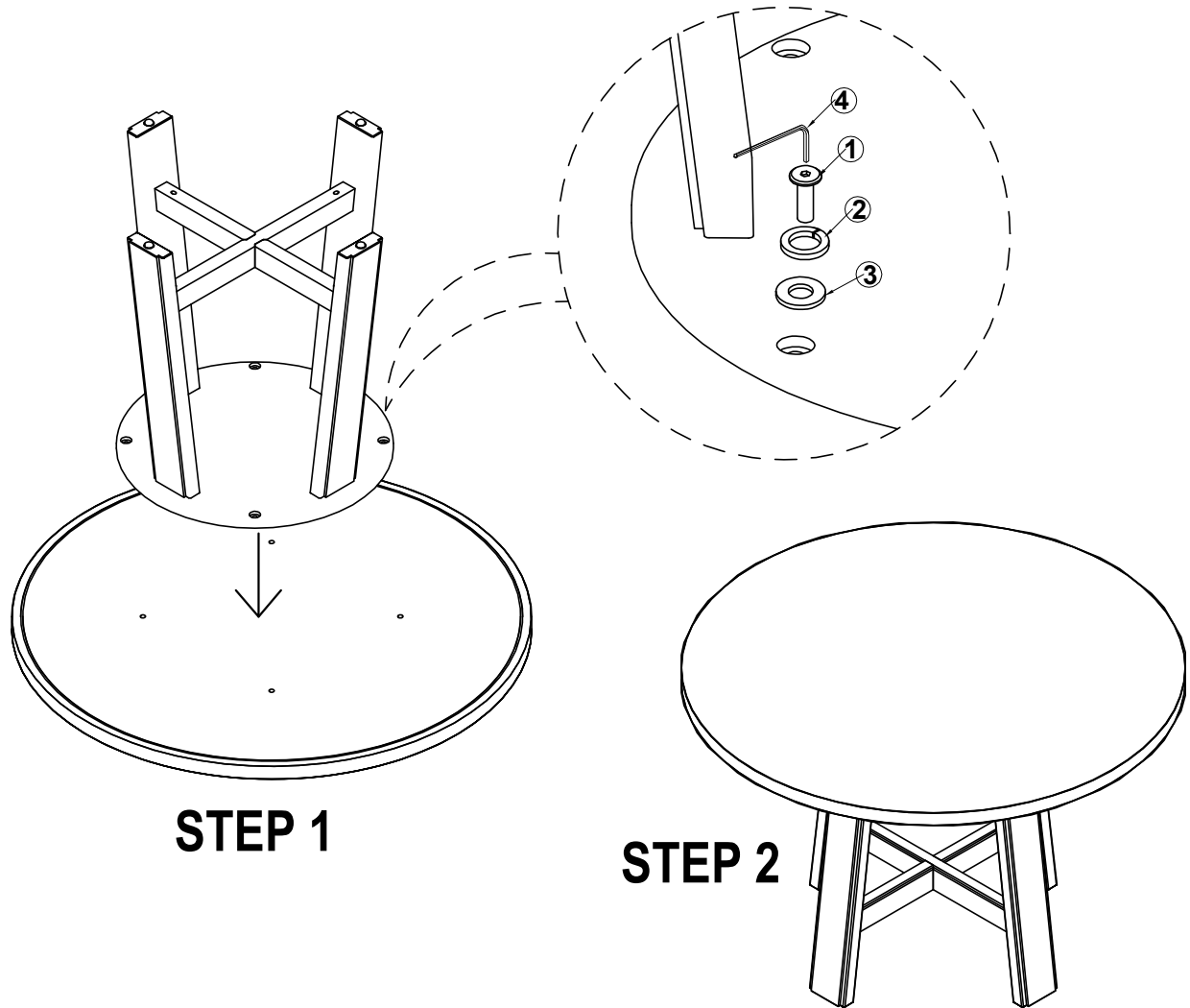

PART LIST

NO.	DRAWING	DESCRIPTION	SIZE	QTY
1		Allen Bolts	Ø M8 X 35 mm	4 pcs
2		Lock Washers	Ø M8	4 pcs
3		Flat Washers	Ø M8	4 pcs
4		Allen Key	Ø M8	1 pc

ASSEMBLY INSTRUCTION

1. Place Dining Table on a clean soft padded surface
2. Set item upright and level furniture with adjustable floor glides

CLEANING INSTRUCTION

Clean surface with a soft damp cloth. Dry Immediately