

Hall Tree

IMPORTANT

Carefully remove all the parts from the carton and place them individually on a soft cloth to prevent scratches or other damage.

Carefully and strictly follow these assembly instructions to ensure a completed product as designed.

Do not use power tools above 8 volts to assemble.

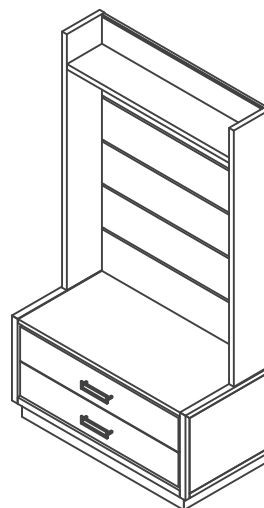

Part List

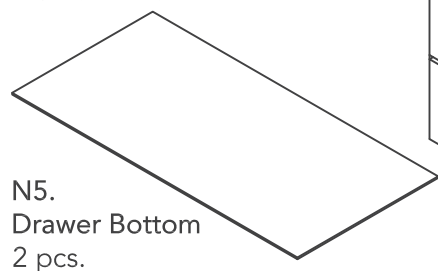

N5.
Drawer Bottom
2 pcs.

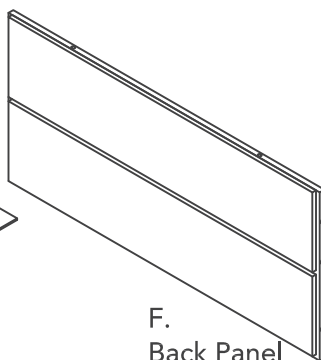

F.
Back Panel
1 pc.

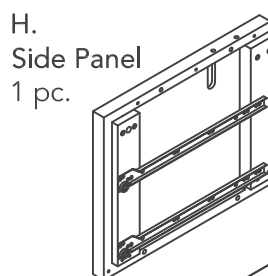

H.
Side Panel
1 pc.

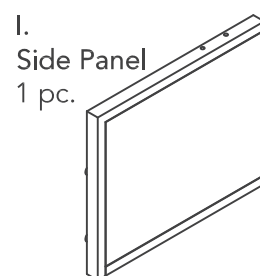

I.
Side Panel
1 pc.

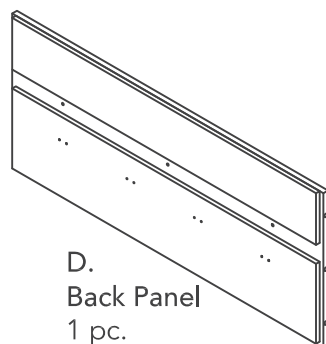

D.
Back Panel
1 pc.

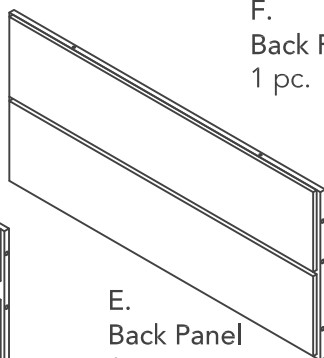

E.
Back Panel
1 pc.

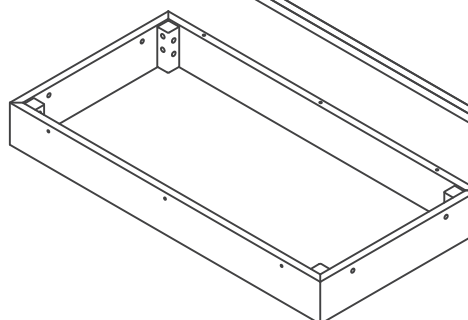

M.
Bottom
1 pc.

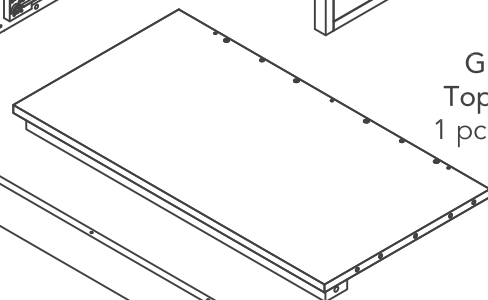

G.
Top
1 pc.

Hardware List



Cam Lock Screw
36 pcs. (+4 extra)



Cam Lock
36 pcs. (+4 extra)



5/16"x80
Bolt
2 pcs. (+1 extra)



Square Washer
2 pcs. (+1 extra)



Nut
2 pcs. (+1 extra)



Wrench
1 pc.



M4x32
1 1/4" Round
Head Screw
4 pcs. (+1 extra)



M4x25
1" Round
Head Screw
6 pcs. (+1 extra)



M3x32
1 1/4" Flat
Head Screw
28 pcs. (+1 extra)



M3x19
3/4" Flat
Head Screw
28 pcs. (+1 extra)



M6x40
Head Cap Bolt
6 pcs. (+1 extra)



Flat Washer
6 pcs. (+1 extra)



Spring Washer
6 pcs. (+1 extra)



Hex Wrench
1 pc.



Small Hex Wrench
1 pc.



5/32"x1"
Machine Screw
4 pcs.

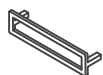

Handle
2 pcs.



Hook
4 pcs.

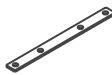

Bracket
2 pcs.



Dowel
20 pcs. (+1 extra)

Carton 20 05506 0491 is also needed for assembly.

Tool(s) required for assembly: Phillips screwdriver, Level, Pencil, Drill (8 volts or less), 3/8" Drill Bit

Home Styles Customer Service: www.homestyles-furniture.com,
servicedesk@homestyles-furniture.com, 888-680-7460, 877-831-0319

Assembly Instructions 2/11

IMPORTANT

- Use a soft cloth between these parts and the floor.
- Do not use power tools above 8 volts to assemble.
- Do not tighten all the bolts until each part is properly assembled.
- The unit must be level to work properly. Use the included adjustable levelers to level.
- Keep Hex Wrench and Wrench as the Bolts and Nuts may need to be tightened in the future.

STEP 1

Insert Cam Lock Screws and Bolts into pre-drilled holes in Top (G), Side Panels (A), (B), (H), (I), Back Panel (E) and Bottom (M), then tighten.

Insert Bolts into Side Panels (H) and (I), then tighten.

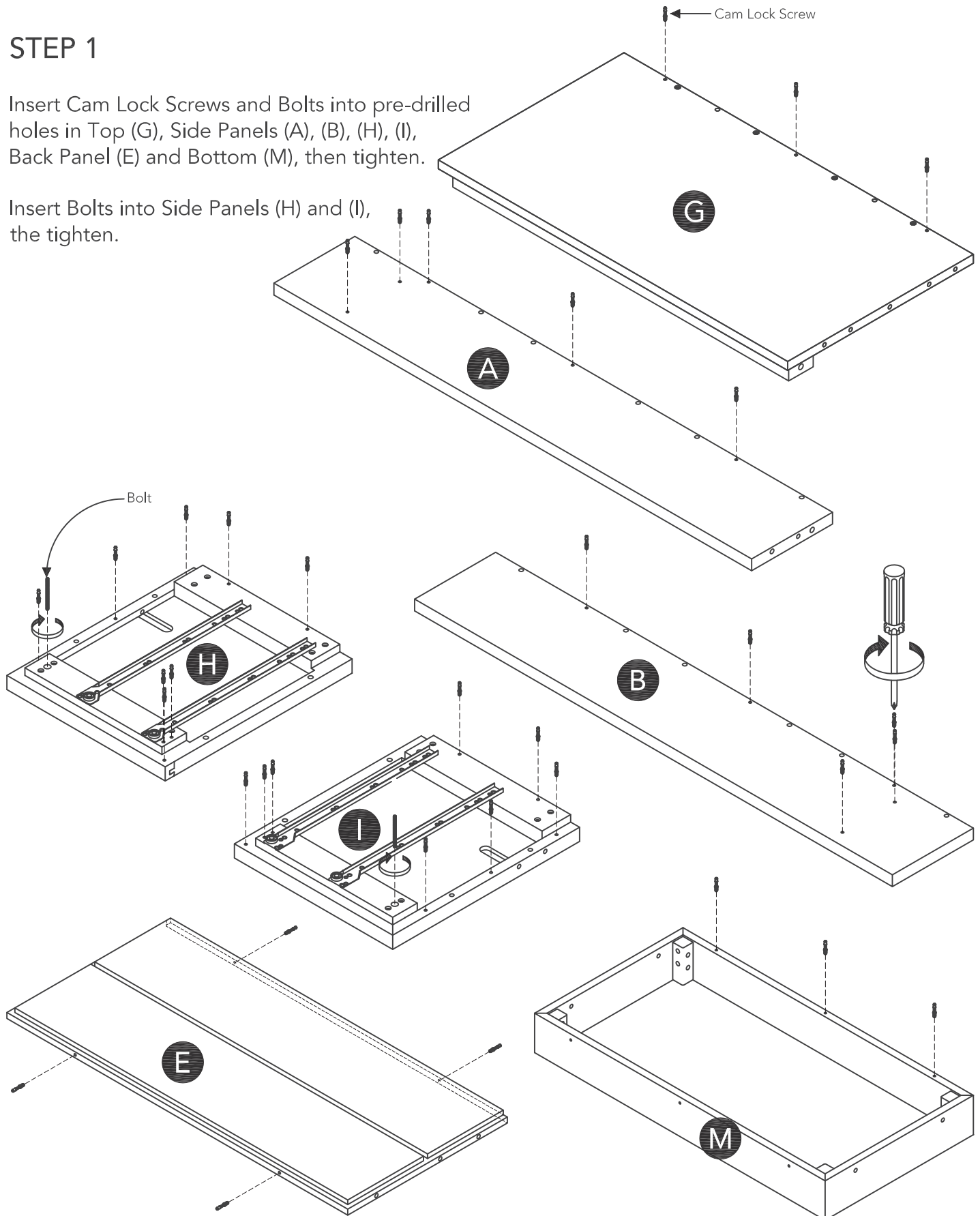

STEP 2

Attach Shelf (C) to Back Panel (D) with 1" Round Head Screws.

Attach Back Panels (D) and (F) to Back Panel (E) with Cam Locks.
(See Figure 1)

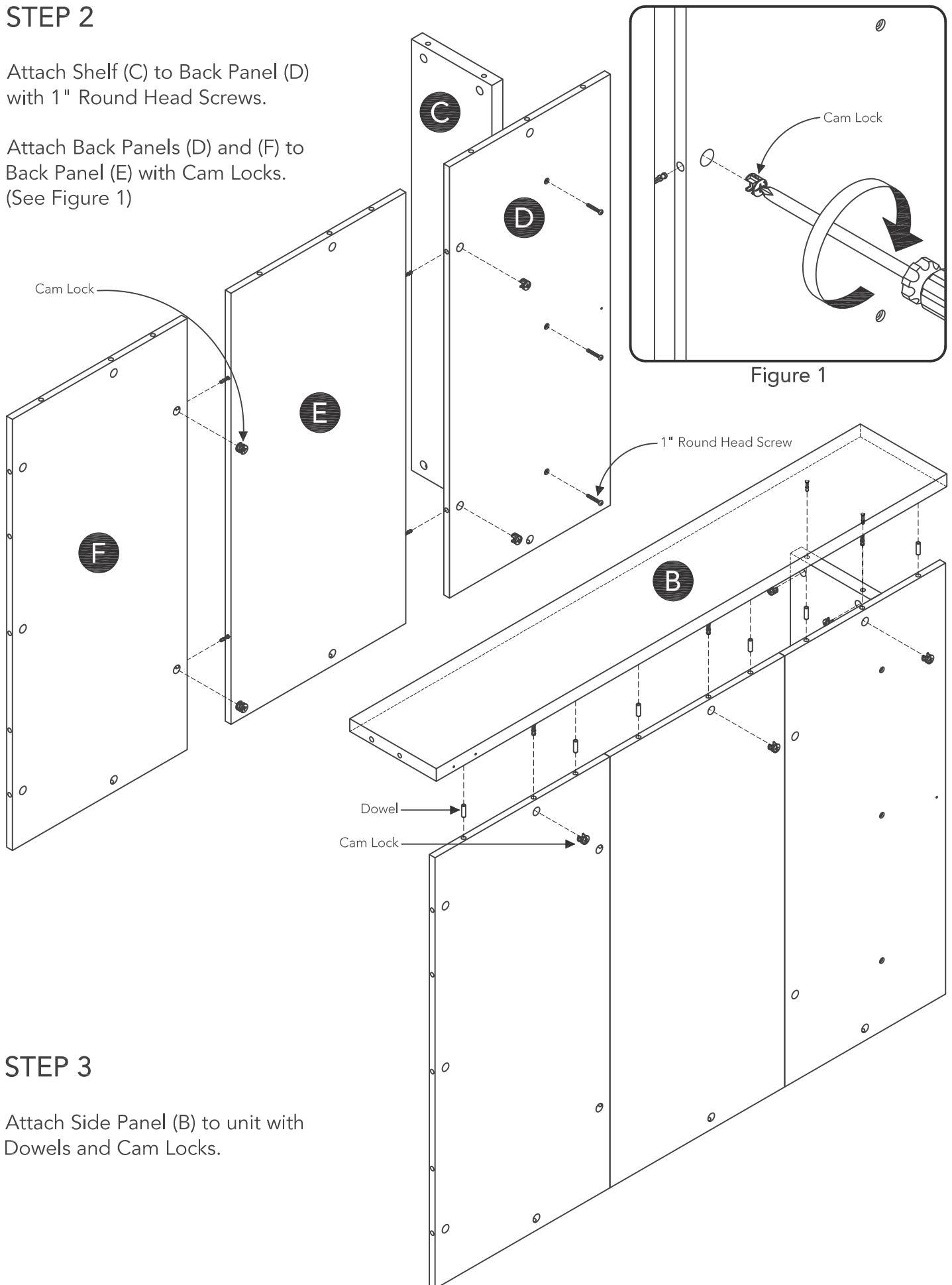

STEP 3

Attach Side Panel (B) to unit with Dowels and Cam Locks.

STEP 4

Attach Side Panel (A) to unit with Dowels and Cam Locks.

Attach Hooks to unit with 3/4" Flat Head Screws. (See Figure 2)

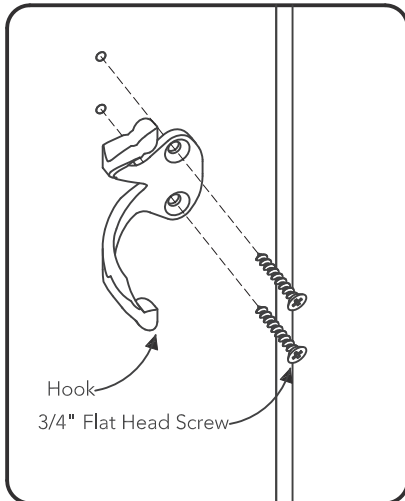
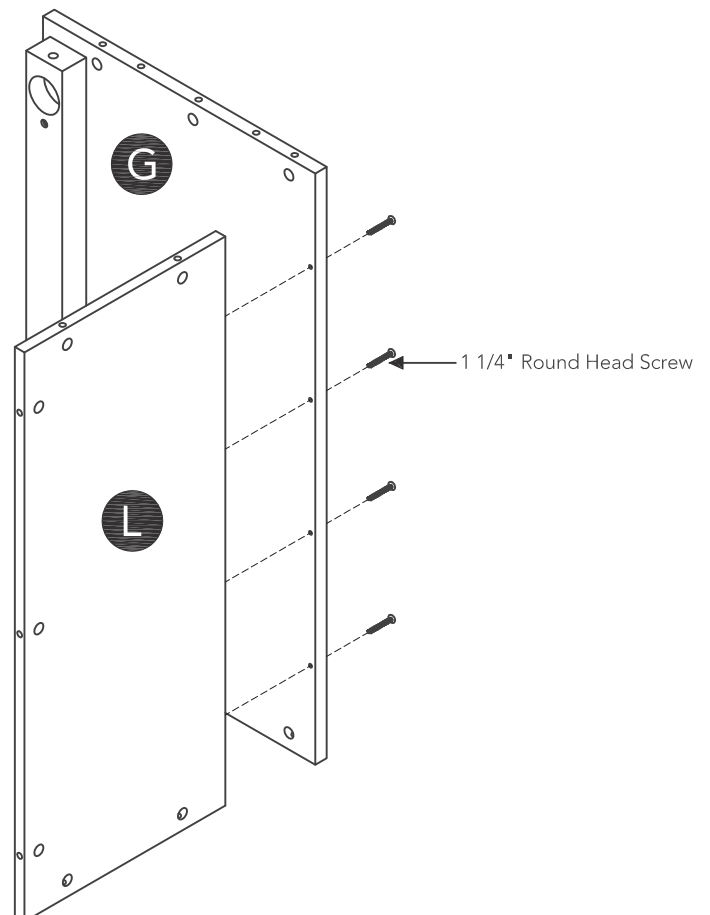
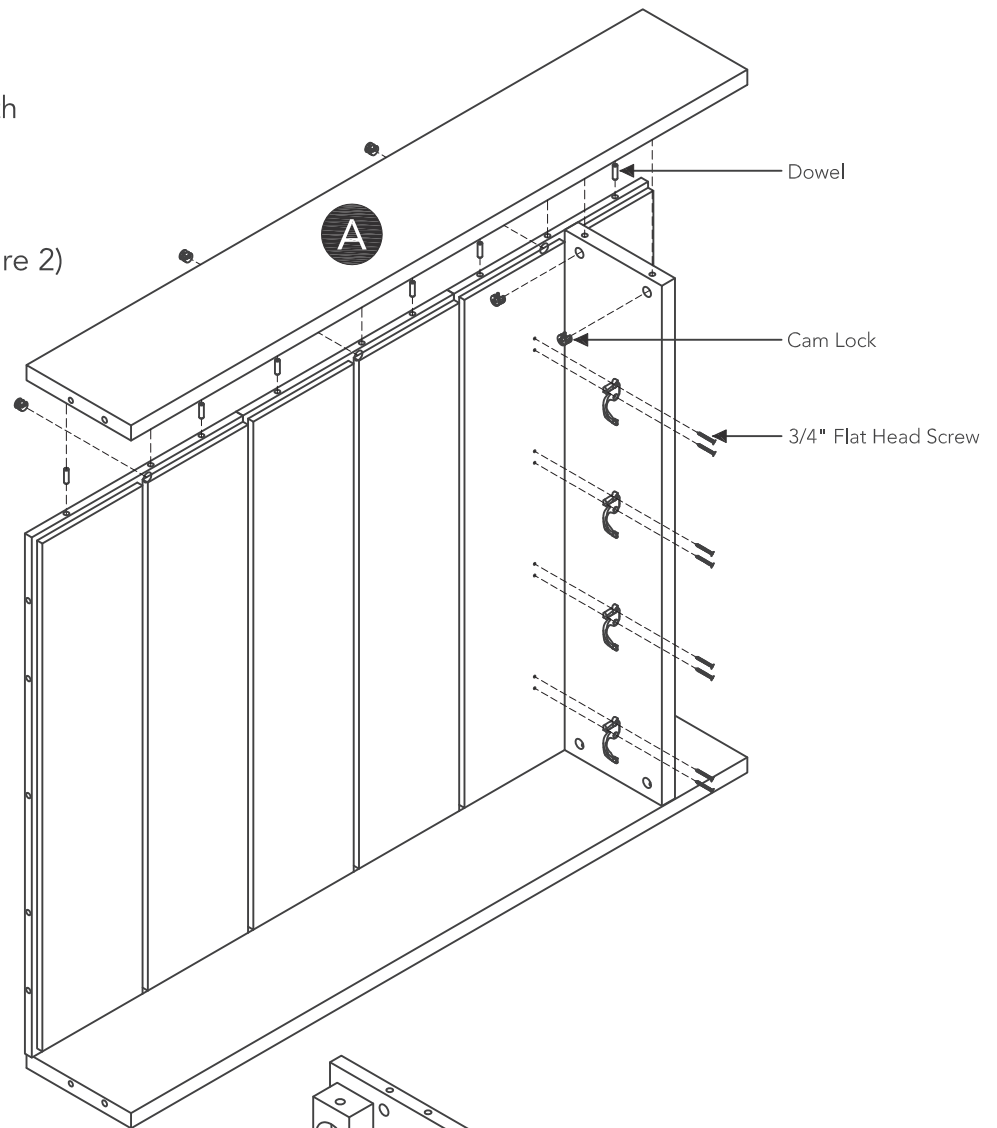

Figure 2



STEP 5

Attach Back Panel (L) to Top (G) with 1 1/4" Round Head Screws.

STEP 6

Attach unit and Front Rails (J), (K) to Side Panel (H) with Dowels, Cam Locks, Square Washer and Nut. (See Figure 3)

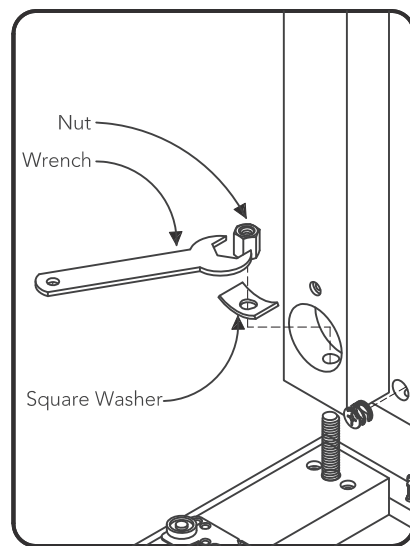
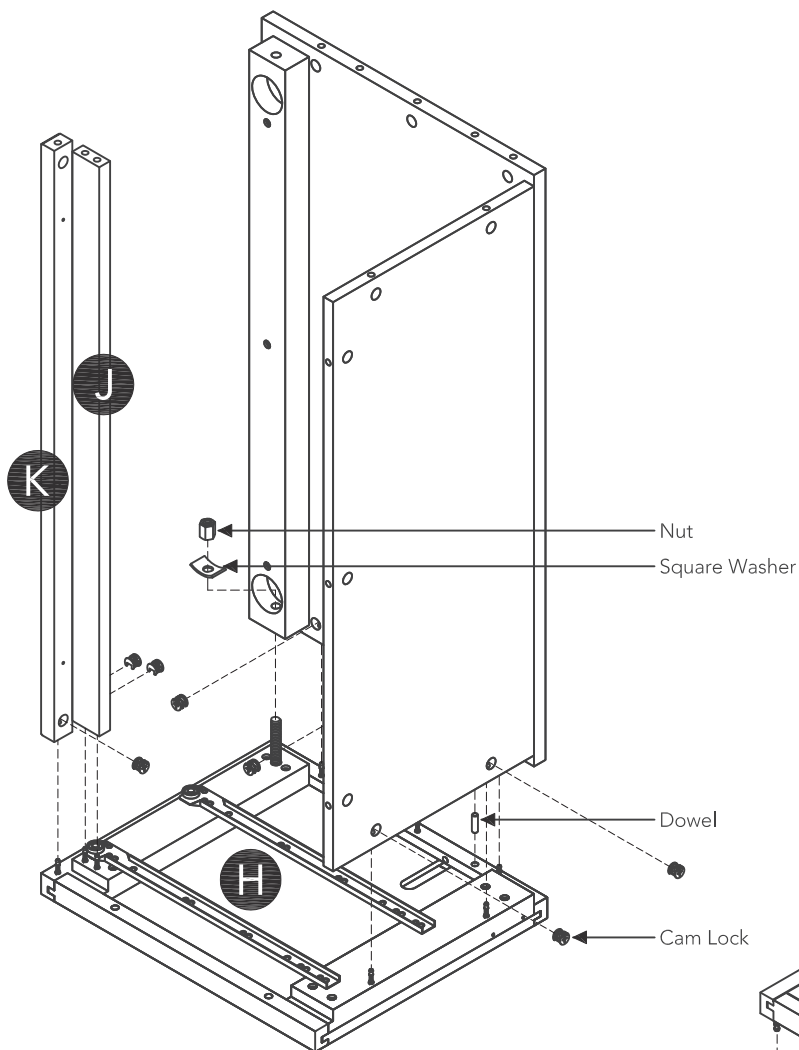
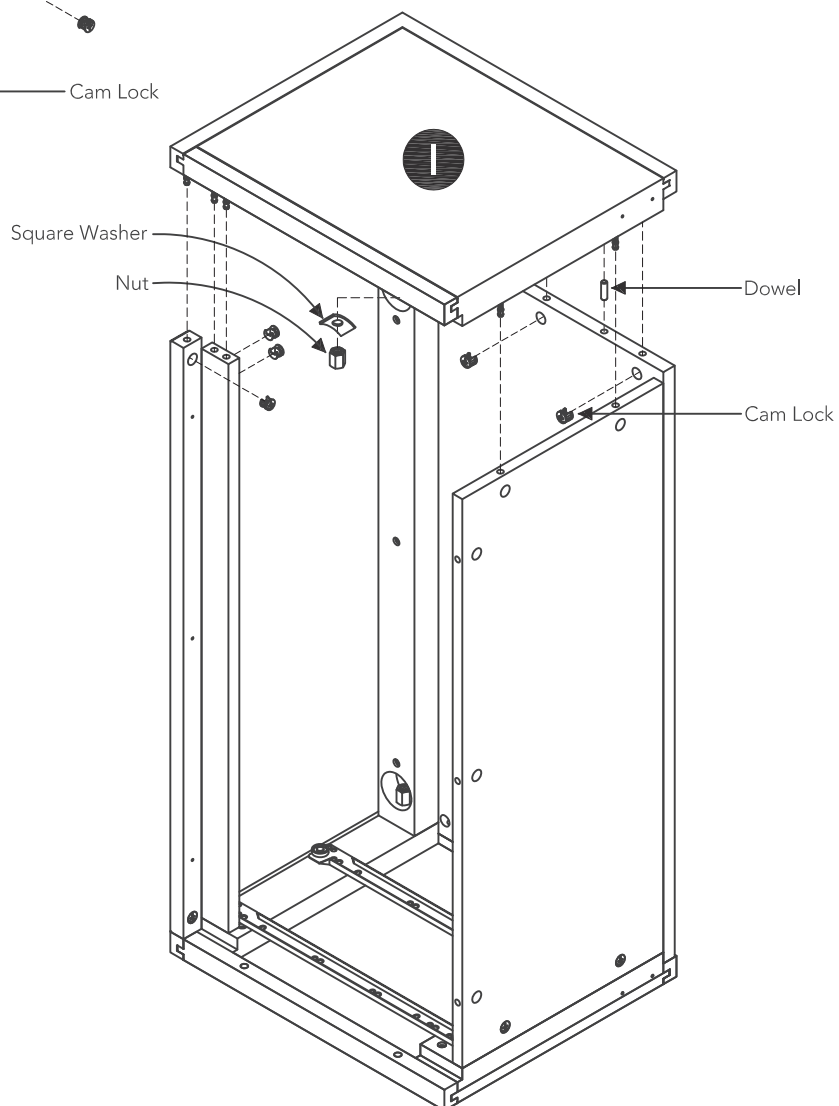

Figure 3



STEP 7

Attach Side Panel (I) to unit with Dowels, Cam Locks, Square Washer and Nut.

STEP 8

Attach Bottom (M) to unit with Cam Locks, Flat Washers, Spring Washers, Head Cap Bolts and 1" Round Head Screws.

Tighten Head Cap Bolts with Hex Wrench. (See Figure 4)

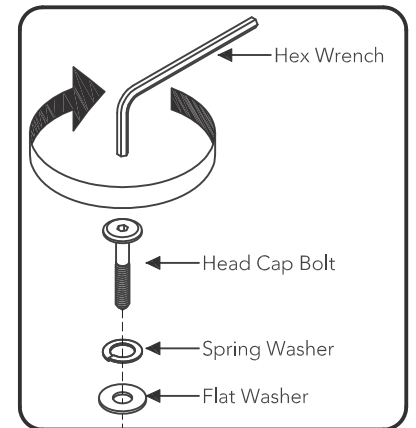
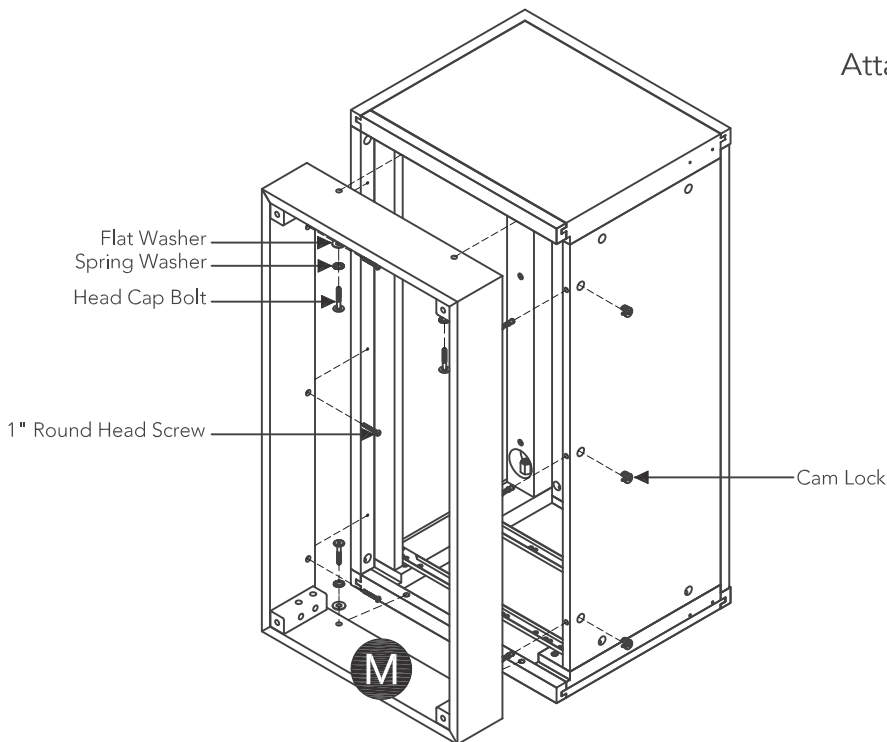
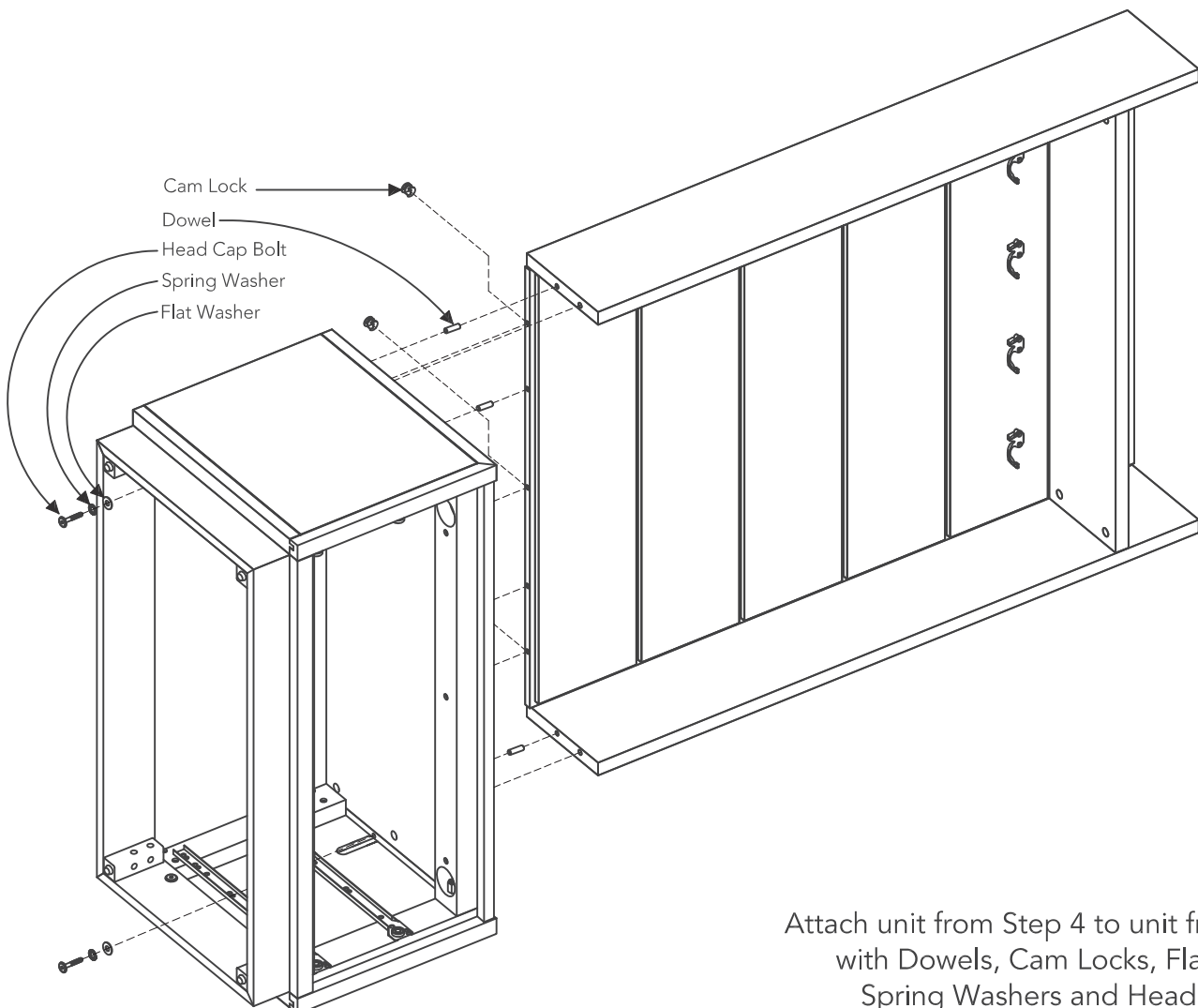

Figure 4



STEP 9

Attach unit from Step 4 to unit from Step 8 with Dowels, Cam Locks, Flat Washers, Spring Washers and Head Cap Bolts.

STEP 10

Turn unit to its upright position.

Attach Connector Plates to unit with 3/4" Flat Head Screws. (See Figure 5)

Level unit by adjusting the adjustable levelers on bottom of unit. (See Figure 6)

Note: Unit must be level to work properly.

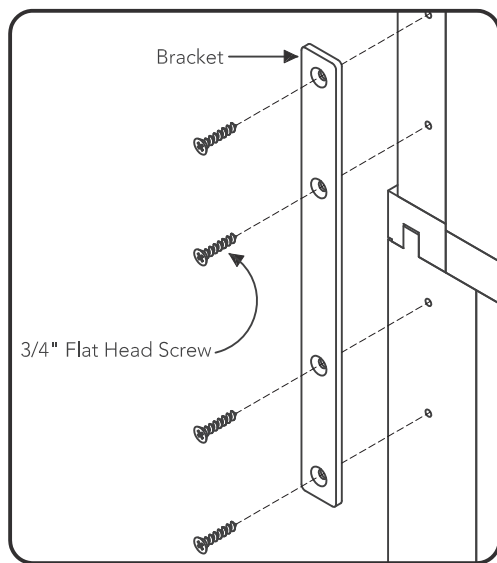

Figure 5

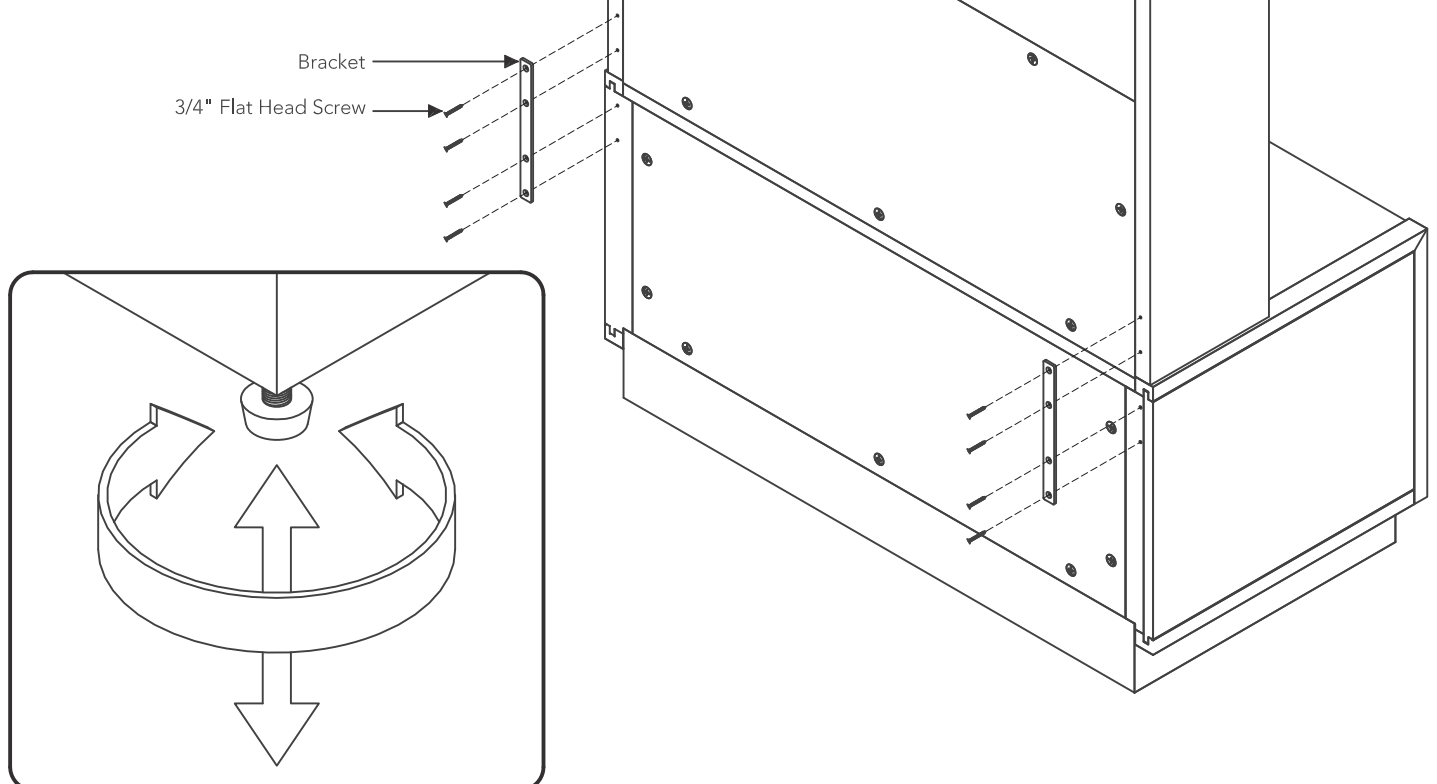

Figure 6

Assembly Instructions 8/11

IMPORTANT

- To help reduce the risk of the unit tipping over, the Tipover Restraint must be installed following these instructions exactly.

STEP 11

Place unit at desired location.

Drill a 3/8" hole in wall in-line with pre-drilled hole at top of unit.

Move unit.

Insert Anchor into the wall hole and attach Bracket with Wall Screw.

Attach Bracket at pre-drilled hole at top of unit with Wood Screw.

Move unit back into place.

Slide Tipover Restraint through Bracket on wall and Bracket on unit.
(See Figure 7)

Put tie end of Tipover Restraint into lock end of Tipover Restraint and pull until tight.

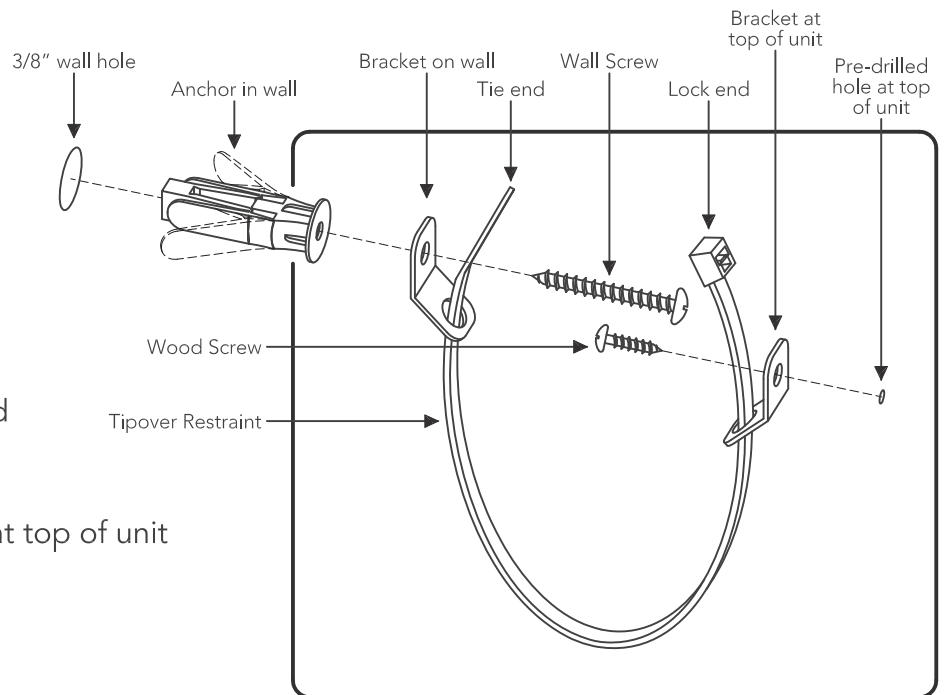
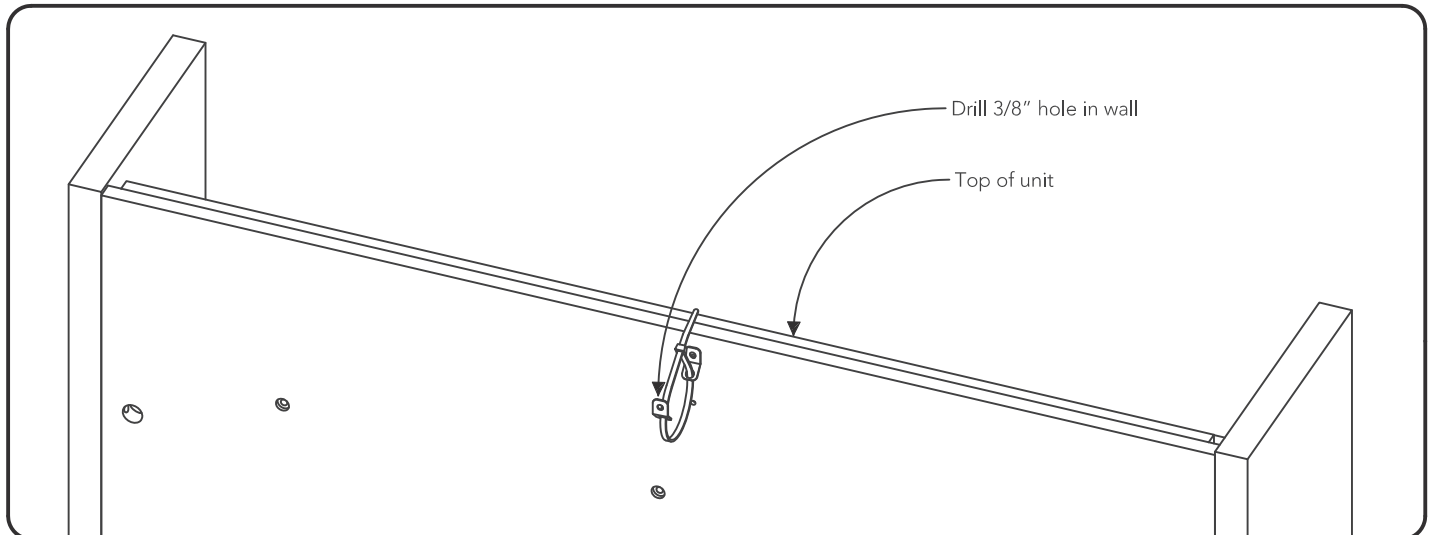
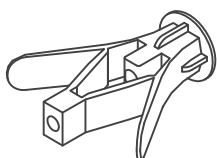

Figure 7



Hardware List



Anchor
1 pc. (+1 extra)

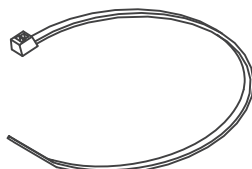

Tipover Restraint
1 pc.



Bracket
2 pcs.

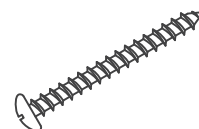

**M3x38
Wall Screw**
1 pc. (+1 extra)



**M3x13
Wood Screw**
1 pc. (+1 extra)

Assembly Instructions 9/11

Drawer (N)

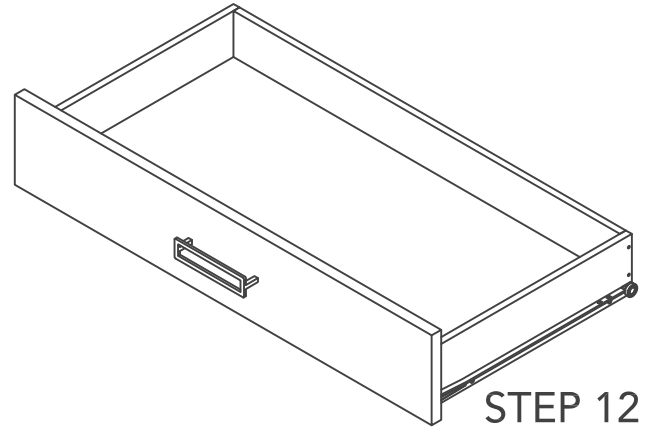
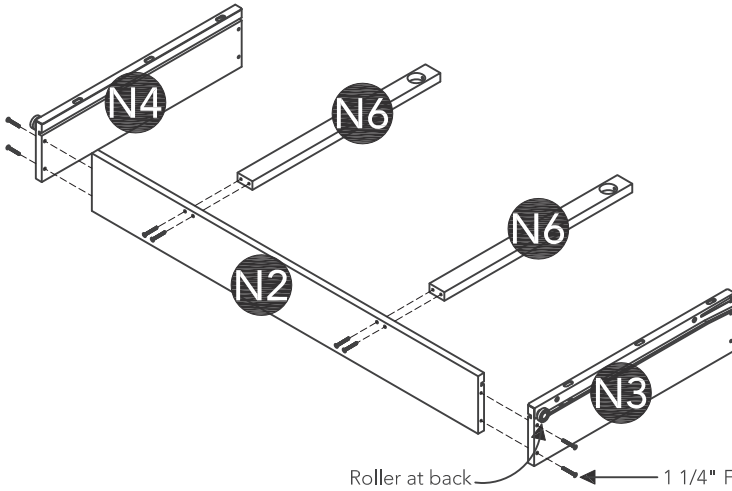

STEP 12

Attach Drawer Sides (N3), (N4) and Drawer Supports (N6) to Drawer Back (N2) with 1 1/4" Flat Head Screws.

STEP 13

Insert Drawer Bottom (N5) into groove.

Attach Drawer Front (N1) to unit with 1 1/4" Flat Head Screws.

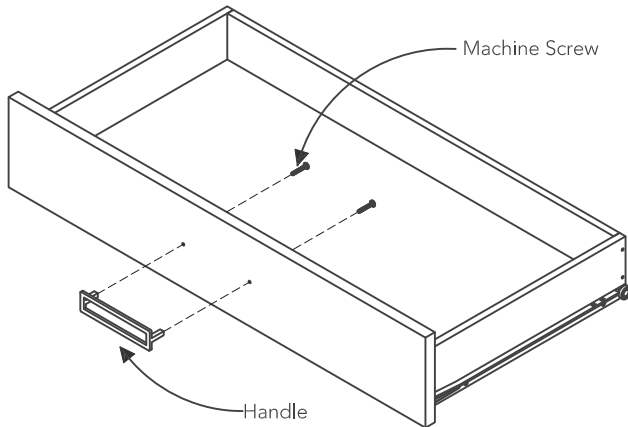
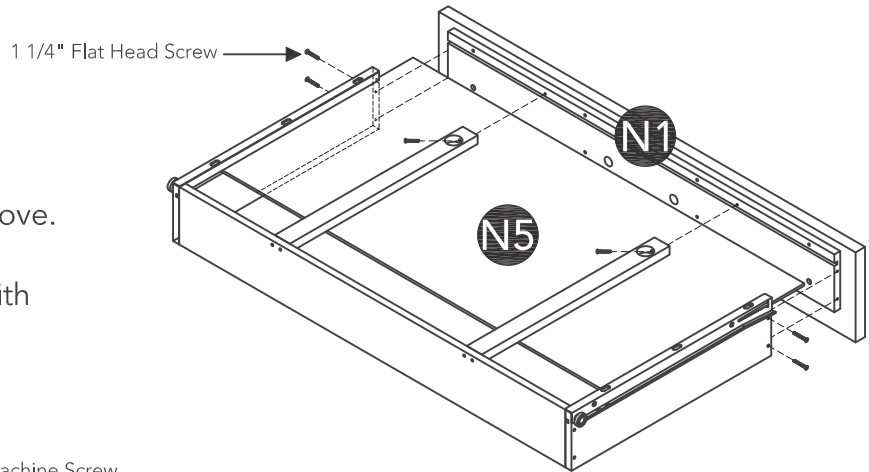

STEP 14

Attach Handle with Machine Screws.

Note: Drawer assembly is not complete until 3/4" Flat Head Screws are used in a later step.

Part List

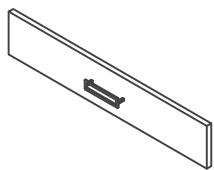

N1.
Drawer Front
2 pcs.



N2.
Drawer Back
2 pcs.

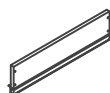

N3.
Drawer Side
2 pcs.



N4.
Drawer Side
2 pcs.

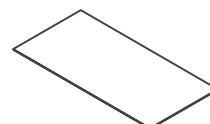

N5.
Drawer Bottom
2 pcs.



N6.
Drawer Support
4 pcs.

STEP 15

Loosen slightly screws pre-installed on back of drawer fronts.

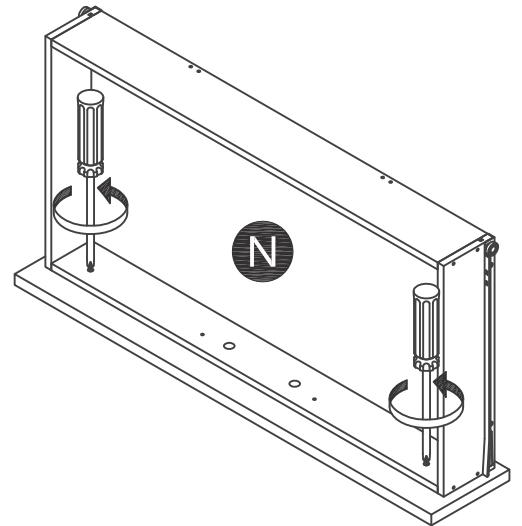
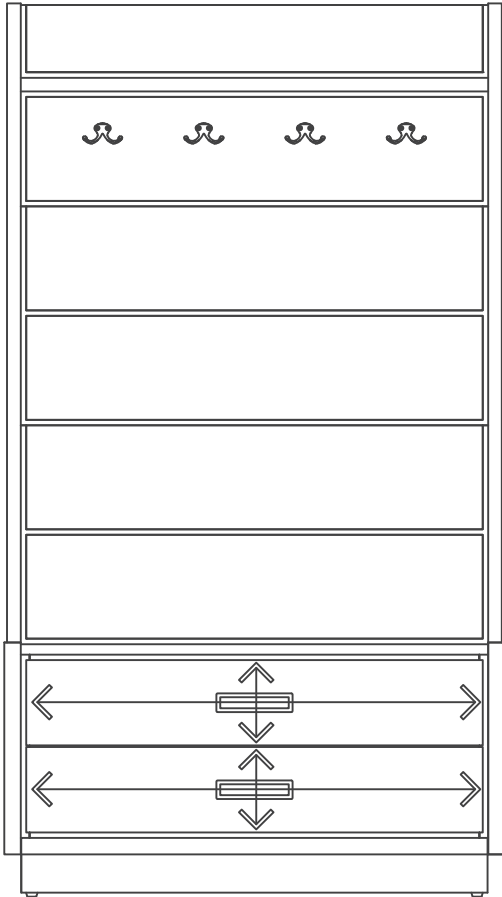

STEP 16

Insert drawers into unit, then adjust drawer front panels left or right and up or down until drawer gaps look proportional.

STEP 17

Pull each drawer open slowly, then retighten screws from Step 15.

Make sure drawer front panels do not move and lock drawer front panels into position with 3/4" Flat Head Screws.

Note: These 3/4" Flat Head Screws must be installed to complete the drawer assembly.

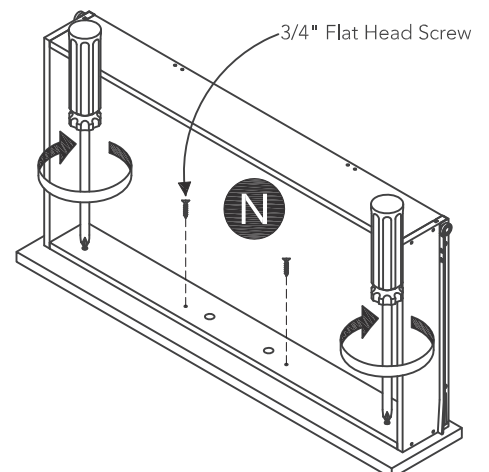
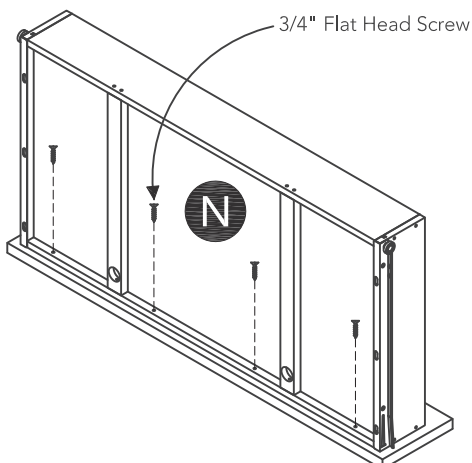

STEP 18

Slide Drawers (N) into position.

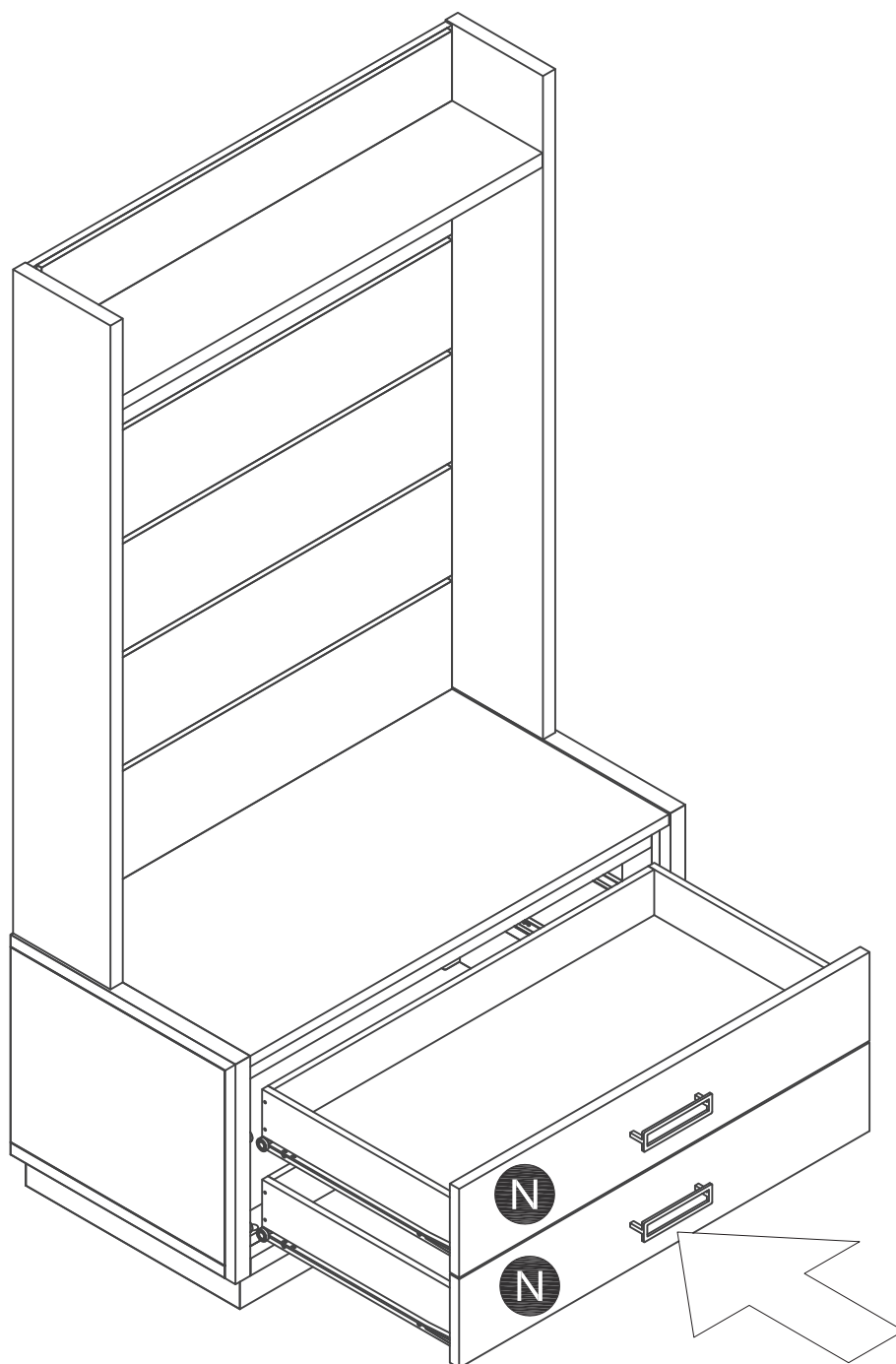

CARE INSTRUCTIONS

NEVER

allow liquids to remain on furniture.
Absorption causes parts to warp
and split and finishes to delaminate.

NEVER

use glass cleaners on
finished furniture. Ammonia
chemically attacks the finish.



Do not use power tools
above 8 volts to assemble.

**PREVENT
CRACKING**



Do not place
in direct sunlight.

**PREVENT
FADING**



Do not write
directly on surface.

**PREVENT
MARKING**



Do not place hot
objects on surface.

**PREVENT
FINISH DAMAGE**



Do not use rubber
based placemats.

**PREVENT
DISCOLORING**



Do not use commercial
waxes and polishes.

**PREVENT
YELLOWING**

CLEAN

with a soft cloth moistened
in lukewarm soap and water.
Buff with a dry clean cloth.



Home Styles will provide replacements free of charge for missing or damaged hardware or parts within 30 days of purchase. Digital images of the defective parts may be required. If the product was not purchased from an authorized retail affiliate, Home Styles is under no obligation to provide replacement parts. Parts are not available for fully assembled items nor are parts available for sale. Replacements for missing or damaged hardware or parts may be requested at:

www.homestyles-furniture.com/customer-service/replacement-parts

Home Styles Customer Service: www.homestyles-furniture.com,
servicedesk@homestyles-furniture.com, 888-680-7460, 877-831-0319