

PURELL® CS2 DISPENSER REFILL LOADING INSTRUCTIONS

These instructions apply to PURELL® brand CS2 Push-Style Dispensers.

Please carefully read all instructions before loading the refill.

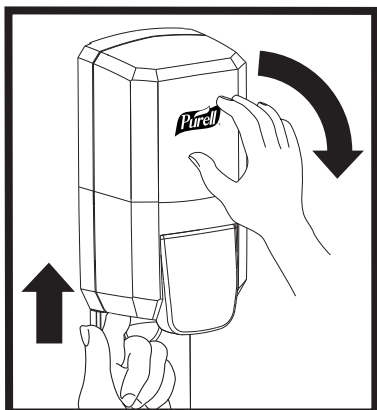

- 1.** Open dispenser by depressing release button on bottom and pull down on front cover.

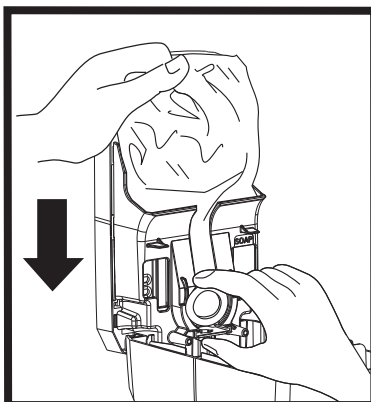

- 2.** Remove refill from shipper and insert into dispenser with nozzle in front.

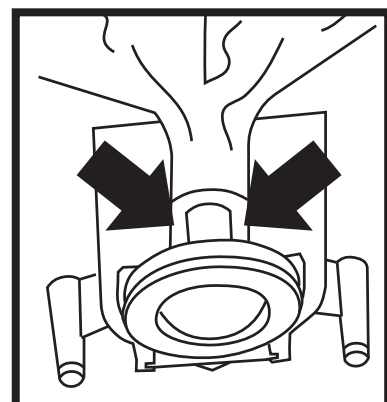

- 3.** Push nozzle and refill down until fully seated.

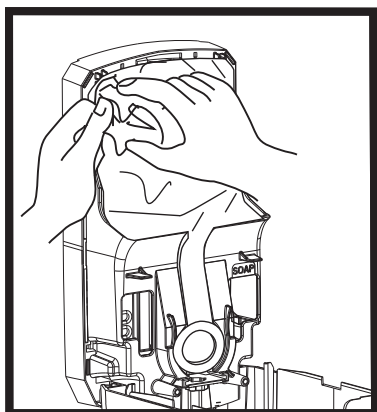

- 4.** Tuck refill completely into dispenser.

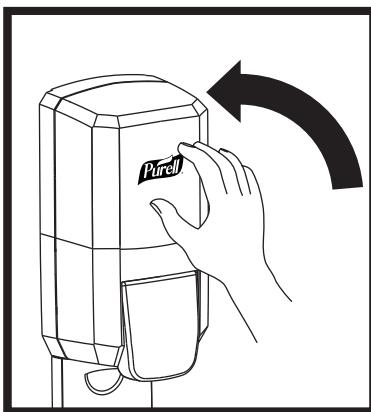

- 5.** Close dispenser cover.



GOJO Industries, Inc.
One GOJO Plaza, Suite 500
P.O. Box 991 • Akron, OH 44309-0991
Tel: 1-330-255-6000 • Toll-free: 1-800-321-9647
Fax: 1-800-FAX-GOJO