

SHIMANO

TRAX

TRX200AXG

The (5765) Bearing, (6074) Spool clutch pin, and (4225) Roller clutch cannot be replaced by the customer. To replace these parts, please request after-sales service.

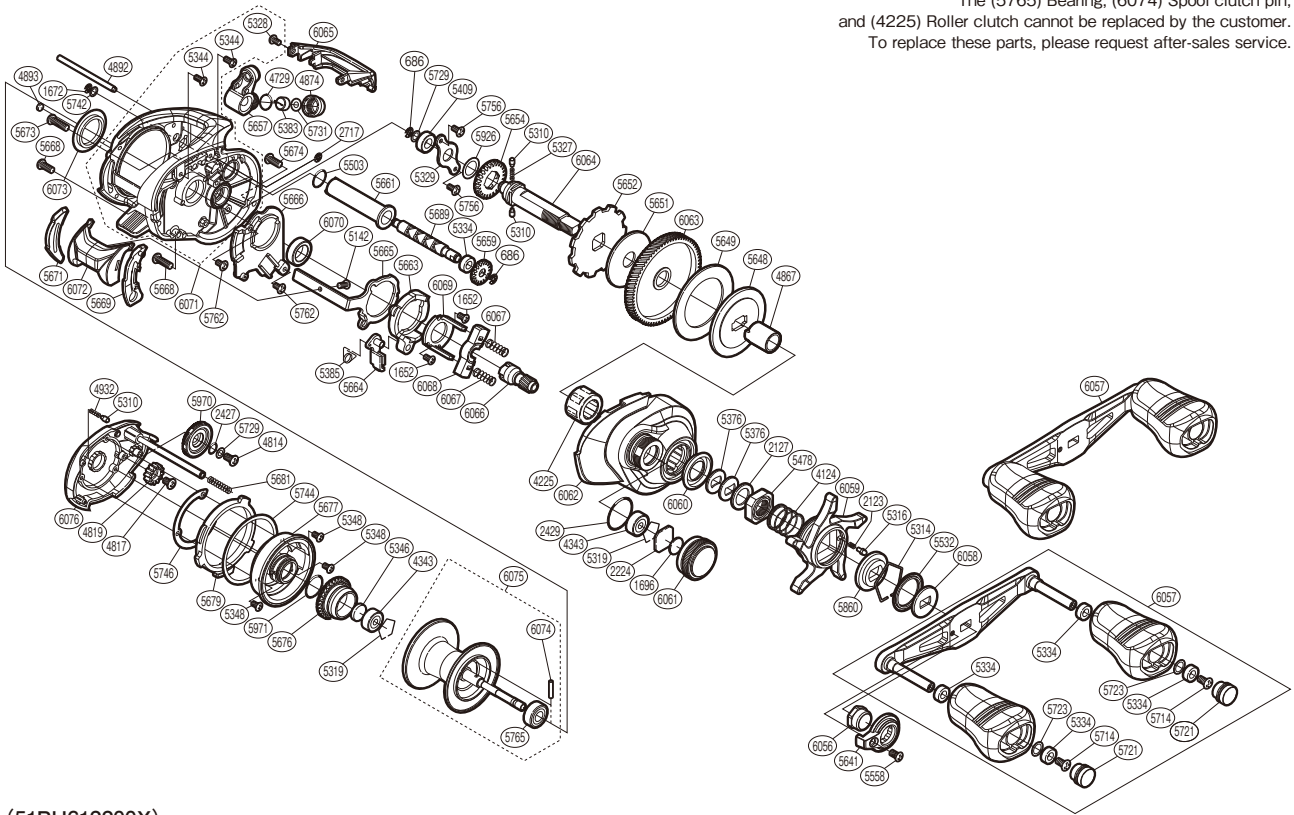

(51RH612200X)

#	Part No.	Description	#	Part No.	Description	#	Part No.	Description
686	105NK	E Lock	5383	10BHQ	Line Guide Pawl	5742	10S42	Washer
1652	10LVE	Screw	5385	104CP	Clutch Pawl Spring	5744	10042	Washer
1672	105NC	E Lock	5409	10DQF	Drive Shaft Bushing	5746	10040	Washer
1696	10896	Cast Control Spacer B	5478	1024H	Star Drag Nut	5756	10S3Y	Screw
2123	10BT2	Click Spring	5503	101GT	O Ring	5762	10S57	Screw
2127	10J1N	Star Drag Spacer	5532	10QVP	Star Drag Seal	5765	105CA	Ball Bearing
2224	1085F	Spool Tension Spacer A	5558	10R1Q	Screw	5860	10J26	Star Drag Click Plate
2427	108WS	O Ring	5641	10SSK	Handle Nut Plate	5926	1023S	Washer
2429	108WK	O Ring	5648	10SSR	Key Washer	5970	10SAZ	Brake Dial
2717	105NB	E Lock	5649	10SSF	Drag Washer	5971	100GW	O Ring
4124	10A70	Star Drag Spring	5651	1023U	Drag Washer	6056	10DRL	Handle Nut
4225	10F3C	Roller Clutch Bearing	5652	10SSJ	Anti-Reverse Ratchet	6057	10E8U	Handle Assembly
4343	105C3	Ball Bearing	5654	101K8	Idle Gear	6058	10SAW	Drive Shaft Shield
4729	108WQ	O Ring	5657	101E0	Line Guide Assembly	6059	10SRY	Star Drag
4814	103LE	Screw	5659	10SRL	Idle Gear	6060	10DRE	Roller Clutch Water Proof
4817	103L7	Screw	5661	10SSP	Level Wind Guard	6061	10T9X	Cast Control Cap
4819	10CLF	Idle Gear	5663	10SG1	Clutch Cam	6062	10SRG	Right Side Plate
4867	10CCN	Roller Clutch Inner Tube	5664	101M5	Clutch Pawl Assembly	6063	10SAX	Drive Gear
4874	10FJB	Pawl Cap	5665	10SSV	Clutch Plate	6064	10DRD	Drive Shaft
4892	10QSE	Stabilizer Bar	5666	10SST	Clutch Guard	6065	10SAU	Level Wind Protector
4893	108PY	Anti-Thrust Washer	5668	10SXB	Screw	6066	10DRC	Pinion Gear
4932	10GQZ	Click Spring	5669	10SG5	Clutch Bar Guide B	6067	10SAS	Yoke Spring
5142	10559	Screw	5671	10SRK	Clutch Bar Guide A	6068	10SAP	Yoke
5310	10HJG	Idle Gear Pin	5673	10LHY	Screw	6069	10DRF	Clutch Cam Retainer
5314	10KXW	Click Plate Retainer	5674	10SXA	Screw	6070	10DRK	Pinion Gear Bushing
5316	10MFC	Click Pin	5676	101DR	Brake Ring Gear Assembly	6071	10RE7	Frame Assembly
5319	1054D	Bearing Retainer	5677	10DSB	Brake Case Assembly	6072	100ZE	Clutch Button Assembly
5327	10JDY	Idle Gear Spring	5679	10SG6	Left Side Plate Cam Lever	6073	10SAR	Frame Center Seal
5328	10LCQ	Screw	5681	10KNH	Spring	6074	10P68	Spool Clutch Pin
5329	109T1	Drive Shaft Retainer	5689	10SSS	Worm Shaft	6075	100ZK	Spool Assembly
5334	10PXZ	Bushing	5714	10LFA	Screw	6076	1011D	Left Side Plate Assembly
5344	10MPD	Screw	5721	1022Z	Handle Knob Seal			
5346	10EX5	Spacer B	5723	1003Z	Washer			
5348	10L1Q	Screw	5729	1003V	Spacer			
5376	109F5	Drag Spring Washer	5731	1003S	Spacer			

Please note that the number of adjusting washers may not be the same as shown in the exploded views. (Adjustment will vary with each individual product.)

(241029)_008