



## **CX10** - FLAT BACK ADIRONDACK

---

### **ASSEMBLY INSTRUCTIONS**

---



**IMPORTANT:** Please read this manual carefully before beginning assembly of this product. Keep this manual for future reference. Visit our website for an assembly instruction video.

\*Made from 95% post-consumer recycled plastic bottle caps

**[www.capterracasual.com](http://www.capterracasual.com)**  
**[wecare@capterracasual.com](mailto:wecare@capterracasual.com)**  
**Toll-free: 1-866-439-9521**

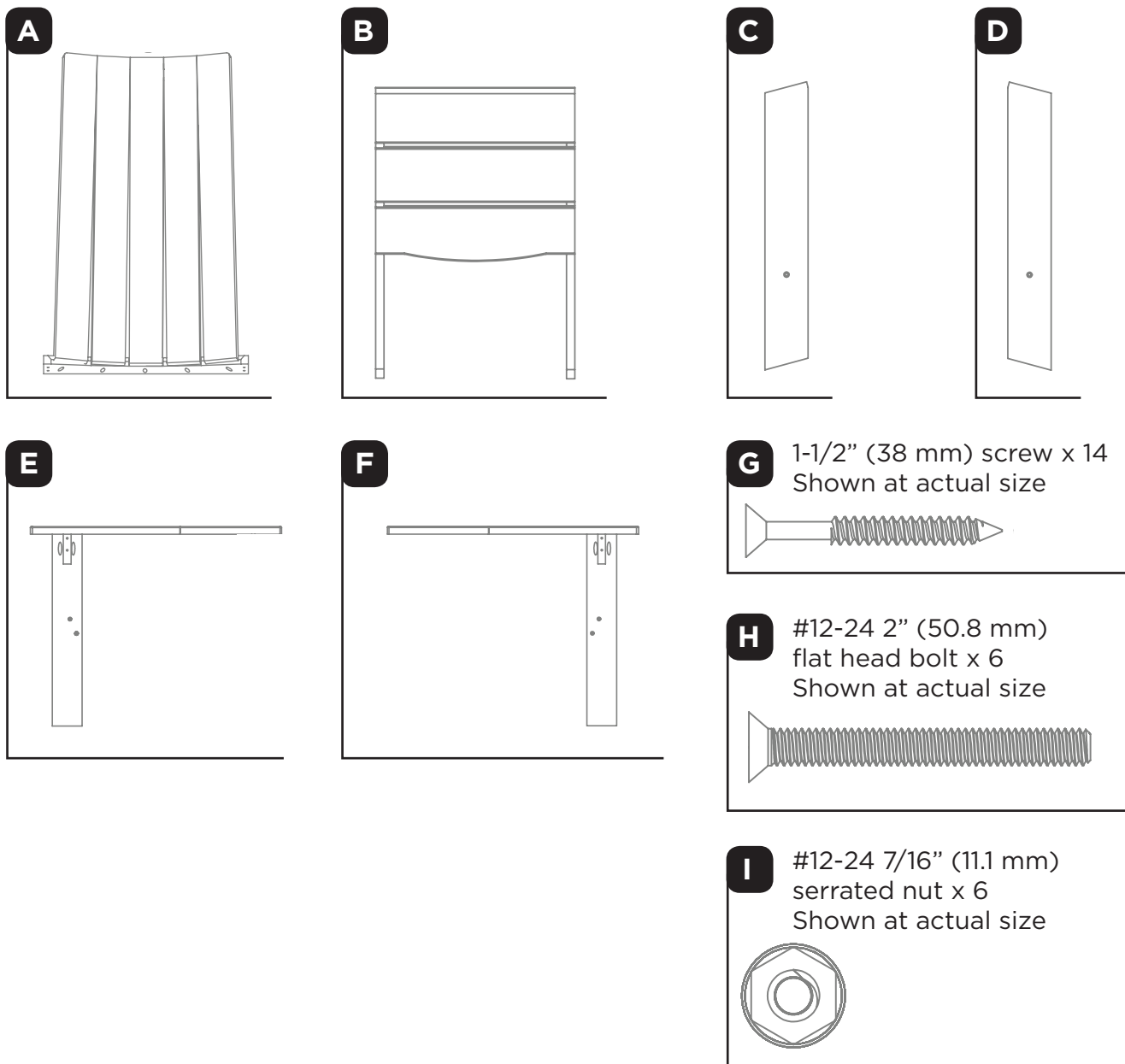

Needed for assembly:

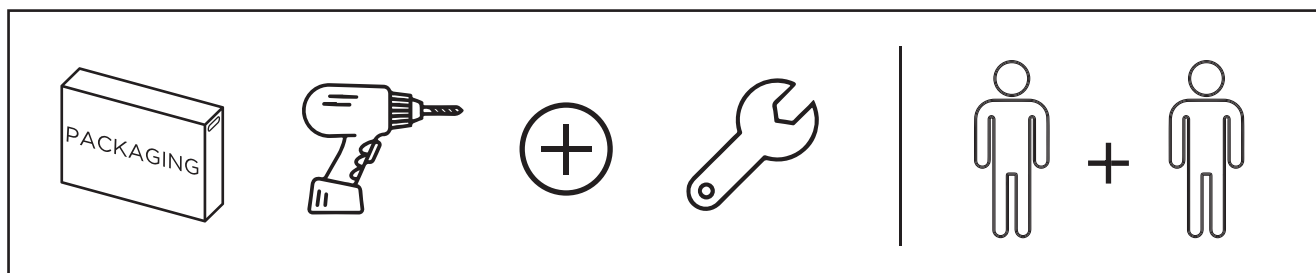

**IMPORTANT:** Please read and understand the manual before any assembly. Before beginning assembly of product, make sure all parts are present. Compare parts with packaging contents list. If any part is missing, or if you have any questions, contact our service center. Remove all parts from the box in the cleared area and position them on the floor in front of you. Do not dispose of the packing materials until assembly is complete.

## Step 1

Requires **B** - SEAT, **C** - LEFT LEG, **D** - RIGHT LEG, **H**, **I**.

Attach piece **D** to seat **B** with bolt **H** and nut **I**. Tighten bolt 95%, then fully tighten at step 7. Make sure the edge of **D** is flush with **B**. Repeat for other side with piece **C**.

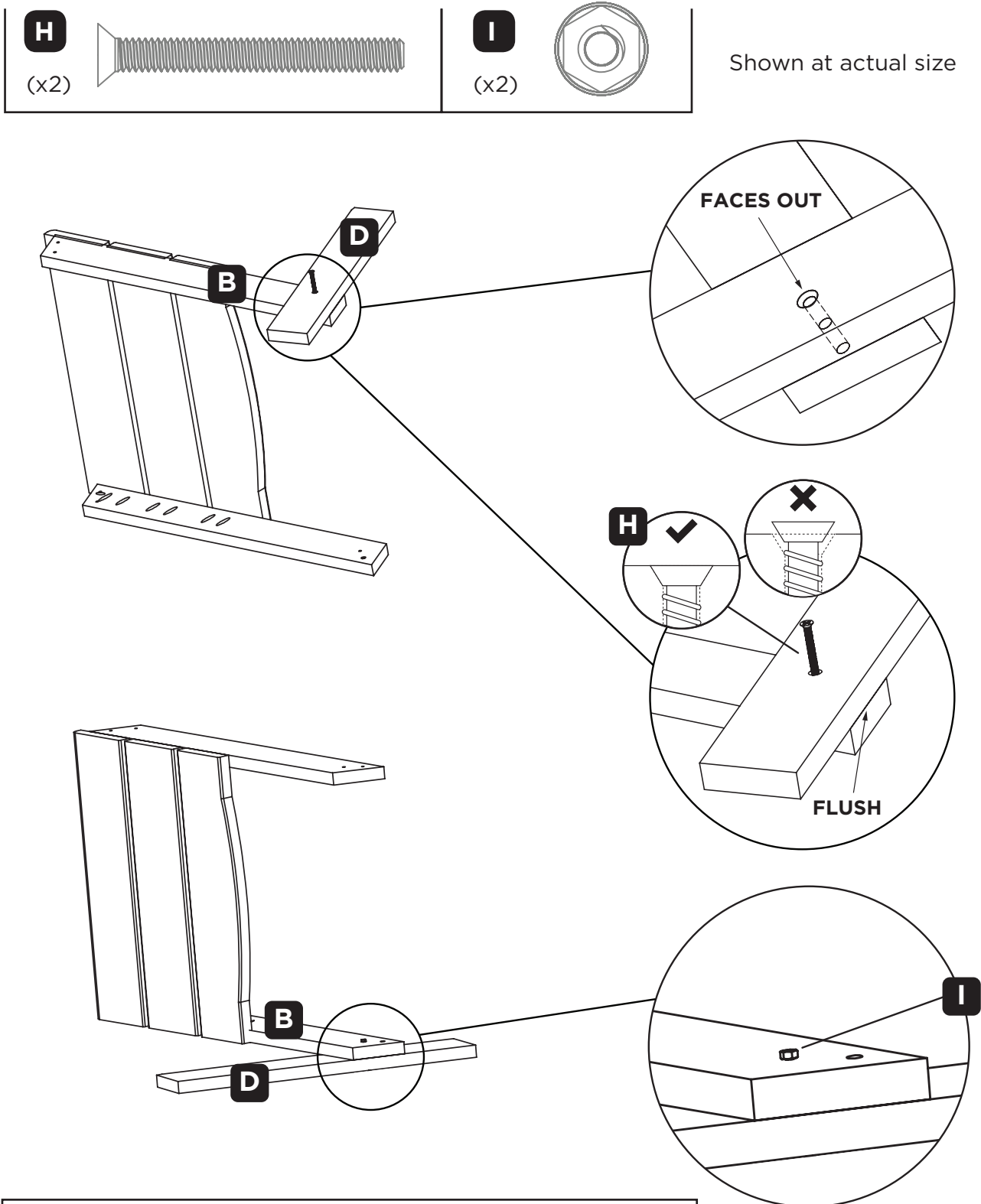

**REPEAT FOR OTHER SIDE WITH PIECE C.**

## Step 2

Requires A - BACK, G.

Place assembled seat of chair on box for ease of assembly. Attach piece **A** to piece **B** using **G** screws, lining up with front pre-drilled holes.

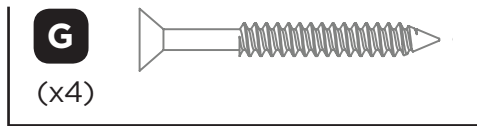

Shown at actual size

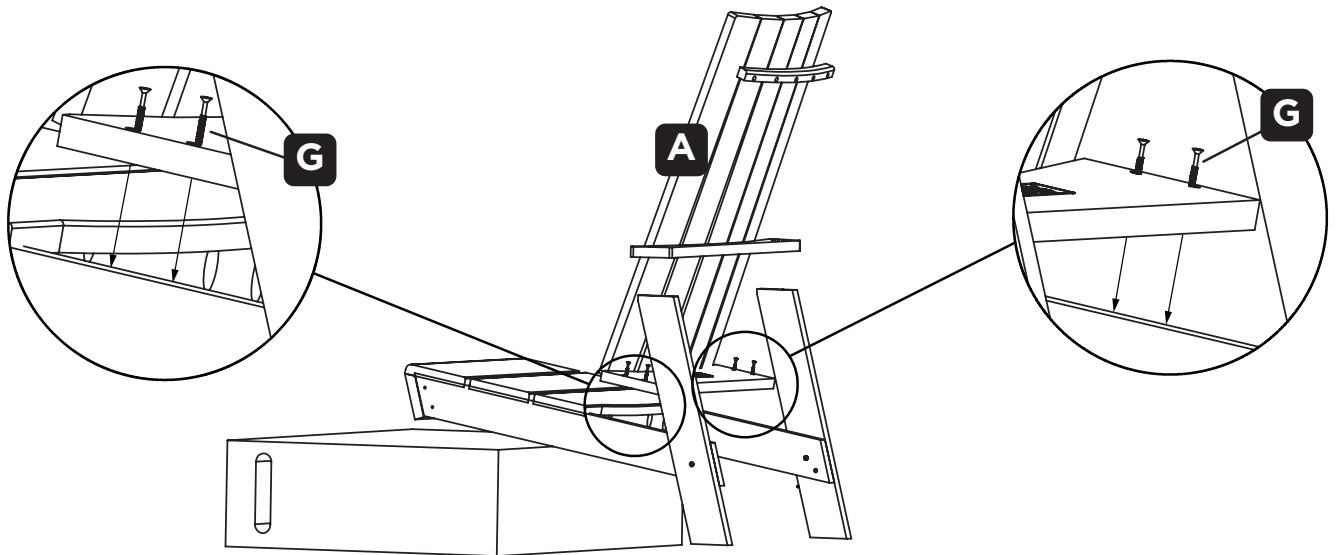

## Step 3

Requires G.

Attach piece **A** to piece **C** and **D** using **G** screws.

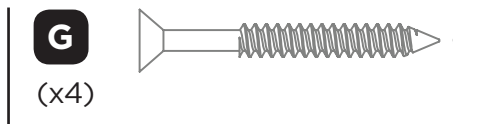

Shown at actual size

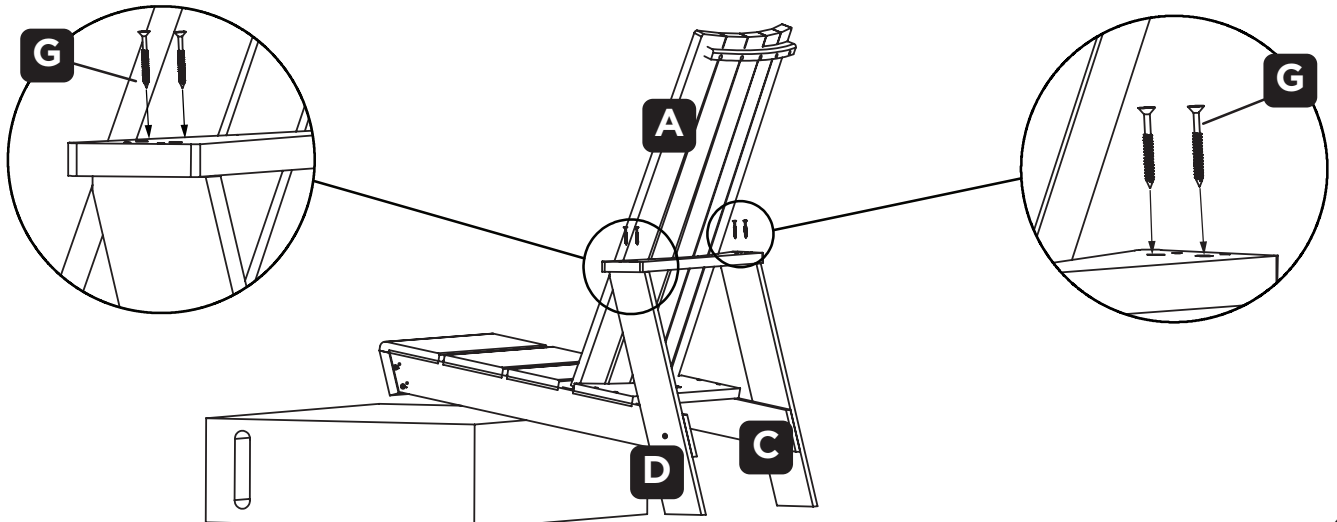

## Step 4

Requires E - LEFT ARM, F - RIGHT ARM, H, I.

Attach piece **E** to piece **B** with bolts **H** and nuts **I**. Repeat for other side with piece **F**.

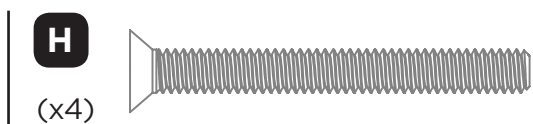

Shown at actual size

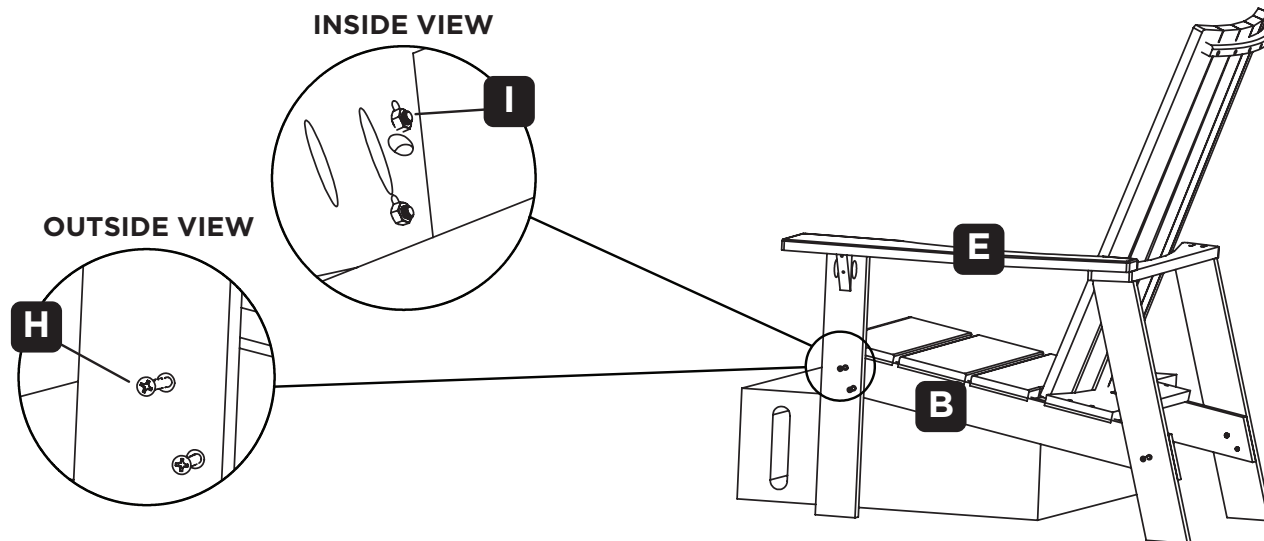

**REPEAT FOR OTHER SIDE WITH PIECE F.**

## Step 5

Requires G.

Attach pieces **E** and **F** to piece **A** using **G** screws.

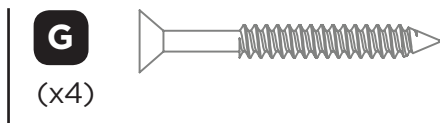

Shown at actual size

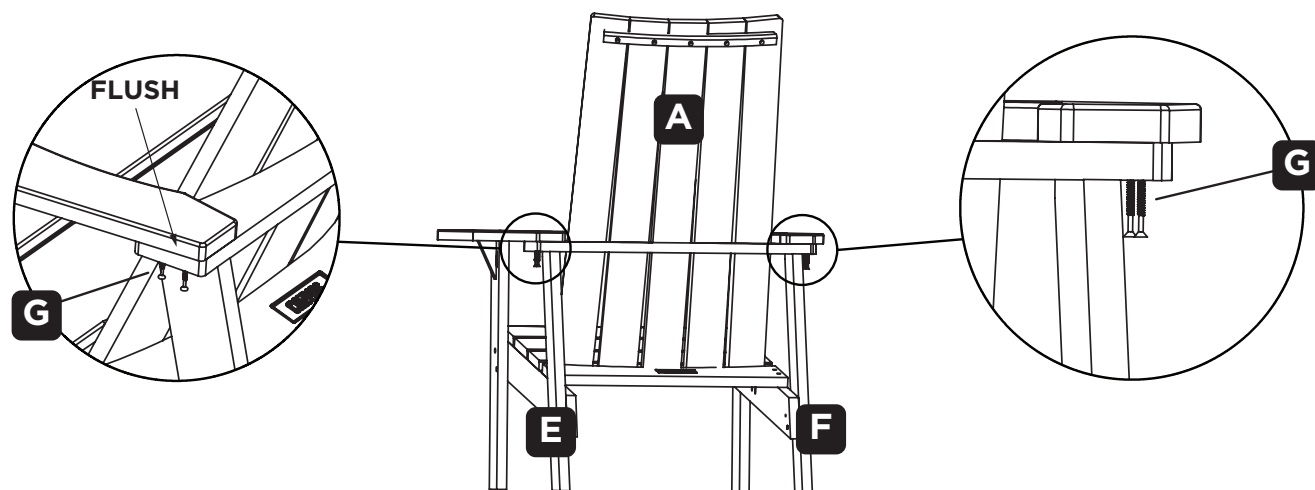

## Step 6

Requires G.

Secure piece **D** to piece **B** using **G** screw. Make sure edge of **D** is flush with **B**. Repeat for other side with piece **C**, making sure edge of **C** is flush with **B**.

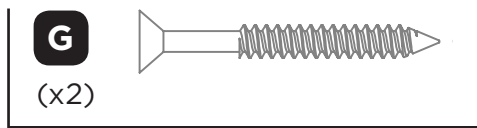

Shown at actual size

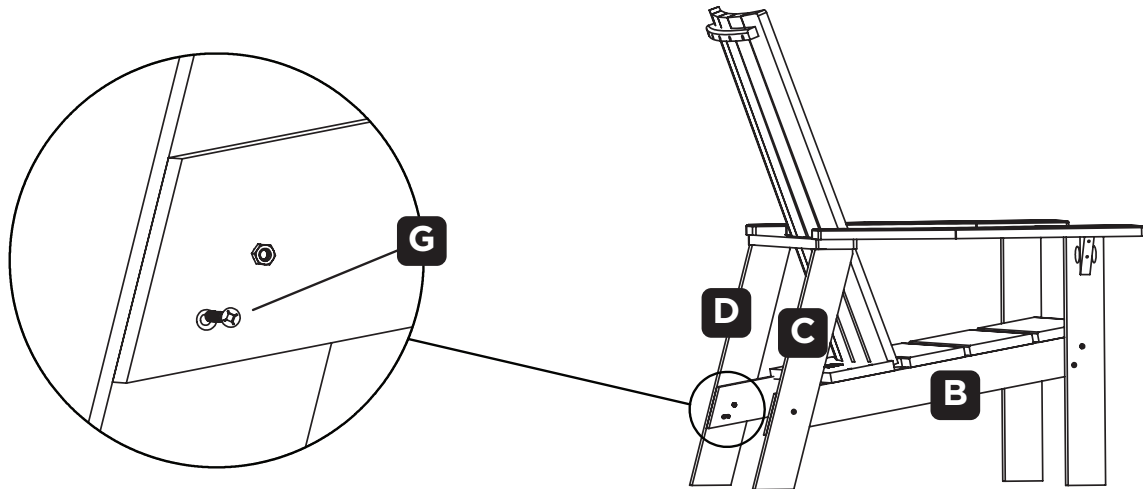

**REPEAT FOR OTHER SIDE WITH PIECE C.**

## Step 7

Make sure that the nuts and bolts are all properly tightened on both sides.

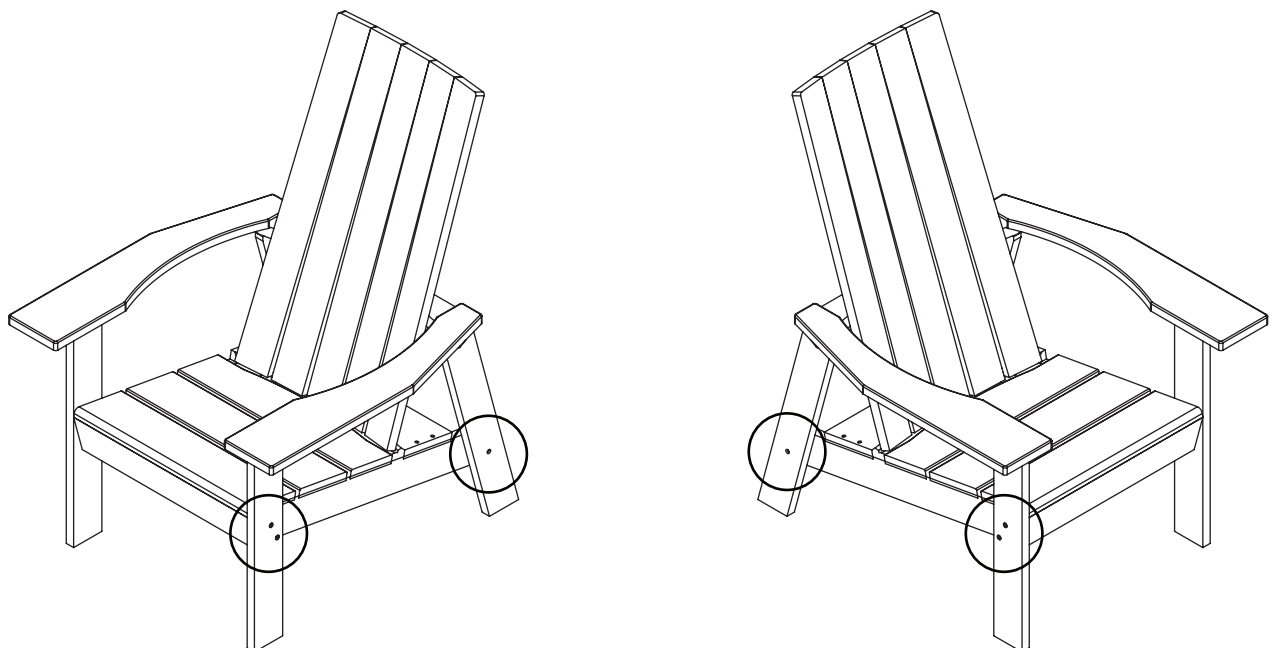

## WARRANTY

This Capterra Casual product carries a ten (10) year warranty against defects in workmanship. See Capterra Casual Full Warranty Guide for more details. This product is not guaranteed against wear or breakage due to misuse and/or abuse.

## MAINTENANCE

Clean with soapy water and sponge. Do not pressure wash.

## TECHNICAL DATA

|                        |                 |
|------------------------|-----------------|
| Dimensions (L x W x H) | 89 x 79 x 102   |
|                        | 35" x 31" x 40" |
| Product weight         | 22 kg           |
|                        | 48 lb           |

Made in Canada with domestic and imported materials.

**CAUTION: DO NOT EXCEED MAXIMUM WEIGHT CAPACITY OF 300 LB (126 KG).**