

SIDES	BOTTOM
2 PCS 6-32×3/8 Screws Installed	
Material:Steel-0.031MIN"-G60 Galvanized	

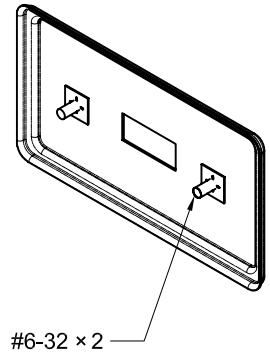
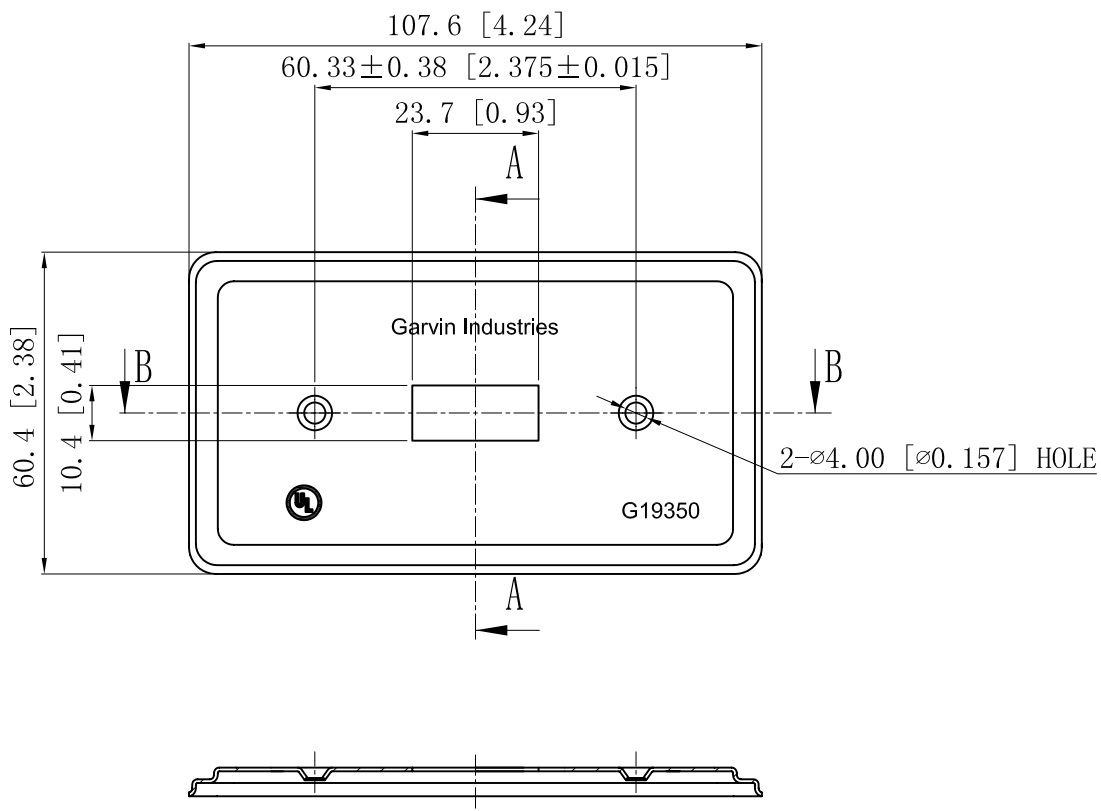
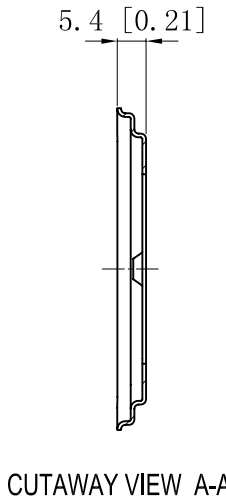

CUTAWAY VIEW B-B

This data sheet is for reference only .GARVIN INDUSTRIES reserves the right to make changes to the design without prior notice.

DESCRIPTION
TRADE REFERENCE TERMS

STANDARD PACKING
100 PCS

<b>GARVIN INDUSTRIES</b>		
TITLE HANDY UTILITY BOX COVERS		
SIZE A4	DWG NO. G19350	REV C
DATA SHEET		