

DWG. NO.		451-900-0360H	
REV	DESCRIPTION	BY DATE	APPD
A	ECR 7416	7/22/02	

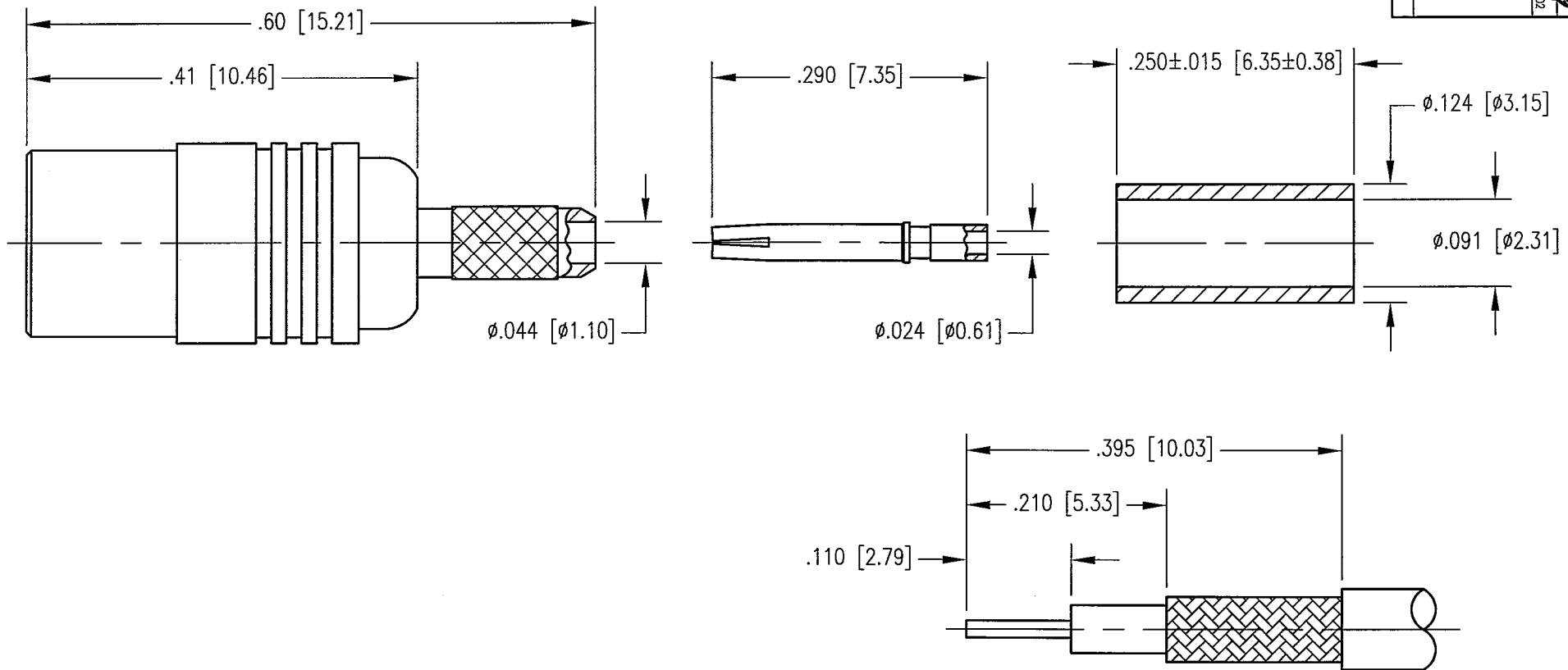

CABLE TRIMMING DIMENSIONS

NOTES:

- MATERIALS:
 BODY AND FERRULE: BRASS PER ASTM B16
 CONTACT: COPPER ALLOY
 INSULATOR: TEFLON PER ASTM D1710
- FINISH:
 BODY: .000015 MIN. GOLD PER MIL-G-45204 OVER
 .000050 MIN. NICKEL PER QQ-N-290
 CONTACT: .000030 MIN. GOLD MIL-G-45204 OVER
 .000050 MIN. NICKEL PER QQ-N-290
 FERRULE: .000005 MIN. GOLD PER MIL-G-45204 OVER
 .000050 MIN. NICKEL PER QQ-N-290
- FOR USE WITH RG-178 CABLE OR EQUIVALENT
- FOR CABLING PROCEDURE USE CAP 9-08 WITH TRIMMING DIMENSIONS SHOWN.
- CRIMP FERRULE USING .128 HEX DIE.

PER ASME Y14.5M-1994 UNLESS OTHERWISE SPECIFIED: DIMENSIONS ARE IN INCHES [MM]		NORTHROP GRUMMAN	
TOLERANCES: DECIMALS .XX ± .01 [0.254] XXX ± .005 [0.127] ANGLES ± 2°		Winchester Electronics 400 Park Road Watertown, CT 06795	
SCALE: 6:1		TITLE MCX STRAIGHT JACK	
CUSTOMER DRAWING			
DRAWN JED	DATE 12/26/97	CHECKED PAT	DATE 12/26/97
APPROVED KJT	DATE 12/26/97	APPROVED KJT	DATE 12/26/97
A		451-900-0360H	SHT. OF REV. 1 OF 1 A