

SIDES	BOTTOM
Material: Steel-Welding tube, zinc plated	

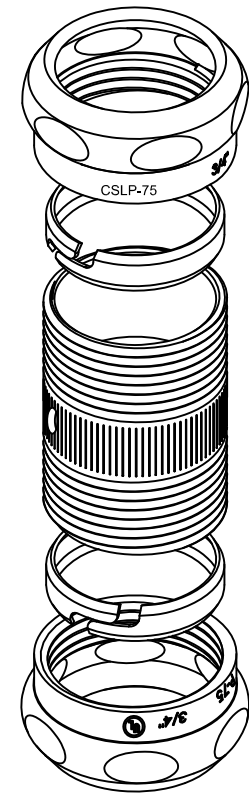
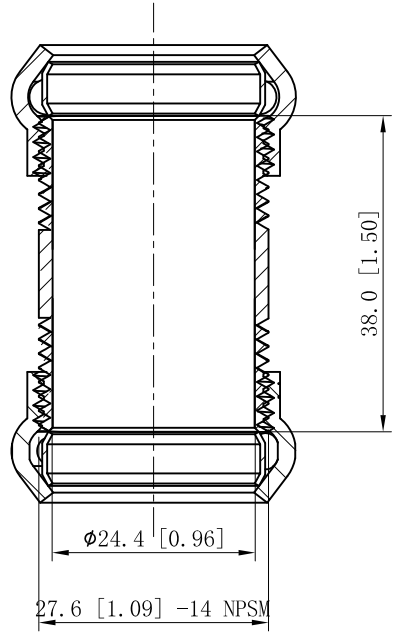
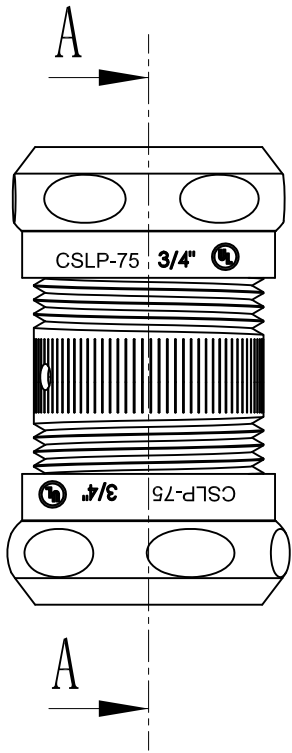

CUTAWAY VIEW A-A

This data sheet is for reference only .GARVIN INDUSTRIES reserves the right to make changes to the design without prior notice.

DESCRIPTION
TRADE REFERENCE TERMS

STANDARD PACKING	<h1 style="text-align: center;">GARVIN INDUSTRIES</h1>		
50 PCS			
	SIZE	DWG NO.	REV
	A4	CSLP-75	B
DATA SHEET			
www.garvinindustries.com			