

**INSTRUCTIONS**

1. Please count and make sure all pieces are present before assembly.
2. The pole pieces are delicate. To prevent damage, do not use excessive force.
3. Assemble crystal puzzle by putting the puzzle pieces together in the order shown below.
4. Missing a piece? Email [info@ugames.com](mailto:info@ugames.com) or call (415) 503-1600 with missing piece number.

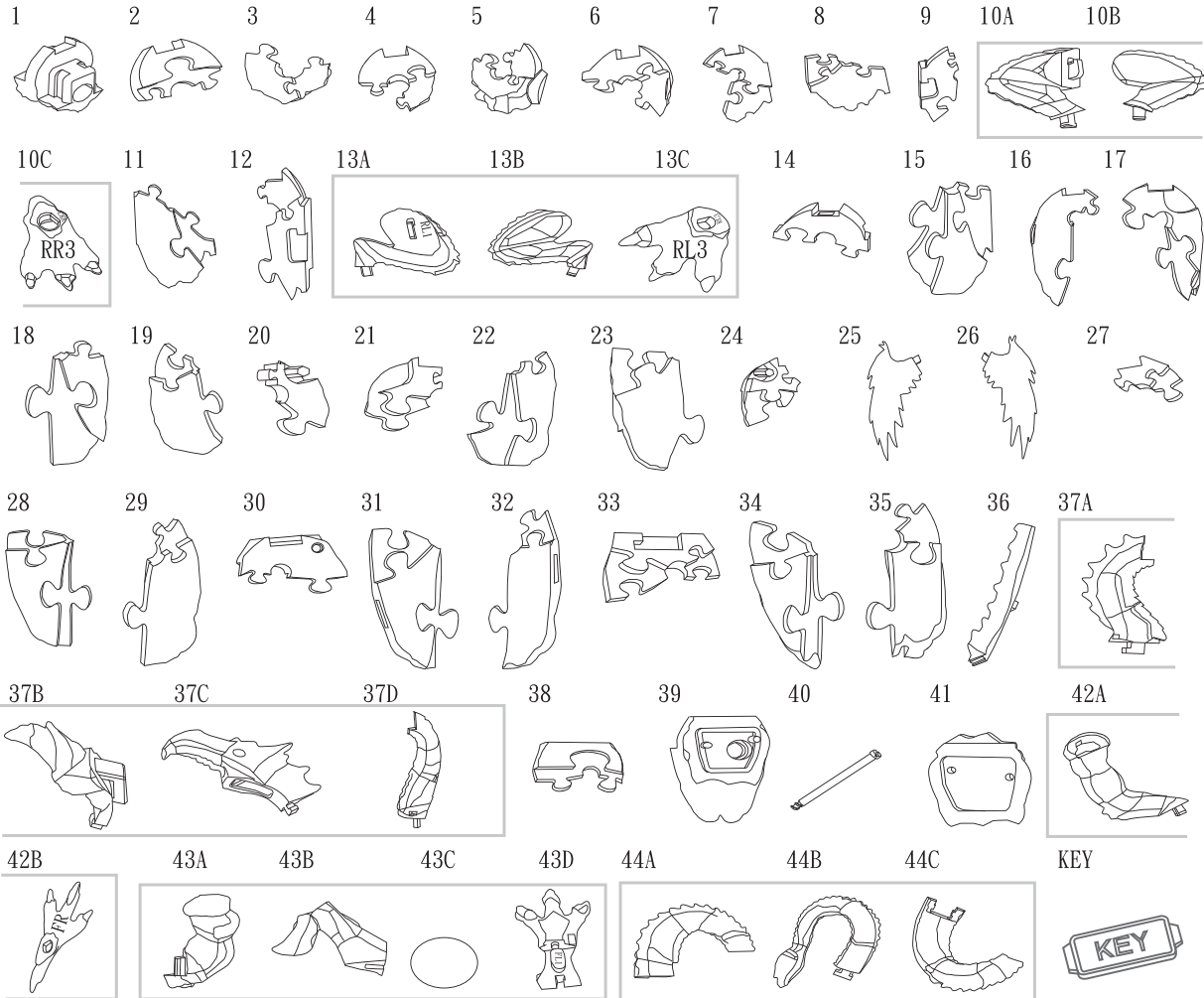

**HINTS**

**1**

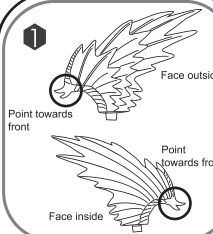

Point towards front

Face outside

Point towards front

Face inside

Make sure wings are pointed in the correct direction, as indicated above.

**2**

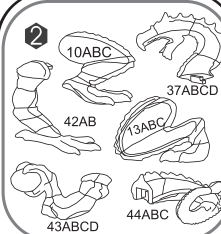

10ABC

37ABCD

42AB

13ABC

43ABCD

44ABC

Combine the head, neck, tail and legs before mounting pieces onto the body.

**3**

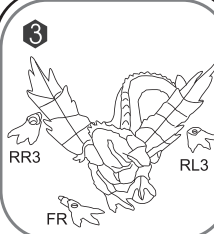

RR3

RL3

FR

Note the markings on the three legs distinguishing front, rear, left and right.

**4**

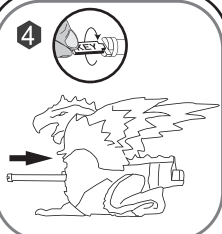

After assembling piece #39, insert center pole #40 through the front and screw it down with the screw it enclosed.

