

SIDES	BOTTOM
18 1/2"-3/4" KNOCKOUTS	
4 PCS 8-32X1/2 Screws Installed	
Material:Steel-0.0625"-G60 Galvanized	

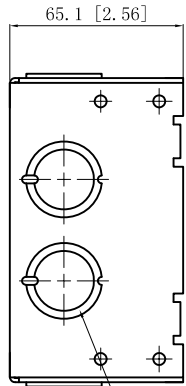

4 1/2"-3/4"KNOCKOUTS $\phi=22.50$ [$\phi=0.886$]
 $\phi=28.50$ [$\phi=1.122$] MIRROR

4-#8-32 UNC HOLE

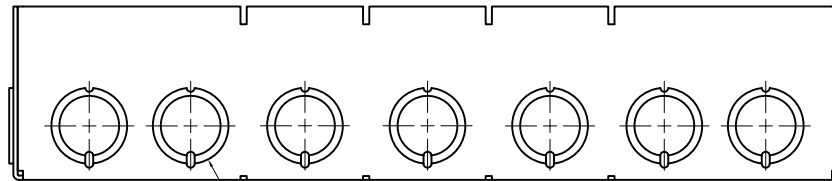
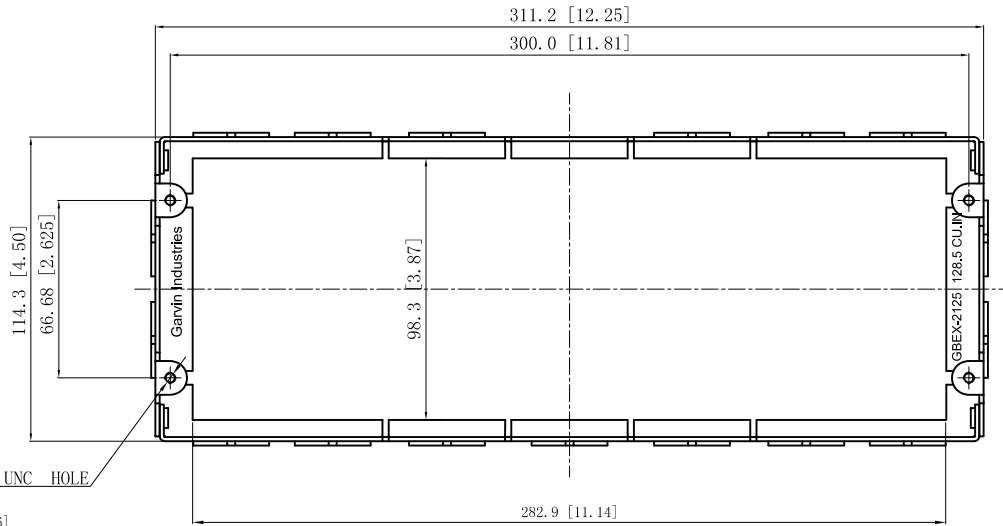

14 1/2"-3/4"KNOCKOUTS $\phi=22.50$ [$\phi=0.886$]
 $\phi=28.50$ [$\phi=1.122$] MIRROR

#8-32,x4

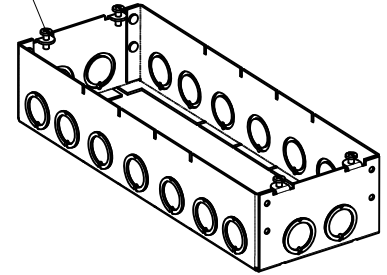

DESCRIPTION
TRADE REFERENCE TERMS

This data sheet is for reference only .GARVIN INDUSTRIES reserves the right to make changes to the design without prior notice.

STANDARD PACKING	GARVIN INDUSTRIES		
	2-1/2" DEEP MULTI-GANG BOXES		
10 PCS	TITLE		REV
	SIZE	DWG NO.	A
	A4	GBEX-2125	A
		DATA SHEET	