

IMPORTANT

Carefully remove all the parts from the carton and place them individually on a soft cloth to prevent scratches or other damage.

Carefully and strictly follow these assembly instructions to ensure a completed product as designed.

Do not use power tools above 8 volts to assemble.

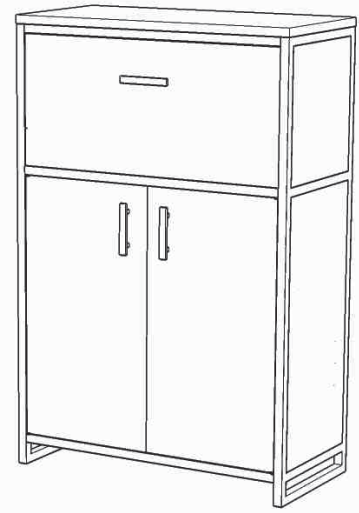

Part List



A.
Frame
1 pc.



B.
Frame
1 pc.



C.
Frame
1 pc.

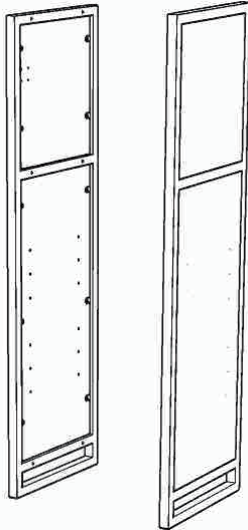

D.
Side Panel
1 pc.

E.
Side Panel
1 pc.

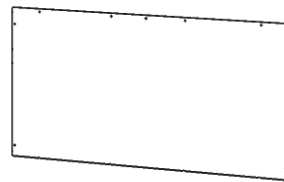

K.
Back Panel
1 pc.

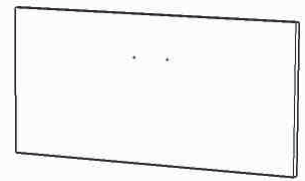

O.
Door
1 pc.

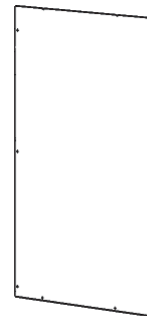

L.
Back Panel
1 pc.



M.
Strip
1 pc.

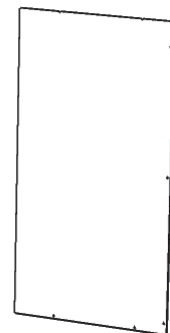

N.
Back Panel
1 pc.

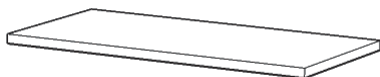

F.
Top
1 pc.



H.
Bottom
1 pc.

P.
Door
1 pc.

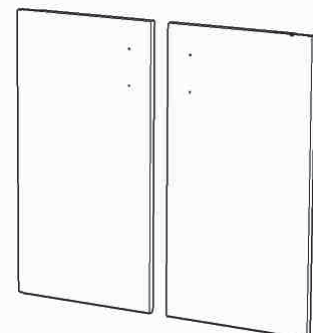

Q.
Door
1 pc.



G.
Shelf
1 pc.



I.
Shelf
2 pcs.



J.
Support
2 pcs.

Tool(s) required for assembly: Phillips screwdriver, Level

Home Styles Customer Service: www.homestyles-furniture.com,
servicedesk@homestyles-furniture.com, 888-680-7460, 877-831-0319

IMPORTANT

Carefully remove all the parts from the carton and place them individually on a soft cloth to prevent scratches or other damage.

Carefully and strictly follow these assembly instructions to ensure a completed product as designed.

Do not use power tools above 8 volts to assemble.

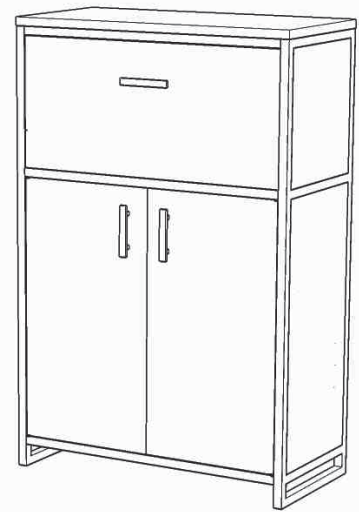
**Hardware List**

Hex Wrench
1 pc.



Small Hex Wrench
1 pc.

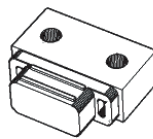

Magnet
2 pcs.



Adjustable Pin
8 pcs. (+1 extra)



M6x25
Tapered Bolt (short)
4 pcs. (+1 extra)

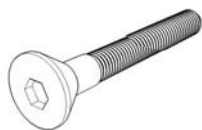

M6x38
Tapered Bolt (long)
12 pcs. (+1 extra)

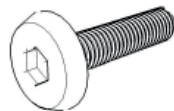

M6x16
Head Cap Bolt
14 pcs. (+1 extra)



Spring Washer
14 pcs. (+1 extra)



Flat Washer
14 pcs. (+1 extra)



M3.5x16
Wood Screw (short)
22 pcs. (+1 extra)



M3.5x28
Wood Screw (long)
6 pcs. (+1 extra)



M3x16
Hinge A, B Screw
24 pcs. (+1 extra)



M3.5x15
Hinge C Screw
24 pcs. (+1 extra)



M4x25
Machine Screw
6 pcs.

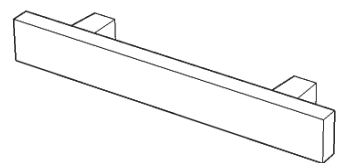

Handle
3 pcs.

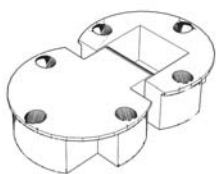

Hinge A
2 pcs.

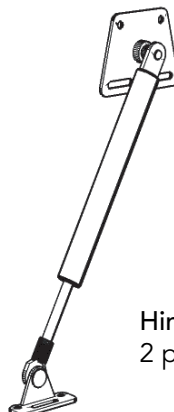

Hinge B
2 pcs.

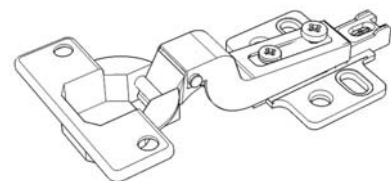

Hinge C
4 pcs.

Tool(s) required for assembly: Phillips screwdriver, Level

Home Styles Customer Service: www.homestyles-furniture.com,
servicedesk@homestyles-furniture.com, 888-680-7460, 877-831-0319

Assembly Instructions 3/9

IMPORTANT

- Use a soft cloth between these parts and the floor.
- Do not use power tools above 8 volts to assemble.
- Do not tighten all the bolts until each part is properly assembled.
- The unit must be level to work properly. Use the included adjustable levelers to level.
- Keep Hex Wrench as the bolts may need to be tightened in the future.

STEP 1

Attach Magnets to Frame (A) with Tapered Bolts (short).
(See Figure 1)

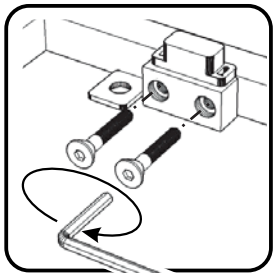
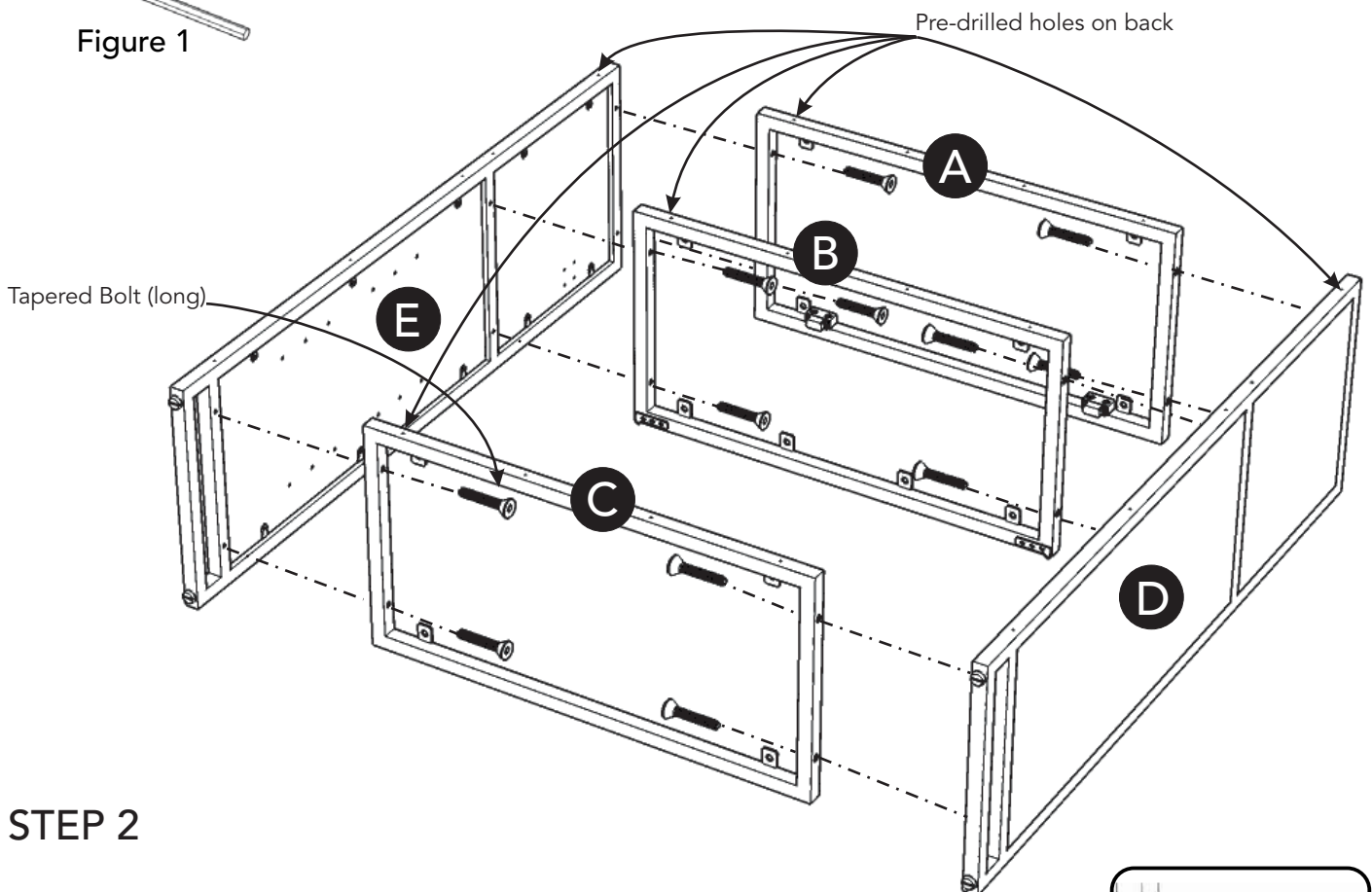
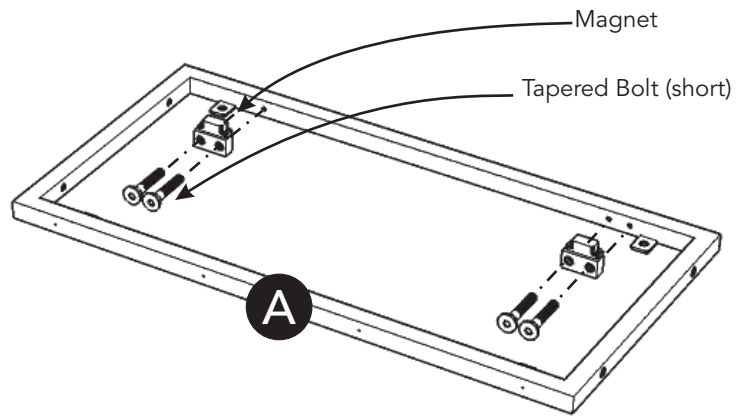

Figure 1



STEP 2

Noted: All parts in this step have pre-drilled holes on back; orientate the pre-drilled holes up during this step.

Attach Frames (A), (B) and (C) to Side Panel (D) with Tapered Bolts (long), tightening bolts only halfway. (See Figure 2)

Attach Side Panel (E) to unit with Tapered Bolts (long), tightening bolts only halfway.

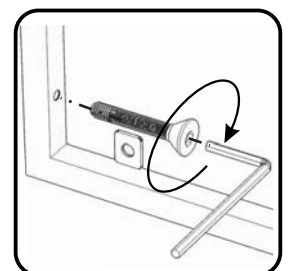

Figure 2

STEP 3

Align Frames (A), (B) and (C) flush with Side Panels (D) and (E).
(See Figure 3)

Tighten all bolts used in Step 2.

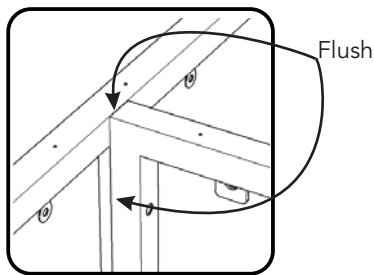

Figure 3

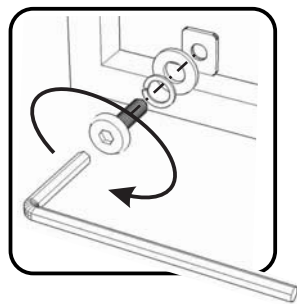
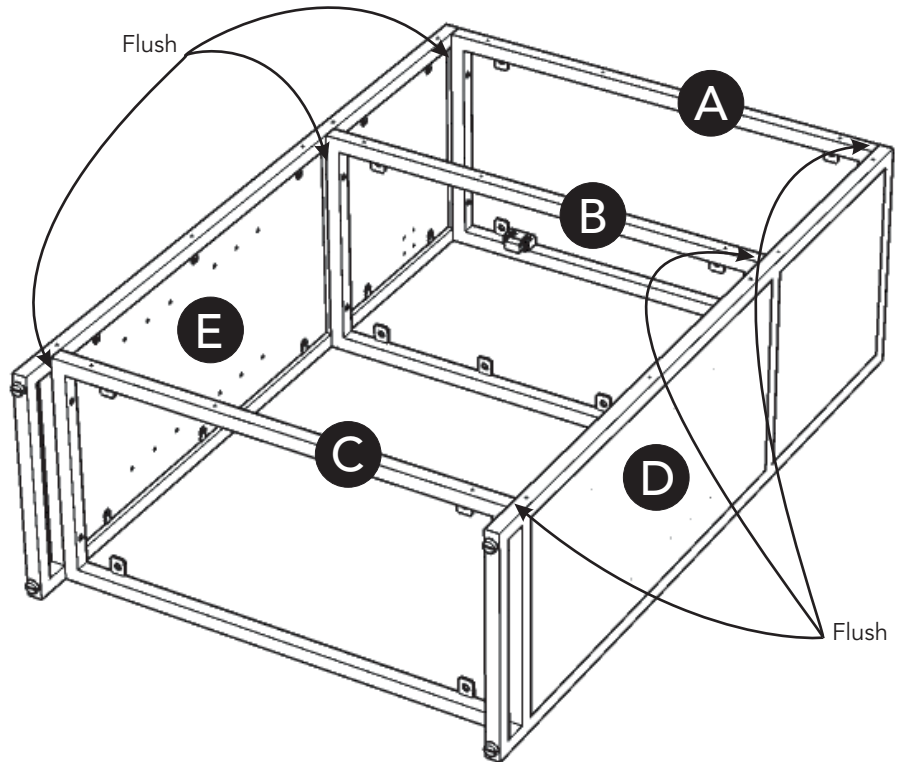
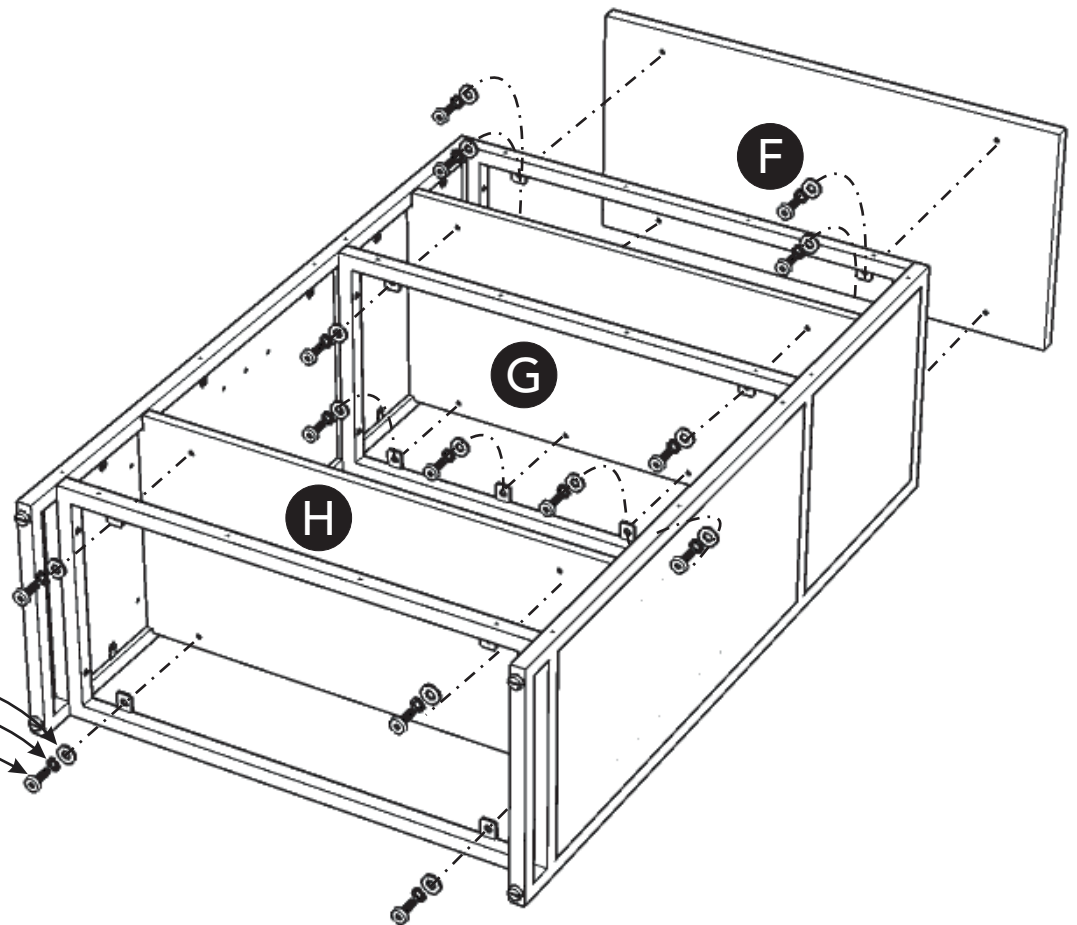

Figure 4

Flat Washer
Spring Washer
Head Cap Bolt



STEP 4

Attach Top (F), Shelf (G) and Bottom (H) to unit with Head Cap Bolts, Spring Washers and Flat Washers, tightening bolts only halfway. (See Figure 4)

Tighten all bolts used in this step.

Assembly Instructions 5/9

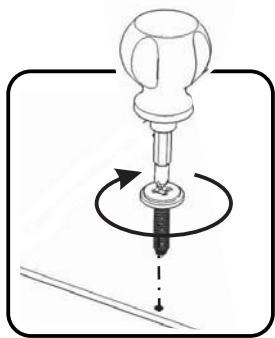
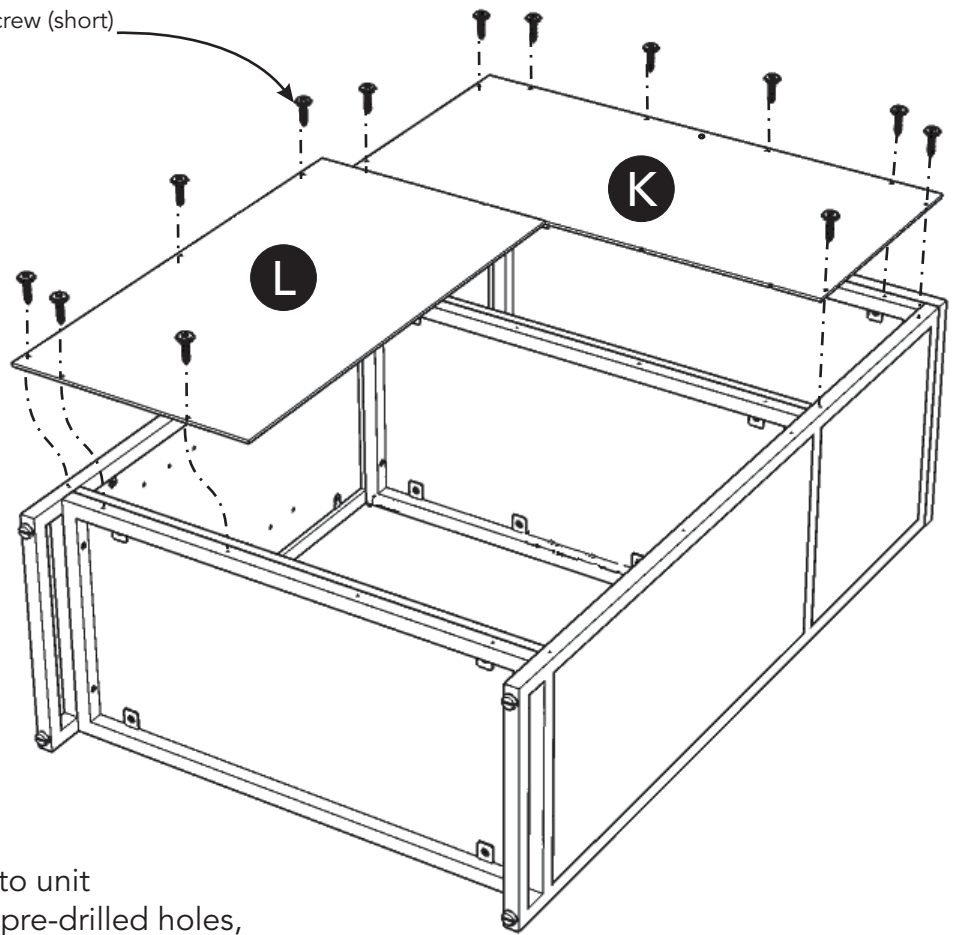

Figure 5

Wood Screw (short)



STEP 5

Attach Back Panels (K) and (L) to unit with Wood Screws (short) into pre-drilled holes, tightening screws only halfway. (See Figure 5)

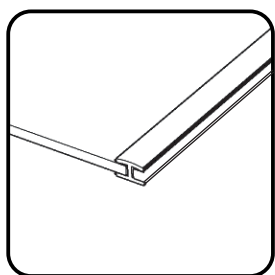
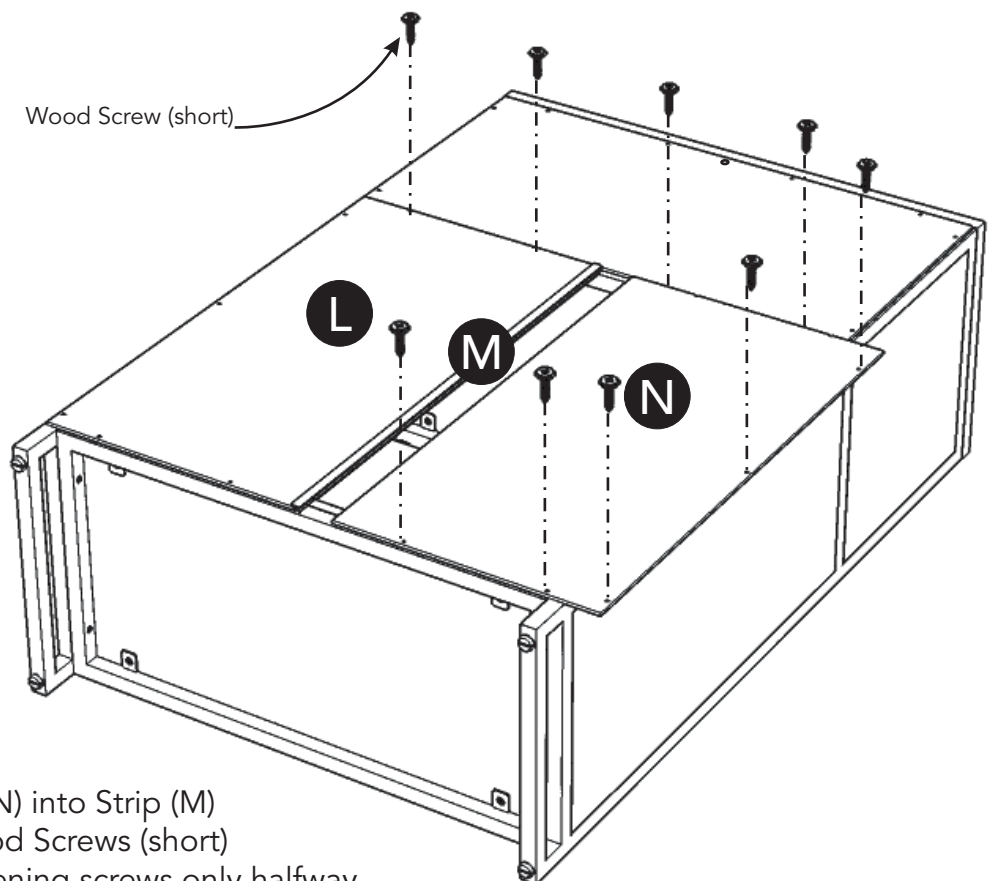

Figure 6

Wood Screw (short)



STEP 6

Attach Strip (M) to Back Panel (L). (See Figure 6)

Insert edge of Back Panel (N) into Strip (M) and attach to unit with Wood Screws (short) into pre-drilled holes, tightening screws only halfway.

Assembly Instructions 6/9

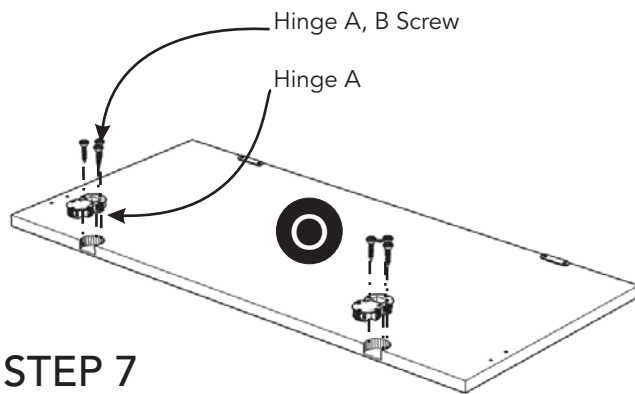

STEP 7

Attach Hinges A to Door (O) with Hinge A, B Screws. (See Figure 7)

Attach Supports (J) to Shelves (I) with Wood Screws (long) into pre-drilled holes. (See Figure 8)

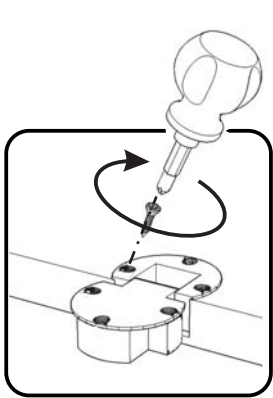
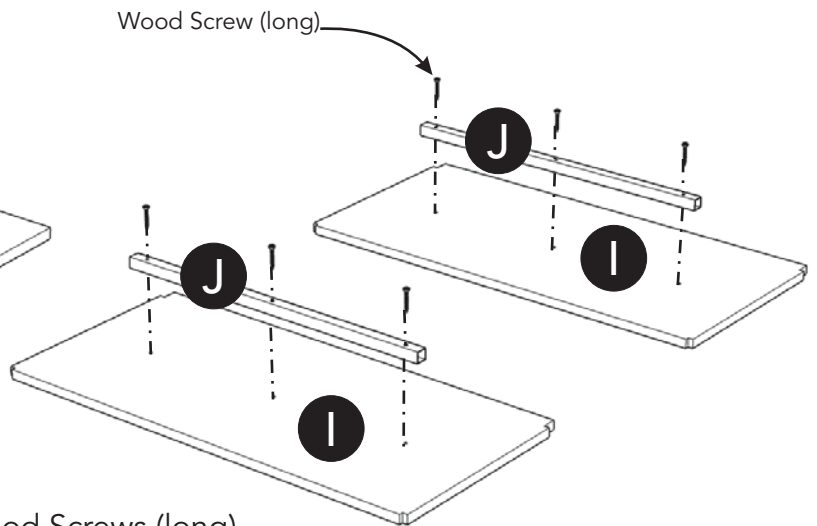

Figure 7

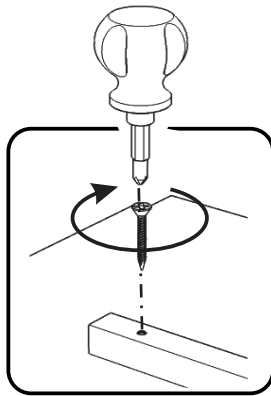

Figure 8

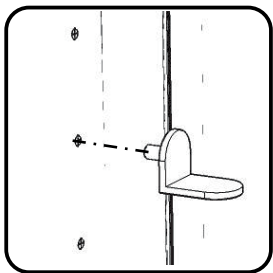

Figure 9

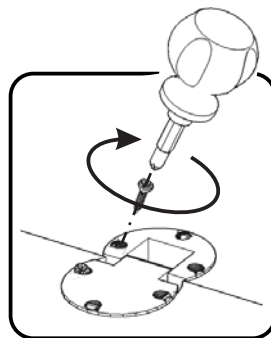

Figure 10

STEP 8

Insert Adjustable Pins into side panels at desired level. (See Figure 9)

Place Shelves (I) into position.

Attach Door (O) to unit with Hinge A, B Screws. (See Figure 10)

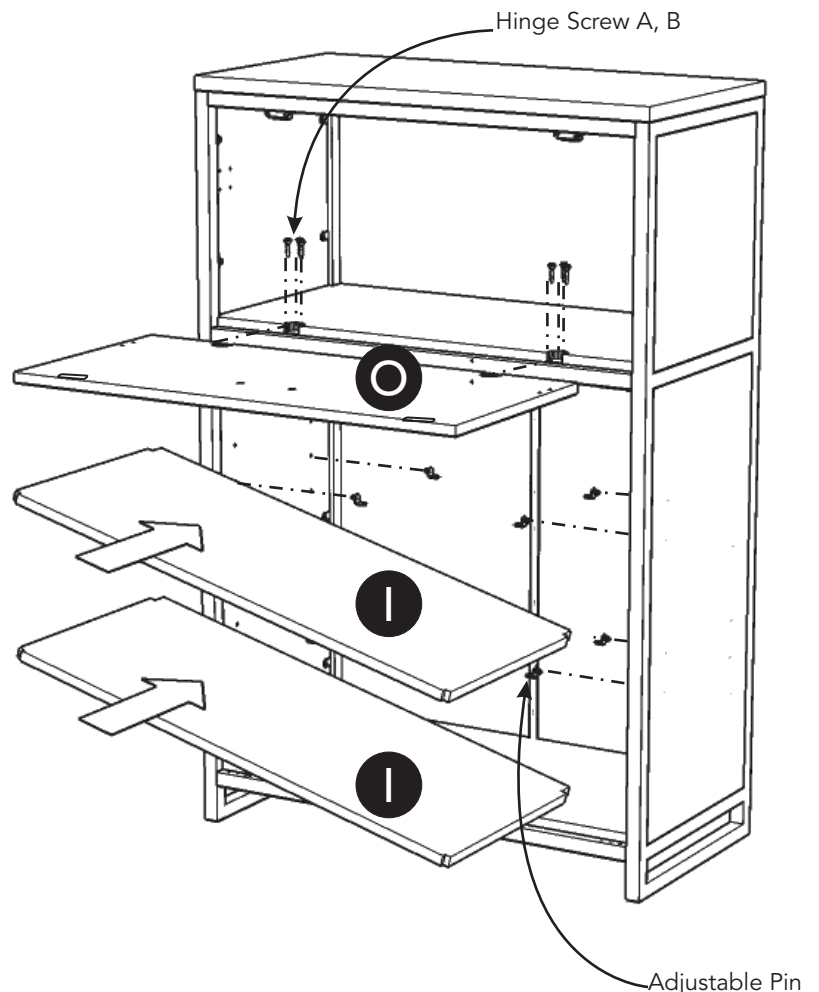

Assembly Instructions 7/9

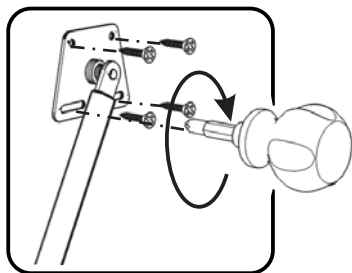

Figure 11

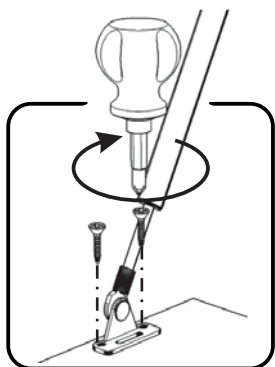
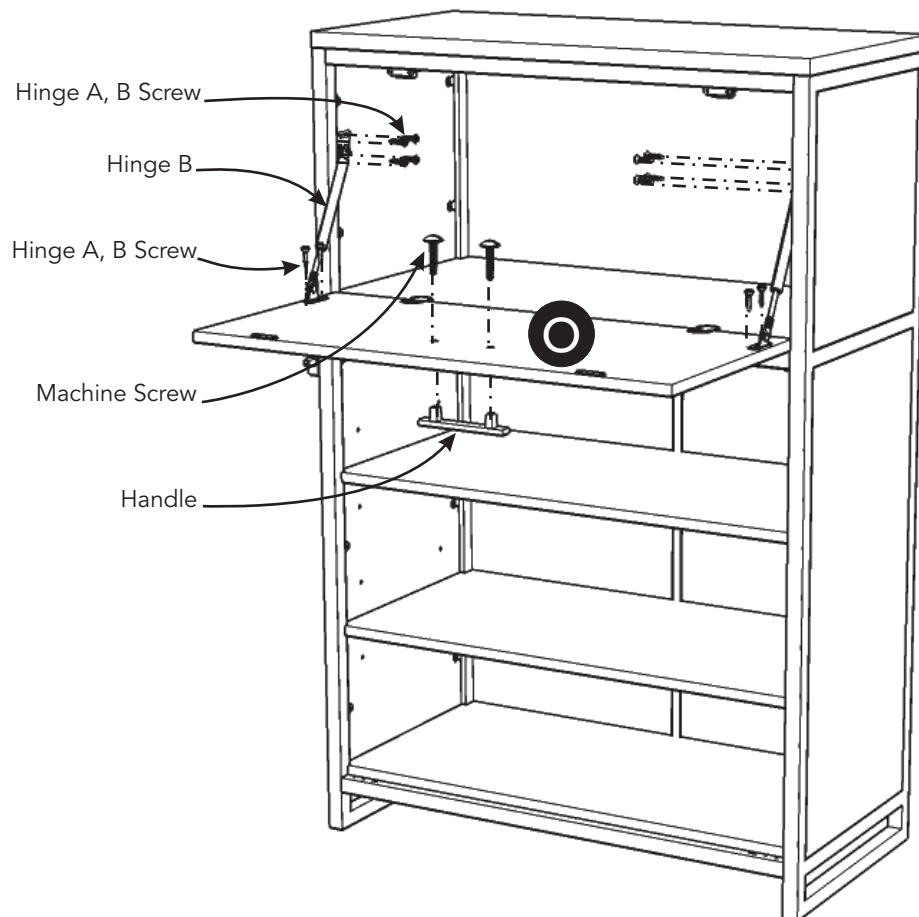

Figure 12



STEP 9

Attach Hinges B to Door (O) and side panels with Hinge A, B Screws into pre-drilled holes. (See Figures 11 and 12)

Attach Handle to Door (O) with Machine Screws.

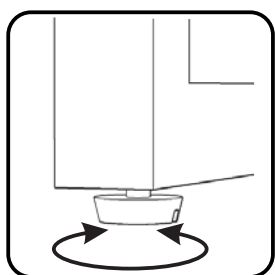

Figure 13

STEP 10

Level unit by adjusting the adjustable levelers on bottom of unit. (See Figure 13)

Note: Unit must be level to work properly.

Tighten all wood screws used in Steps 5 and 6.

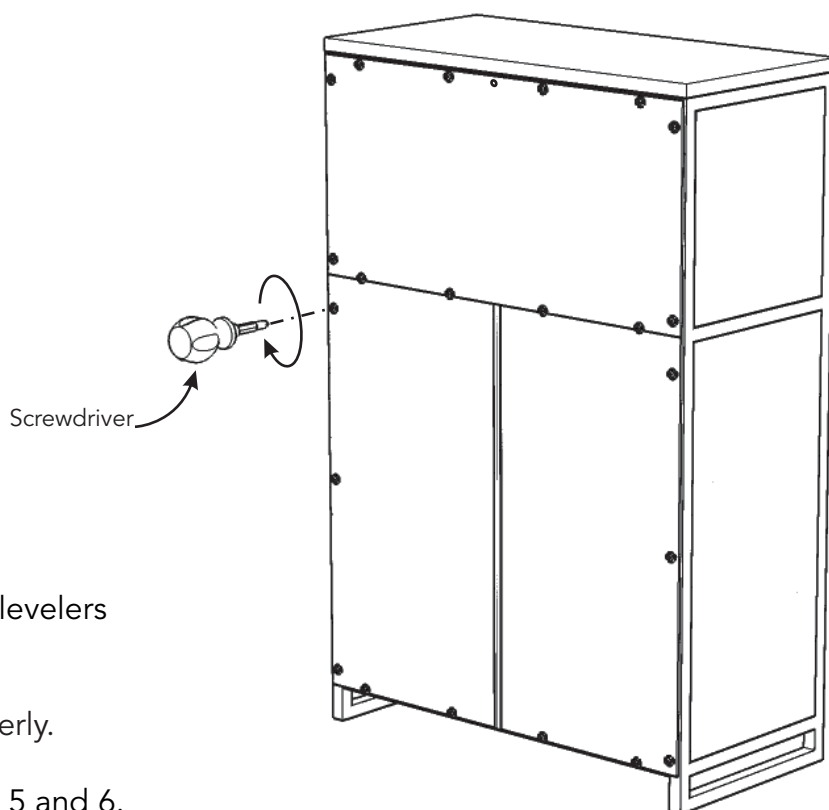

STEP 11

Attach Hinges C to side panels with Hinge C Screws into pre-drilled holes. (See Figure 14)

Attach Doors (P) and (Q) to unit with Hinge C Screws into pre-drilled holes. (See Figure 15)

Attach Handles to Doors (P) and (Q) with Machine Screws.

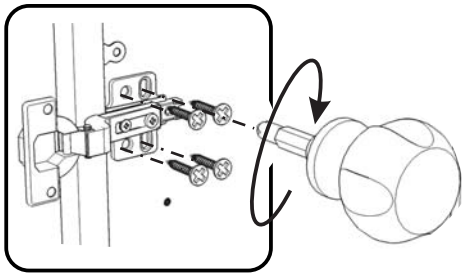

Figure 14

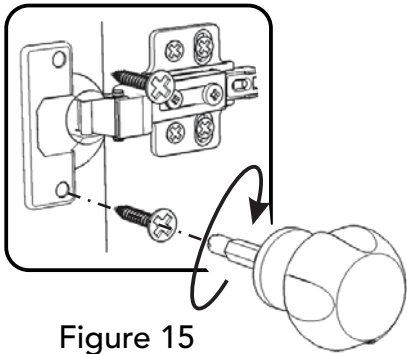
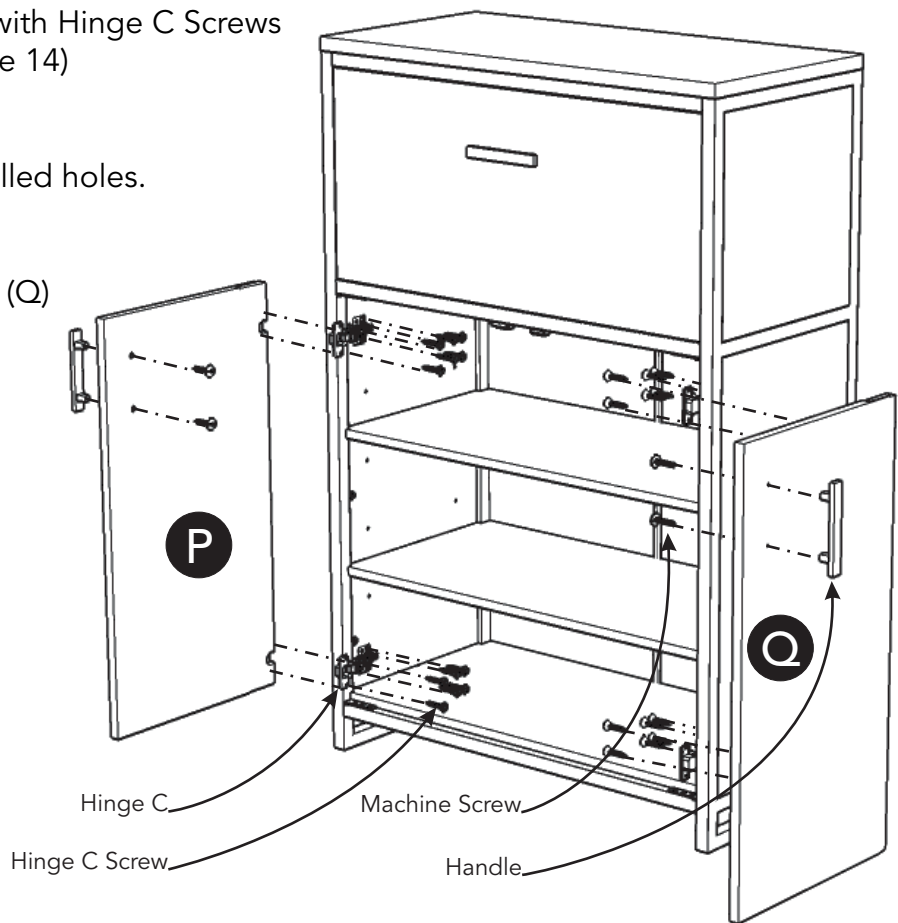

Figure 15



If needed, adjust Doors (P) and (Q) up or down by removing the front Hinge C Screws and loosening slightly the back Hinge C Screws from side panel, adjusting door up or down and re-installing screws. (See Figures 16).

If needed, adjust Doors (P) and (Q) left to right. (See Figure 17)

If needed, adjust Doors (P) and (Q) front to back. (See Figure 18)

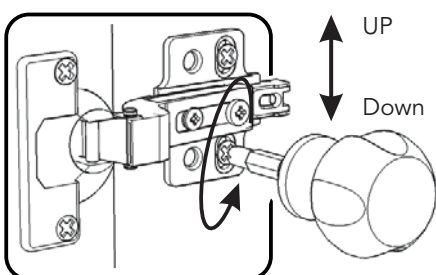

Figure 16

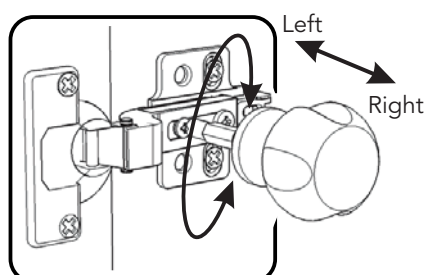

Figure 17

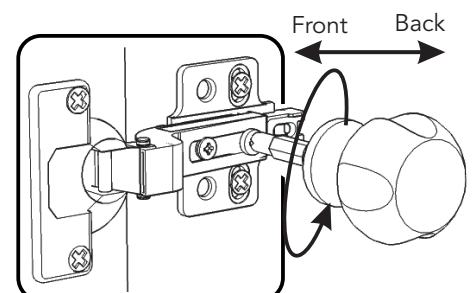

Figure 18

Assembly Instructions 9/9

IMPORTANT

- To help reduce the risk of the unit tipping over, the Tip-over Restraint must be installed following these instructions exactly.

STEP 12

Place unit at desired location.

Drill a 3/8" hole in wall in-line with the pre-drilled hole at top of unit.

Move unit.

Insert Anchor into the wall hole and attach Bracket with Wall Screw.

Attach Bracket at pre-drilled hole at top of unit with Machine Screw.

Move unit back into place.

Slide Tip-over Restraint through Bracket on wall and Bracket on unit.
(See Figure 19)

Put tie end of Tip-over Restraint into lock end of Tip-over Restraint and pull until tight.

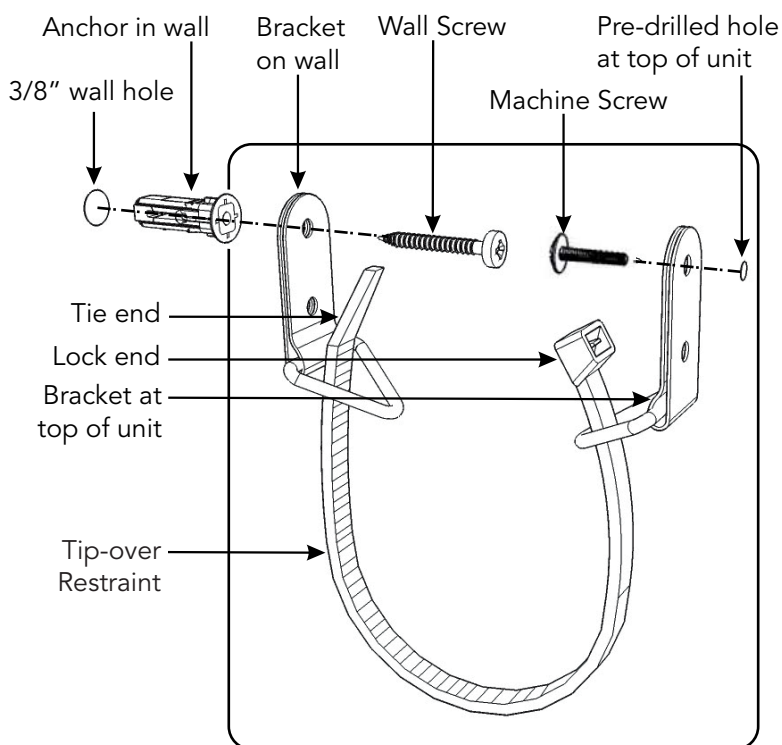
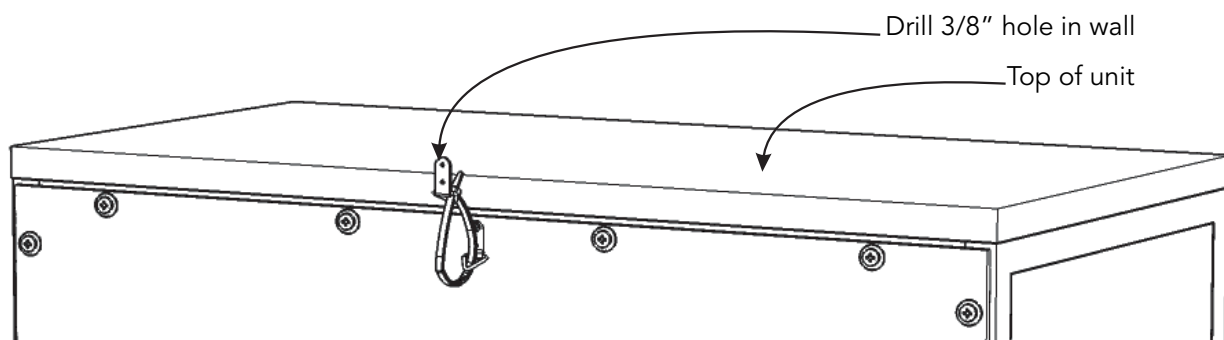
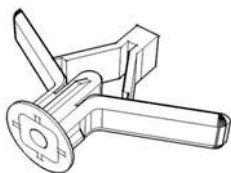

Figure 19



Hardware List



Anchor
1 pc. (+1 extra)

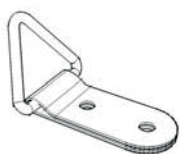

Bracket
2 pcs. (+1 extra)

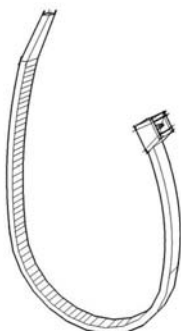

Tip-over Restraint
1 pc. (+1 extra)



M3.5x40
Wall Screw
1 pc. (+1 extra)



M4x10
Machine Screw
1 pc. (+1 extra)

CARE INSTRUCTIONS

NEVER

allow liquids to remain on furniture.
Absorption causes parts to warp
and split and finishes to delaminate.

NEVER

use glass cleaners on
finished furniture. Ammonia
chemically attacks the finish.



Do not use power tools
above 8 volts to assemble.
**PREVENT
CRACKING**

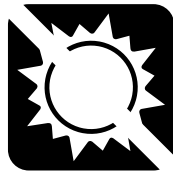

Do not place
in direct sunlight.
**PREVENT
FADING**



Do not write
directly on surface.
**PREVENT
MARKING**



Do not place hot
objects on surface.
**PREVENT
FINISH DAMAGE**

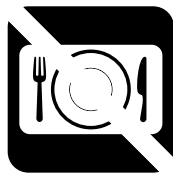

Do not use rubber
based placemats.
**PREVENT
DISCOLORING**



Do not use commercial
waxes and polishes.
**PREVENT
YELLOWING**

CLEAN

with a soft cloth moistened
in lukewarm soap and water.
Buff with a dry clean cloth.



Home Styles will provide replacements free of charge for missing or damaged hardware or parts within 30 days of purchase. Digital images of the defective parts may be required. If the product was not purchased from an authorized retail affiliate, Home Styles is under no obligation to provide replacement parts. Parts are not available for fully assembled items nor are parts available for sale. Replacements for missing or damaged hardware or parts may be requested at:

www.homestyles-furniture.com/customer-service/replacement-parts

Home Styles Customer Service: www.homestyles-furniture.com,
servicedesk@homestyles-furniture.com, 888-680-7460, 877-831-0319