

# KALLISTA®

## Handshower, Hose & Handshower Accessories

---

### INSTALLATION INSTRUCTIONS

P24443, P24445, P24446,  
P24452, P24453, P24456

## INSTALLATION INSTRUCTIONS

### THANK YOU FOR CHOOSING KALLISTA

We appreciate your commitment to KALLISTA quality products. Please take a moment to review this manual before you install your KALLISTA product. If you encounter any installation or performance problems, please do not hesitate to contact us at the phone number listed at the bottom of the page.

### BEFORE YOU BEGIN

**NOTE:** Plumbing codes may require a vacuum breaker be installed in-line to handshowers. Please consult with local plumbing codes.

- Carefully plan the location of the wall supply elbow and fixed wall bracket to avoid the possibility of the handshower hose interfering with the operation of any faucets and/or drains, etc.
- Please read all instructions before you begin.
- Observe all local plumbing and building codes.
- Shut off the water supply.
- Inspect the supply piping for damage. Replace as necessary.
- KALLISTA reserves the right to make revisions in the design of products without notice, as specified in the Price Book.

### TOOLS AND MATERIALS



Pencil



Tape Measure

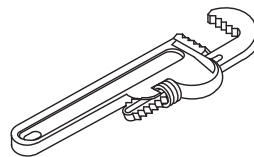

Pipe Wrench



Thread Sealant



Hex Wrench



Drill



Assorted Screwdrivers



Adjustable Wrench

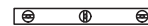

Level

## INSTALLATION INSTRUCTIONS

### 1. INSTALL THE SUPPLY ELBOW (P24452)

- Install a temporary nipple into the shower ell.
- Run water through the system to flush out dirt and debris.
- Remove temporary nipple from the shower ell.
- Apply several layers of sealant tape around the straight end of the threaded adapter.
- Install the threaded adapter into the supply elbow.

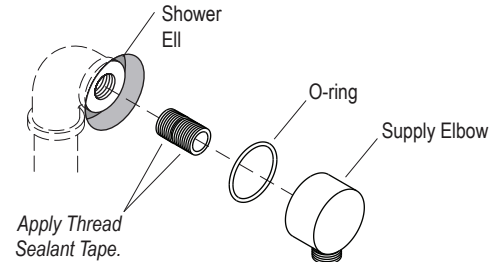

**NOTE:** A hex wrench can be used to tighten the threaded adapter.

- Apply several layers of sealant tape around the exposed tapered end of the threaded adapter.
- Install the O-ring into the back of the supply elbow.
- Thread the threaded adapter and supply elbow onto the shower ell.
- Turn on the water and allow water to flow through the supply elbow.
- Check connection for leaks. Repair as needed.

### 2. INSTALL THE FIXED WALL BRACKET (P24453)

- Determine the location for the fixed wall bracket.
- Mark the location of the holes for the wall anchors. Drill the holes and install the wall anchors.
- Attach the fixed wall bracket to the wall with the screws.

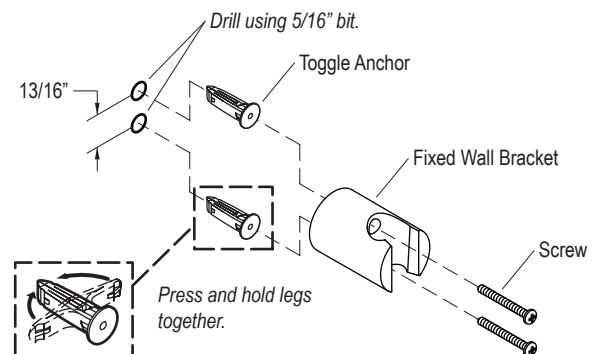

## INSTALLATION INSTRUCTIONS

## 3. INSTALL THE HANDSHOWER AND HOSE (P24443, P24445, OR P24446)

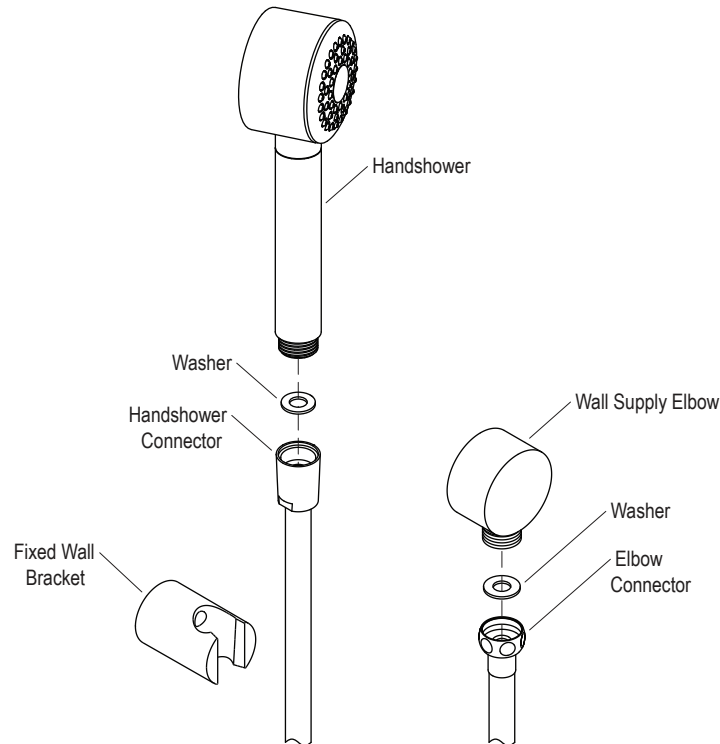

- Insert a washer into the elbow connector end of the shower hose.
- Attach the shower hose to the wall supply elbow. Run cold and hot water through the shower hose to flush out dirt and debris.
- Insert the other washer into the threads of the handshower connector.
- Thread the handshower into the shower hose. Tighten with an adjustable wrench.
- Turn on the water. Check for leaks and smooth operation.
- Place the handshower in the fixed wall bracket.

## INSTALLATION INSTRUCTIONS

### 4. INSTALL THE OPTIONAL SLIDEBAR (P24456)

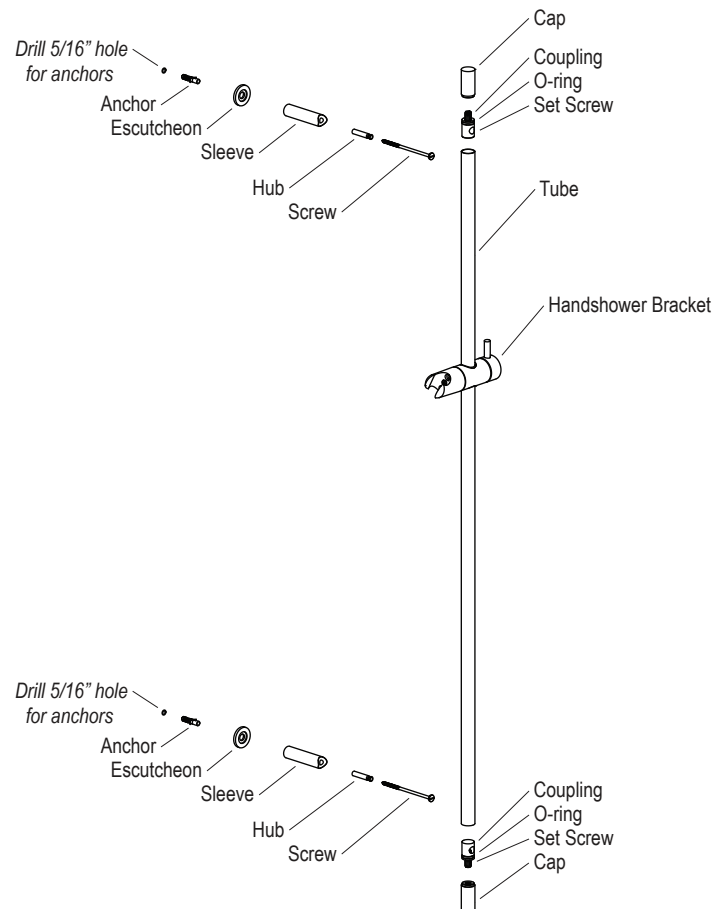

- Determine the location for the sidebar.
- Mark the location of the holes for the wall anchors. Drill the holes and install the wall anchors.
- Attach the escutcheons, sleeves, and hubs with the screws.
- Slide the handshower bracket onto the tube.
- Insert the couplings into the ends of the tube. Line up the holes in the tube with the holes in the couplings.
- Place the tube over the sleeves.
- Tighten the set screws so that they engage with the groove in the hubs.
- Screw the caps onto the exposed ends of the set screws.

## INSTALLATION INSTRUCTIONS

### 5. INSTALL THE OPTIONAL DECK-MOUNTED HANDSHOWER MOUNTING TRIM (P24456)

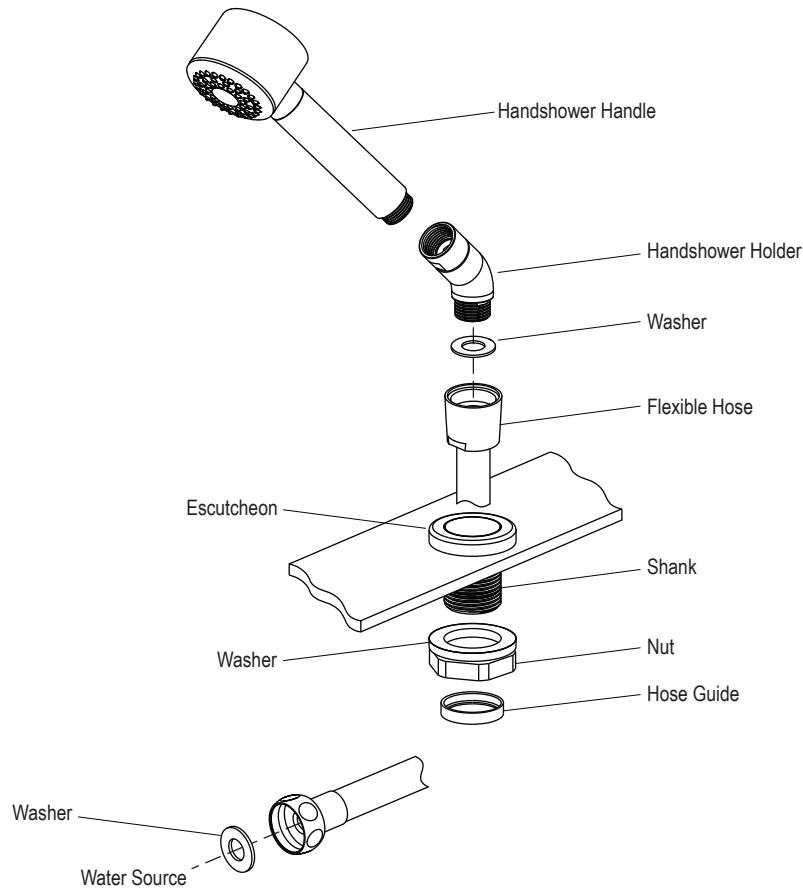

- Insert the shank through the hole of the deck. Ensure the O-ring is in the groove under the escutcheon.
- Insert the washer and thread the nut underneath the deck and tighten.
- Thread on the hose guide and hand tighten.
- From the top of the bath or finished deck, insert the smaller end of the flexible hose down through the escutcheon.
- From the underside of the bath or finished deck, insert one washer into the flexible hose.
- Tighten the flexible hose onto the water source.
- Run cold and hot water through the hoses to flush out dirt and debris.
- Insert a washer in the top end of the hose and thread on the handshower holder onto the flexible hose.
- Insert a washer into the handshower holder and thread the handshower handle into the handshower holder.
- To avoid kinking, remove any twists or loops in the hose.