



ITEM: T1-AZ056  
T1-AZ058  
T1-AZ061  
ONE PIECE TOILET  
INSTALLATION & OPERATION MANUAL  
V2.1  
07/02/2022

T1-AZ056



T1-AZ058



T1-AZ061

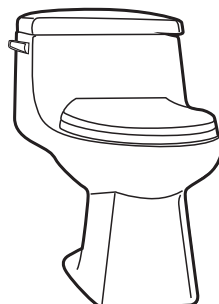

# DON'T WAIT! REGISTER NOW!

Register your product within 90 days to ensure your product is recognized as an official purchase and is eligible for warranty coverage.

Mail in the completed registry card (Pg. 2) or register online at [www.swcorp.com/register](http://www.swcorp.com/register).

# ANZZI®

## PRODUCT REGISTRATION\*

**IMPORTANT: YOUR WARRANTY WILL NOT BE RECOGNIZED UNLESS THIS CARD IS FULLY COMPLETED AND RETURNED OR ONLINE REGISTRATION IS COMPLETED.**

To ensure that your warranty is registered and confirmed please do one of the following:

1. **Register online at [www.swcorp.com/register](http://www.swcorp.com/register).** You will be asked to fill out the same information you would in the registration card. Registering online is fast, secure and ensures we receive your information.
2. **Complete, cut out and mail the registration card below.** By returning this registration card we confirm the date of purchase for your new product. This confirmation will allow us to process any warranty claims.

Mail the card to 5701 NW 35 Avenue, Miami, FL 33142



### Product Registration Card

Name..... Address .....

City..... State..... Zip.....

Phone ..... Email.....

Date of Purchase ..... Order or Purchase # ..... SKU or Model # .....

Installer's Name ..... Phone .....

I have read the Owner's Manual carefully and understand and agree that any installation, operation or maintenance of the product must be done strictly in accordance with instructions and guidelines contained in the owner's manual and installation guide.

Signature..... Date.....

Need help? For technical support call 305-614-4070 or visit us at [www.ANZZI.com](http://www.ANZZI.com)

## INSTALLATION GUIDE BEFORE YOU BEGIN

● Please check the product for damage and missing parts immediately upon delivery. Damage reported later will not be covered by our warranty. Please handle the product with care. Avoid any impact to the sides and edges of the glass.

● Consult your local plumbing & building codes prior to installation.

### **WARNING**

● Handle with care. Vitreous chinaware is glasslike with sharp edges if broken. Do not drop, handle roughly, or overtighten bolts.

## TOOLS AND MATERIALS

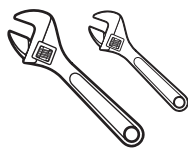

Wrench

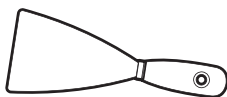

Putty Knife

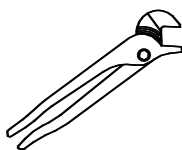

Adjustable Plier

Thank you for purchasing ANZZI TOILET. Please read and follow the installation and operation instructions carefully, to ensure the long life and reliable operation of this appliance. FAILURE TO DO SO COULD CAUSE PROPERTY DAMAGE OR SERIOUS INJURY. Please keep this manual for future reference.

## PRODUCT SIZE CHART

### T1-AZ056

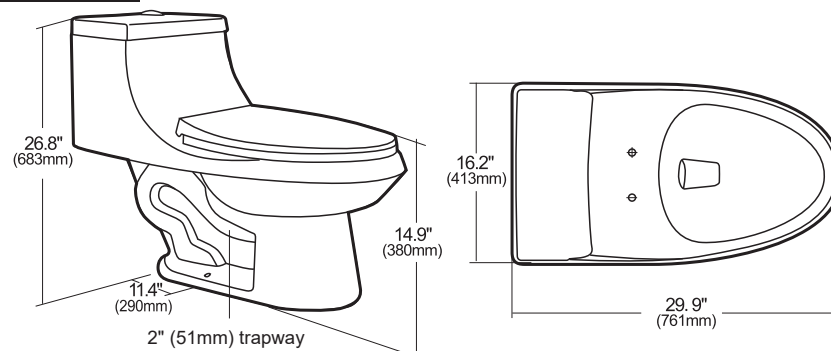

### T1-AZ058

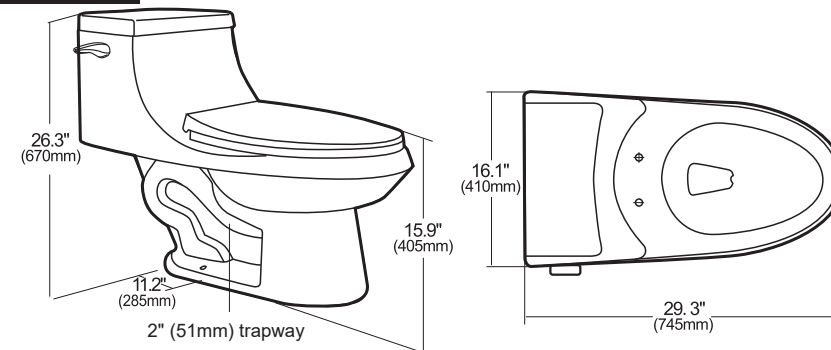

### T1-AZ061

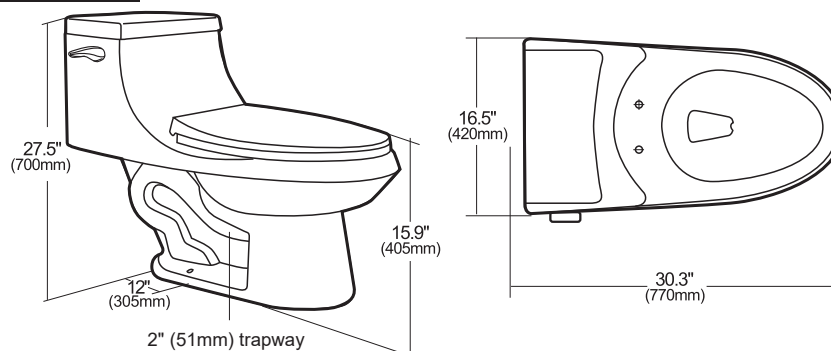

## TOILET COMPONENTS

### T1-AZ056



Part	Description	Qty.
[01]	Seat with Lid	1
[02]	Dual Flush Button	1
[03]	Bolt Cap	2
[04]	Gasket	2
[05]	Lock Bolt	2
[06]	Lock Nut	2
[07]	Washer	2
[08]	Gasket	2
[09]	Cover	2
[10]	Seat Gasket	2
[11]	Cover	1
[12]	Toilet	1

### T1-AZ058 & T1-AZ061

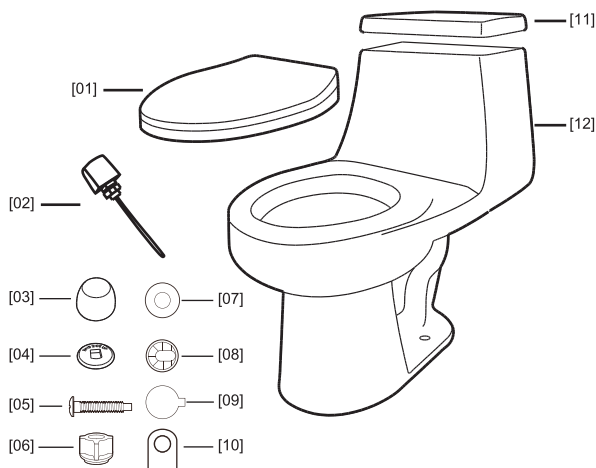

Part	Description	Qty.
[01]	Seat with Lid	1
[02]	Flush Handle	1
[03]	Bolt Cap	2
[04]	Gasket	2
[05]	Lock Bolt	2
[06]	Lock Nut	2
[07]	Washer	2
[08]	Gasket	2
[09]	Cover	2
[10]	Seat Gasket	2
[11]	Cover	1
[12]	Toilet	1

## TOILET INSTALLATION

### ⚠ ATTENTION

- To avoid personal injury or property damage, identify components and read all instructions before installing.
- Follow the instructions below to remove your old toilet and install ANZZI TOILET. Toilet Flange, Toilet Wax Ring and Toilet Bolts are not provided. You may need to buy them for new installation.

### 1

- Turn off the water supply and flush the tank completely. Remove remaining water from tank and bowl with towel or sponge.
- Disconnect and remove the old water supply line.
- Remove the bowl from the floor by removing the bolt caps and the floor bolt nuts.
- Temporarily plug the floor flange with a towel or cover to block sewer gases from escaping.

NOTE: The mounting surface should be clean and level before the new toilet is installed.

### 2

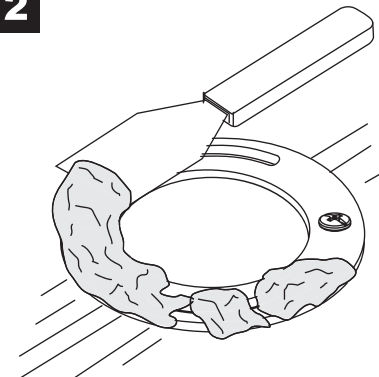

Remove existing bolts and wax (if necessary).

### 3

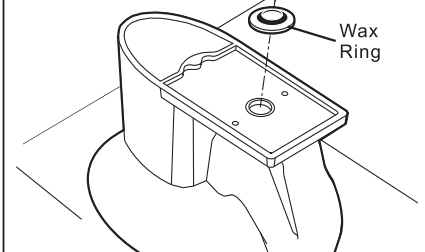

Install Wax Ring (not provided).

# INSTALLATION

4

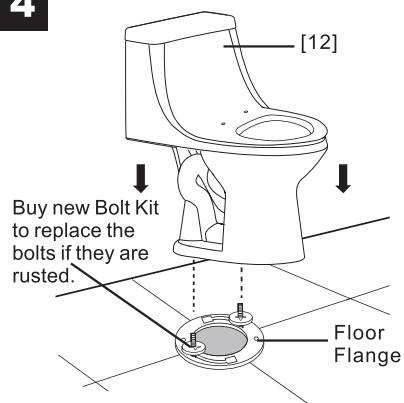

Position **Toilet [12]** on Floor Flange. Make sure the bolts go through the holes of the **Toilet [12]**. Attention: Do not shake the toilet back and forth as this may damage the seal.

5

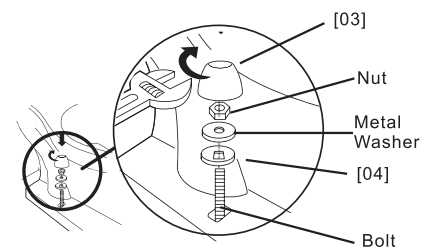

Slide **Gasket [04]** and **Metal Washer** (not provided) onto the **Bolt**. Tighten the **NUT** (not provided) to secure. **DO NOT OVER TIGHTEN!** Cover the **Bolt** with **Bolt Cap [03]**. Attention: Pour water into bowl to prevent the escape of sewer gas. Make sure the **Gasket [04]** with mark "This side up" faces upward.

6

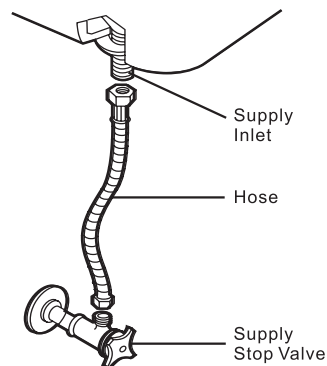

- Connect the **Hose** (not provided) to the **Supply Inlet** of the toilet and the **Supply Stop Valve**.
- Tighten the tank connection coupling nut 1/4 turn beyond hand tight.
- Turn on the **Supply Stop Valve** and allow the tank portion of the **Toilet [12]** to fill.
- Check for leakage at all connections. Tighten if necessary. **DO NOT OVER TIGHTEN.**

7

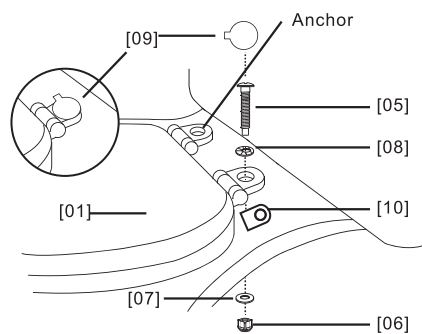

Position the **Seat with Lid [01]** onto the **Toilet [12]** with **Seat Gasket [10]** under the **Anchors**. Install the **Lock Bolt [05]** through the **Gasket [08]** and the **Anchors**. Slide the **Washer [07]** onto the **Lock Bolt [05]** under the **Toilet [12]** and secure by tightening **Lock Nuts [06]**. Do not over-tighten.

# INSTALLATION

8-1

## DUAL FLUSH BUTTON INSTALLATION

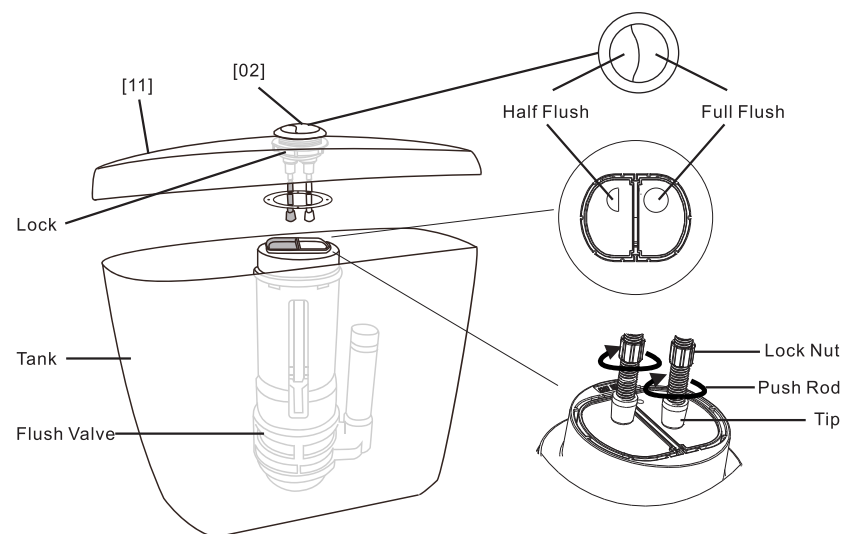

- Install the **Dual Flush Button [02]** to **Cover [11]** so that **Half Flush Button** will align with **left button (half flush)** on top of the **Flush Valve** and **Full Flush Button** aligns with the **right button (full flush)**.
- Secure the **Dual Flush Button [02]** in the **Cover [11]** by hand tightening the **Lock Nuts**.
- The **Tips** on the bottom of the **Push Rods** leading from the **Dual Flush Button [02]** should lightly touch the top of the buttons on the **Flush Valve**.
- To increase the **Push Rod** length, turn the **Push Rod Lock Nut** clockwise to loosen, then rotate the **Push Rod** clockwise to increase exposed length. When the desired length is achieved, hold the **Push Rod** and turn the **Push Rod Lock Nut** counterclockwise, until it is tightened.

INSTALLATION

8-2 FLUSH HANDLE INSTALLATION

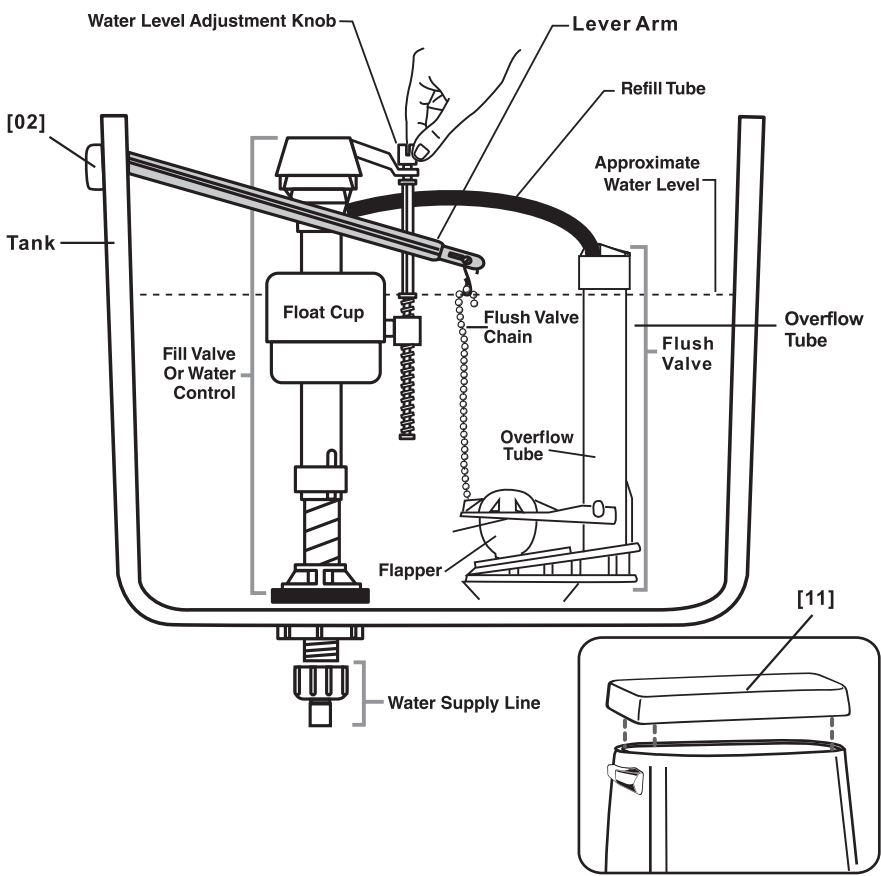

- a. Install the **Flush Handle [02]** in the hole on the left of Tank as the picture shows. Connect the Chain to the end of the Lever Arm. Adjust the length of the Chain so that it can pull up the Flapper when pushing down the **Flush Handle [02]** and Flapper can close when releasing the **Flush Handle [02]**.
- b. Adjust water level in Tank by turning Water Level Adjustment Knob to move Float Cup up or down.  
  
Notice: Water level should be lower than the top of Overflow Tube.
- c. Gently place the **Cover [11]** onto the top of the Tank to finish the installation.

CLEANING and MAINTENANCE

When cleaning your toilet, wash it with mild, soapy water, rinse thoroughly with clear water and dry with a soft cloth. Avoid detergents, disinfectants, or cleaning products in aerosol cans. NEVER use abrasive scouring powders or abrasive pads on your toilet seat. Some bathroom chemicals and cosmetics may damage the seat's finish.

ATTENTION: Do not use in-tank cleaners. Products containing chlorine (calcium hypochlorite) can seriously damage fittings in the tank. This damage can cause leakage and property damage. ANZZI shall not be responsible or liable for any tank fitting damage caused by the use of cleaners containing chlorine (calcium hypochlorite).

TROUBLE SHOOTING

Symptoms	Probable Causes	Trouble Shooting
Poor flush.	Supply Stop Valve is not fully open.	Open the Supply Stop Valve
Toilet discharges water continuously	The Push Rods of Dual Flush Button are too long or the Chain connecting to the Lever Arm is too short	Adjust the length of Dual Flush Button Push Rods or Chain
Excessive noise when tank is filling.	Flush Valve is blocked	Remove dirt or obstruction from the valve head. Flush the lines.

