

REV	DESCRIPTION	BY DATE	APPD
A	ECR 7153	JNH 12/11/01	<i>[Signature]</i>

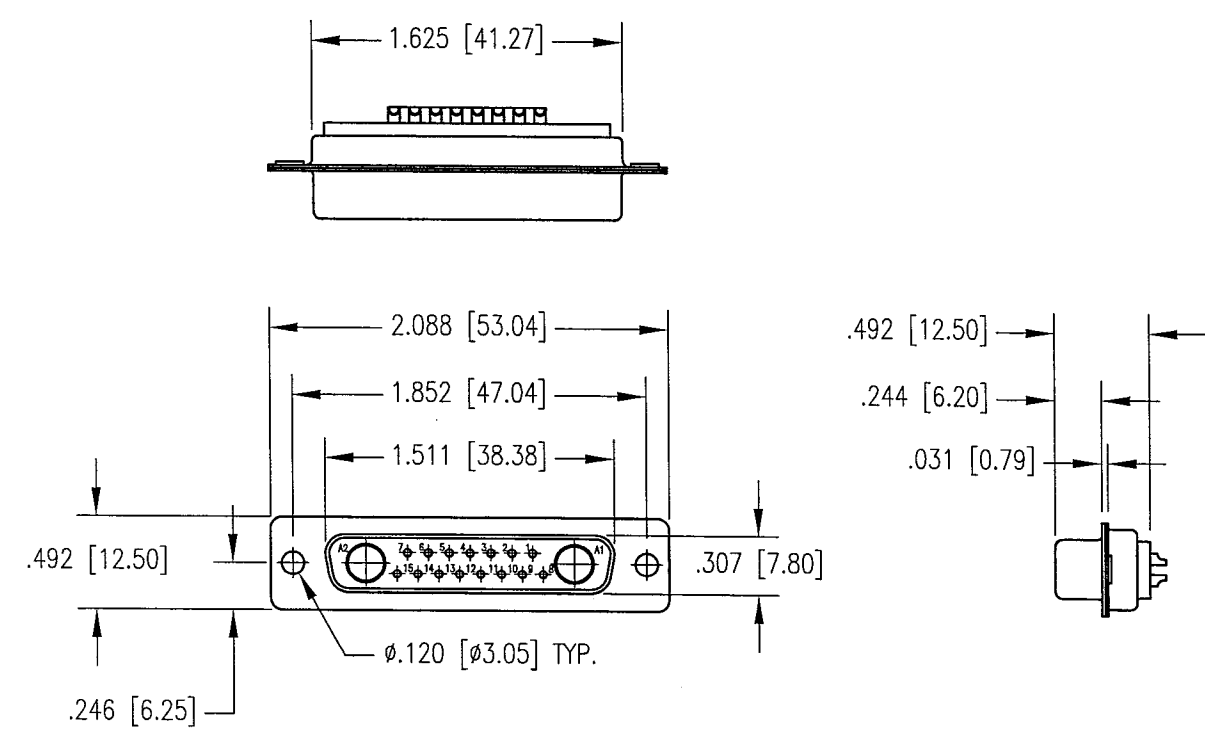

NOTES:

- MATERIALS:
SHELL: STEEL PER ASTM A568
INSULATOR: GLASS FILLED POLYESTER
CONTACTS: COPPER ALLOY
- FINISH:
SHELL: TIN PLATED PER ASTM B545
INSULATOR: GREEN
CONTACTS: .000030 MIN. GOLD PER MIL-G-45204 OVER
.000050 MIN. NICKEL PER QQ-N-290

PER ASME Y14.5M-1994 UNLESS OTHERWISE SPECIFIED: DIMENSIONS ARE IN INCHES [MM]				Litton Winchester/Retconn 400 Park Road Watertown, Connecticut 06795	
TOLERANCES: DECIMALS .XX ± .01/0.254 .XXX ± .005/0.127 ANGLES ± 2° SCALE: 1:1				TITLE 17W2S D-SUB CONNECTOR	
CUSTOMER DRAWING					
DRAWN JNH	DATE 12/11/01	CHECKED <i>[Signature]</i>	DATE 12/11/01	SH. OF 1 1	REV. A
APPROVED <i>[Signature]</i> 12/11/01				APPROVED <i>[Signature]</i> 12/11/01	
A				RM17W2S-50-TB	