



Birth-  
25 lbs

# SURE COMFORT<sup>®</sup> collapsible tub

Two-position collapsible baby bathtub

Y7939

## Instructions



## ⚠️ WARNING

**Drowning Hazard:** Babies have **drowned** while using infant bath tubs.

### To prevent drowning:

- **Stay in arm's reach** of your baby.
- **Never** rely on a toddler or preschooler to help your baby or alert you to trouble. Babies have drowned even with other children in or near bath tub.
- Babies can drown in as little as **1 inch** of water. Use as little water as possible to bathe your baby.
- Use in **empty** adult tub or shower floor.
- Keep drain **open** in adult tub or shower floor.
- Always remain in contact with your child.
- Never leave your baby unattended in the bath, even for a few moments. If you need to leave the room, take the baby with you.

**Fall Hazard:** Babies have suffered **head injuries** falling from infant bath tubs.

### To prevent falls:

- Place tub **only** in adult tub or shower floor.
- **Never** lift or carry baby in tub.
- **Always** use this product on a level surface.
- **Never** use the tub on a raised surface. Always keep the drain open in an adult bathtub when using the tub.

## CLEANING & CARE

- Before first use and after each use, fully drain the tub, clean the tub with a soft cloth using warm water and mild soap. Dry with soft towel or hang to dry using hook.
- Before each use, inspect the tub to be sure that all parts are correctly positioned and locked.
- Discontinue use of the product if it becomes damaged, broken, or disassembled.

## IMPORTANT! READ CAREFULLY AND KEEP FOR FUTURE REFERENCE. WARNING - DROWNING HAZARD

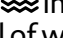
- Children have drowned while bathing.
- Children can drown in as little as 2 cm of water in a very short time.
- Always remain in contact with your child during bathing.
- Never leave your baby unattended in the bath, even for a few moments. If you need to leave the room, take the baby with you.
- Babies and young children are at risk of drowning when being bathed.
- Never use this product on any elevated surface (except free-standing within an adults bath or shower floor).
- To avoid scalding by hot water, position the product in such a way to prevent the child from reaching the source of water.
- Always check the water temperature before bathing the child.
- Always check the stability of the product before use.
- Do not use the product if any components are broken or missing.
- Do not use replacement parts or accessories other than those approved by the manufacturer.
- For an infant in the reclined position (narrow end of tub) - this function can be used up to when your child can sit unaided.
- For an infant in the seated position (wider end of tub) - this function can only be used when your child is able to sit unaided and up to when your child tries to stand up by itself.
- The symbol  $\text{MAX}$   inside the bath indicates the maximum level of water to be used.
- Not suitable for use with any other bathing aid (e.g. bath seat or stand)

## INSTRUCTIONS:

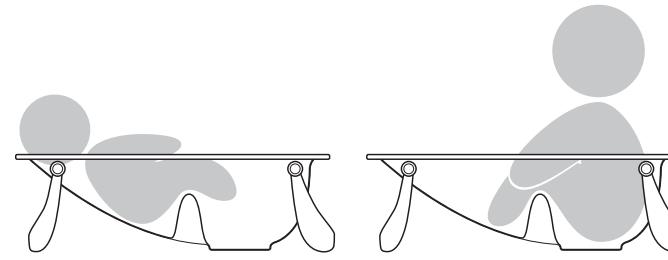

The narrow end of the tub is intended for newborns in a reclined position.

The wider end of the tub is intended for babies who are able to sit upright unassisted.

**NOTE** The tub was designed with a large range of children in mind. If you find your child slipping in the recline position, it may be beneficial to place a small towel or sponge at the bottom of the tub.

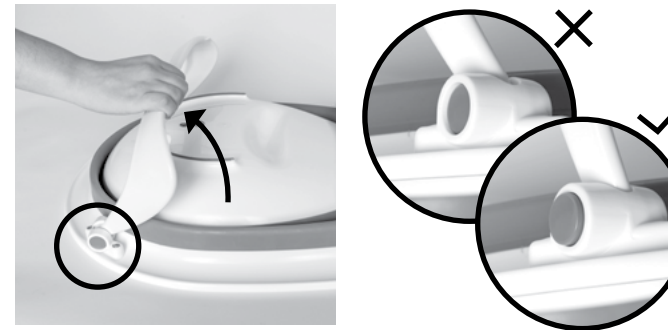

1. Place tub upside down and unfold both support legs outward until they snap into their locked positions.

**NOTE** Always double check that the legs are securely snapped into place before putting your child into the tub.

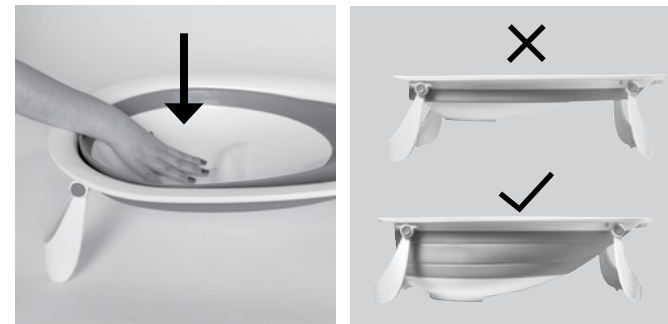

2. Turn tub right side up and push the flexible basin down until all sides are fully extended.

**NOTE** Make sure the drain plug within the tub is securely fitted before filling the tub.

3. Place the tub on the flat bottom of an adult tub or shower.

4. Fill the tub with as little water as possible. Always test the water temperature and water level before placing your baby into the tub. Typical water temperature for bathing a baby should be between 90 and 100°F (32.2 and 37.8°C). While bathing your child, swivel the hook under the tub so it is not accessible to the child.
5. After bathing and removing your baby from the tub, drain water from the tub by lifting the drain plug, and rotating plug to the side. Tilt the tub to drain water.



6. Place tub upside down on a flat surface and push down on flexible basin until it is fully collapsed.

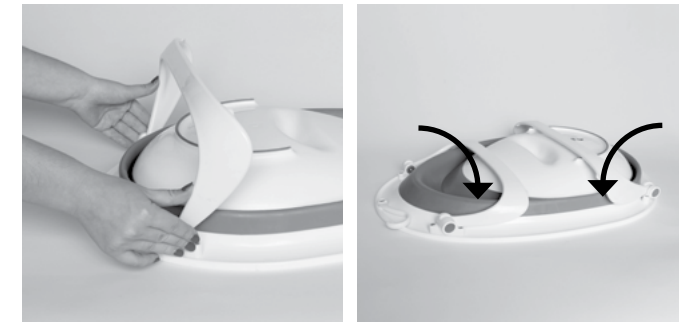

7. To collapse leg, simultaneously press and hold the buttons on each side of leg as you fold leg inward. Repeat on other leg.



8. Swivel hook out and hang for drying or storage.



THE FIRST YEARS is the trademark of TOMY, registered in the U.S. and other countries.

© 2023 TOMY TOMY INTERNATIONAL, 2015 SPRING RD., OAK BROOK, IL 60523, USA. ALL RIGHTS RESERVED.

US & CANADA: 800-704-8697

[WWW.TOMY.COM](http://WWW.TOMY.COM)

TOMY EUROPE

HEMBURY HOUSE, EXETER, EX2 5AZ. UK

(TOMY EUROPE IS THE TRADING NAME OF TOMY UK CO., LTD.)

Please retain all product information for future reference. Color and contents may vary. Trademarks and copyrights are exclusively owned by TOMY. MADE IN CHINA. Y7939 230906