

**WE DO NOT RECOMMEND
USE OF WEAVER BASES
ON HEAVY CALIBER GUNS**

Users manual and guarantee

Aimpoint 1000

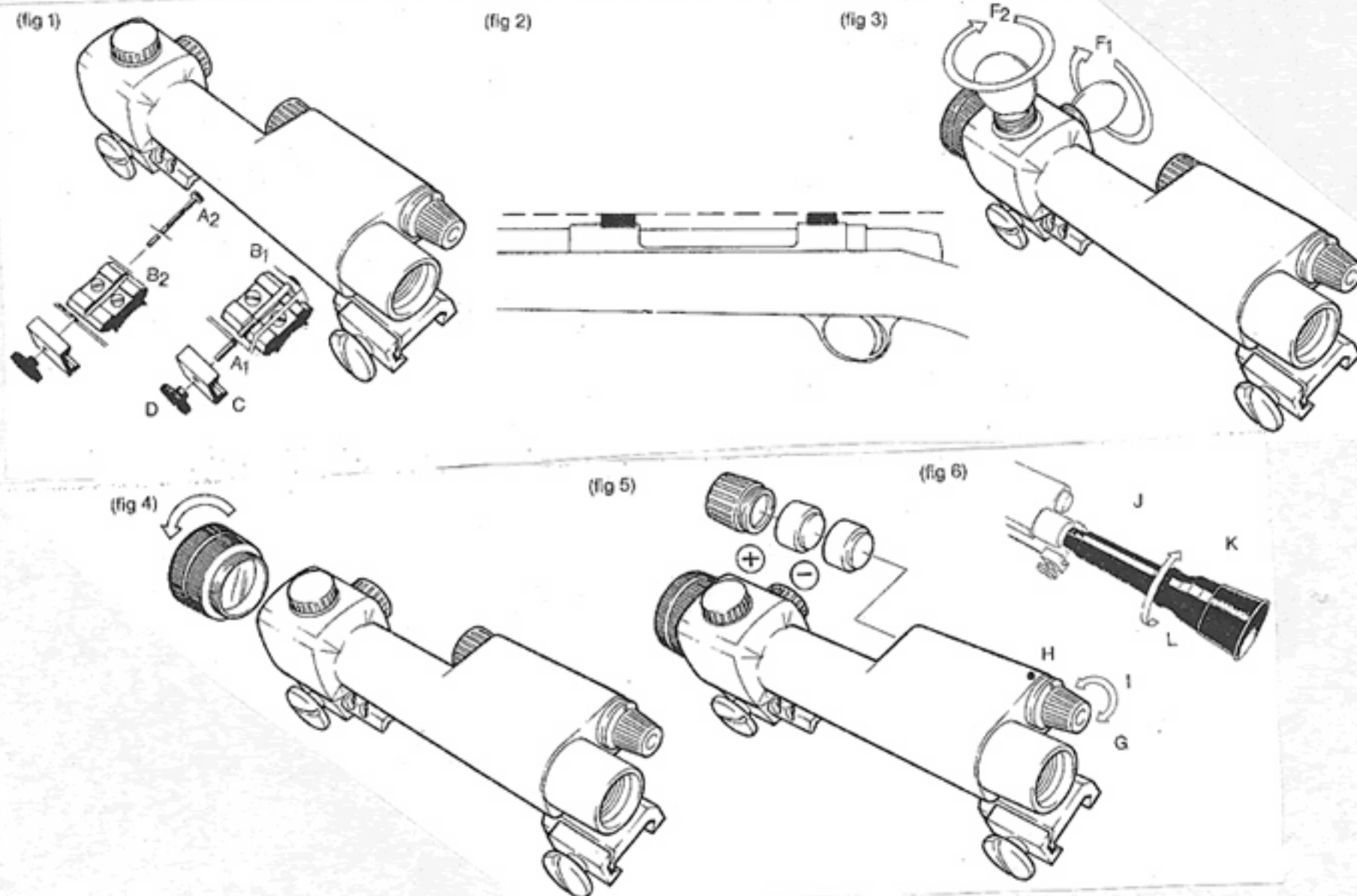
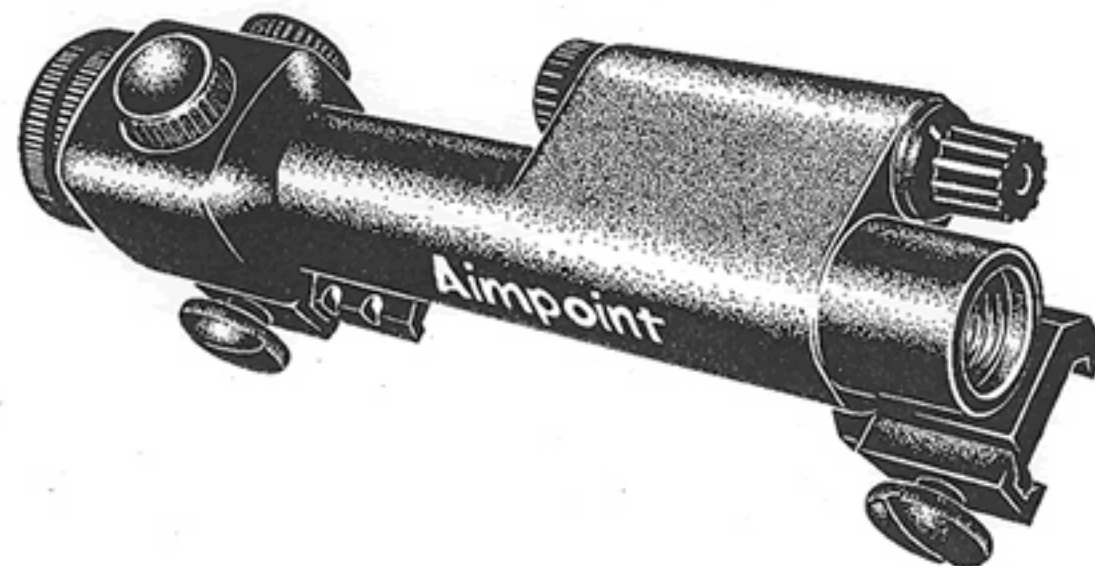

English

INTRODUCTION:

You have chosen Aimpoint 1000 – a very advanced red dot sight. For you as a hunter and shooter, it means unsurpassed advantages in getting a fast, simple and safe shoot.

MOUNTING (fig. 1)

Aimpoint 1000 is specifically designed to be mounted on weaver bases. When assembling, see to it that the bases are on the same line, vertically as well as horizontally (fig. 2). Fit the rear screw (A₁) in the groove of the rear weaver base (B₁). Fit the rear locking clamp (C) on the screw (A₁) and tighten properly with the nut (D). Repeat the same procedure for fastening the front part of the sight on the front weaver base (B₂). Note! The front screw (A₂) is located above the front weaver base (B₂) and does not have to fit in the groove.

BORE SIGHTING

If the sight is mounted on a bolt action rifle, remove the bolt and place the weapon on a solid, flat surface. Aim the weapon by looking through the bore at a small distant target. Move the eye from the bore to the sight without moving the weapon and adjust the sight for windage and elevation until the red dot is on the target. After having carefully bore sighted, the bullet should strike within 8–12 inches (20–30 cm) of the target at the distance of 110 yards (100 m).

Final adjustment is being done in the normal way by shooting at a target. Be sure to retighten the locking nuts after the first shots.

WINDAGE AND ELEVATION ADJUSTMENT (fig. 3)

Unscrew the cover for the adjustment screws (F₁, F₂). The groove of the screws is designed so adjustment can be made with

a coin. Each click of the adjustment screws (F₁, F₂) corresponds to a movement of the impact point of 1/4 inch (6.4 mm) at a distance of 110 yards (100 m). Each mark on the screws (F₁, F₂) corresponds to one click.

When moving the point of impact to the left, screw the windage adjustment screw (F₁) in the direction of the arrow. When moving the point of impact to the right, screw the windage adjustment screw (F₁) against the direction of the arrow. When moving the point of impact upwards, screw the elevation adjustment screw (F₂) in the direction of the arrow. When moving the point of impact downwards, screw the elevation adjustment screw (F₂) against the direction of the arrow.

The windage and elevation adjustment have been mechanically centered at the factory in order to provide optimal adjustment possibilities. Therefore, do not screw the adjustment screws before having mounted the sight on the weapon.

POLARIZING FILTER (fig. 4)

The Aimpoint 1000 comes with a polarizing filter to be mounted at the front of the sight. The filter can be mounted on the sight at all times, except at very low light levels at dawn or dusk.

Turn the front part of the filter in the direction of the arrow to change the contrast.

LIGHT ADJUSTMENT AND BATTERIES (fig. 5)

The Aimpoint 1000 is equipped with a rotary switch with 10 positions. The sight is switched on in position (H). The intensity of the red dot increases by turning the knob in direction (I). The Aimpoint 1000 is equipped with two Duracell SP/MP 675 (1.4 volt). These can be found

batteries can be used which have better low temperature characteristics:

Lithium 1 pc DL1/3N (3V/cell) Duracell
Silveroxide 2 pcs D357 H (1.5V/cell) Duracell

TECHNICAL DATA

Weight: 228 grams/8 ozs including batteries and polarizing filter.
Length: 156 mm/6.15 inches.

THE AIMPOINT SCOPE ATTACHMENTS (3x) and (1.5–4x) (fig. 6)

Technical data 3x: Length 125 mm (5 inches).
Weight 85 g (3 ounces). Field of view: 8.8 m (9.6 yards) at 100 m (110 yards). Eye relief:

Mounting: The scope attachment is mounted to the Aimpoint 1000 by screwing it into the internal threads at the rear of the sight. It can be tightened by hand and with moderate force by gripping the straight front part of the unit.