

290 mm

## ASSEMBLY&INSTALLATION

Please read carefully and save these instructions,as you may need them a later date.

### CAUTION

Turn off the main power at the circuit breaker before installing the fixture, in order to prevent possible shock.

### GENERAL

All electrical connections must be in accordance with local and National Electrical Code (N.E.C) standards. If you are unfamiliar with proper electrical wiring connections obtain the services of a qualified electrician.

Remove the fixture and the mounting package from the box and make sure that no parts are missing by referencing the illustrations on the installation instructions.

## ASSEMBLY AND INSTALLATION

1. Carefully unpack the fixture, lay out all parts on a clean surface.

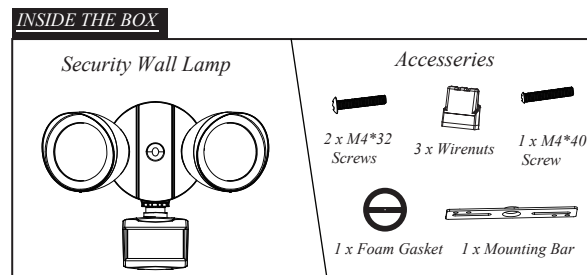

2. Select the motion sensor(14) mode you want (see page 2), the default mode is Test Mode.
3. Use the provided waterproof gasket (2) to place it between the outlet box(3)(not included) and the mounting bar(11), and fix it with outlet box screws(9).
4. Wrap the ground wire (7) from the fixture around the ground screw on the mounting Bar (11). Use a wire connector (12) to connect the ground wire (7) from the fixture to the ground wire (4) from the outlet box.
5. Use a wire connector (12) to connect the white wire (6) from the fixture to the white wire (1 neutra wire) from the outlet box. Use a wire connector (12) to connect the black wire (8) from the fixture to the black wire (5 live wire) from the outlet box. Position the wires inside the outlet box.

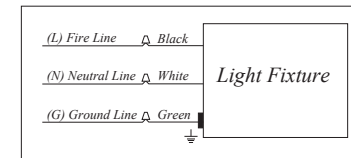

## ASSEMBLY AND INSTALLATION (CONT.)

5. Remove the silicone plug(15) first, and then place the fixture (10) onto the mounting bar(11) and fix it with screws (13), and finally plug the silicone plug(15) in to prevent moisture and dust from entering.
6. To prevent moisture from entering the outlet box and the fixtures mounting plate causing a short, apply a bead of clear caulk to outline the outside of the fixtures mounting plate where it meets the wall. Leave a small space at the bottom to allow any condensation or moisture to escape.
7. Turn on the power.

## INSTALLATION IS NOW COMPLETED

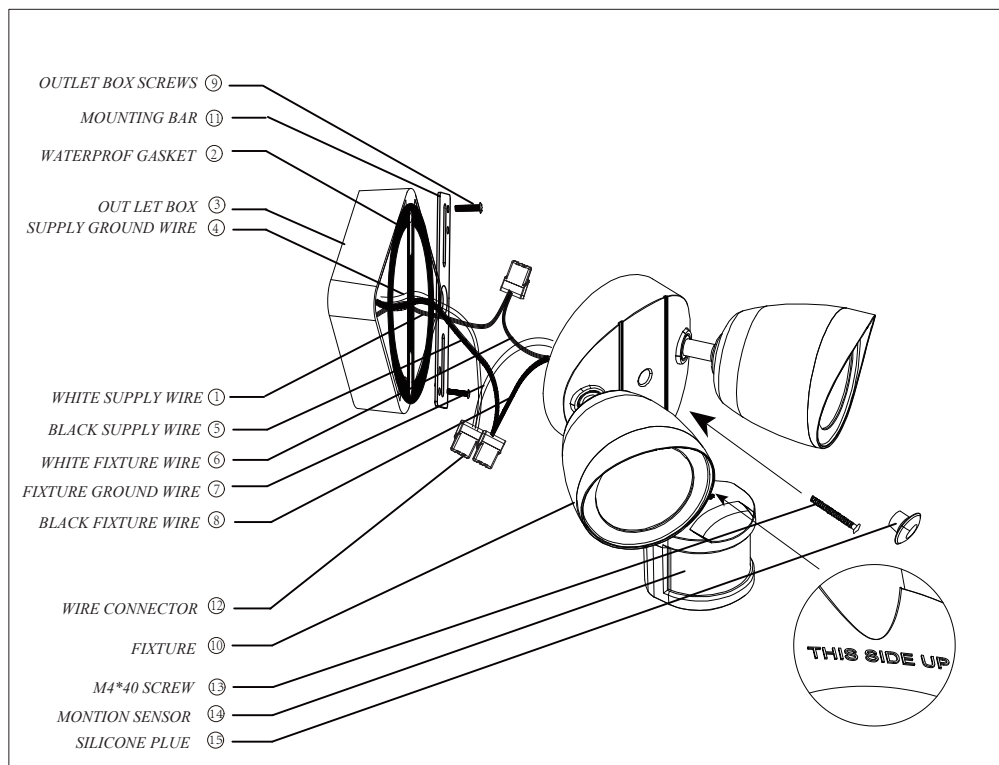

ITEM NO.: M-18002

210 mm

**Motion Sensor Modes**

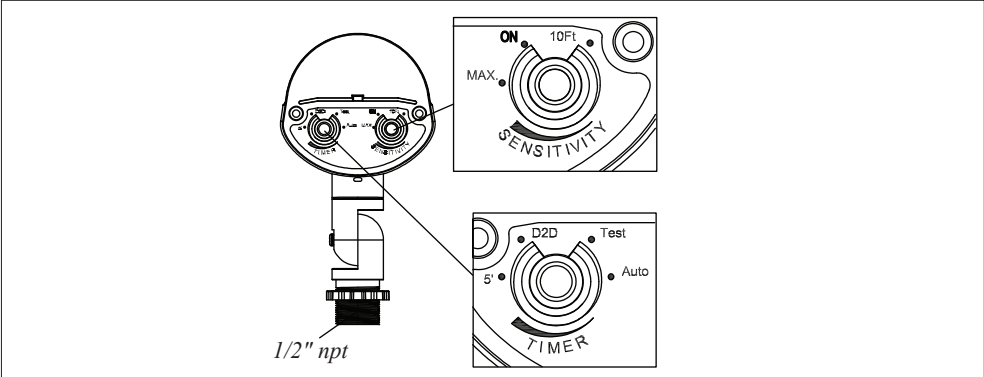

**SENSITIVITY**

Continuous adjustments of the sensitivity from 10ft to 60ft max with max 180° detection range

**TIMER**

**Test Mode:** “TIMER” switch is set to the “Test ” position. The light fixture will operate at Day or Night. Pilot light will flash 2 times, and the light will stay on for 5 ± 3 secondes until no motion detected.

**Auto Mode:** “TIMER” swi tch can be adjusted between “Auto ” and “5 ” position to set timmer between 10 sec ~ 5 min. The light fixture will only operate at Night(20lux ~ 150lux). Pilot light will flash 4 times, and the light will stay on for “10 sec ~ 5min” until no motion ddetected

**Dusk-to-Dawn Mode (D2D):** When “TIMER” switch is set to the “D2D ” position. Pilot light will flash 6 times, the light will turn on (20lux - 1500lux) stay and ON (150lux-1500lux) intil sunrise (1500 lux max).

**Manual override mode:** Under Auto Mode, when the light is on,turn power switch OFF for 0.5sec - 3sec, and then turn the power switch back ON, the light fixture will stay ON for 8 hours, then when LUX reaches 1500, the light fixture will turn off the light after 1 minute and enter Auto mode. (Note: 1. Switch on and off again in the same way, the sensor will enter Auto Mode. 2. After cutting off the power for more than 5sec, the sensor will reset to its initial state and enter the selected mode after heating up.)

**On Model:** When "Sensitivity" switch adjusted to "ON" position, the light will stay ON and is not affected by time and illumination.

ITEM NO.: M-18002

290 mm

210 mm