

# EML3SD

## Self Diagnostic LED Emergency Light

### Product Description

The EML3 LED Self Diagnostic Emergency Light combines a low-profile, standard design light with the advanced technology of self-diagnostic testing. The EML3 Series is available in white and offers universal mounting, a test button with status indicator, damp location listing, and a remote capable option. With fully adjustable heads, the EML3 Series complements any design application.

#### Construction

- Injection molded thermoplastic ABS housing
- UL-94 5VA Flame rating
- Test switch and charge/status indicator
- Adjustable heads for aiming light where required
  - Head tilt: +25°/-90°
  - Head rotation: 330°

#### Optical System

- Precision engineered Prismatic Lens

#### Electrical

- Power Draw: Non-Remote: 2.5W at 120/277VAC, Remote: 3.3W at 120/277VAC
- Remote version supports up to two (2) 3.6VDC NICOR remote lamps (see compatibility chart)
- 90 minute capacity (including remote lamps)
- Self Diagnostic feature automatically tests and reports on fixture status
- Operating temperature: 50°F - 104°F (10°C - 40°C)

#### LED

- 6 high brightness LEDs per head for even and consistent illumination

#### Finish

- White unpainted ABS Plastic

#### Mounting and installation

- Easy installation onto a standard junction box
- Suitable for wall mount and ceiling mount
- Universal mounting plate with EZ quick connect

#### Compliance

- UL924
- Meets NFPA 70 and 101 requirements
- Listed for damp locations

#### Warranty

- 1-year limited system standard
- Warranty does not cover product failure due to an overvoltage event (power surge)

Project

Catalog

Type

Date

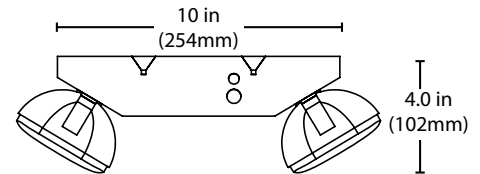
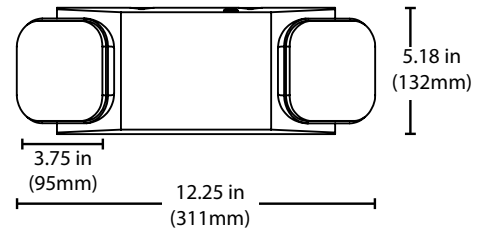

### Photometric Data

#### EML3SD NonRemote

|                             |         |
|-----------------------------|---------|
| Input Voltage (VAC)         | 120/277 |
| System Level Power (W)      | 2.5     |
| Delivered Lumens (Lm)       | 203     |
| System Efficacy (Lm/W)      | 81.2    |
| Correlated Color Temp (K)   | 6000    |
| Color Rendering Index (CRI) | 70      |

#### Compatible NICOR Remote Lamps\*

- ERH3SD
- ERH4SD
- ERH3WPSD
- ERH4WPSD

\*Not a complete list. Check compatibility before installation.

## EML3SD 200 lumen LED Self Diagnostic Emergency Light



### Ordering Information

Example: EML310UNVWH

| Series | Version  | Voltage        | Housing Color | Remote Lamp Option      | Self Diagnostic |
|--------|----------|----------------|---------------|-------------------------|-----------------|
| EML3   | 10 (1.0) | UNV (120-277V) | WH (white)    | BLANK (non-remote)      | SD              |
|        |          |                |               | R (remote lamp capable) |                 |