

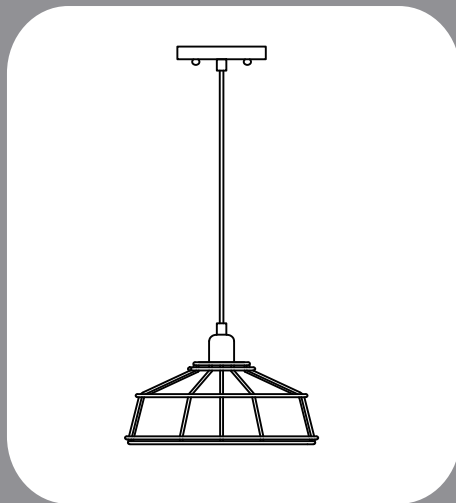

Presenza
Chrome Metal Cage Pendant

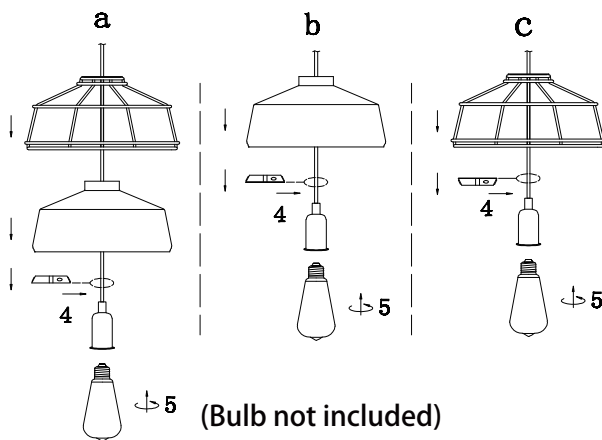

VN-L00033

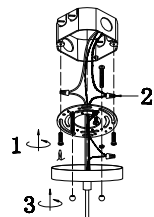

Remarks:
Suggest using the Edison 60 watts light bulb.

Warning: Turn off the switch during installation

Installing the ceiling case

1. Fix the bottom of the ceiling box case to the ceiling by screws with the circular metal ring with the power source wires passing through.
2. Match and connect the live (Black) and neutral (White) wires from the lamp to the power supply. Fix it with the cone shape terminal block. Match and connect the earth wire (Green) to the ground wire and screw to the ground screw nut (Green) on the circular ring.
3. Close the case and screw tight with the circular nut.

Three ways of lampshade installation

- A. Pass the lamp holder through the metal cage and glass shade in sequence as in the picture. Screw the lock ring on top of the lamp holder to fix the shades in place.
- B. Same as A but removing the metal cage.
- C. Same as A but removing the glass shade.

Cleaning&Care

Dust surfaces with a dry soft cloth.

IMPORTANT SAFETY INSTRUCTIONS:

IF you are unsure about your ceiling/wall type or what mounting method you should use, consult a qualified professional or your local hardware store.

We recommend installation of this pendant lamp be performed by a licensed electrician.

WARNING:

Small parts and sharp edges may be present prior to assembly.

Care Instructions

Do not use window cleaners or cleaning abrasives as they will scratch the surface and could damage the protective coating.

Customer Service

For questions regarding this product, or to receive replacement or missing parts, please contact customer service based on your location. Please have ready the model number when you contact us.

USA : partsandreplacements@teamson.com or 1-800-935-3959

