

READ AND FOLLOW ALL SAFETY INSTRUCTIONS!
SAVE THESE INSTRUCTIONS AND DELIVER TO OWNER AFTER INSTALLATION

- To reduce the risk of death, personal injury or property damage from fire, electric shock, falling parts, cuts/abrasions, and other hazards please read all warnings and instructions included with and on the fixture box and all fixture labels.
- Before installing, servicing, or performing routine maintenance upon this equipment, follow these general precautions.
- Installation and service of luminaires should be performed by a **qualified licensed electrician**.
- Maintenance of the luminaires should be performed by person(s) familiar with the luminaires' construction and operation and any hazards involved. Regular fixture maintenance programs are recommended.
- It will occasionally be necessary to clean the outside of the refractor/lens. Frequency of cleaning will depend on ambient dirt level and minimum light output which is acceptable to user. Refractor/lens should be washed in a solution of warm water and any mild, non-abrasive household detergent, rinsed with clean water and wiped dry. Should optical assembly become dirty on the inside, wipe refractor/lens and clean in above manner, replacing damaged gaskets as necessary.
- **DO NOT INSTALL DAMAGED PRODUCT!** This luminaire has been properly packed so that no parts should have been damaged during transit. Inspect to confirm. Any part damaged or broken during or after assembly should be replaced.
- Recycle: For information on how to recycle LED electronic products, please visit www.epa.gov.
- These instructions do not purport to cover all details or variations in equipment nor to provide every possible contingency to meet in connection with installation, operation, or maintenance. Should further information be desired or should particular problems arise which are not covered sufficiently for the purchaser's or owner's purposes, this matter should be referred to Acuity Brands Lighting, Inc.



WARNING
RISK OF ELECTRIC SHOCK

- ✓ Disconnect or turn off power before installation or servicing.
- ✓ Verify that supply voltage is correct by comparing it with the luminaire label information.
- ✓ Make all electrical and grounded connections in accordance with the National Electrical Code (NEC) and any applicable local code requirements.
- ✓ All wiring connections should be capped with UL approved recognized wire connectors.



WARNING
RISK OF BURN

- ✓ Allow lamp/fixture to cool before handling. Do not touch enclosure or light source.
- ✓ Do not exceed maximum wattage marked on luminaire label.
- ✓ Follow all manufacturer's warnings, recommendations and restrictions for: driver type, burning position, mounting locations/methods, replacement and recycling.



CAUTION
RISK OF INJURY

- ✓ Wear gloves and safety glasses at all times when removing luminaire from carton, installing, servicing or performing maintenance.
- ✓ Avoid direct eye exposure to the light source while it is on.



CAUTION
RISK OF FIRE

- ✓ Keep combustible and other materials that can burn, away from lamp/lens.
- ✓ Do not operate in close proximity to persons, combustible materials or substances affected by heat or drying.



CAUTION: RISK OF PRODUCT DAMAGE

- ✓ Never connect components under load.
- ✓ Do not mount or support these fixtures in a manner that can cut the outer jacket or damage wire insulation.
- ✓ Controls for dimming, auto-sensing, or remote control of a luminaire that are not factory-wired to the luminaire must be checked for compatibility with the luminaire prior to installation. LED fixtures must be powered directly off a switched circuit.
- ✓ Unless individual product specifications deem otherwise: Do not restrict fixture ventilation. Allow for some volume of airspace around fixture. Avoid covering LED fixtures with insulation, foam, or other material that will prevent convection or conduction cooling.
- ✓ Unless individual product specifications deem otherwise: Do not exceed fixtures maximum ambient temperature.
- ✓ Only use fixture in its intended location.
- ✓ LED products are Polarity Sensitive. Ensure proper Polarity before installation.
- ✓ Electrostatic Discharge (ESD): ESD can damage LED fixtures. Personal grounding equipment must be worn during all installation or servicing of the unit.
- ✓ Do not touch individual electrical components as this can cause ESD, shorten lamp life, or alter performance.
- ✓ Some components inside the fixture may not be serviceable. In the unlikely event your unit may require service, stop using the unit immediately and contact an ABL representative for assistance.
- ✓ Always read the fixtures complete installation instructions prior to installation for any additional fixture specific warnings.
- ✓ Always ensure that the electrical distribution system is up to NEC (and any applicable local code) requirements.
- ✓ Verify that power distribution system has proper grounding. Lack of proper earth ground can lead to fixture failure and may void warranty.

All luminaires that contain electronic devices that generate frequencies above 9kHz from any component within the luminaire comply with Part 15 of the FCC Rules. Operation is subject to the following two conditions:

- (1) This device may not cause harmful interference
- (2) This device must accept any interference received, including interference that may cause undesired operation

Failure to follow any of these instructions could void product warranties. For a complete listing of product Terms and Conditions, please visit www.acuitybrands.com.

Our Brands	Indoor/Outdoor	Indoor Lighting	Outdoor Lighting	Controls	Daylighting
	Lithonia Lighting	Gotham	American Electric Lighting	DARK TO LIGHT	SunOptics
	Carandini	Mark Architectural Lighting	Antique Street Lamps	LC&D	
	Holophane	Peerless	Hydrel	ROAM	
	RELOC	Renaissance Lighting	Tersen	Sensor Switch	
	Light Concepts	Winona Lighting		Synergy	

Acuity Brands Lighting, Inc. assumes no responsibility for claims arising out of improper or careless installation or handling of its products.

ABL LED General Warnings, Form No. 503.203

© 2010, 2016 Acuity Brands Lighting, Inc. All rights reserved. 12/01/10

Installation instructions for Fixture Conversion Retrofit by Underwriters Laboratory Inc

This Retrofit Kit contains:

REFLECTOR ASSEMBLIES

8 FT (MASTER AND SATELLITE OR 2 MASTERS)
4 FT (MASTER ONLY)

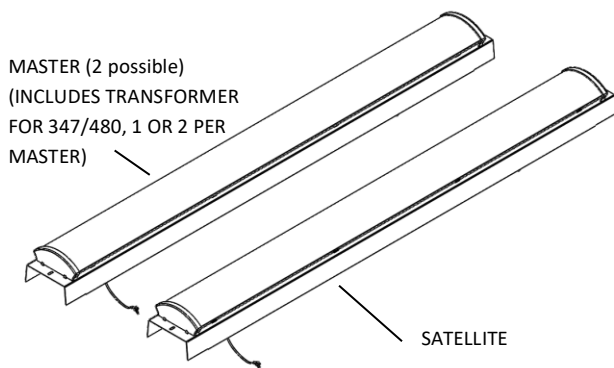

UFITRF L48 (master) ships with 2 End Brackets attached to Reflector Assembly
UFITRF L96 (2 master OR master and satellite) ships with 1 End Bracket
attached to each Reflector Assembly

MOUNTING BRACKET CENTER 8 FT ONLY (1)

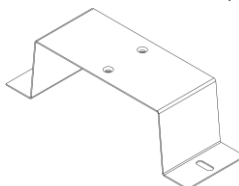

MOUNTING BRACKET END (2)

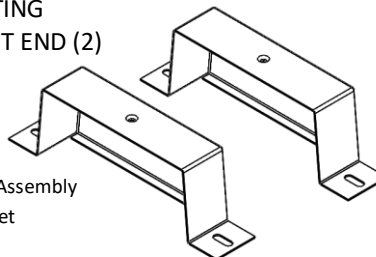

#8-18 X 1/2"
SELF DRILLING
SCREWS
8 FT (6), 4FT (4)

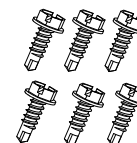

#8-18 X 3/8" SELF-DRILLING
SCREWS
8 FT (4), 4FT (2)



WARNING – Risk of fire or electric shock. Luminaires wiring, ballasts, or other electrical parts may be damaged when drilling for installation of reflector kit hardware. Check for enclosed wiring and components.

WARNING – Risk of fire or electric shock. Install this kit only in luminaires that have the construction features and dimensions shown in the photographs and/or drawings and where the input rating of the Retrofit Kit does not exceed the input rating of the luminaire.

WARNING – To prevent wiring damage or abrasion, do not expose wiring to edges of sheet metal or other sharp objects.

*** Locate the fluorescent lighting fixture that is to be retrofitted. **Turn off power.**

WARNING – Electrical shock can occur during retrofit component installation if power is not turned off.

WARNING – Risk of fire or electric shock. LED Retrofit Kit installation requires knowledge of luminaires electrical systems. If not qualified, do not attempt installation. Contact a qualified electrician.

WARNING – As indicated in the individual installation instruction: Do not make or alter any open holes in an enclosure of wiring or electrical components during kit installation or Only those open holes indicated in the photographs and/or drawings may be made or altered as a result of kit installation. Do not leave any other open holes in an enclosure of wiring or electrical components.

WARNING – Ensure that existing fixture is and remains properly connected to building ground. Use of any other than Acuity Brands supplied screws to install assembly may result in ungrounded fixture components.

This Retrofit Kit is designed to fit housings with
minimum dimensions (not to scale):

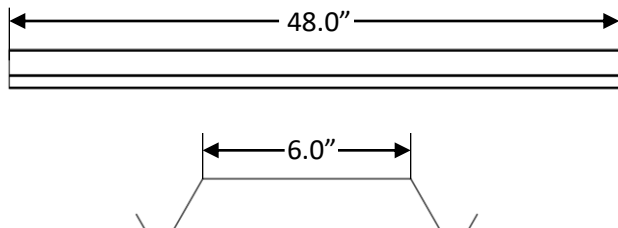

Installation Instructions:

Step 1:

- Verify fixture power is turned off.
- Identify and disconnect power supply wires.
- Remove lamps and ballast cover from existing fixture.
- Remove ballast(s), lampholder brackets, lampholders, and internal wiring to provide adequate clearance for Retrofit Kit installation.

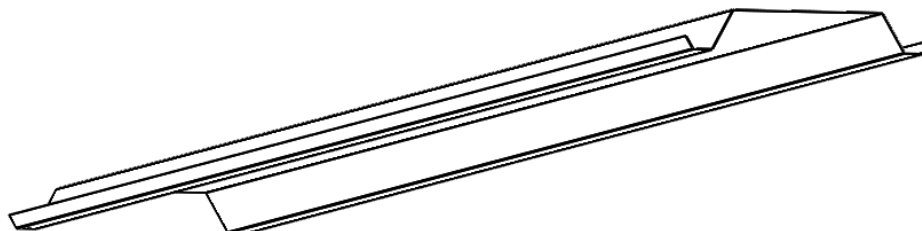

Tandem host channel with lamps, channel cover, lampholder brackets, and lampholders removed.

Step 2:

- Install Brackets with provided #8-18 x 1/2" Self-Drilling Screws.
- Install Center Bracket as close as possible to center of Host Housing.

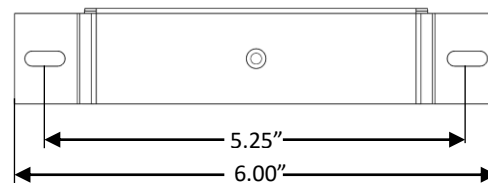

Mounting Bracket Dimensions

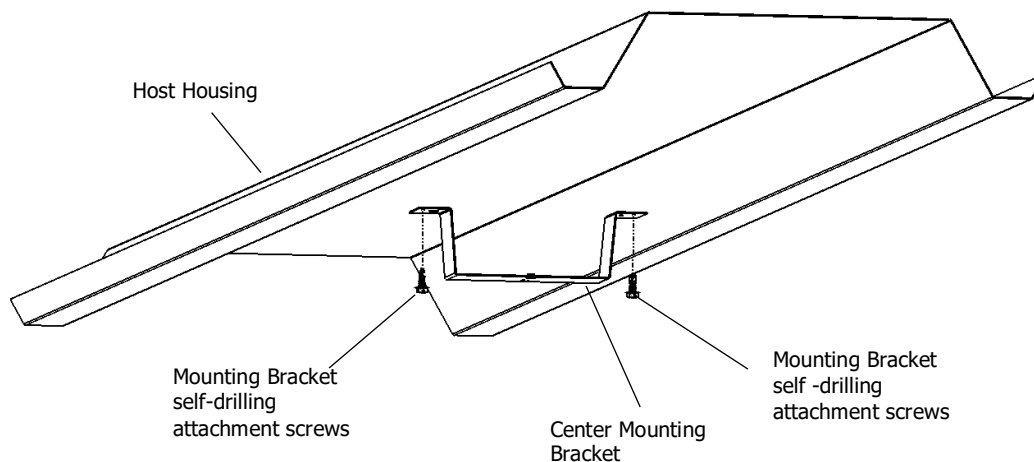

Step 3:

- Locate reflector assembly such that the end bracket is even with the end of the Host Housing.
- Install End Brackets into provided slots on the end of the Reflector Assemblies using #8-18 x 3/8" Self-Drilling Screws
- CAUTION – End Bracket must be towards end of Host Housing to prevent accessibility of live wires and splices
- Attach Reflector Assemblies with the tether/bond wires with captive self-drilling screws.

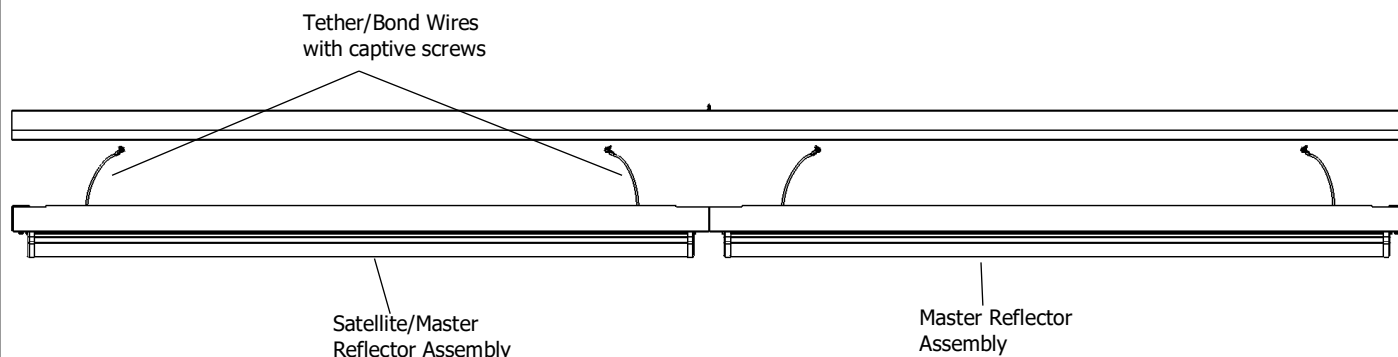

Step 4:

- With Reflector Assemblies hanging, connect the black and white wire (flying leads) to incoming power. Additionally, make the ground connection.
- If applicable, route low voltage connector plugs over center bracket.
- For L96, connect provided wire harness to input power, and connect wire harness male disconnect ends to female disconnect ends on Reflector Assembly.

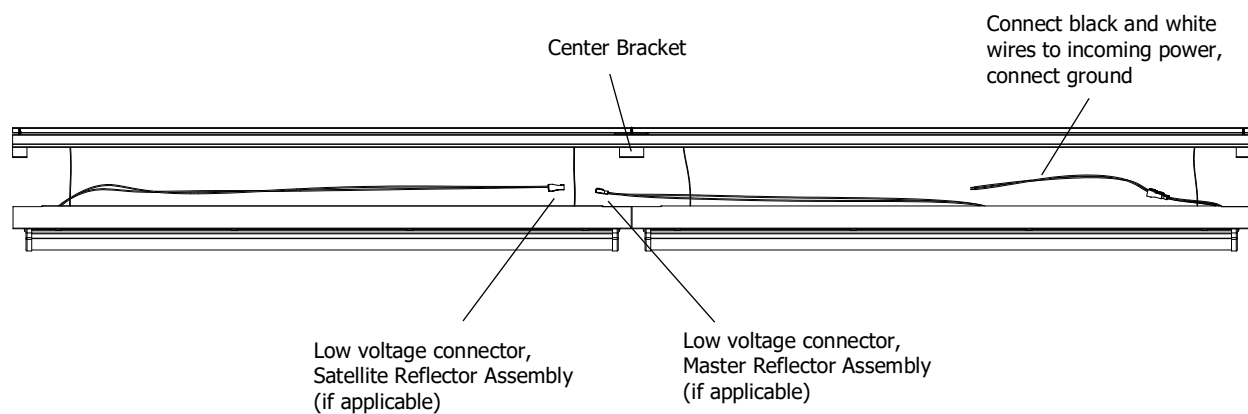

Step 5:

- Attach Reflector Assemblies to Housing with #8-18 x 1/2" self-drilling screws.
- If applicable, attach Reflector Assemblies to Center Bracket with #8-18 x 3/8 sheet metal screws.

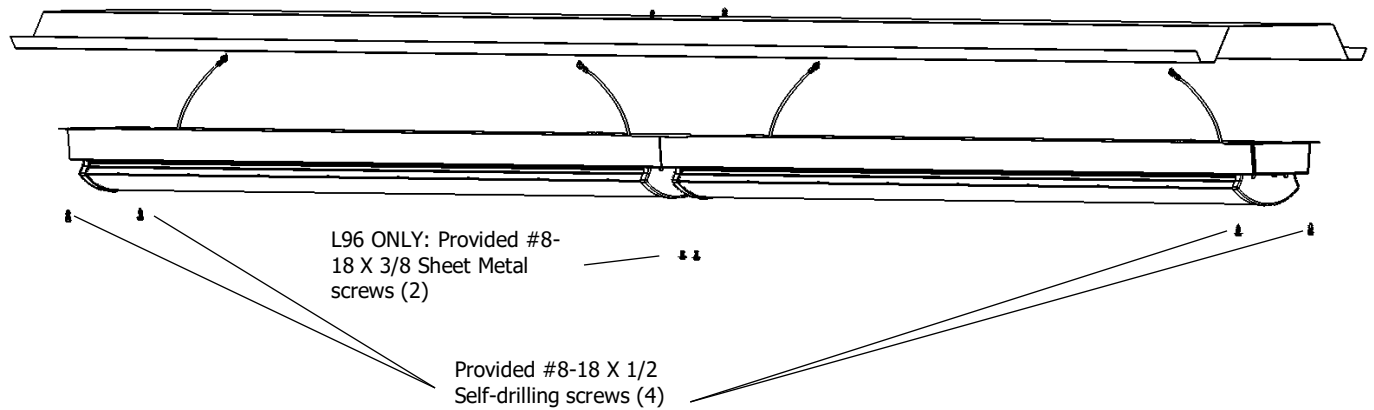

Step 6

- Reflector Assemblies installed.

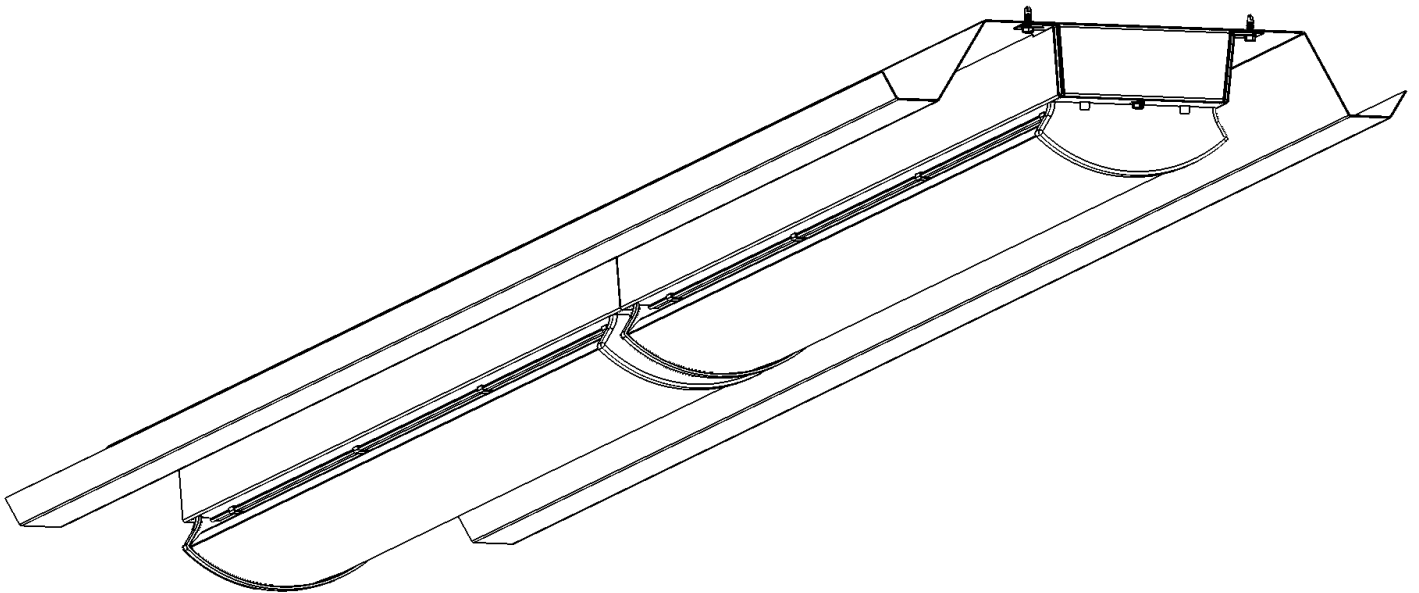

Step 7 (if applicable): Commissioning nLight AIR (NLTAIR2) Sensor

- Out-of-the-box NLTAIR2 RES7 sensors perform as follows:
 - 100% light output for 7.5 minutes, then 1% light output for 2.5 minutes if no occupancy is detected before turning off the luminaire.
- Please refer to *nLight AIR Quick Start Guide* (912-00058-001) included with the retrofit kit
- Please locate additional references and resources at <http://acuitybrands.com/nlightair>

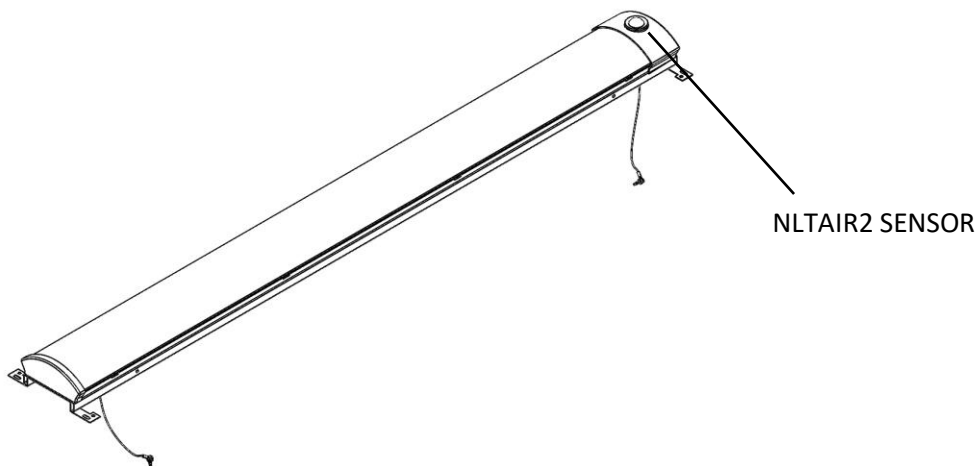

ELECTRICAL COMPONENT LOCATION REFERENCE

- Not all components come with all retrofit kits, options detailed below

