

Cassia™

Max 20 lb (9 kg)

SW128



MAXI-COSI®
We carry the future

4358-8177C 03.05.23

**KEEP INSTRUCTIONS FOR FUTURE USE.
Read all instructions before using this swing.**

Safety Information

- Adult assembly required.
- Tools needed: Phillips head screwdriver (not included).
- Before each usage and assembly, inspect swing for damaged hardware, loose joints, missing parts, or sharp edges. **DO NOT** use swing if any parts are missing or broken. Contact Dorel Juvenile Group, Inc. for replacement parts and instructional literature if needed. **DO NOT** substitute parts.
- Age of usage: Infants from birth to maximum weight of 20 lb, or attempt to climb out (approximately 9 months).

Maintenance

1. Please check this baby swing regularly. Make sure each part is well connected and well installed. Stop using for poor connection and connect/install it again if necessary.
2. This product contains electronic components, which shall not be used in water or in a humid environment. Please ensure the product is dry and store it in a cool and dry place, avoiding direct sunshine for a long time.
3. Always attach all provided fasteners tightly according to the instructions. Check frequently.









WARNING:

FALL and STRANGULATION HAZARDS: Infants have suffered head injuries falling from swings and have strangled in straps.

- **ALWAYS** use restraints. Adjust to fit snugly.
- **STOP** using product when infant attempts to climb out (approximately 9 months).
- Stay near and watch baby during use. This product is not safe for sleep or unsupervised use. If baby falls asleep, remove baby as soon as possible and place baby on a firm, flat sleep surface such as a crib or bassinet.
- Ensure that the seat is fully zipped into place.
- **ALWAYS** place swing on floor. Never use on any elevated surface.
- Toy bar is a possible entanglement injury. Keep out of baby's reach. Remove mobile when infant can grasp toys.
- The toy bar is intended for visual stimulation and is not intended to be grasped by the infant.
- **KEEP** small parts away from children.

Contents

	Parts of Swing 1
	Assembling Swing.....2
	To Operate 6
	Battery Use 8
	Securing Child in Swing..... 10 Adjusting Harness for Growing Child .. 11
	Removing Seat Pad Insert & Harness Covers..... 12 Wash & Care 13
	Dorel Juvenile Group Information 14

Parts of Swing



1

Seat Pad
Insert

Harness
Covers

Harness
System

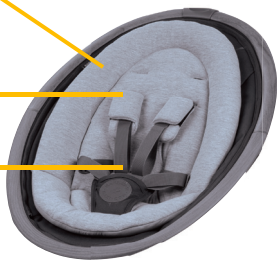

Power
Adapter

Base

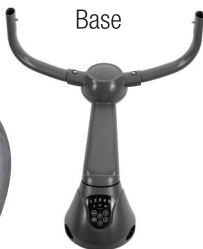

Feet



Screws x2



Toys



Toy Bar

Lay out and identify all of the parts.

If any parts are missing, **do not return this product to the place of purchase.**

Please contact Consumer Care via:

- Phone: 1-800-951-4113
- Text: 1-812-652-2525
- Chat: www.maxicosi.com

You will need to know the model number (SW128) and manufacture date.

It is located on a label on the bottom of the base.

2



Assemble Swing

Install Feet

You will need:



Phillips
Screwdriver

1



2



3



**3**

Install Seat & Toy Bar

You will need:

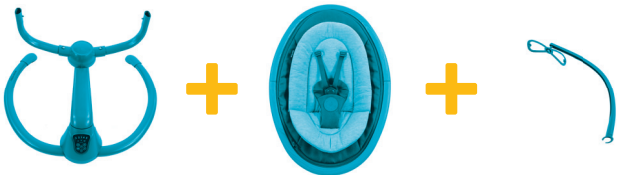
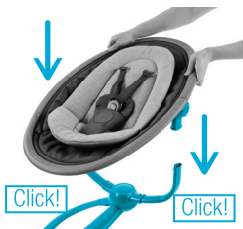
**4****5****6**

4



Install Toys

You will need:

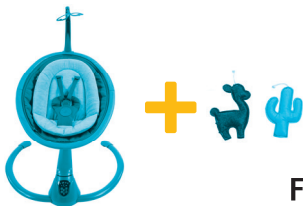

7

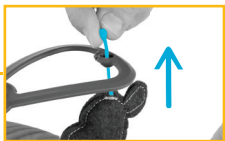
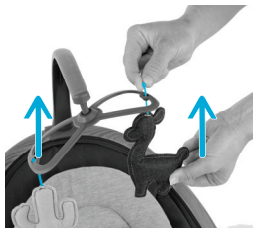

Finished!



WARNING:

The toy bar is intended for visual stimulation and not to be grasped by the child. Toy bar is a possible entanglement injury. Keep out of baby's reach. Remove toy bar when infant can grasp toys.



Max 20 lb (9 kg)



To recline and rotate the swing, see page 6.

6



To Operate

Recline

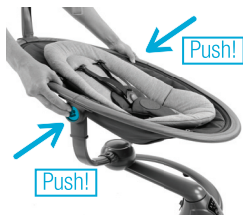

Rotate



Swing Lock

Hold the base steady and rotate the swing.



Motion



Also works with just batteries. See page 8.



Swing Lock

⚠ WARNING:

Children have STRANGLED in cords. Keep this cord out of the reach of children. Do not remove the tag on the cord.



Control Panel

Motion
Detection
Mode

5 Speeds

Volume

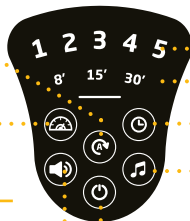

Speed Indicator

Timer Indicator

3 Timers

12 Songs

Power On / Off



Battery Use



4x 1.5V AA/LR6





Important Battery Information:

Keep these instructions as they contain important information.



Recycle or dispose of batteries safely according to federal, state, and local laws.

We recommend alkaline batteries for longer battery life.

CAUTION:

Always follow the instructions carefully. Use only specified batteries. Make sure to insert batteries with the correct polarity.

To prevent battery leaks, which can burn skin and eyes:

- Always replace the entire set of batteries at one time.
- Never mix old and new batteries, or batteries of different brands or types.
- Remove batteries when storing product for a long time.
- Dispose of used batteries immediately.
- Remove exhausted batteries from the product.
- Do not short-circuit the supply terminals
- RECHARGEABLE BATTERIES: Rechargeable batteries are to be removed from the product before being charged. Rechargeable batteries are only to be charged under adult supervision. Do not recharge non-rechargeable batteries.



Securing Child in Swing

1



2



3



WARNING:

- **ALWAYS** use restraints. Adjust to fit snugly.



Max 20 lb
(9 kg)

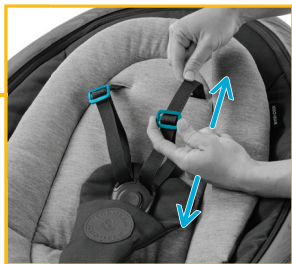

Unfasten the harness covers to access the harness strap slide rings.



Removing Seat Pad Insert & Harness Covers

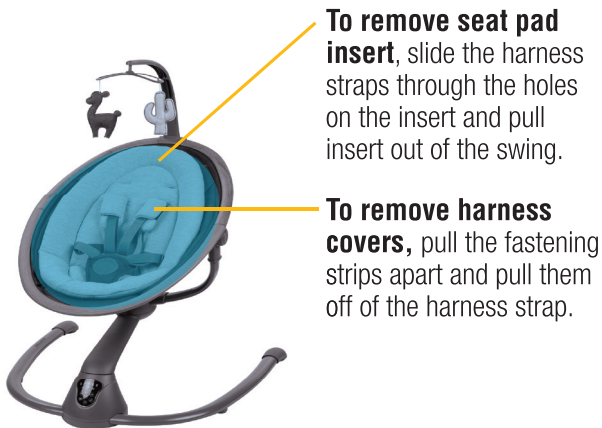



Spot Clean



Cleaning Seat Pad Insert, Harness Covers, and Toys

- Machine wash separately with cold water on a gentle cycle.
- Do not use bleach.
- Air dry.
- Do not iron.
- Do not dry clean.

Dorel Juvenile Group Information

Thank you for choosing this swing.

The DJG family is committed to creating strollers with the most comfort and convenience available today.

For parts availability or if you have questions or any concerns with this product, please contact our Consumer Care Department:



Send Us a Text: 1-812-652-2525
(US and Canada Only)
Carrier Fees May Apply)



Find Us Online:
www.maxicosi.com



Email Us: support@djgusa.com

Give Us a Call: 1-800-951-4113
(Toll Free, US and Canada Only)

Include the model number and manufacture date (located on a label on the bottom of the base) and a brief description of the part.

- Harness Covers (2)
- Seat Pad Insert
- Toys

Two-Year Limited Warranty

Dorel Juvenile Group, Inc. warrants to the original purchaser that this product (Cassia Swing), is free from material and workmanship defects when used under normal conditions for a period of two (2) years from the date of purchase. Should the product contain defects in material or workmanship Dorel Juvenile Group, Inc., will repair or replace the product, at our option, free of charge. Purchaser will be responsible for all costs associated with packaging and shipping the product to Dorel Juvenile Group Consumer Care Department at the address noted on the back of this document and all other freight or insurance costs associated with the return. Dorel Juvenile Group will bear the cost of shipping the repaired or replaced product to the purchaser. Product should be returned in its original package accompanied by a proof of purchase, either a sales receipt or other proof that the product is within the warranty period. This warranty is void if the owner repairs or modifies the product or the product has been damaged as a result of misuse. This warranty excludes any liability other than that expressly stated previously, including but not limited to, any incidental or inconsequential damages. **SOME PROVINCES DO NOT ALLOW THE EXCLUSION OR LIMITATION OF INCIDENTAL OR CONSEQUENTIAL DAMAGES, SO THE ABOVE LIMITATION OR EXCLUSION MAY NOT APPLY TO YOU. THIS WARRANTY GIVES YOU SPECIFIC LEGAL RIGHTS, AND YOU MAY ALSO HAVE OTHER RIGHTS THAT MAY VARY FROM PROVINCE TO PROVINCE.**

This device complies with part 15 of the FCC Rules. Operation is subject to the following two conditions (1) this device may not cause harmful interference, and (2) this device must accept any interference received, including interference that may cause undesired operation.

RADIO AND TELEVISION INTERFERENCE: This equipment has been tested and found to comply with the limits for a Class B digital device, pursuant to part 15 of the FCC Rules. These limits are designed to provide reasonable protection against harmful interference in a residential installation. This equipment generates, uses, and can radiate radio frequency energy and if not installed and used in accordance with the instructions, may cause harmful interference to radio communications. However there is no guarantee that interference will not occur in a particular installation.

If this equipment does cause harmful interference to radio or television reception, which can be determined by turning this equipment off and on, the user is encouraged to try to correct the interference by one or more of the following measures:

- Reorient or relocate the receiving antenna.
- Increase the separation between the equipment and the receiver.
- Connect the equipment into an outlet on a circuit different from that to which the receiver is connected.
- Consult the dealer or an experienced radio/TV technician for help.

NOTE: Changes or modifications not expressly approved by Dorel Juvenile Group can void your authority to operate this equipment under Federal Communications Commission's rules.



Cassia™

Max 20 lb (9 kg)

©2023 Dorel Juvenile Group, Inc. (800) 951-4113 www.maxi-cosi.com. Styles and colors may vary. Les styles et les couleurs peuvent varier. Made in CHINA. Fabriqué en CHINE. Distributed by (distribué par) Dorel Juvenile Group, Inc., 2525 State St., Columbus, IN 47201-7494. Dorel Juvenile Canada, 2233 Argentia Road, Suite 110, Mississauga, ON L5N 2X7. Importado y Distribuido en Chile por: Comercial e Industrial Silfa S.A. - San Ignacio 0201 / Parque Industrial Portezuelo Quilicura, Santiago Chile. Fono (562) 2339 9000. En Perú por: Comexa S.A. - Los Libertadores 455 – San Isidro, Lima – Perú. Fono (511) 4469014. En Centro América, Caribe y Ecuador por: Best Brands Group S.A. – Av. Balboa, Bay Mall Plaza, Planta Baja, local 9, Panamá. - Fono: (507) 300 2884. En Colombia por: Baby Universe S.A.S. - Vía 40 No. 77-29, Barranquilla, Colombia - Fono: (575) 353 1110 Importador: DJGM, S.A. DE C.V. Gabriel Mancera No. 1041 Col. Del Valle, Benito Juárez C.P. 03100 México, Ciudad de México R.F.C. DJG140305GN9 Tel. (55) 67199202 03/05/23 4358-8177C

