

PARTS INCLUDED

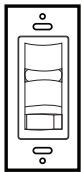

Dimmer (1)



Mounting Screws (2)



Wire Nuts (4)

TOOLS REQUIRED (NOT INCLUDED)



Flathead
screwdriver



Phillips
screwdriver



Wire Strippers/Cutters
(in case the copper
isn't exposed enough)



WARNING: This product may represent a possible shock or fire hazard if improperly installed or attached in any way. Product should be installed in accordance with the owners manual, current electrical codes and/or the current National Electric Code (NEC).

CAUTION: If you are unfamiliar or inexperienced with your home's electrical systems, contact a certified electrician for assistance.

RISK OF ELECTRIC SHOCK: TURN OFF THE MAIN POWER AT THE CIRCUIT BREAKER BEFORE INSTALLING.

RISK OF FIRE:

- DO NOT USE WITH CONTROL RECEPTACLE OUTLETS, FLUORESCENT LIGHTING FIXTURES, MOTOR-OPERATED APPLIANCES OR TRANSFORMER SUPPLIED APPLIANCES.
- DO NOT EXCEED ELECTRICAL RATINGS
- USE ONLY COPPER WIRES WITH THIS DEVICE
- USE INDOORS ONLY

IMPORTANT WIRING INFORMATION

- Strip insulation 3/8in (10mm) for 14AWG or 12AWG (1mm or 2.5mm) wire
- Strip insulation 7/16 in (11mm) for 18AWG wire
- Use to join one or two 14AWG or 12AWG (1.5mm or 2.5mm wires with one 18AWG (0.75mm) control "Traveler" wire)



NOTE: Try to keep the copper exposed at the same lengths. Use the wire cutters in case more copper needs to be exposed or cut if it is too long.

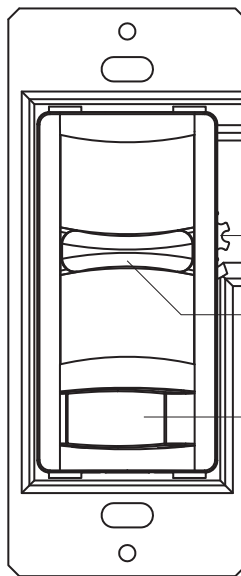

Trim Adjustment Wheel

Dimming Slider

On/off Rocker Switch

LIMITED WARRANTY

This product is warranted to be free from defects in workmanship and materials for up to 1 year from date of purchase. If it fails to do so, please contact Feit Electric at info@feit.com or call 1-866-326-BULB (2852) for instructions on replacement. This replacement is the sole remedy available and liability for incidental or consequential damage is expressly excluded. Do not return the product to the store. For comments please contact: Feit Electric Customer Service 4901 Gregg Road, Pico Rivera, CA 90660. www.feit.com.

NOTE: Dimmable LEDs may not dim as low as incandescent bulbs. Dimming range of dimmable LEDs can vary from manufacturer to manufacturer. This dimmer has an adjustable dimming range. If your bulbs do not dim to your satisfaction, hum, buzz or flicker adjust your trim and review the troubleshooting section for help.

Compatible with Feit Electric dimmable LED bulbs and most other dimmable LED bulbs. Dimming performance may not be the same or similar to dimming of incandescent bulbs. Some possible dimming variations include but are not limited to: less dimming range than an incandescent bulb; dimming less smooth than an incandescent bulb; flicker or shimmer at certain light levels; and, buzzing or humming at certain light levels. Feit Electric warrants the compatibility of this dimmer with Feit Electric LED dimmable bulbs and replacement of the dimmer is the sole remedy for incompatibility. Feit Electric does not warrant the compatibility of this dimmer with any other particular LED bulb.

If you experience flickering when using the dimmer, move the dimmer control to full and readjust the dimming setting.

FEIT ELECTRIC COMPANY
Pico Rivera, CA, USA
(800) 543-3348 | FAX (562) 908-6360
www.feit.com

MODEL: DIM/SLIDE/2

FEIT
ELECTRIC

SLIDE DIMMER SWITCH

Works with
incandescent, halogen, CFL
and dimmable LEDs
(Dimmer does not work with smart bulbs)

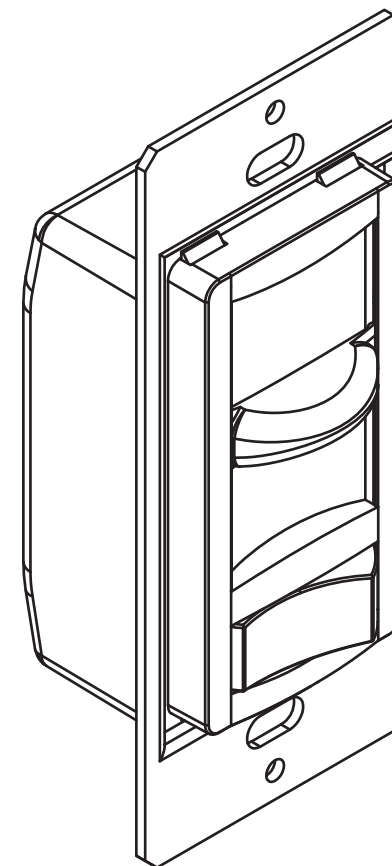

120 Volt • 60Hz
600 Watt MAX incandescent
200 Watt MAX dimmable LED

Installing Dimmers



NOTE: FOR ALL THE STEPS BELOW IF YOU ARE NOT CERTAIN YOU HAVE THE WIRING DESCRIBED, CONSULT A QUALIFIED ELECTRICIAN FOR ASSISTANCE.

1 TURN POWER OFF



WARNING: SHOCK HAZARD. MAY RESULT IN SERIOUS INJURY OR DEATH. **TURN OFF POWER AT CIRCUIT BREAKER BEFORE INSTALLING DIMMER**

2 REMOVE EXISTING DIMMER OR SWITCH

Take off wall-plate and switch by removing mounting screws. Carefully pull out switch from wall (**do not remove wires**).

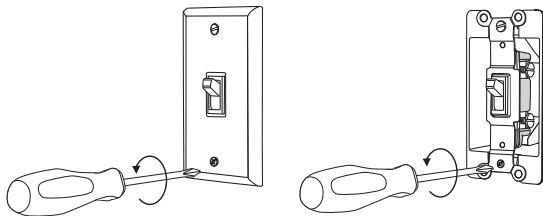

3 IDENTIFY THE TYPE OF CIRCUIT

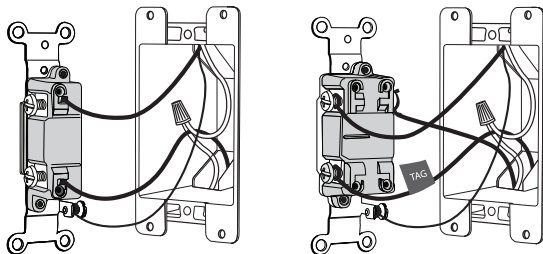

SINGLE-POLE:

If switch is wired with Black(hot) insulated wires connected to two screws of the same color.

Go to Step 4a.

NOTE:

If you are not sure, contact a certified electrician.

3-WAY:

If switch is wired with insulated Black (HOT) wires and connected to three screws and one of these wires is connected to a screw of a different color (not green) or labeled COMMON, **mark or tag this wire to identify it when wiring.**

Go to Step 4b.

4 WIRE YOUR NEW DIMMER

4a Single Pole Circuit



NOTE: The red and white wires are only used for dual control application connections, in single control application connections, screw on the wire nut for protection.

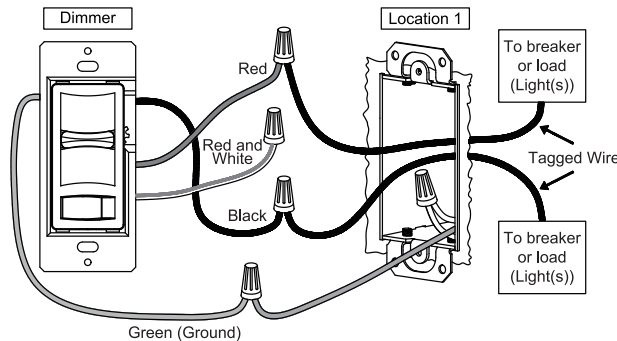

LOCATION 1 WIRING

- Connect the **green or bare** dimmer ground wire to the green or bare copper ground wire in the wall-box and tighten using the provided wire nuts.
- Connect one of the **red** dimmer wires going to load removed from the switch and screw together using the provided wire nuts.
- Connect the **black** dimmer wire to the hot input wire removed from the switch and tighten using the provided wire nuts.
- Use the remaining wire nut to cap the remaining **red & white** wire on dimmer.

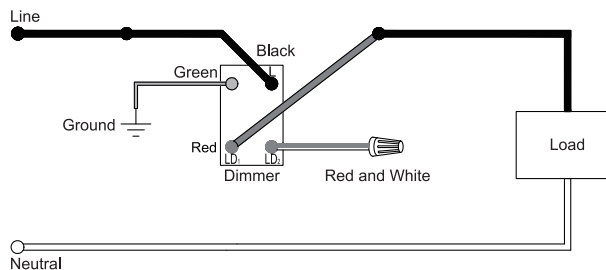

NOTE: Screw and tighten nut after every wire installation. Do a quick pull test to ensure it does not come off easily. Do NOT overtighten.

4b 3-Way Circuit

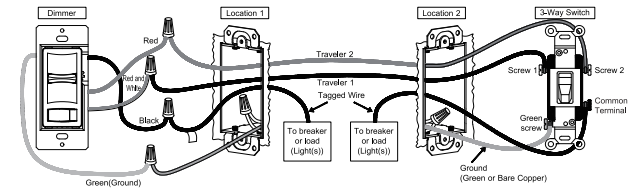

LOCATION 1 WIRING

- Connect the **green** wire on the dimmer to the green or bare copper ground wire on the wall box and screw on using the provided wire nuts to tighten.
- Connect the **black** wire on the dimmer wire to the tagged wire removed from the switch. This could be the load wire or live wire from the circuit breaker. Screw together using the wire nuts provided.
- Connect the **red & white** wires from the dimmer to the Traveler 1 and screw on using the wire nuts to tighten.
- Connect the **red** wire from the dimmer to Traveler 2 and screw it on tightly with the wire nuts provided.

LOCATION 2 WIRING

- Traveler 1 is connected to Screw 1 of the 3-way switch.
- The common terminal of the 3-way Switch is connected to the live wire end of the circuit breaker or the load line.
- Traveler 2 is connected to the Screw 2 of the 3-way switch.



NOTE: Screw and tighten nut after every wire installation. Do a quick pull test to ensure it does not come off easily. Do NOT overtighten.

IMPORTANT:
In a 3-WAY circuit, only one dimmer can be used

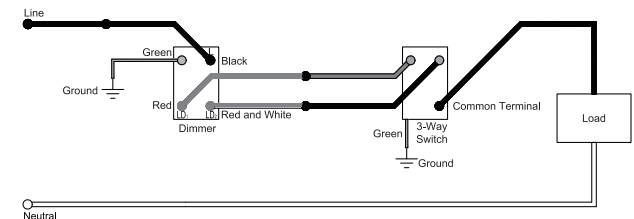

Installing Dimmers Continued

5 INSERT DIMMER INSIDE THE SWITCH BOX

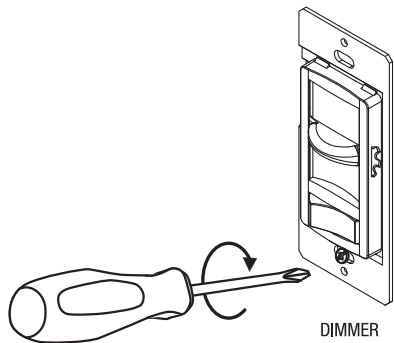

- Position all wires inside the switch box with care, leaving enough room to insert the dimmer housing.
- With the mounting screws provided, mount the dimmer securely inside the switch box.

6 TURN POWER ON

- Turn on the power at the circuit breaker. Try out your new dimmer and ensure it is operating correctly before proceeding.
- If you are not satisfied with the dimming range and light output of your bulbs, proceed to the next steps.

NOTE: Dimmable LEDs may not dim as low as incandescent or halogen bulbs. The dimming range of dimmable LEDs can vary depending on manufacturer. If your bulb do not dim to your satisfaction, especially the dimmer range and minimum brightness level, use the adjustment wheel found on your dimmer.

7 TESTING

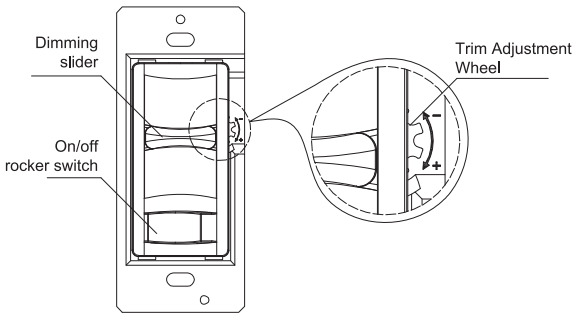

- Move the dimming slider to the 30-50% position. Push the rocker switch to the ON position to turn on the lights. Move the dimming slider down to the lowest setting.
- Slowly turn the trim adjustment wheel to the lowest brightness level where the light output for all the bulbs is stable and does not flicker or flash.
- Push the rocker switch off and back on after one second. Verify that all the bulbs turn on, are stable, and do not flicker or flash.
- If all or some bulbs do not turn on or you are not satisfied with the minimum brightness level of the bulbs, turn the trim adjustment wheel clockwise (+) slowly until all the bulbs work or the minimum brightness level is achieved. The repeat step 3.
- Ensure that all the bulb turn on and achieve minimum brightness level when the rocker switch is in the ON position and the dimming slider is in the lowest position. Please test it for full dimming range.

8 INSTALL WALL PLATE

Place the decorative wall plate over the installed mounting frame with the top first then the bottom. Gently push wall plate to ensure flush fit.

NOTE: DECORATIVE WALL PLATE NOT INCLUDED

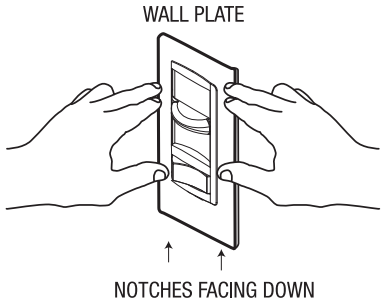

Troubleshooting

| PROBLEM | POSSIBLE CAUSE | SOLUTION |
|---|--|--|
| Lights flickering | Lamp has a bad connection | Reconnect and fix the wires |
| LED and CFL bulbs flicker at low end of the dimming range | Adjust the adjustment wheel | Turn up the minimum brightness value, see step 7 for details |
| Long stroke at the low end of dimmer | Long stroke at the low end of dimmer | Turn up the minimum brightness value, see step 7 for details |
| Light does not turn on | The circuit breaker has tripped | Turn power on |
| | The fuse burned out | Change the fuse |
| | The lamp burned out | Change the lamp |
| | The lamp neutral connection is not wired | Reconnect the lamp neutral |