

INSTRUCTION MANUAL

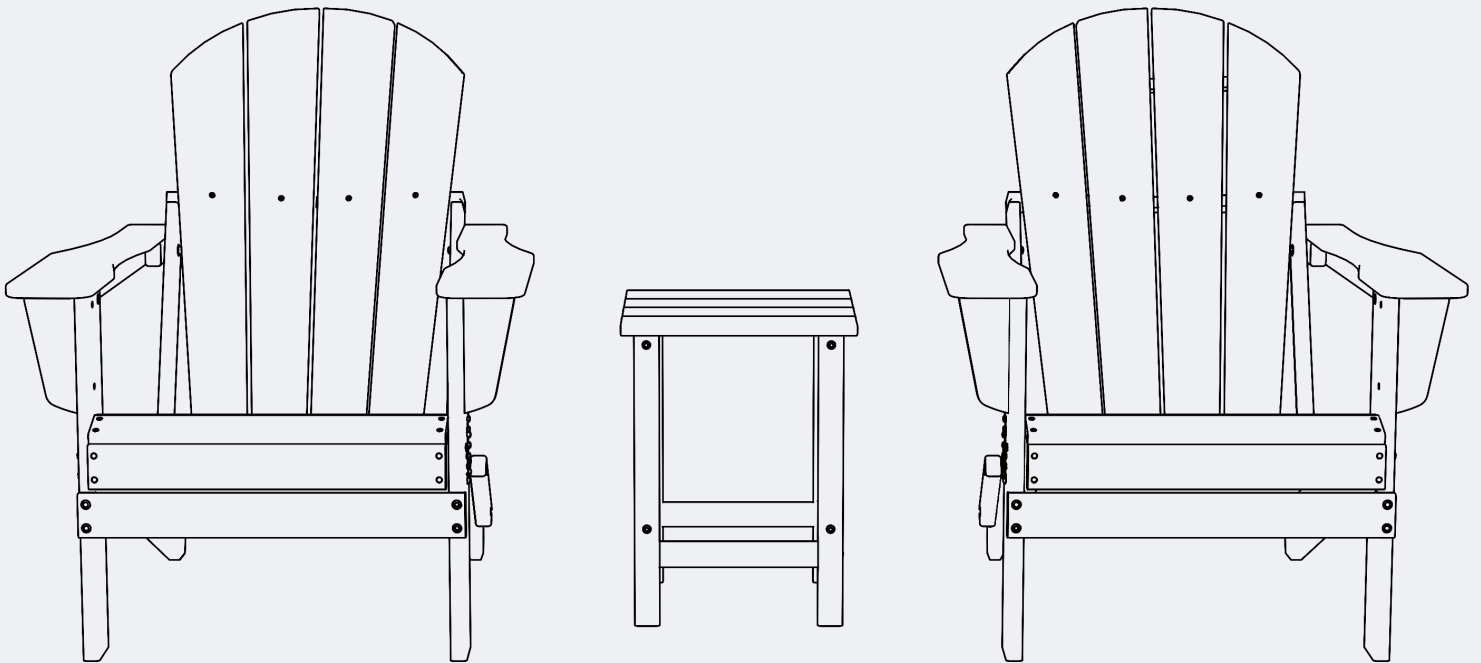

3PC Outdoor Poly Adirondack Chair Set
with Side Table

V1.0

TABLE OF CONTENTS

ASSEMBLY INSTRUCTIONS

Outdoor Folding Poly Adirondack Chair..... 3

Outdoor Poly Adirondack Side Table 9

INSTRUCTION MANUAL

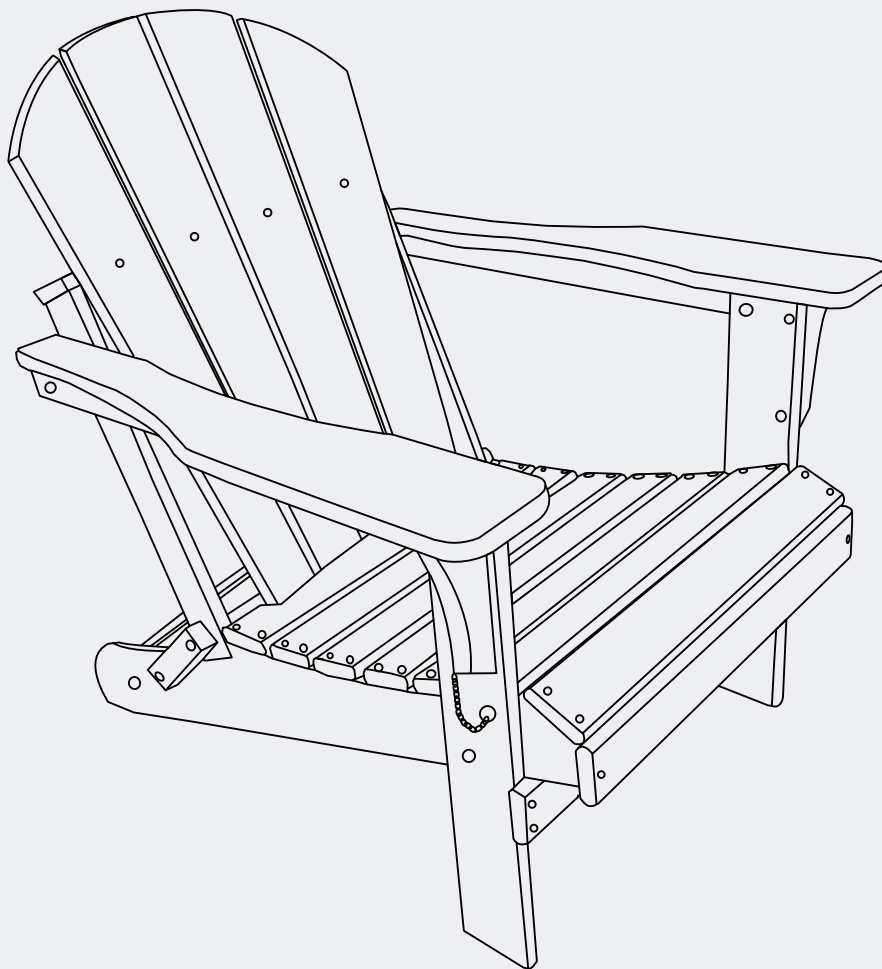

Outdoor Folding Poly Adirondack Chair

⚠ NOTICE

Do not overtighten screws. (Insert all screws before tightening screws.)

- Please do not exceed the weight limitations of this item.
- Do not stand on or use any part of this item as a step ladder.
- Firmly secure all bolts, screws and nuts before use.
- Reconfirm that all bolts, screws, and nuts are secure every 90 days.
- Do not use or store this item in the proximity of open flame or flammable/combustible chemicals.
- Be aware that some parts are heavy and have sharp edges.
- Be very careful when folding chair to avoid smashing your hands or fingers.

TOOLS REQUIRED

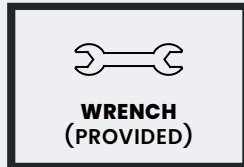
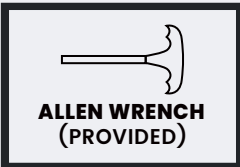

**CHAIR
330 LBS
CAPACITY**



**1 PERSON
ASSEMBLY**



**UP TO 30 MIN.
ASSEMBLY**

HARDWARE

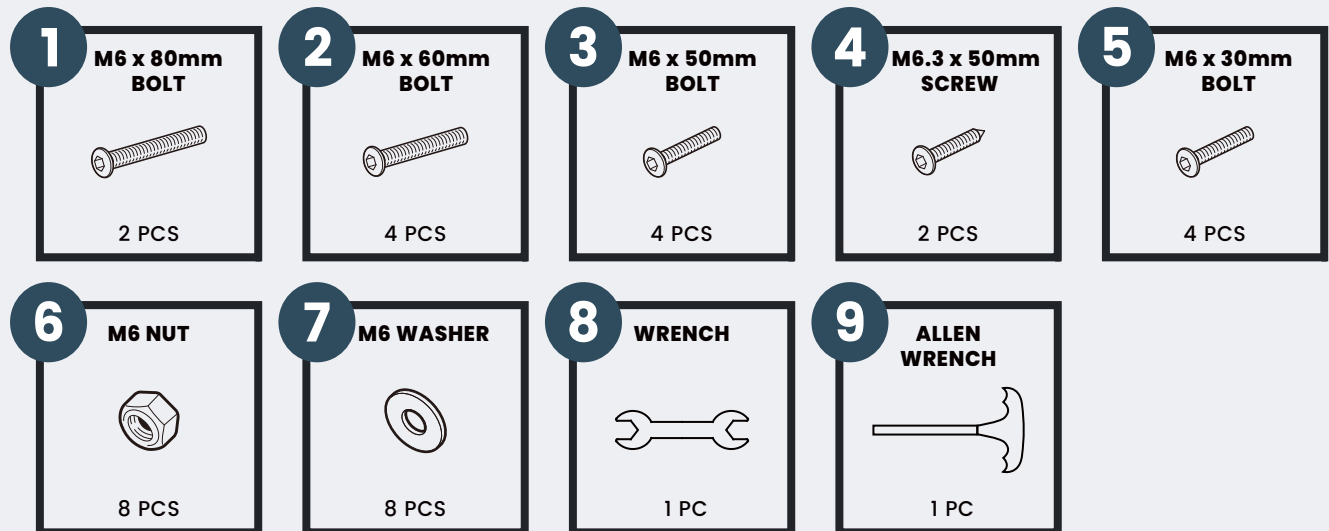

PARTS

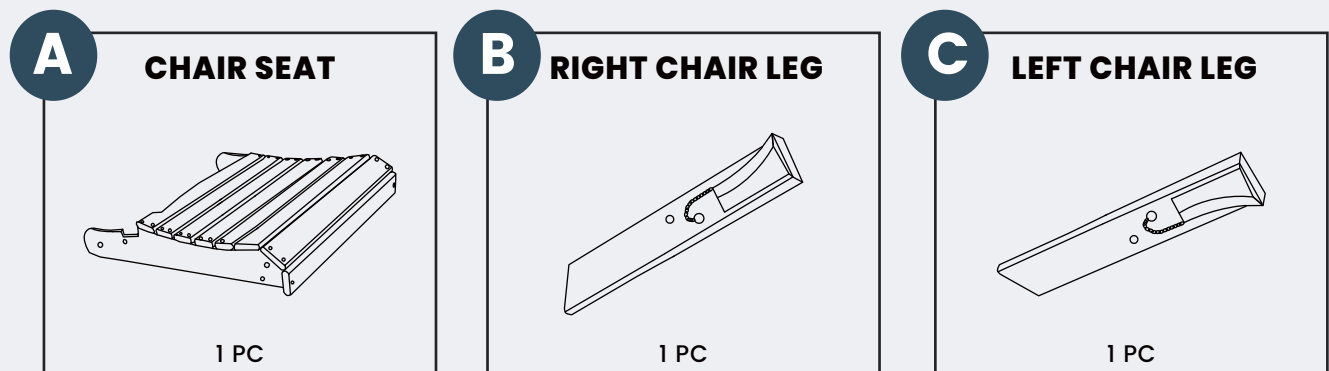

PARTS

D**RIGHT CHAIR ARM**

1 PC

E**LEFT CHAIR ARM**

1 PC

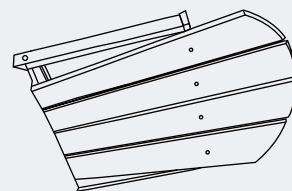
F**CHAIR BACKREST**

1 PC

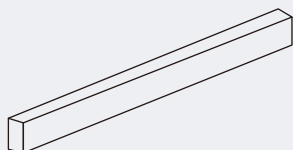
G**BACK RAIL**

1 PC

H**FRONT RAIL**

1 PC

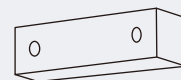
I**LOCKING BLOCK**

2 PCS

PRODUCT ASSEMBLY – OVERALL VIEW

Look at following overall view of this chair and learn the exact position of each part to be assembled.

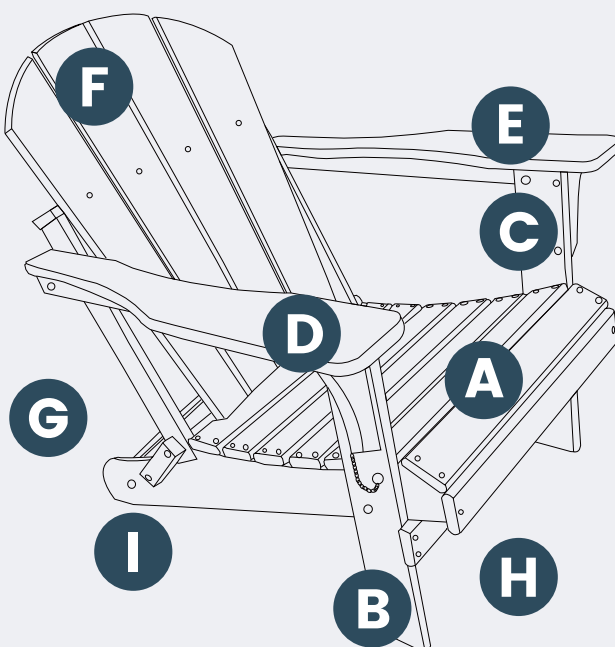

PRODUCT ASSEMBLY

1

Attach **Part C Left Chair Leg** to **Part E Left Chair Arm** with 1 pc of **Hardware #2 Bolt** and **Hardware #7 Washer** and **Hardware #6 Nut**. Do same to **Part B Right Chair Leg** and **Part D Right Chair Arm**. Attach the locking pin to the chair legs with a screw driver before assembly.

Do not tighten screws too much at this stage.

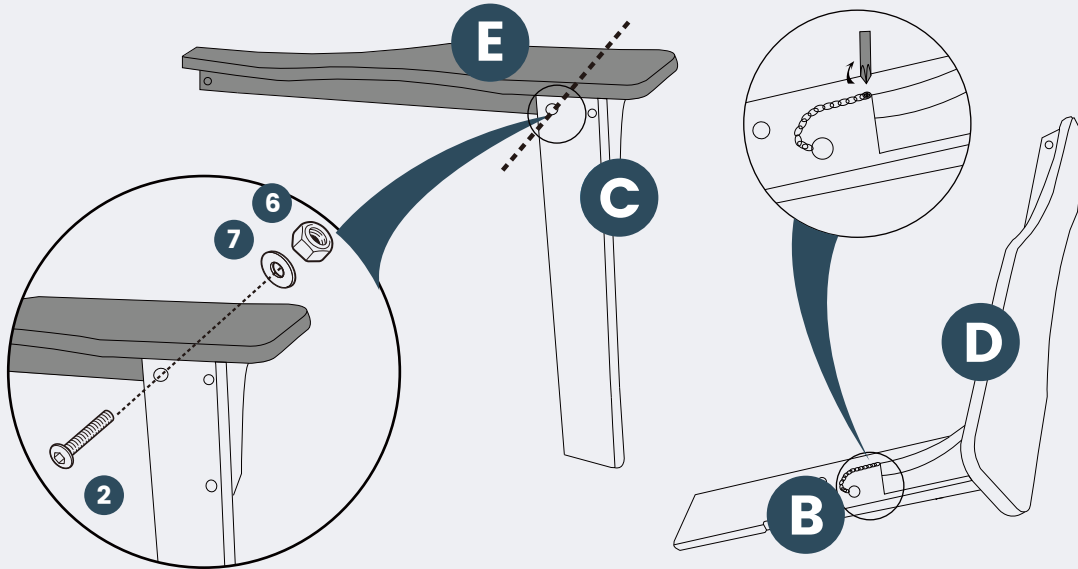

2

Attach **Part B Right Chair Leg** and **Part C Left Chair Leg** to **Part A Chair Seat** with 2 pcs of **Hardware #2 Bolt**, **Hardware #7 Washer** and **Hardware #6 Nut**.

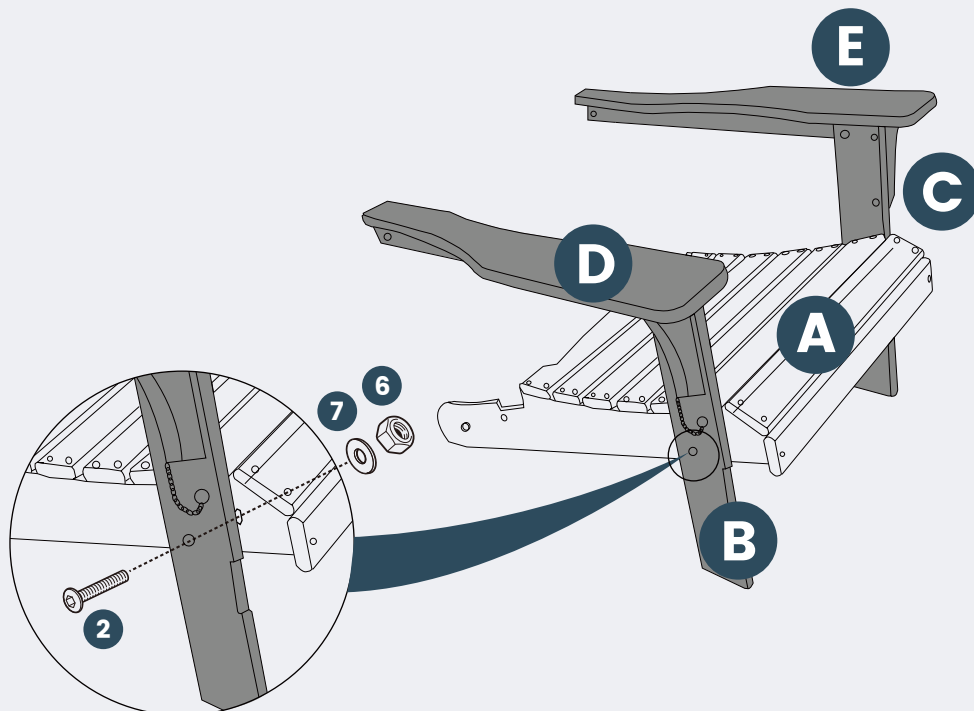

PRODUCT ASSEMBLY

3

Fix **Part F Backrest** into **Part A Chair Seat** and then attach **Part F Chair Backrest** to **Part D Right Chair Arm** with 1 pc of **Hardware #1 Bolt**, **Hardware #7 Washer** and **Hardware #6 Nut**.

Do the same to attach **Part F Backrest** to **Part E Left Chair Leg**.

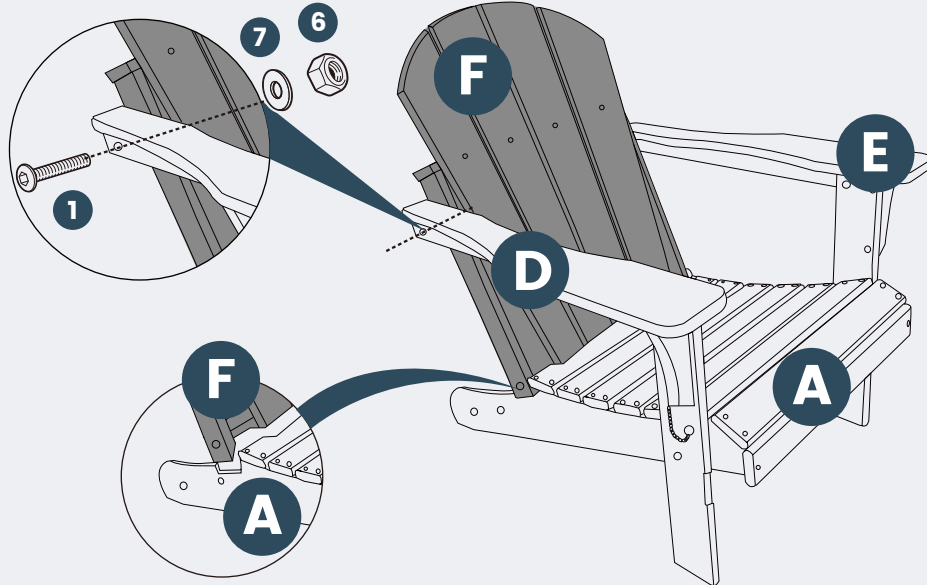

4

Attach **Part I Locking Blocks** to **Part F Chair Backrest** (both sides) with 2 pcs of **Hardware #4 Screw** and attach **Part I Locking Blocks** to **Part A Chair Seat** (both sides) with 2 pcs of **Hardware #3 Bolt**, **Hardware #7 Washer** and **Hardware #6 Nut**.

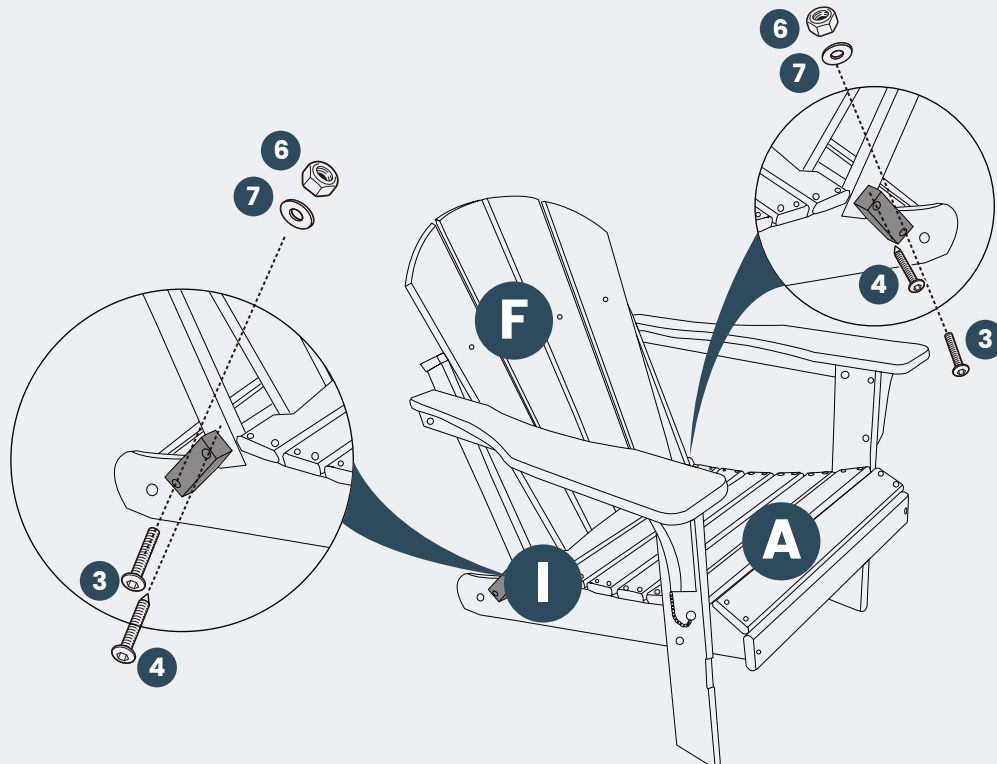

PRODUCT ASSEMBLY

5

Attach **Part G Back Rail** to **Part A Chair Seat** with 2 pcs of **Hardware #3 Bolt**.

Attach **Part H Front Rail** to **Part B Left Chair Leg** and **Part C Right Chair Leg** with 4 pcs of **Hardware #5 Bolt**.

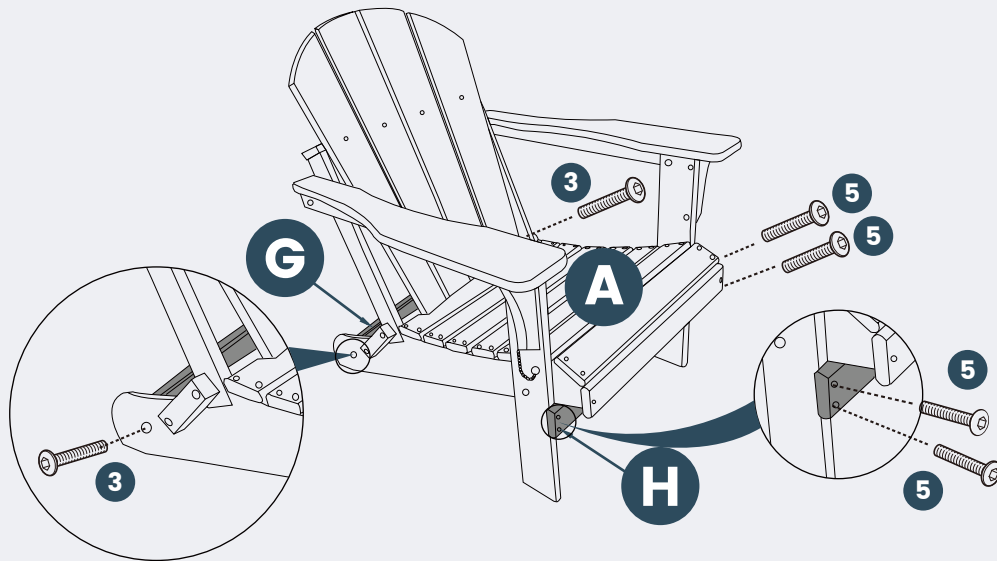

Congratulations! You finished the assembly of this chair.

Pull the locking pin out of both legs to fold this chair as below.

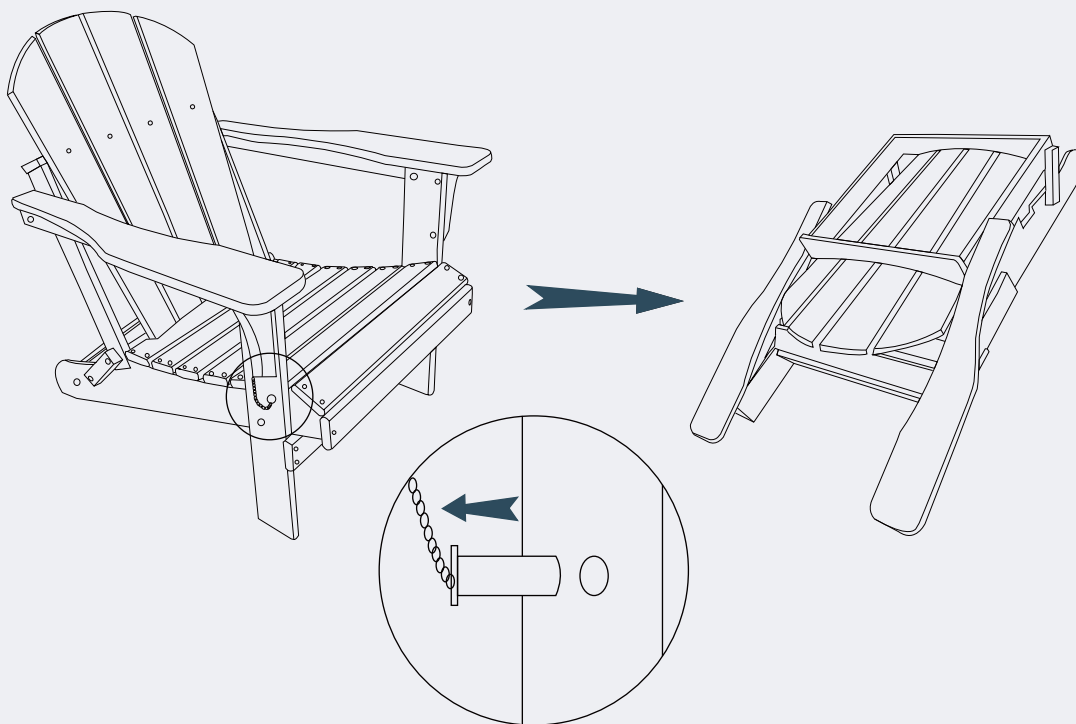

INSTRUCTION MANUAL

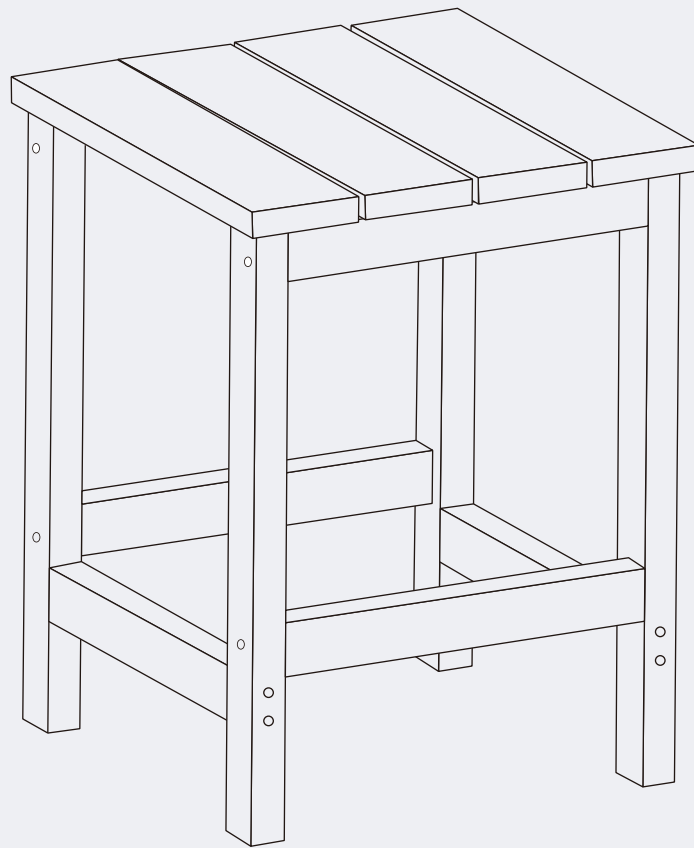

Outdoor Poly Adirondack Side Table

! NOTICE

Do not overtighten screws or bolts. (Insert all screws before tightening screws.)

- Please do not exceed the weight limitations of this item.
- Do not stand on or use any part of this item as a step ladder.
- Firmly secure all bolts, screws and nuts before use.
- Reconfirm that all bolts, screws, and nuts are secure every 90 days.
- Do not use or store this item in the proximity of open flame or flammable/combustible chemicals.
- Avoid using strong power tools to prevent cracking the PE boards when assembling.

TOOLS REQUIRED



**TABLE
100 LBS
CAPACITY**



**1 PERSON
ASSEMBLY**



**UP TO 20 MIN.
ASSEMBLY**

HARDWARE

1

**BOLT
M6 x 45mm**



8 PCS

PARTS

A

TABLE TOP

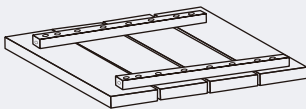

1 PC

B

TABLE LEG

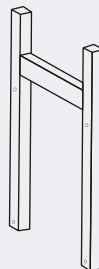

2 PCS

C

WOODEN BRACE

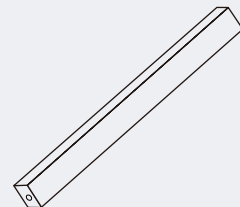

2 PCS

PRODUCT ASSEMBLY

1

Attach **Part B Table Leg** to **Part A Table Top** with 2 pcs of **Hardware #1 Bolt** using an **Allen Wrench**.

Do not tighten the bolts too much at this stage.

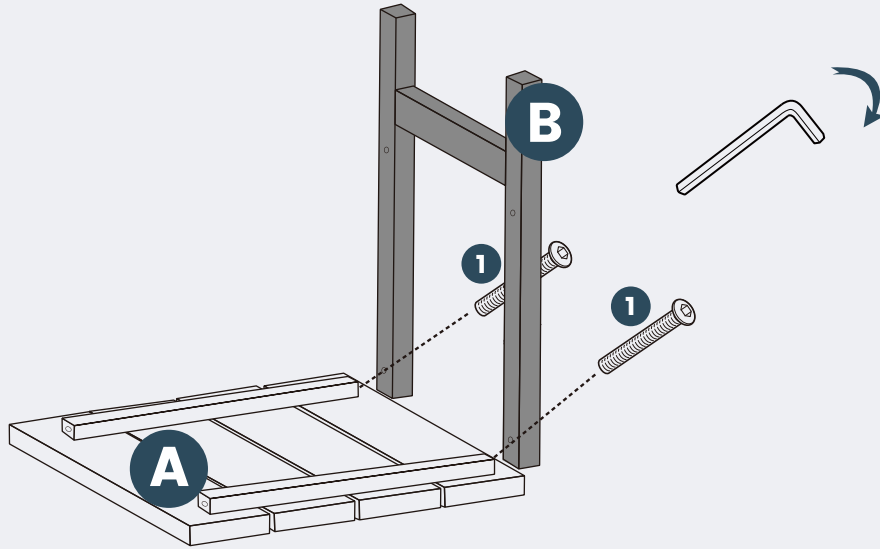

2

Attach **Part C Table Wooden Braces** to **Part B Chair Legs** with 2 pcs of **Hardware #1 Bolt**.

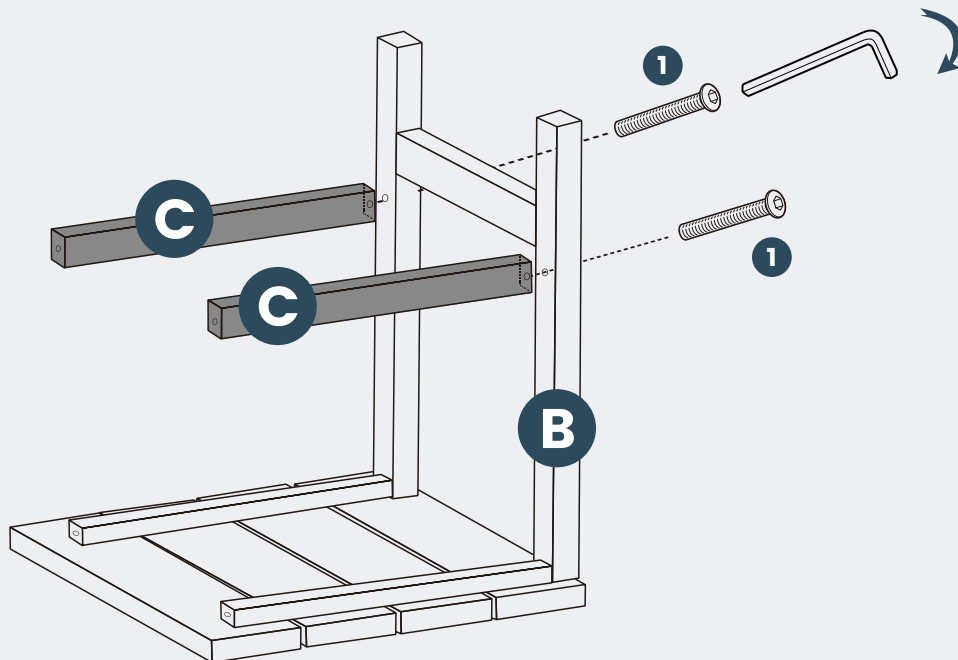

PRODUCT ASSEMBLY

3

Attach **Part B Table Leg** to **Part A Table Top** and **Part C Wooden Brace** with 2 pcs of **Hardware #1 Bolt** using an **Allen Wrench**.

Tighten all bolts and screws to finish the assembly.

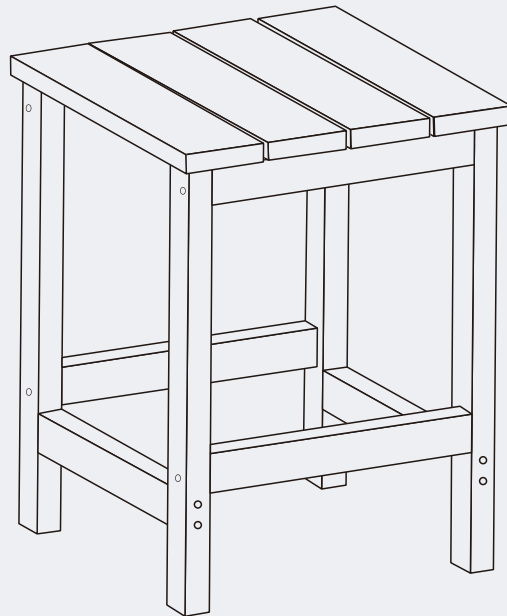
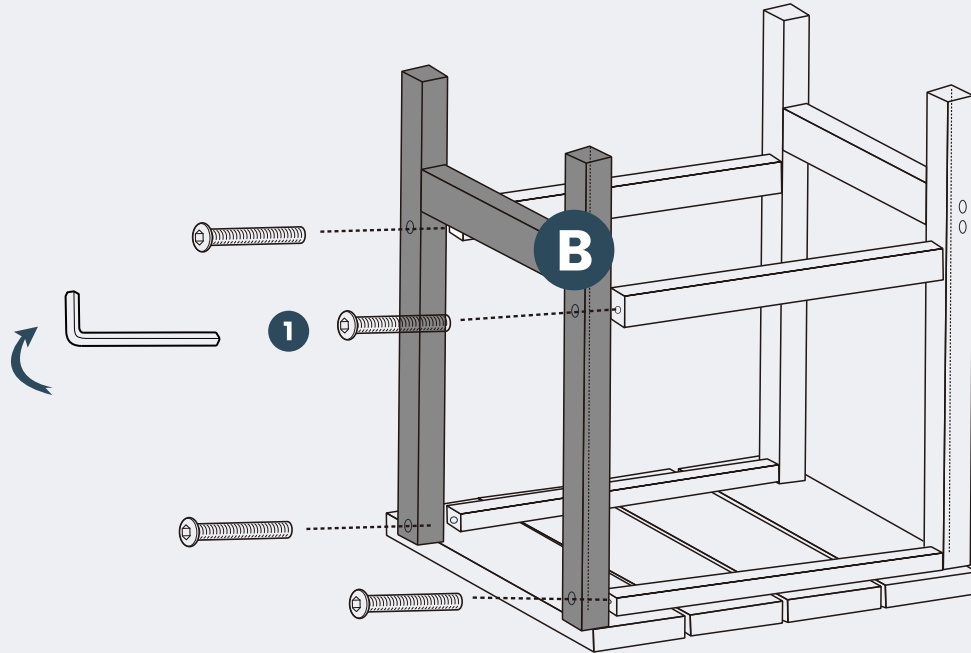

CLEANING TIPS

REGULAR CLEAN: Use a mixture of warm water and mild soap. Gently scrub the surface with a soft bristle brush to remove any dirt or stains.

QUICK CLEAN: You can simply wipe down the furniture with a damp cloth.

Regular cleaning not only preserves the aesthetic appeal of your furniture, but also helps extend its lifespan.