

# Model 161-PA18A Plastic Arm Chair

## Parts Listing

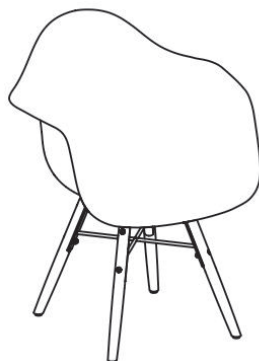
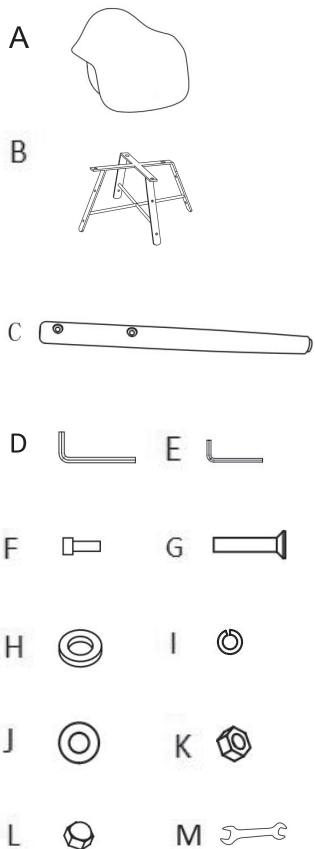

## Assembly Instructions

Tools Needed: Allen Wrench and Open End Wrench (provided)



Please read all instructions before assembly

Step 1: Attach the beech wooden leg (C) to frame(B) as below drawing showing.

Use 4 screws (G) with 4 nuts (K) to fix the 4 wooden legs. Tighten all screws with Allen Wrench (E) and Open End Wrench (M). Then put the 4 plastic cap (L) to the nuts (K);

Step 2: Remove 4 white plugs under the seat, put 4 black plastic gaskets (H) on the seat (A). Attach the leg on the seat (A), use 4 screws (F) with 4 spring washer (I) and 4 gasket (J) fix the leg to the seat. Tighten all screws with Allen Wrench (D)

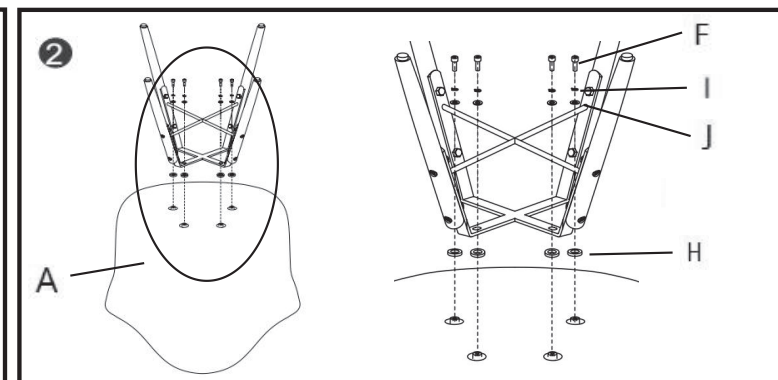
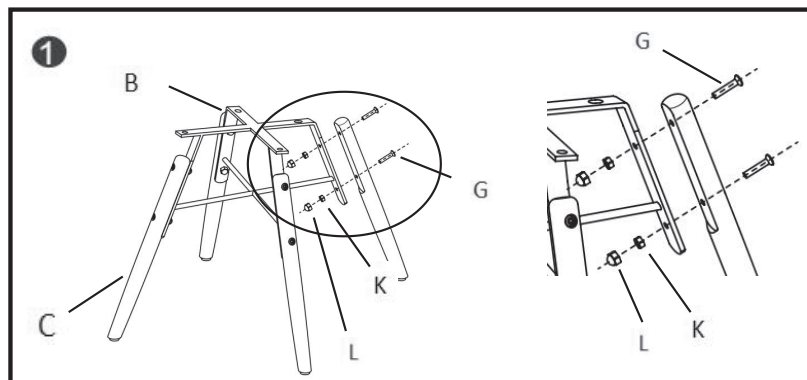

### Assembly Notes:

During assembly, hand tighten screws only. When all screws are in place, you may then tighten all screws completely.

### CAUTION:

1. Do not use this chair as a step ladder.
2. Check for loose screws and tighten them every 6 months.

*ofm*

161 Tradition Trail, Holly Springs, NC, 27540  
800-520-7471 (voice) 919-362-4765 (fax)  
919-303-6389 (voice) [www.ofminc.com](http://www.ofminc.com)  
[support@ofminc.com](mailto:support@ofminc.com)