

# SHIMANO

## SLX

## SLX150XG

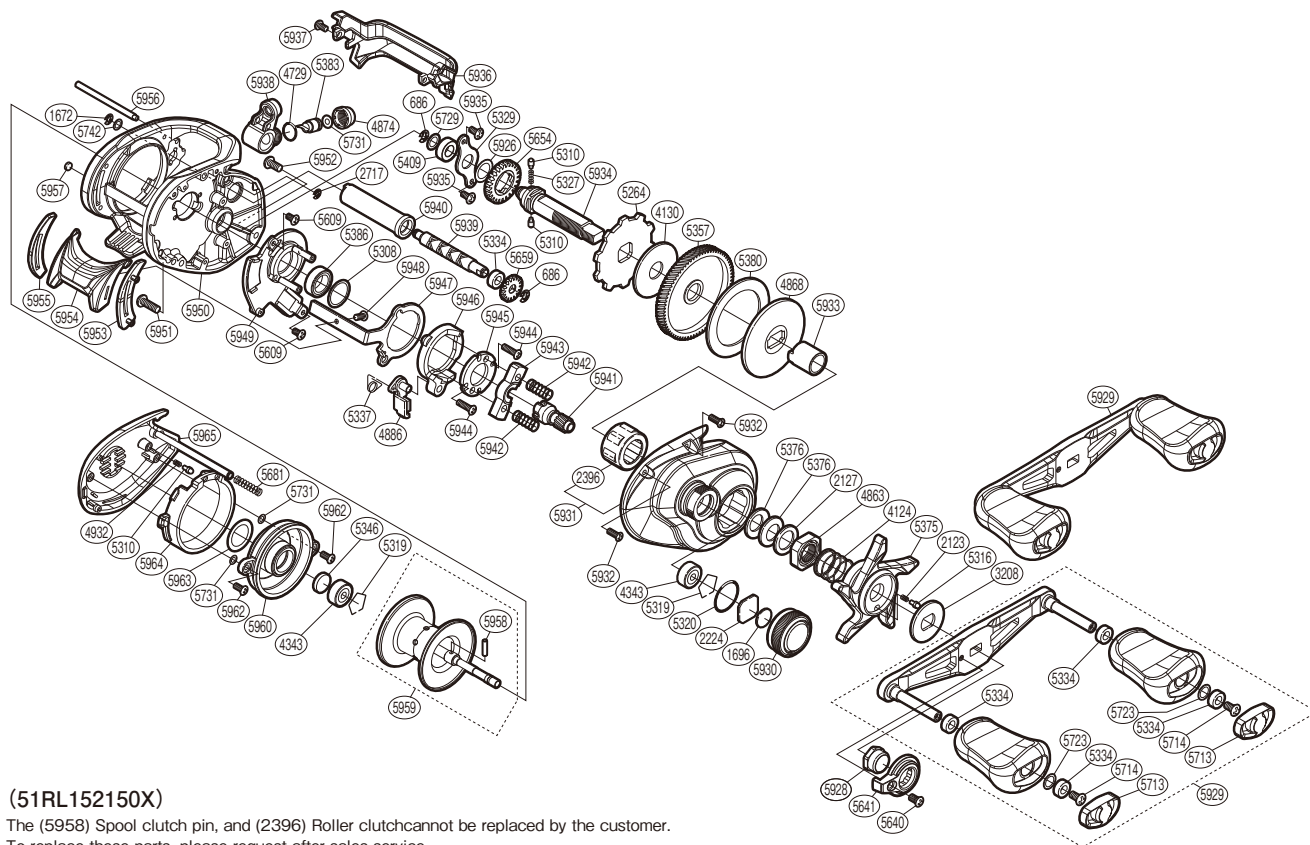

### (51RL152150X)

The (5958) Spool clutch pin, and (2396) Roller clutch cannot be replaced by the customer.  
To replace these parts, please request after-sales service.

#	Part No.	Description	#	Part No.	Description	#	Part No.	Description
686	105NK	E Lock	5375	10R0G	Star Drag	5939	100U6	Worm Shaft
1672	105NC	E Lock	5376	109F5	Drag Spring Washer	5940	100UF	Level Wind Guard
1696	10896	Cast Control Spacer (B)	5380	10R3D	Drag Washer	5941	100U7	Pinion Gear
2123	10BT2	Click Spring	5383	10BHQ	Line Guide Pawl	5942	100U9	Yoke Spring
2127	10J1N	Star Drag Spacer	5386	10EX6	Ball Bearing	5943	100UH	Yoke
2224	1085F	Spool Tension Spacer (A)	5409	10DQF	Drive Shaft Bushing	5944	10LV0	Screw
2396	10F5C	Roller Clutch Bearing	5609	10LCT	Screw	5945	100US	Clutch Cam Retainer
2717	105NB	E Lock	5640	101VV	Screw	5946	100UK	Clutch Cam
3208	10J22	Star Drag Click Plate	5641	10SSK	Handle Nut Plate	5947	100UG	Clutch Plate
4124	10A70	Star Drag Spring	5654	101K8	Idle Gear	5948	10LF4	Screw
4130	10CHX	Drag Washer	5659	10SRL	Idle Gear	5949	10DUK	Clutch Guard Assembly
4343	105C3	Ball Bearing	5681	10KNH	Spring	5950	100MJ	Frame
4729	108WQ	O Ring	5713	10SS2	Handle Knob Seal	5951	100UU	Screw
4863	10A3T	Star Drag Nut	5714	10LF4	Screw	5952	100UV	Screw
4868	10D3H	Key Washer	5723	1003Z	Washer	5953	100MH	Clutch Bar Guide B
4874	10FJB	Pawl Cap	5729	1003V	Washer	5954	100ML	Clutch Button
4886	10MME	Clutch Pawl	5731	1003S	Washer	5955	100MW	Clutch Bar Guide A
4932	10GQZ	Click Spring	5742	10S42	Washer	5956	100UT	Stabilizer Bar
5264	10D73	Anti-reverse Ratchet	5926	1023S	Washer	5957	10DTF	Washer
5308	10190	Washer	5928	10E67	Handle Nut	5958	10P67	Spool Pin
5310	10HJG	Idle Gear Pin	5929	1010G	Handle Assembly	5959	10DUH	Spool Assembly
5316	10MFC	Click Pin	5930	10TZQ	Cast Control Cap	5960	13X9B	Dial Case
5319	1054D	Bearing Retainer	5931	13X9C	Right Side Plate Assembly	5962	100UL	Screw
5320	10R22	O Ring	5932	10LCY	Screw	5963	10DUM	Washer
5327	10JDY	Idle Gear Spring	5933	100UC	Roller Clutch Inner Tube	5964	100UQ	Left Side Plate Cam Lever
5329	109T1	Drive Shaft Retainer	5934	100UP	Drive Shaft	5965	10DUJ	Left Side Plate Assembly
5334	10PXZ	Bushing	5935	10E23	Screw			
5337	10R1H	Clutch Pawl Spring	5936	10DUL	Level Wind Protector Unit			
5346	10EX5	Spacer B	5937	100U4	Screw			
5357	10R0D	Drive Gear	5938	10DUG	Line Guide Assembly			

Please note that the number of adjusting washers may not be the same as shown in the exploded views.  
(Adjustment will vary with each individual product.)