

SHIMANO

CALCUTTA CONQUEST

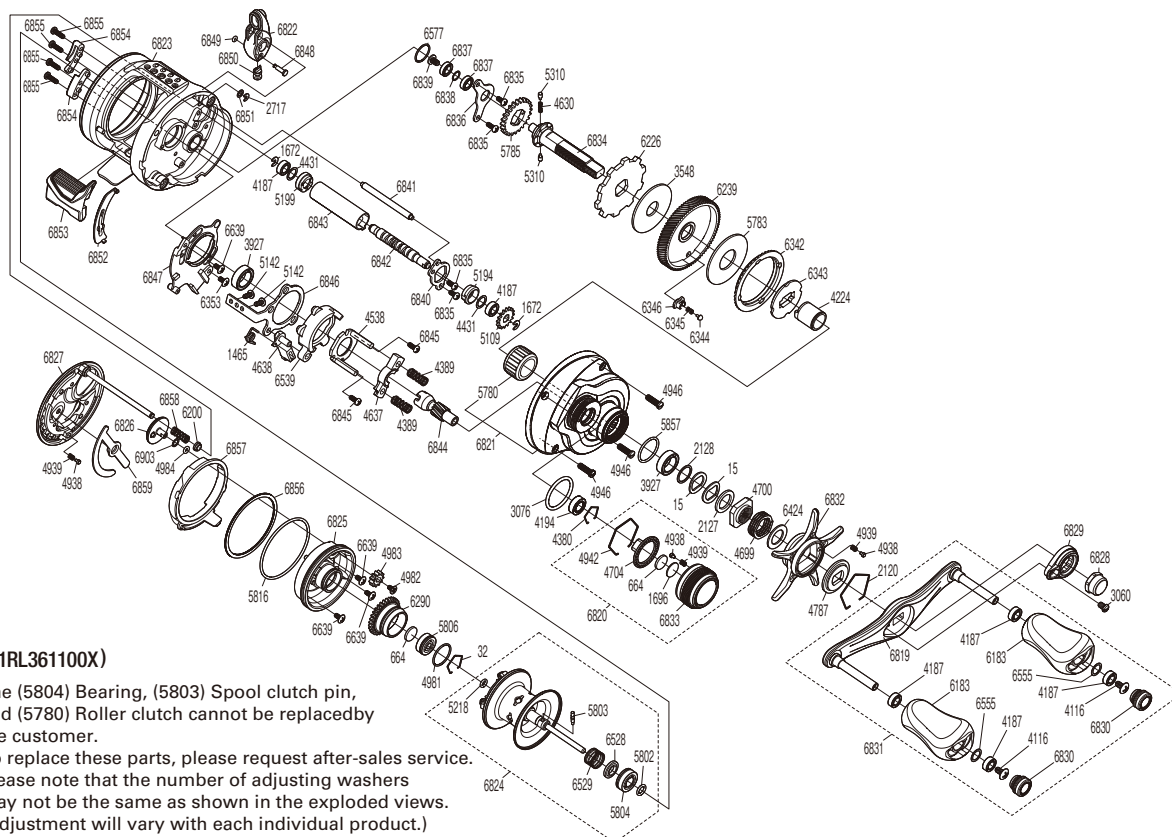

21CQ100HG



(51RL361100X)

The (5804) Bearing, (5803) Spool clutch pin, and (5780) Roller clutch cannot be replaced by the customer.

To replace these parts, please request after-sales service. Please note that the number of adjusting washers may not be the same as shown in the exploded views. (Adjustment will vary with each individual product.)

Part No.	Description	Part No.	Description	Part No.	Description
BNT0015	Drag Spring Washer	BNT5142	Screw	BNT6825	Dial Case Assembly
BNT0032	Bearing Retainer	BNT5194	Worm Bushing A	BNT6826	Br Dial Assembly
BNT0664	Washer	BNT5199	Worm Bushing B	BNT6827	Left Side Plate Assembly
BNT1465	Clutch Pawl Spring	BNT5218	O Ring	BNT6828	Handle Nut
BNT1672	E Lock	BNT5310	Idle Gear Pin	BNT6829	Handle Retainer
BNT1696	Cast Control Spacer	BNT5780	Roller Clutch Bearing	BNT6830	Handle Knob Seal
BNT2120	Click Plate Retainer	BNT5783	Drag Washer	BNT6831	Handle Assembly
BNT2127	Star Drag Spacer	BNT5785	Idle Gear	BNT6832	Star Drag
BNT2128	Bearing Washer	BNT5802	O Ring	BNT6833	Cast Control Cap
BNT2717	E Lock	BNT5803	Spool Clutch Pin	BNT6834	Drive Shaft
BNT3060	Screw	BNT5804	Ball Bearing	BNT6835	Screw
BNT3076	O Ring	BNT5806	Ball Bearing	BNT6836	Drive Shaft Retainer
BNT3548	Drag Washer	BNT5816	O Ring	BNT6837	Ball Bearing
BNT3927	Ball Bearing	BNT5857	O Ring	BNT6838	Washer
BNT4116	Screw	BNT6183	Handle Knob	BNT6839	Screw
BNT4187	Ball Bearing	BNT6200	Damper Guide	BNT6840	Worm Bushing Retainer
BNT4194	Ball Bearing	BNT6226	Anti-Reverse Ratchet	BNT6841	Level Wind Guide
BNT4224	Roller Clutch Inner Tube	BNT6239	Drive Gear	BNT6842	Worm Shaft
BNT4380	Retainer	BNT6290	Brake Pipe Gear Assembly	BNT6843	Level Wind Guide
BNT4389	Yoke Spring	BNT6342	Drag Click Ratchet	BNT6844	Pinion Gear
BNT4431	Washer	BNT6343	Key Washer	BNT6845	Screw
BNT4538	Clutch Cam Retainer	BNT6344	Drag Click	BNT6846	Clutch Plate
BNT4630	Idle Gear Spring	BNT6345	Click Spring	BNT6847	Clutch Guard
BNT4637	Yoke	BNT6346	Drag Click Pin Holder	BNT6848	Oscillating Slider Retainer
BNT4638	Clutch Pawl	BNT6353	Screw	BNT6849	O Ring
BNT4699	Star Drag Spring	BNT6424	Washer	BNT6850	Line Guide Pawl
BNT4700	Star Drag Nut	BNT6528	Bushing	BNT6851	Washer
BNT4704	Cast Control Click Plate	BNT6529	Bearing Pressure Spring	BNT6852	Clutch Bar Guide
BNT4787	Star Drag Click Plate	BNT6539	Clutch Cam	BNT6853	Clutch Button Assembly
BNT4938	Click Pin	BNT6555	Washer	BNT6854	Brake Case Cam
BNT4939	Click Spring	BNT6577	O Ring	BNT6855	Screw
BNT4942	Cast Control Click Holder	BNT6639	Screw	BNT6856	Washer
BNT4946	Screw	BNT6819	Handle Shank Assembly	BNT6857	Left Side Plate Cam Lever
BNT4981	O Ring	BNT6820	Cast Control Cap Assembly	BNT6858	Damper Spring
BNT4982	Screw	BNT6821	Right Side Plate Assembly	BNT6859	Left Side Plate Seal
BNT4983	Br Dial Gear	BNT6822	Line Guide Pawl Holder Assembly	BNT6903	Washer
BNT4984	O Ring	BNT6823	Frame Assembly		
BNT5109	Idle Gear	BNT6824	Spool Assembly(With Bearing)	BNT4692	B-100 Oil (accessory)