

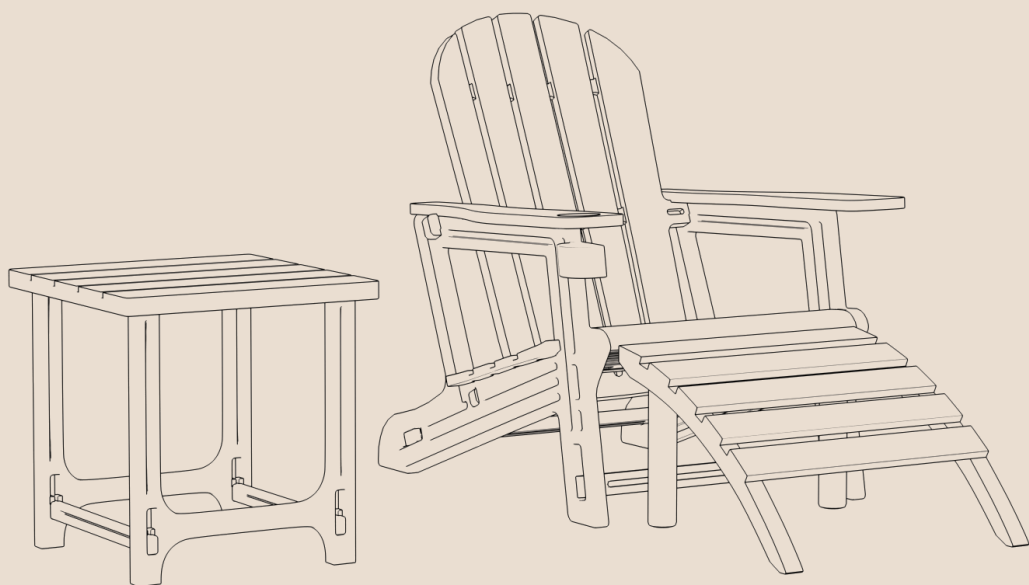

DESIGNED IN CALIFORNIA



— OUTDOOR POLY 3-PIECE SET ADIRONDACK —
CHAIR WITH OTTOMAN AND SIDE TABLE

THANK YOU!

We appreciate you for choosing WestinTrends!

Thank you for letting WestinTrends continue to offer accessible luxury trends, inspired by everyone!

JOIN THE WESTINTRENDS COMMUNITY

Sign up here:

<https://westintrends.com/welcome>



QUESTIONS OR COMMENTS?

If you have questions reach out to
cs@westintrends.com

FOLLOW, SHARE, & LEARN



PRODUCT REGISTRATION

<https://westintrends.com/apps/product-registration>



ACCESSIBILITY - COMMUNITY - VALUE - SUSTAINABILITY

TABLE OF CONTENTS

ASSEMBLY INSTRUCTIONS

Outdoor Poly Side Table 4

Outdoor Poly Adirondack Chair with Cup Holder 9

Outdoor Poly Adirondack Ottoman 16



DESIGNED IN CALIFORNIA

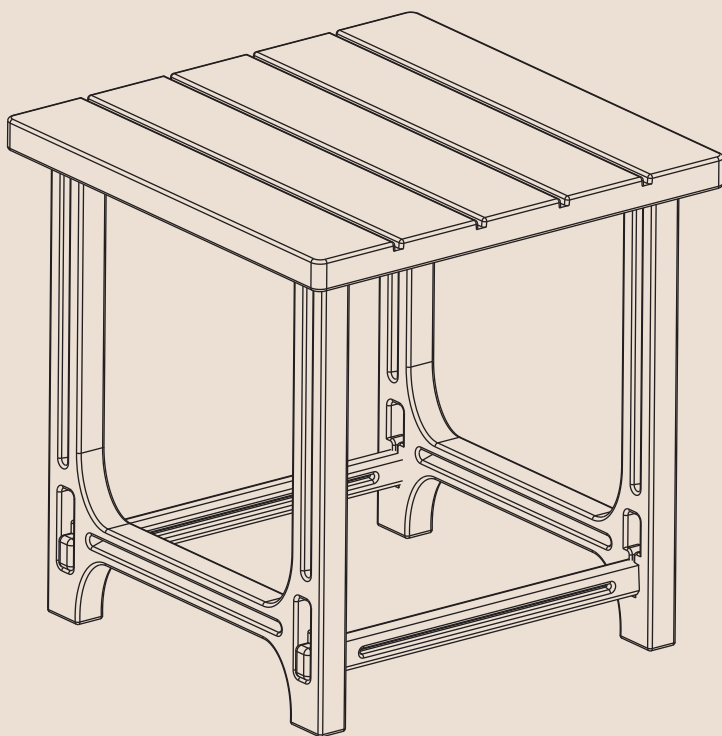

— OUTDOOR POLY SIDE TABLE —

! CARE & MAINTENANCE

Please keep this instruction for your future reference.

- Be careful when assembling, avoid damaging the painted surface.
- Clean the table with lukewarm water, mild detergent & soft cloth.
- Firmly secure all connections before use. Do not use any part of this item as a step ladder.
- Do not use or store this item in the proximity of open flame or flammable/combustible chemicals.
- Be aware that some parts are heavy and have sharp edges.
- Please do not exceed the weight limitations of this item.

NO TOOLS REQUIRED



TABLE
150 LBS
CAPACITY



1 PERSON
ASSEMBLY



UP TO 10 MIN.
ASSEMBLY

PARTS

A

TABLE TOP

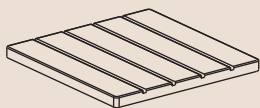

1 PC

B

TABLE LEG

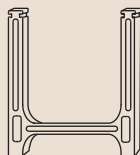

2 PCS

C

RAIL

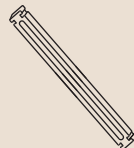

2 PCS

PRODUCT ASSEMBLY - OVERALL VIEW

Look at following overall view of this table and learn the exact position of each part to be assembled.

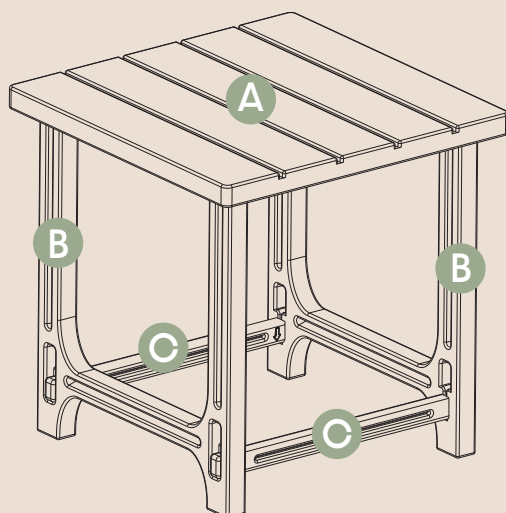

PRODUCT ASSEMBLY

1

Pick out **Part A Table Top** and **Part B Table Leg** from package and assemble as follows.

1. Check the mortise in the leg and make sure the open end is facing outside (Figure 1).
2. Plug the top tenon of **Part B Table Leg** into the groove in the bottom of **Part A Table Top**. Push the leg towards the edge of table top until the tenon is locked firmly in the groove (Figure 2).

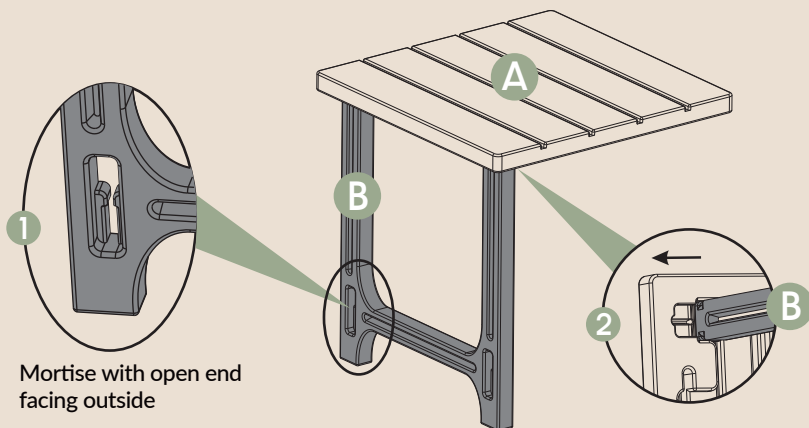

2

Do the same to attach another **Part B Table Leg** to **Part A Table Top**.

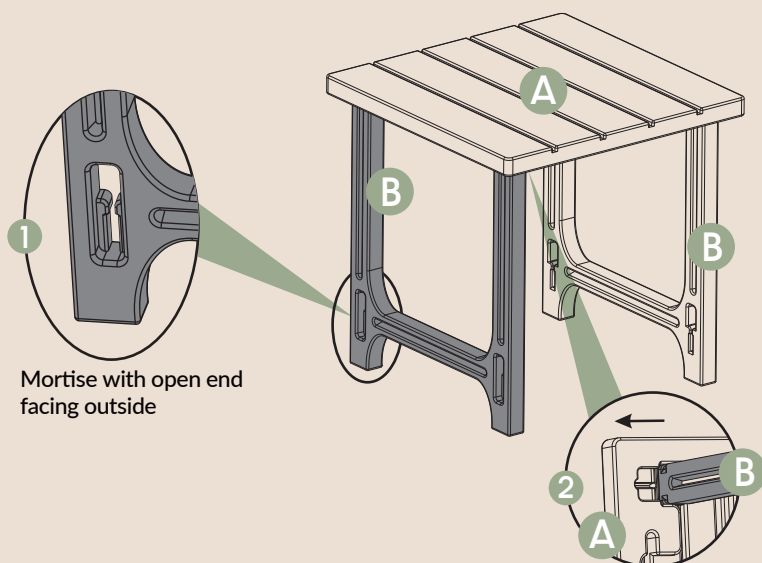

3

Place **Part C Rail** between 2 pcs of **Part B Table Legs**. Make sure the arrows are inside and pointing downward (Figure 1).

Press hard on **Part C Rail** to make the tenons lock firmly into the mortise in the legs (Figure 2).

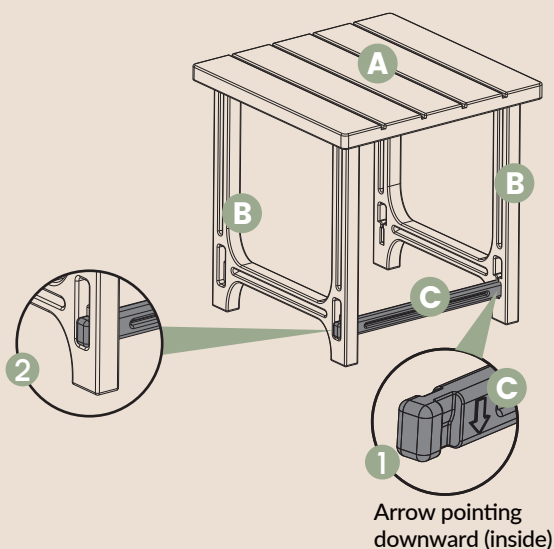

4

Do the same to attach another **Part C Rail** between 2 pcs of **Part B Table Legs**.

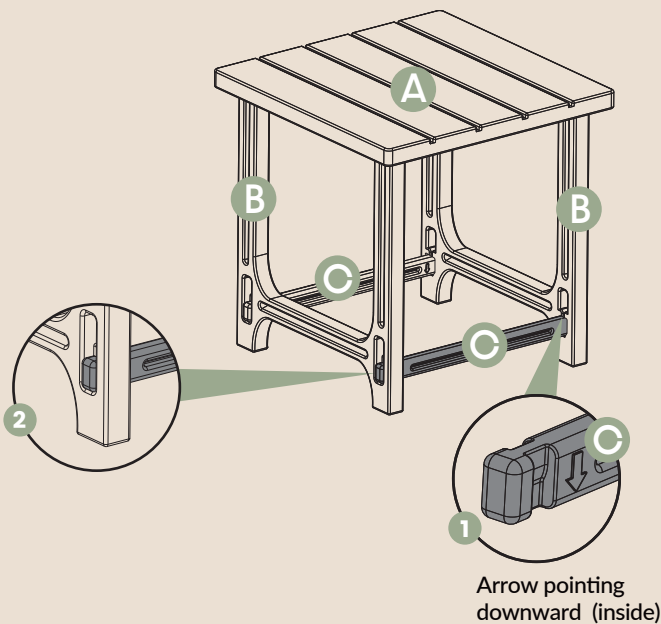

Arrow pointing
downward (inside)

5

Check and tighten all the connections again to ensure the table is steady enough.

Enjoy the table now.

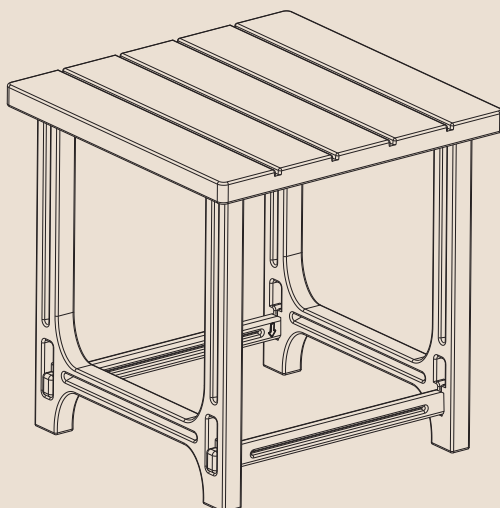



DESIGNED IN CALIFORNIA

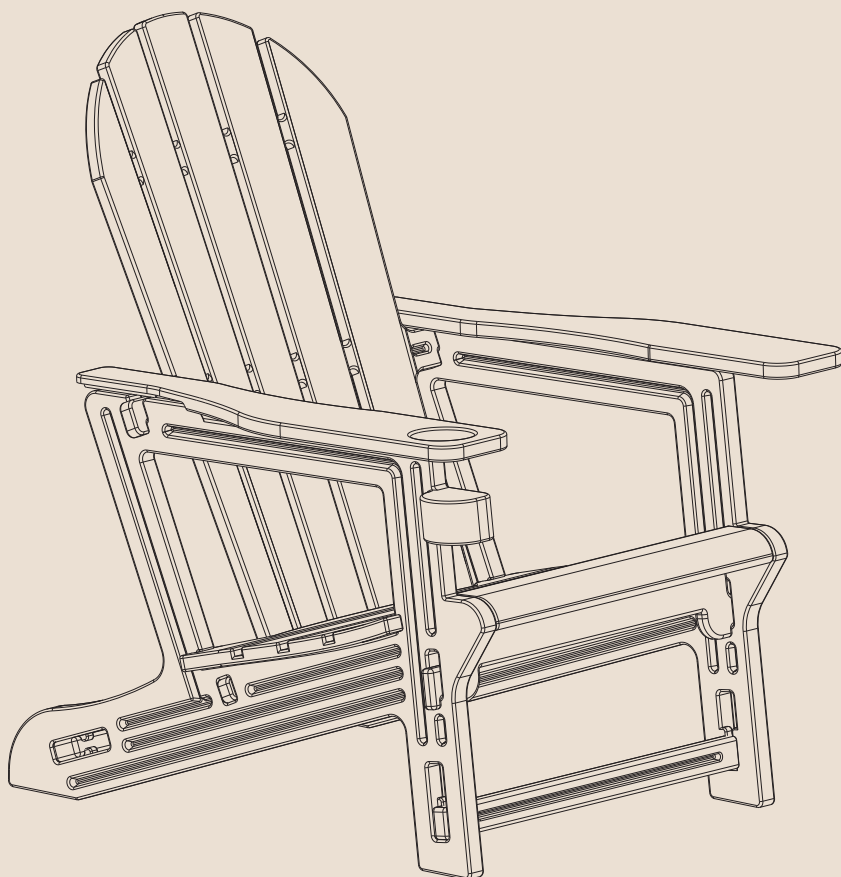

OUTDOOR POLY ADIRONDACK CHAIR WITH CUP HOLDER

! CARE & MAINTENANCE

Please keep this instruction for your future reference.

- Be careful when assembling, avoid damaging the painted surface.
- Clean the chair with lukewarm water, mild detergent & soft cloth.
- Firmly secure all connections before use. Do not use any part of this item as a step ladder.
- Do not use or store this item in the proximity of open flame or flammable/combustible chemicals.
- Be aware that some parts are heavy and have sharp edges.
- Please do not exceed the weight limitations of this item.

NO TOOLS REQUIRED



CHAIR
400LBS
CAPACITY



1 PERSON
ASSEMBLY



UP TO 10 MIN.
ASSEMBLY

PARTS

A

BACKREST

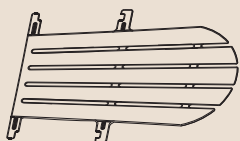

1 PC

B

CHAIR SEAT

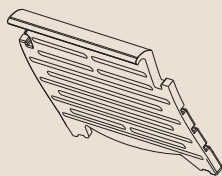

1 PC

C

RIGHT ARM



1 PC

D

LEFT ARM



1 PC

E

RAIL



2 PCS

F

SUPPORTING RAIL



1 PC

G

LEFT LEG

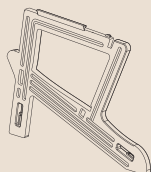

1 PC

H

RIGHT LEG

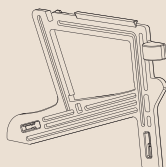

1 PC

PRODUCT ASSEMBLY - OVERALL VIEW

Look at following overall view of this chair and learn the exact position of each part to be assembled.

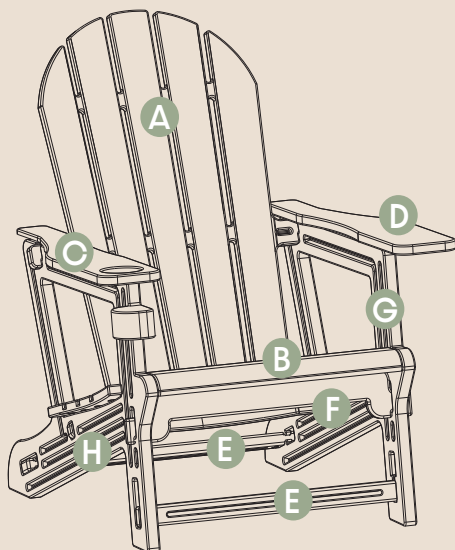

PRODUCT ASSEMBLY

1

Attach **Part H Right Leg** to **Part A Backrest** by following the steps below:

1. Place **Part H Right Leg** on flat surface. Make sure the seat holder is facing forward (Figure 1).
2. Press the upper bar of the backrest into the positioning slot of the leg (Figure 2).
3. Insert the lower bar into the holding position of the leg (Figure 3).

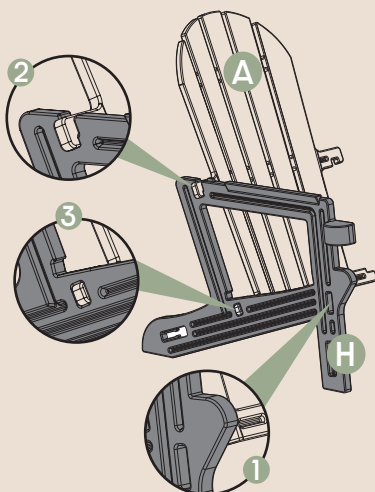

PRODUCT ASSEMBLY

2

Do the same to attach **Part G Left Leg** to **Part A Backrest**.

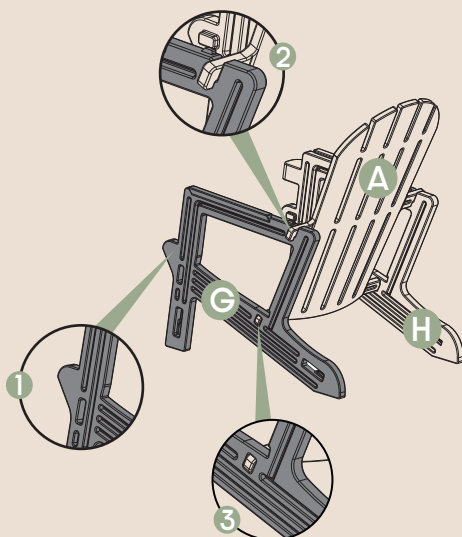

PRODUCT ASSEMBLY

3

Insert **Part B Chair Seat** to the assembled frame until the groove sits in the slot in the legs (Figure 1). Keep the seat angled upwards as below.

Pay attention not to press down the seat at this stage.

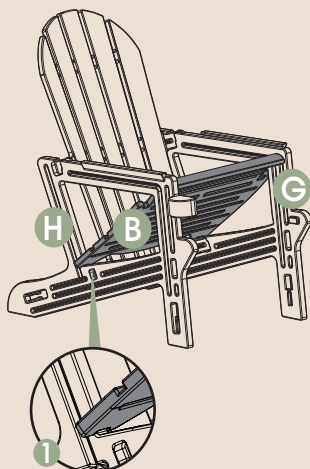

PRODUCT ASSEMBLY

4

Place **Part F Supporting Rail** between 2 pcs of legs as below. Make sure the tenons with grooves are facing downward (Figure 1).

Press hard on **Part F Supporting Rail** to lock the tenons firmly into the mortise in the legs (Figure 2).

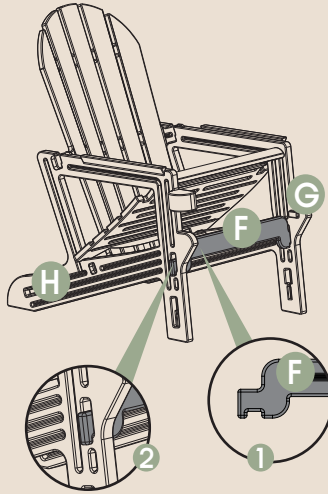

PRODUCT ASSEMBLY

5

Press the seat down until it is locked on the supporting rail firmly.

Place **Part E Rail** between **Part G Left Leg** and **Part H Right Leg** as below. Make sure the arrows are inside and pointing downward (Figure 1).

Press hard on **Part E Rail** to lock the tenons firmly into the mortise in the legs (Figure 2).

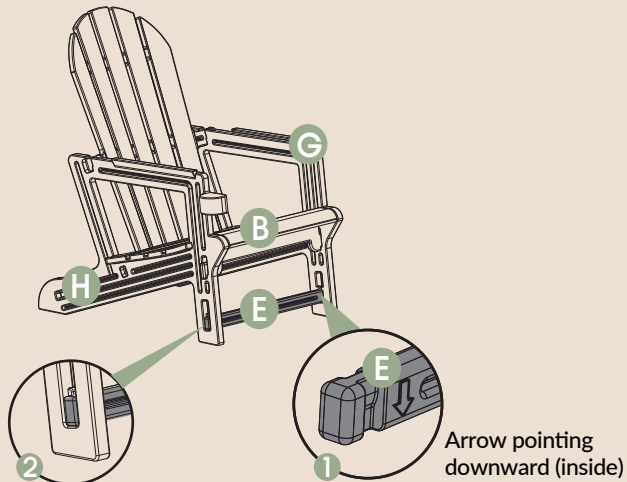

PRODUCT ASSEMBLY

6

Place another **Part E Rail** between **Part G Left Leg** and **Part H Right Leg** as below. Make sure the arrows are inside and pointing downward (Figure 1).

Press hard on **Part E Rail** to lock the tenons firmly into the mortise in the legs (Figure 2).

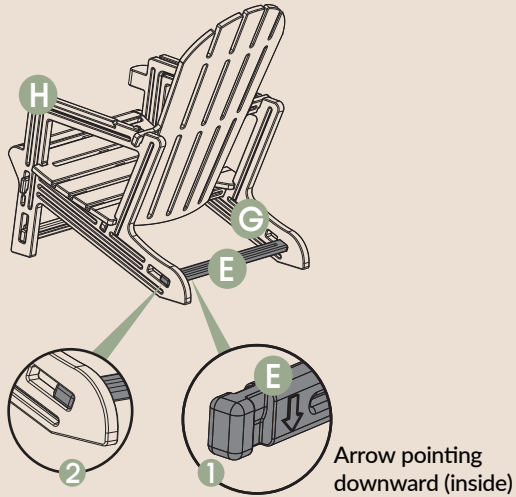

PRODUCT ASSEMBLY

7

Attach **Part C Right Arm** to **Part H Right Leg** by following the steps below.

1. Match the groove in **Part C Right Arm** with the tenon on top of **Part H Right Leg** and slide the arm horizontally backwards (Figure 1).

2. Pull the arm upwards when it moves to the lock. Slide again until the lock is trapped in the groove (Figure 2).

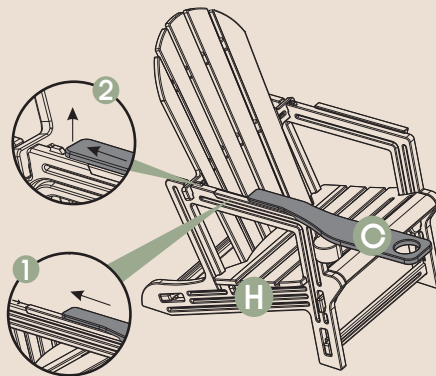

PRODUCT ASSEMBLY

8

Do the same to attach **Part D Left Arm** to **Part G Left Leg**.

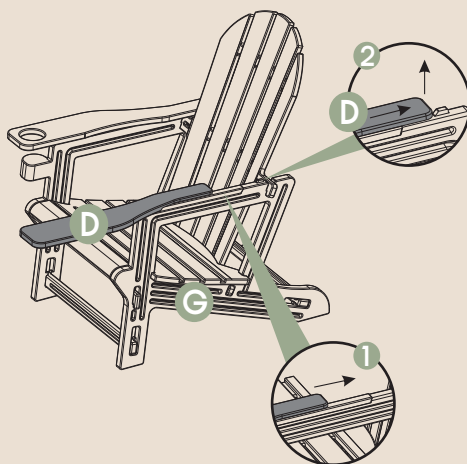

PRODUCT ASSEMBLY

9

Check and tighten all the connections again to ensure the chair is steady enough.

Enjoy the chair now.

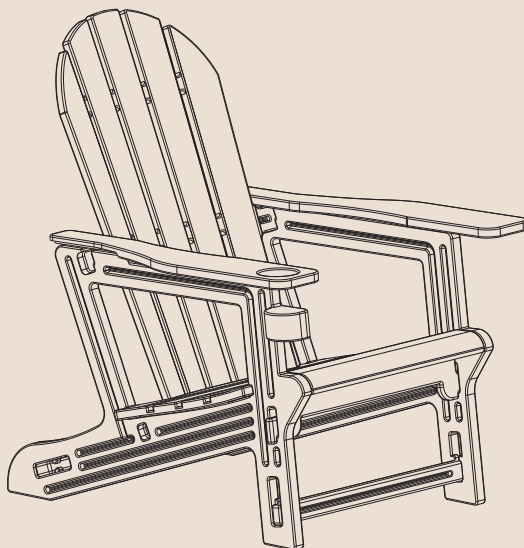



DESIGNED IN CALIFORNIA

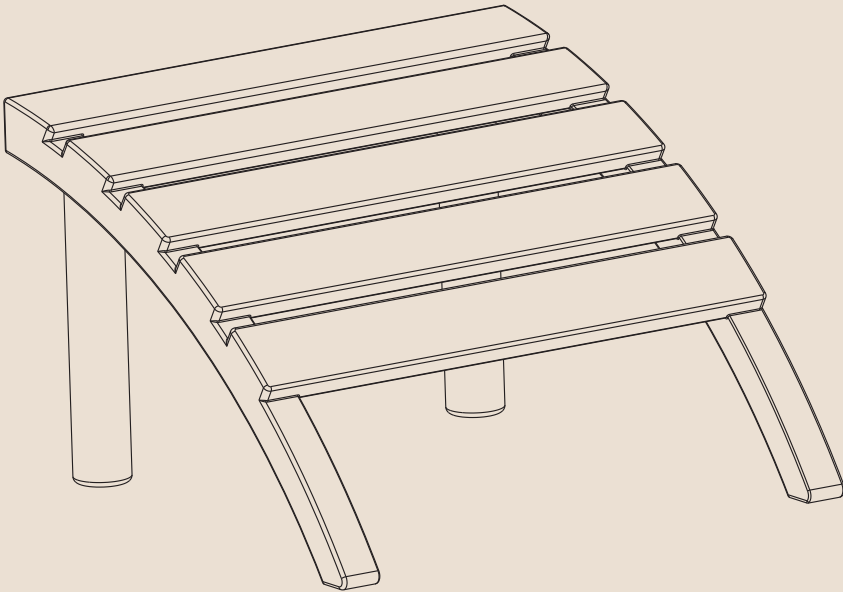

OUTDOOR POLY ADIRONDACK OTTOMAN

CARE & MAINTENANCE

Please keep this instruction for your future reference.

- Be careful when assembling, avoid damaging the painted surface.
- Clean the chair with lukewarm water, mild detergent & soft cloth.
- Firmly secure all connections before use. Do not use any part of this item as a step ladder.
- Do not use or store this item in the proximity of open flame or flammable/combustible chemicals.
- Be aware that some parts are heavy and have sharp edges.
- Please do not exceed the weight limitations of this item.

NO TOOLS REQUIRED



OTTOMAN
80LBS
CAPACITY



1 PERSON
ASSEMBLY



UP TO 1 MIN.
ASSEMBLY

HARDWARE

A

OTTOMAN TOP



1 PC

B

OTTOMAN LEG



2 PCS

PRODUCT ASSEMBLY - OVERALL VIEW

Look at following overall view of this ottoman and learn the exact position of each part to be assembled.

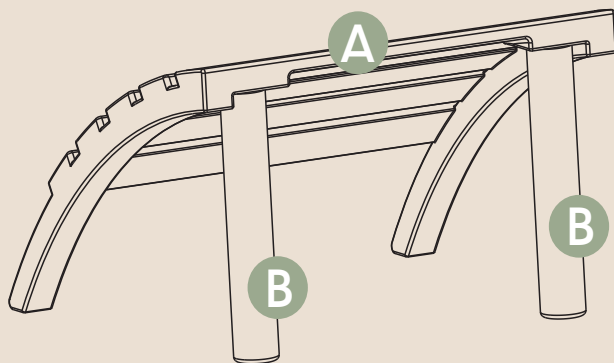

PRODUCT ASSEMBLY

1

Pick out **Part A Ottoman Top** and 1 pc of **Part B Leg** from the package.

Align the threaded head of fix spacing **Part B Leg** with the screw hole in the bottom of **Part A Ottoman Top**.

Turn the screw clockwise until the leg attaches firmly to the ottoman top.

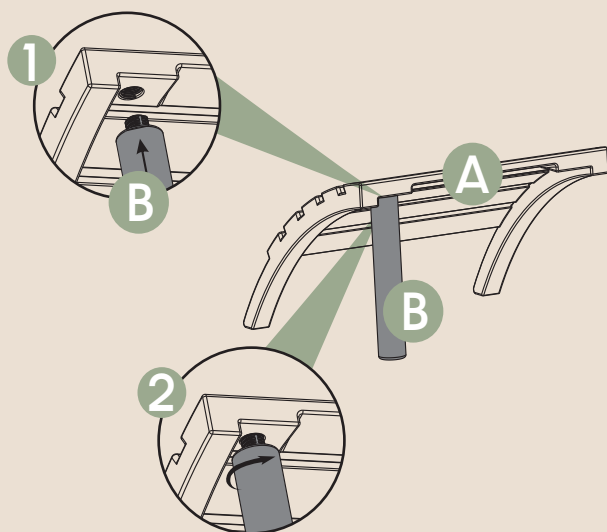

PRODUCT ASSEMBLY

2

Do the same to attach another **Part B Leg** to **Part A Ottoman Top** by step 1 & 2.

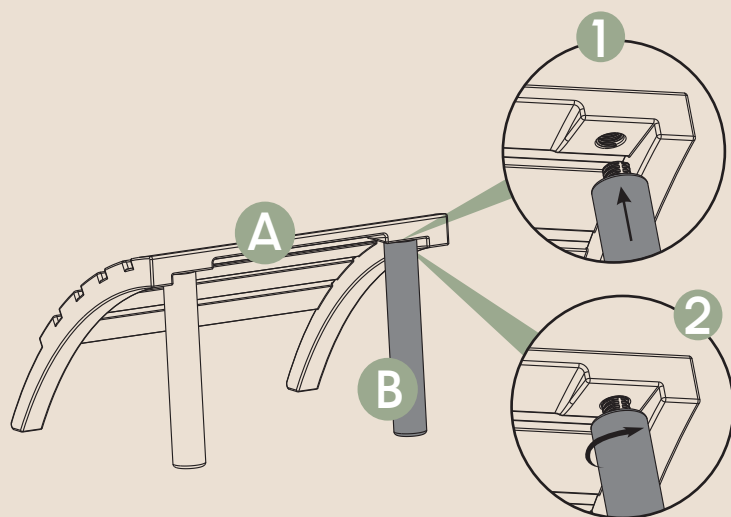

PRODUCT ASSEMBLY

3

Check and tighten the legs again to ensure the ottoman is steady enough.

Enjoy the ottoman now.

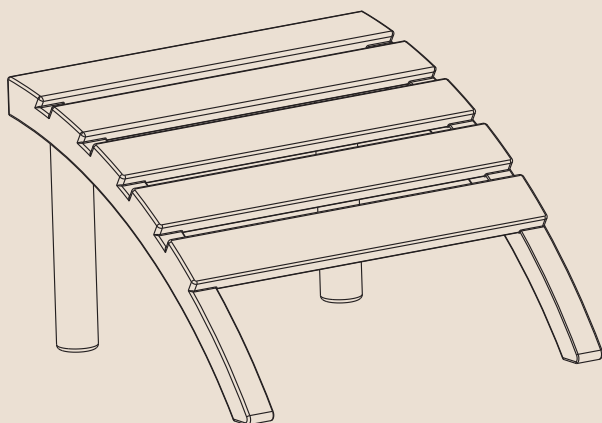

REGISTRATION & REFUND POLICY

<https://westintrends.com/apps/product-registration>



<https://westintrends.com/policies/refund-policy>



HAVING TROUBLE

- **Not sure how to assemble or missing pieces?**

Please contact our Customer Service Team for assistance at cs@westintrends.com

Have Order #, Part # or SKU ready to speed up customer service!

CLEANING TIPS

REGULAR CLEAN: Use a mixture of warm water and mild soap. Gently scrub the surface with a soft bristle brush to remove any dirt or stains.

QUICK CLEAN: You can simply wipe down the HDPE furniture with a damp cloth. The material's resilience makes it resistant to most spills and stains, ensuring a hassle-free maintenance routine.

Regular cleaning not only preserves the aesthetic appeal of your furniture but also helps extend its lifespan.

Pressure washer can be used for seriously deep-cleaning - **DO NOT exceed 1500 PSI** - this will remove debris and dirt.