

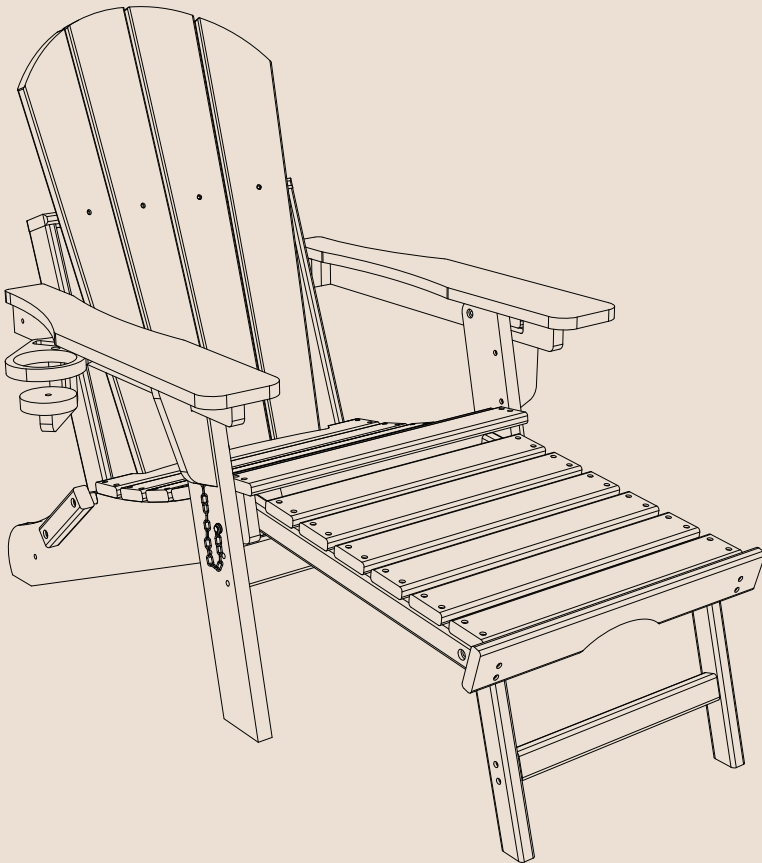

DESIGNED IN CALIFORNIA



OUTDOOR FOLDING ADJUSTABLE
ADIRONDACK CHAIR WITH CUP
HOLDER & HIDEAWAY OTTOMAN

THANK YOU!

We appreciate you for choosing WestinTrends!

Thank you for letting WestinTrends continue to offer accessible luxury trends, inspired by everyone!

JOIN THE WESTINTRENDS COMMUNITY

Sign up here:

<https://westintrends.com/welcome>



QUESTIONS OR COMMENTS?

If you have questions reach out to
cs@westintrends.com

FOLLOW, SHARE, & LEARN



PRODUCT REGISTRATION

<https://westintrends.com/apps/product-registration>



ACCESSIBILITY - COMMUNITY - VALUE - SUSTAINABILITY

! CARE & MAINTENANCE

Do not overtighten screws. (Insert all screws before tightening screws.)

- Please do not exceed the weight limitations of this item.
- Do not stand on or use any part of this item as a step ladder.
- Firmly secure all bolts, screws and nuts before use.
- Reconfirm that all bolts, screws, and nuts are secure every 90 days.
- Do not use or store this item in the proximity of open flame or flammable/combustible chemicals.
- Be aware that some parts are heavy and have sharp edges.
- Be very careful when folding chair to avoid smashing your hands or fingers.

TOOLS REQUIRED

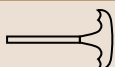

ALLEN WRENCH
(PROVIDED)

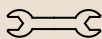

WRENCH
(PROVIDED)



CHAIR
330 LBS
CAPACITY



1 PERSON
ASSEMBLY



UP TO 30 MIN.
ASSEMBLY

HARDWARE

1

BOLT
M6 x 90mm



2 PCS

2

BOLT
M6 x 55mm



4 PCS

3

BOLT
M6 x 50mm



2 PCS

4

BOLT
M6 x 50mm



2 PCS

5

SCREW
ST6.3 x 50mm



8 PCS

6

SCREW
ST6.3 x 40mm



2 PCS

7

M6 NUT



8 PCS

8

M6 NUT



2 PCS

9

M6 WASHER



10 PCS

PARTS

A

CHAIR SEAT



1 PC

B

RIGHT CHAIR LEG

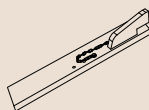

1 PC

C

LEFT CHAIR LEG

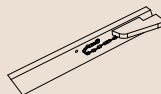

1 PC

D

CHAIR BACKREST



1 PC

PARTS

E

RIGHT CHAIR ARM

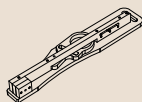

1 PC

F

LEFT CHAIR ARM

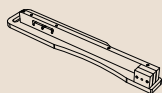

1 PC

G

SUPPORT LEG

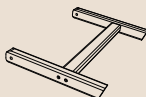

1 PC

H

BACK RAIL



1 PC

I

FRONT RAIL



1 PC

J

LOCKING BLOCK

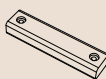

2 PCS

K

CUP HOLDER



1 PC

PRODUCT ASSEMBLY - OVERALL VIEW

Look at following overall view of this chair and learn the exact position of each part to be assembled.

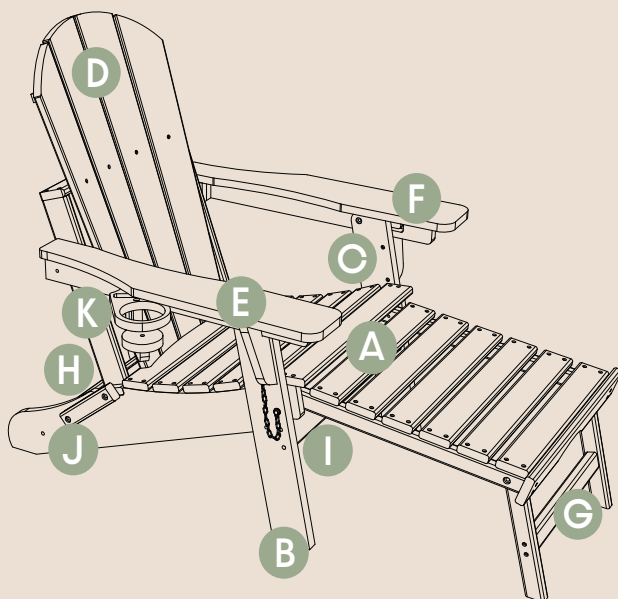

PRODUCT ASSEMBLY

1

Attach **Part G Support Leg** to **Part A Chair Seat** with 2 pcs of **Hardware #2 Bolt** and **Hardware #9 Washer** and **Hardware #7 Nut**.

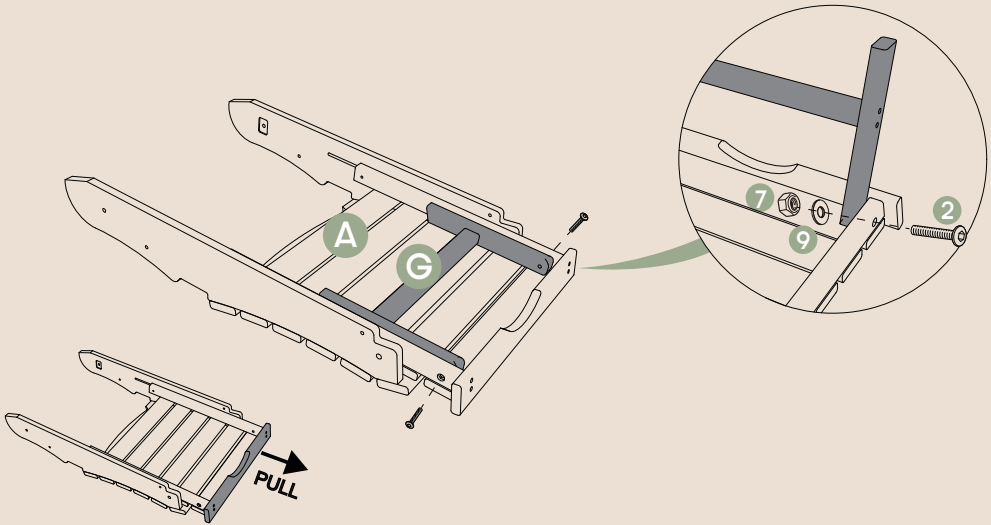

2

Attach **Part I Front Rail** to **Part B Right Chair Leg** and **Part C Left Chair Leg** with 4pcs of **Hardware #5 Screw**.

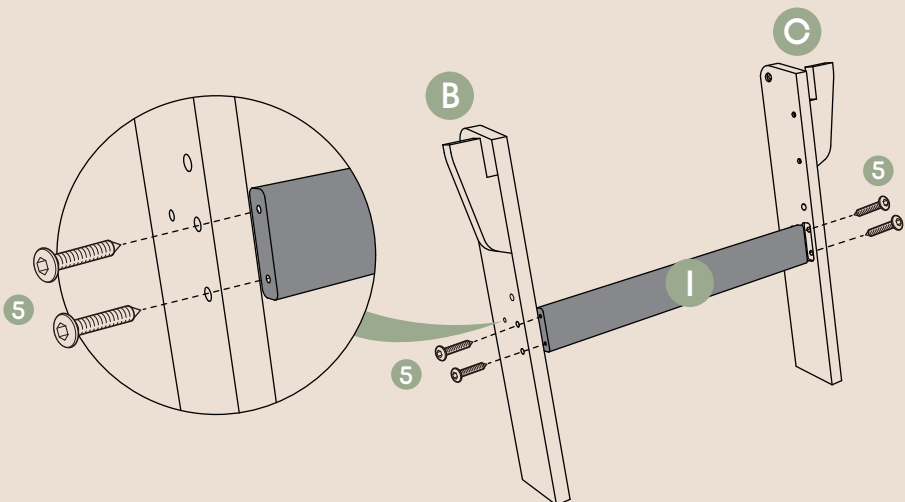

PRODUCT ASSEMBLY

3

Connect the finished part of Step 2 to the finished part of Step 1 with 2 pcs of **Hardware #2 Bolt** and **Hardware #9 Washer** and **Hardware #7 Nut**.

Do not tighten the bolts too much at this step.

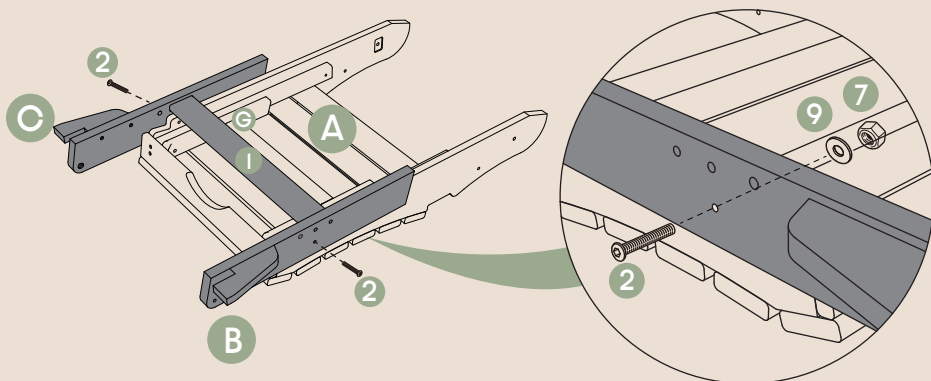

4

Place the steel pins into both legs to lock them in place.

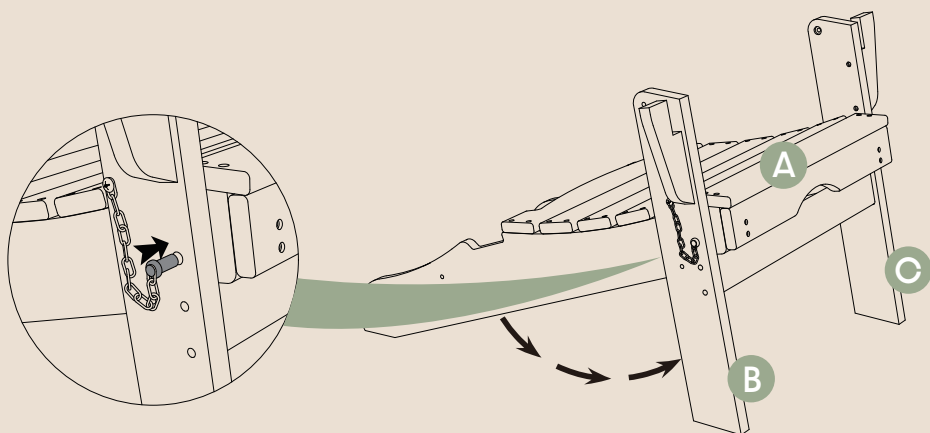

5

Attach **Part F Left Chair Arm** to **Part C Left Chair Leg** with 1 pc of **Hardware #4 Bolt** and **Hardware #9 Washer** and **Hardware #8 Nut**.

Do same to **Part E Right Chair Arm** and **Part B Right Chair Leg**.

Do not tighten the bolts too much at this step.

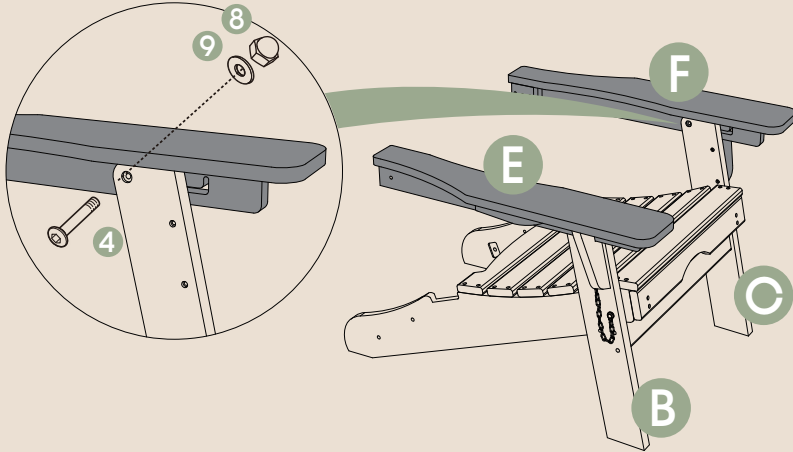

6

Fix **Part D Chair Backrest** into **Part A Chair Seat** and then attach **Part D Chair Backrest** to **Part F Left Chair Arm** with 1 pc of **Hardware #1 Bolt** and **Hardware #9 Washer** and **Hardware #7 Nut**

Do same to **Part D Chair Backrest** and **Part E Right Chair Arm**.

Do not tighten the bolts too much at this step.

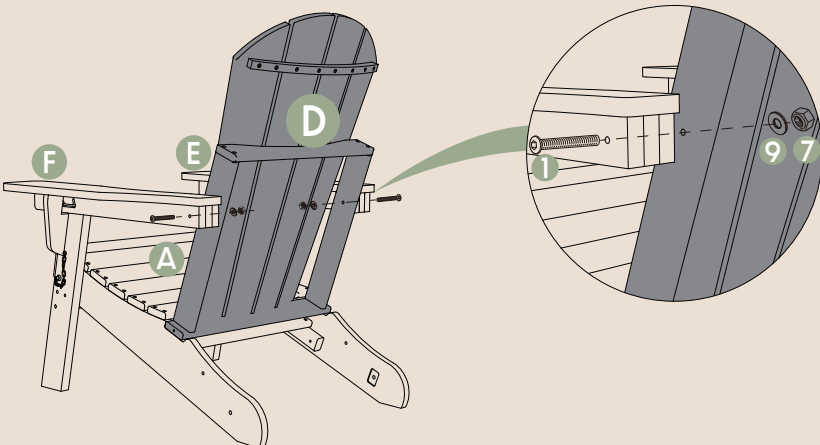

PRODUCT ASSEMBLY

7

Attach **Part J Locking Block** to **Part D Chair Backrest** (both sides) with 2 pcs of **Hardware #5 Screw** and attach **Part J Locking Block** to **Part A Chair Seat** (both sides) with 2 pcs of **Hardware #3 Bolt** and **Hardware #9 Washer** and **Hardware #7 Nut**.

Attach **Part H Back Rail** to **Part A Chair Seat** with 2 pcs of **Hardware #5 Screw**.

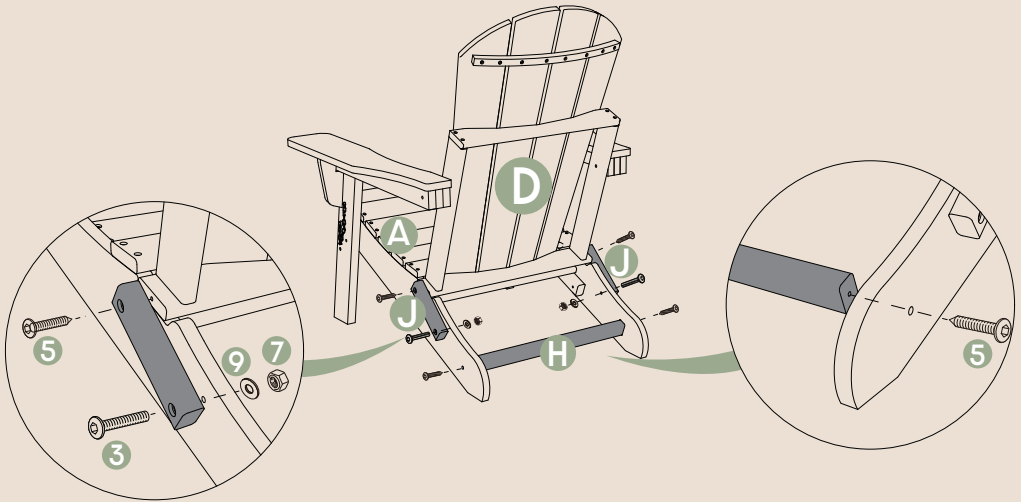

8

Attach **Part K Cup Holder** to **Part E Right Chair Arm** with 2 pcs of **Hardware #6 Screw**. Tighten all screws after assembly is complete.

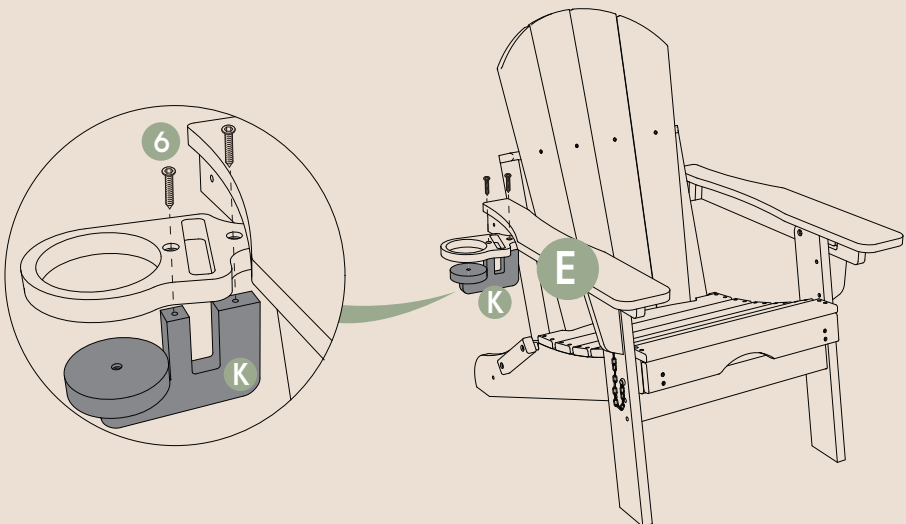

Congratulations! You finished the assembly of this Adirondack chair.

Pull the steel pins out of both legs to fold the chair as below.

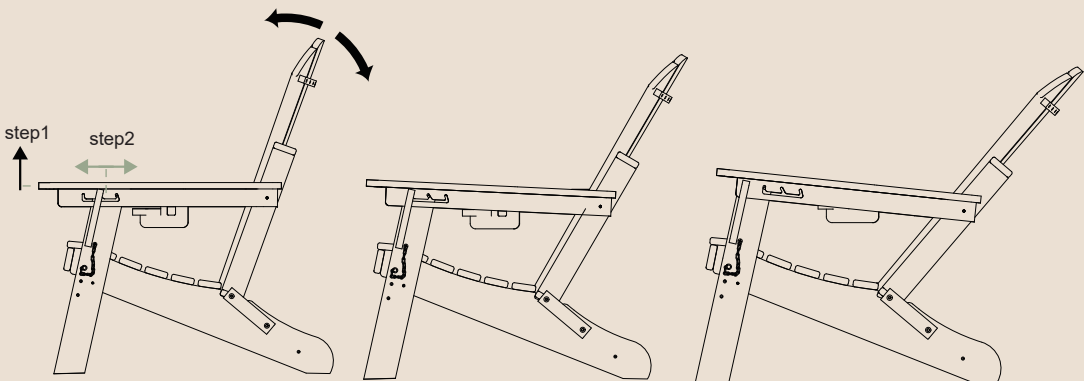
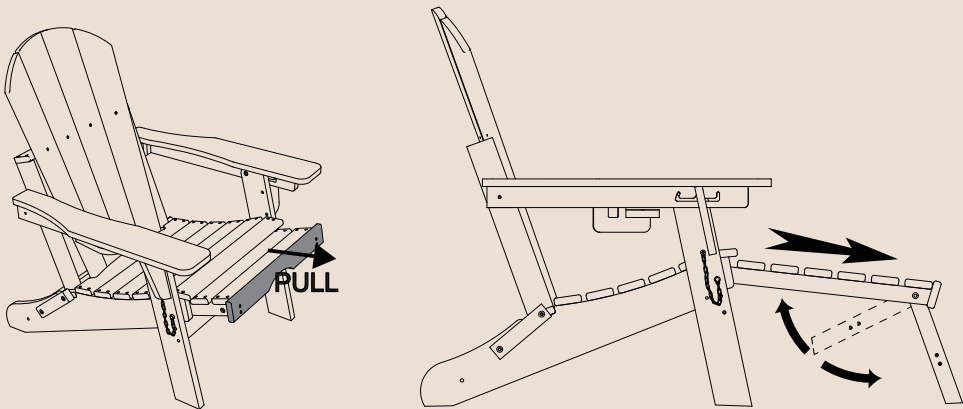
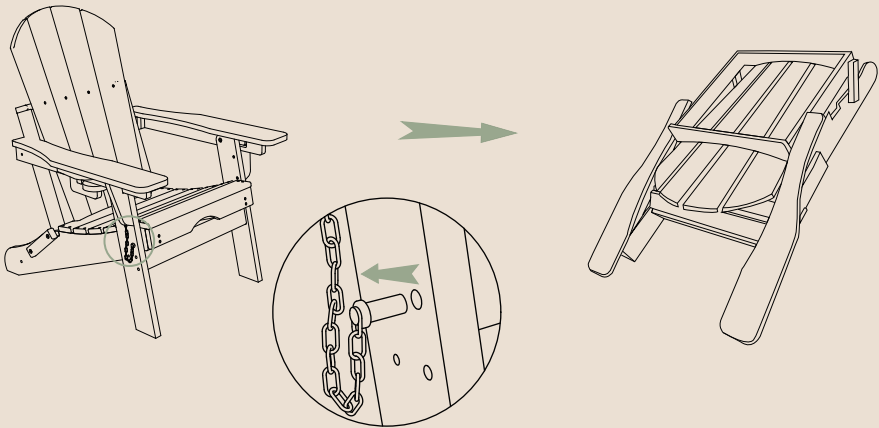

REGISTRATION & REFUND POLICY

<https://westintrends.com/apps/product-registration>



<https://westintrends.com/policies/refund-policy>



HAVING TROUBLE

- **Not sure how to assemble or missing pieces?**

Please contact our Customer Service Team for assistance at cs@westintrends.com

Have Order #, Part # or SKU ready to speed up customer service!

CLEANING TIPS

REGULAR CLEAN: Use a mixture of warm water and mild soap. Gently scrub the surface with a soft bristle brush to remove any dirt or stains.

QUICK CLEAN: You can simply wipe down the HDPE furniture with a damp cloth. The material's resilience makes it resistant to most spills and stains, ensuring a hassle-free maintenance routine.

Regular cleaning not only preserves the aesthetic appeal of your furniture but also helps extend its lifespan.

Pressure washer can be used for seriously deep-cleaning - **DO NOT exceed 1500 PSI** - this will remove any debris and dirt.