



WARNING

- Risk of fire or electric shock. LED installation requires knowledge of luminaires electrical systems. Review the diagrams thoroughly before beginning. All electrical connections must be in accordance with local codes, ordinances, and the National Electric Code. If not qualified, do not attempt installation. Contact a qualified licensed electrician.
- Before installation, disconnect the power by turning off the circuit breaker or by removing the appropriate fuse at the fuse box. Using the light switch to turn power off is not sufficient to prevent electrical shock.
- May be used outdoors under cover. (-15°C - 40°C)
- Do not let power supply cords touch hot surfaces.
- Do not mount near gas or electric heaters.
- Use caution when servicing batteries, all servicing should be completed by qualified personnel. Replace every 8 to 10 years according to ambient. Test regularly in accordance with local codes.
- To prevent wiring damage or abrasion, do not expose wiring to edges of sheet metal or other sharp objects.
- Do not use this equipment for other than its intended use.
- The use of accessory equipment not recommended by the manufacturer may cause an unsafe condition.
- Equipment should be mounted in locations and at heights where it will not be subjected to tampering by unauthorized personnel.
- Only use UL Listed, Suitable for Wet Location conduit parts. Use flexible conduit ONLY.
- Allow batteries to charge for 24 hours before first use.

What's In The Box



One (1) ECL5

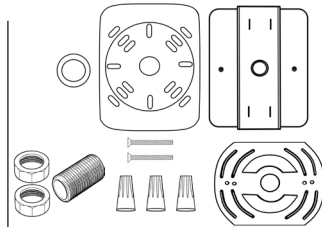

One (1) Mounting Kit

Tools Needed

A Phillips screwdriver and a drill will be needed to install the ECL5.

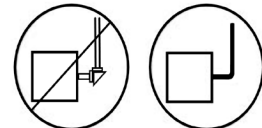
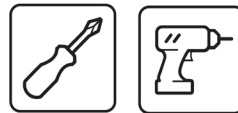

FLEXIBLE CONDUIT ONLY!

Installing the ECL5



Make sure all power is turned off before beginning installation

1 Preparation

Carefully unpack the exit light from its packaging. Inspect product for defects due to shipping. Become familiar with the wiring diagram below before beginning installation. Take the faceplate off of the fixture, remove the plastic diffuser. Remove the appropriate chevron arrow knockout, gently using your fingers or a small tool, then replace the plastic diffuser. If using double face option, remove the appropriate chevron arrow of the second faceplate. Set the faceplate(s) and screws aside.

Wiring Diagram

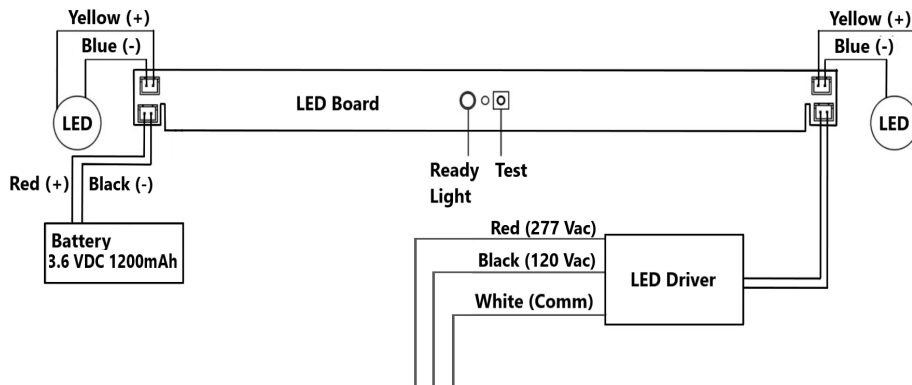

Figure 1 - Wiring Diagram

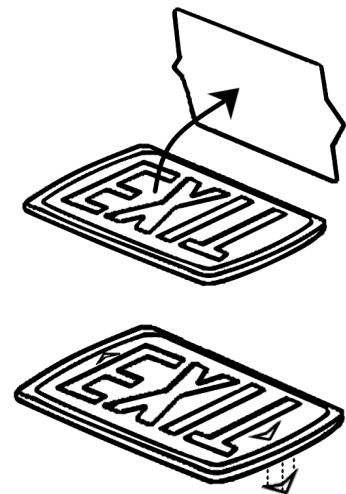

Figure 2 - Chevron Arrow Removal

2 Mounting Instructions

2.1 Surface Wall Mounting

- If back mounting, skip to section 2.2.
- Remove appropriate knockout by drilling a 3/4" hole.
- Thread nut onto pipe nipple. Slide pipe nipple through canopy center hole.
- Remove backing from self adhesive junction box gasket and adhere to back of mounting canopy. Remove backing from self adhesive pipe thread gasket and adhere to front of mounting canopy.
- Place the screws provided in the holes on the canopy.
- Feed the power supply through knockout, pipe, and metal mounting plate, as seen in "Figure 3 - Wall Mount." Direct input wires along walls of the fixture to protect the wires and prevent shadowing.
- Ensure that power is off, then connect the power supply, 120 or 277 VAC, to the appropriate input wires, using the provided wire nuts, according to the wiring diagram in Figure 1. The unused wire must be capped off using the extra wire nut.
- Push wire connections into the junction box. Mount metal bracket to junction box (j-box and hardware not included).
- Secure the canopy to the steel mounting plate. Place pipe nipple through the mounting hole of the housing to lock the canopy into place. Once canopy is locked into position there will not be any side-to-side movement of the canopy.
- Connect batteries to LED board using snap in connectors. Secure the faceplate(s) to the fixture: snap in the white faceplate, then screw on clear cover. Do not over tighten screws.

NOTE: Figure 3 shown as single face install, for double face: install additional EXIT faceplate.

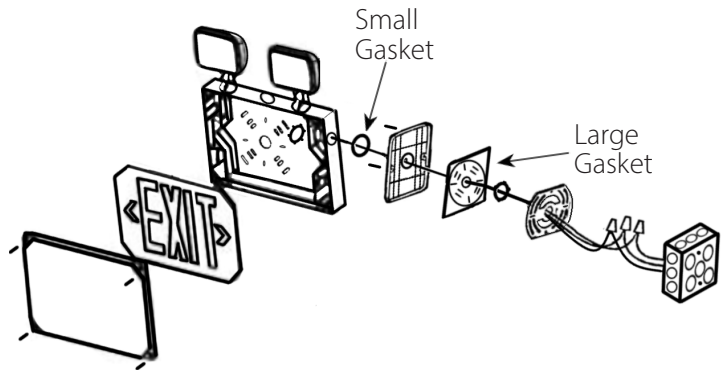

Figure 3 - Wall Mount

2.2 Back Mounting

- Drill or knock out appropriate knockouts on the backplate to fit junction box mounting points and the center knockout for the input wire leads.
- Remove backing from self adhesive junction box gasket and adhere to back plate.
- Feed the power supply through the knockout. Direct the input wires along the walls of the fixture to protect the wires and prevent shadowing. Run the wires through the mounting bracket as seen in Figure 4.
- Ensure that power is off, then connect the power supply, 120 or 277 Vac, to the appropriate input wires, using the provided wire nuts, according to the wiring diagram in Figure 1.
- Mount the metal bracket to the J-box (hardware not included).
- Using the provided (2) mounting screws, secure the fixture to the mounting bracket.
- Connect the battery to the LED board. Secure the faceplate to the fixture: snap in the white faceplate, then screw on clear cover. Do not over tighten the screws.

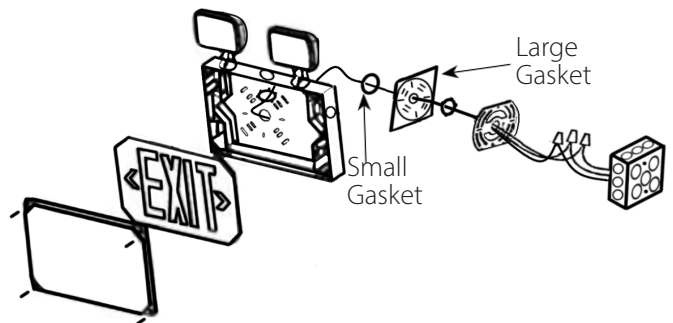

Figure 4 - Back Mount

NOTE

Battery Testing: Allow 24 hours of charging before testing.

- Push In TEST Button - LED display will switch to battery power and remain lit
- Release TEST Button - LED display will switch back to AC power



ECL5 LED Combo Exit Sign & Emergency Light INSTALLATION INSTRUCTIONS

Model: ECL51UNVWHR2, ECL51UNVWHG2

LED EXPRESS LIMITED WARRANTY

Subject to the exclusions below, each NICOR LED product, including the LED electronics and components of a property installed NICOR LED product, will be free from defect in materials and workmanship for a period of five (5) years from the original date of purchase. The product shall be considered defective only if 10% or more of the product's LED components fail. NICOR LED product warranty covers the following performance criteria: LED Light Output will be maintained above 70% of initial output; LED color temperature will not shift more than 200K in CCT; LED driver will operate within NICOR specifications; and the fixture finish, excluding natural aluminum or brass products, will not exhibit cracking, peeling, excessive fading, or corrosion during the warranty period. Exceptions apply as defined in NICOR's product specification sheets, which are incorporated by reference herein.

This limited warranty is provided to you, the purchaser of the product identified on Seller's invoice, as your exclusive remedy and applies only to NICOR products that have been purchased from an authorized NICOR Distributor; the product was new and in an unopened NICOR package at the time of installation; and the NICOR product was installed by a licensed electrician or under the supervision of a licensed electrician and used by consumers in the United States or Canada when accompanied with this warranty. This warranty extends only to the first consumer purchaser and is not transferable. A consumer wishing to invoke the terms of this limited warranty must first obtain a RGA number within 30 days of discovery of the defect, and return the product to NICOR for inspection. Once verified to be covered by this limited warranty, NICOR will, at its sole discretion, repair, replace, or refund the purchase price of any product that does not conform to this limited warranty. If NICOR, at its sole discretion, determines that the product should be repaired or replaced, this warranty is limited to the reasonable, customary, and necessary costs and expenses associated with the repair/replacement. This warranty requires that all repair/replacement estimates and costs, including but not limited to equipment rental (if any), and any other cost or expense to be incurred in the repair/replacement of the product, be approved in advance and in writing by NICOR.

FAILURE TO OBTAIN NICOR'S ADVANCE WRITTEN APPROVAL OF ALL REPAIR/REPLACEMENT COSTS AND EXPENSES IN WRITING SHALL VOID THIS LIMITED WARRANTY.

THIS LIMITED WARRANTY DOES NOT COVER THE FOLLOWING:

- Defects or damages resulting from improper installation, operation, storage, misuse or abuse, accident, or neglect;
- Defects or damages resulting from improper service, testing, adjustment, installation, maintenance, alteration, connection to out-of-specification electrical service, corrosive or damp environments, or connection to incompatible equipment or devices (e.g., connecting non-dimmable lighting products to dimmers);
- Damage which occurs in transit;
- Power surges or overheating due to external conditions
- Acts of nature including but not limited to lightning strikes

ANY IMPLIED WARRANTIES, INCLUDING WITHOUT LIMITATION, THE IMPLIED WARRANTIES OF MERCHANTABILITY AND FITNESS FOR A PARTICULAR PURPOSE SHALL BE LIMITED TO THE DURATION OF THIS LIMITED WARRANTY, OTHERWISE THE REPAIR, REPLACEMENT, OR REFUND AS PROVIDED UNDER THIS EXPRESS LIMITED WARRANTY IS THE EXCLUSIVE REMEDY OF THE CONSUMER, AND IS PROVIDED IN LIEU OF ALL OTHER WARRANTIES, EXPRESS OR IMPLIED. IN NO EVENT SHALL NICOR BE LIABLE, WHETHER IN CONTRACT OR IN TORT (INCLUDING NEGLIGENCE) FOR DAMAGES IN EXCESS OF THE PURCHASE PRICE OF THE PRODUCT, OR FOR ANY INDIRECT, INCIDENTAL, SPECIAL OR CONSEQUENTIAL DAMAGES OF ANY KIND, OR LOSS OF REVENUE OR PROFITS, LOSS OF BUSINESS OR OTHER FINANCIAL LOSS ARISING OUT OF OR IN CONNECTION WITH THE ABILITY OR INABILITY TO USE THE PRODUCT TO THE FULL EXTENT THESE DAMAGES MAY BE DISCLAIMED BY LAW.

This device complies with part 15 of the FCC Rules. Operation is subject to the following two conditions: (1) This device may not cause harmful interference, and (2) this device must accept any interference received, including interference that may cause undesired operation.

NOTE: This equipment has been tested and found to comply with the limits for a Class B digital device, pursuant to part 15 of the FCC Rules. These limits are designed to provide reasonable protection against harmful interference in a residential installation. This equipment generates, uses and can radiate radio frequency energy and, if not installed and used in accordance with the instructions, may cause harmful interference to radio communications. However, there is no guarantee that interference will not occur in a particular installation. If this equipment does cause harmful interference to radio or television reception, which can be determined by turning the equipment off and on, the user is encouraged to try to correct the interference by one or more of the following measures:

- Reorient or relocate the receiving antenna.
- Increase the separation between the equipment and receiver.
- Connect the equipment into an outlet on a circuit different from that to which the receiver is connected.
- Consult the dealer or an experienced radio/TV technician for help

THANK YOU FOR YOUR PURCHASE

SHARE YOUR EXPERIENCE WITH US

SCAN the QR or visit

www.nicorlighting.com/support/survey

FOLLOW US



YouTube

