



SparClean®

warewash products



Providing Quality Maintenance and Chemical Specialty Solutions with Unparalleled Customer Service



SparClean Warewash

The SparClean Warewash line of products gives you the options you need to keep all of your glasses, dishes, pots, pans and utensils in SparClean brilliance! These products were formulated with the latest technology, removing some of the less sustainable raw materials and choosing instead options that achieve performance without the traditional negative impact. Since SparClean products do NOT contain Phosphates, Nonylphenol ethoxylates, or EDTA, they are more environmentally preferable than most traditional warewash products.

CLOSED SYSTEM OPTIONS INCREASE SAFETY:

Spartan now offers some of our popular SparClean Warewash products in a closed system. This system improves safety by reducing the chance of chemical contact when switching out product. Inserts are installed at the factory and your dispenser mating cap locks onto the pre-inserted stem to minimize the opportunity for product splashing or leakage. **A Closer Look:**

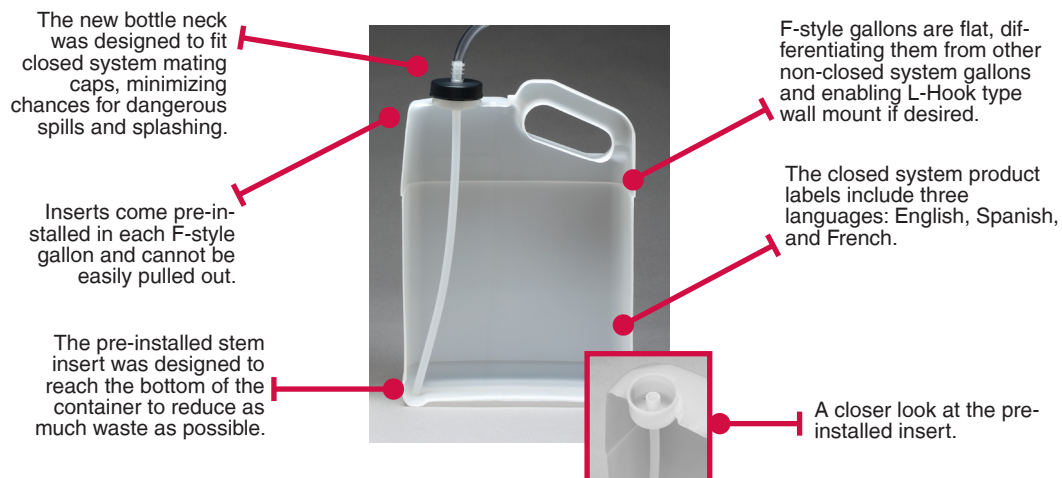

COLOR AND NUMBER CODED:

Each SparClean product is color and number coded for easy product identification. All of the product references and labels reflect this color and number, which makes training short and simple.

TRANSLUCENT CONTAINERS:

All SparClean products are packaged in translucent containers. The clear packaging allows you to see exactly what remains in your container and enables timely reorder of your warewash products.

SUPPORT ACCESSORIES:

Several dispensing options and storage accessories are available to complement the SparClean warewash line of products. We will also smooth your transition with training materials such as a general application SparClean Warewash Wall Chart, a new SparClean Closed System Switch Out Chart, and an updated Clean on the Go 3-Sink System Wall Chart. All of these options are explained in more detail in the Accessories section of this literature.



SparClean®

Warewash Products



SUPER SUDS DISH DETERGENT 48

Super Suds 48 delivers powerful cleaning and long-lasting, luxurious suds. Formulated with Aloe, Super Suds aggressively emulsifies and removes baked-on grease or food soils while conditioning hands. Plus, the powerful grease-cutting formula is concentrated, so you can use less to wash more.

pH 6.5 – 7.5 #7648 



DETERGENT II 49

Detergent II is a non-chlorinated, non-foaming warewashing detergent. SparClean Detergent II is ideal for use in both low and high temperature dish machines. It offers a cost effective formulation that provides the alkalinity needed to clean and remove tough greasy soils from dishes.

pH 13.5 – 14.0 #7649 



ALL TEMPERATURE DETERGENT 50

A non-chlorinated, non-foaming, and highly concentrated warewashing detergent for use in both low and high temperature dish machines. This heavily concentrated detergent is designed to provide a unique blend of water conditioners, soil suspending agents and the necessary alkalinity to tackle tough, greasy soils at low doses per rack.

pH 13.5 – 14.0 #7650 



CHLORINATED DETERGENT 51

A concentrated warewashing detergent boosted with chlorine for use in both low and high temperature dish machines. This formula combines the de-staining ability of chlorine bleach with water conditioners, soil suspending agents, and the necessary alkalinity to tackle tough, greasy soils at low doses per rack. SparClean Chlorinated Detergent is ideal for industry areas where utensils and dishware have problematic food soil stains.

pH 13.5 – 14.0 #7651 



HIGH TEMPERATURE RINSE AID 52

The acidic formula ensures spotless dishes upon drying and helps to control the mineral deposits left by hard water and food soils caused from rapid evaporation at high temperatures. The non-foaming formula will help maintain the machine's spray arm efficiency, providing optimal wash conditions for each rack. SparClean High Temperature Rinse Aid can also be used in low temperature machines where hard water and scale build-up are an issue.

pH 1.0 – 2.0 #7652 



LOW TEMPERATURE RINSE AID 53

Offers superior water sheeting and drying of dishware and utensils in low temperature dish machines. The non-foaming formula helps maintain the machine's spray arm efficiency, providing optimal wash conditions for each rack. Ideally suited for use with a chlorinated sanitizer. Can also be used in high temperature machines.

pH 6.0 – 7.0 #7653 



SANITIZER 54

Chlorinated sanitizer for use in low temperature dish machines. Ensures sanitation of dishware when injected into final rinse water at a concentration of 100 ppm available chlorine.

EPA Reg. No. 5741-27

pH 12.0 – 13.0 #7654 



DELIMER 55

Quickly penetrates and breaks down lime and mineral deposits found in low and high temperature machines. SparClean Delimer is a concentrated, non-foaming synergistic blend of Citric and Hydrochloric acid to ensure longer machine life and decreased machine maintenance. For best results, SparClean Delimer should be part of a regular kitchen maintenance program.
pH 1.0 – 2.0 #7655 



POT AND PAN DETERGENT 56

Specifically designed for manual washing of excessively soiled kitchen items. SparClean Pot and Pan Detergent quickly and efficiently penetrates and emulsifies baked-on grease and food. Demonstrates superior foam retention at lean dilutions even in heavily-soiled conditions. SparClean Pot and Pan Detergent can be used in single and 3-sink systems.
pH 7.5 – 8.0 #7656



SILVERWARE PRE-SOAK 57

Breaks down stubborn food residues from silverware, utensils, and dishes using a proprietary triple action enzymatic formula. As part of daily dish washing procedures, SparClean Silverware Pre-soak helps to ensure one-pass dish washing.
pH 7.5 – 8.0 #7657 



METAL SAFE MACHINE DISH DETERGENT 58

A non-chlorinated, low foaming, highly concentrated warewashing detergent for use in both low and high temperature dish machines. Specially formulated to prevent corrosion of Aluminum, Copper, Brass, and other soft Metals. Strips away and emulsifies soils from pots and pans, trays, dishes, glassware, plastic, and utensils.
pH 13.5 – 14.0 #7658 



Accessories

2 Pump Warewash Dispenser

Two product warewash dispenser for "high temperature" applications. One pump for detergent and one pump for rinse aid. **#910100**



3 Pump Warewash Dispenser

Three product warewash dispenser for "low temperature" applications. One pump for detergent, one pump for rinse aid, and one pump for sanitizer. **#910200**



Pulsar Push Button Single Pump Dispenser

Single pump dispenser with push button activation for 3-sink warewash products. **#910300**

Rinse Injection Fitting

Included w/910100 and 910200. A fitting that allows you to connect the rinse tube to the dish machine. **#910500**



Detergent Adaptor Kit

Included w/910100 and 910200. A fitting that allows you to connect the detergent tube to the dish machine. **#910700**

480VAC Conversion w/Transformer

A transformer to convert 480 voltage 240 voltage to provide power to warewash dispenser. **#912500**



Squeeze Tubes (10 per pack)

1/4" fitting **#960500**
Rinse tubes 1/4" fitting **#910600**



Closed System Gallon Mating Cap

Mating Cap for linking closed gallons to dispensing system. **#914900**

Tubing (100 ft. roll)

Clear 1/4" **#960900**
Red 1/4" **#913200**
Blue 1/4" **#913300**
Clear 3/8" **#961700**



Tube Stiffener w/Cap

18" for pails **#960700**
14" for gallons **#910800**

Warewash Wall Chart

A general application wall chart for both high and low temperature warewash procedures. **#987800**



Closed System Switch Out Chart

Instructional chart on safely changing out the closed system gallons. **#987800!**

3-Sink Wall Chart

Instructional chart on 3-sink washing procedures. **#987900**

Warewash Line Tags

Attach to dispenser tubing to quickly identify product when performing switch outs. Helps reduce mistakes. **#963500**



Gallon Wire Rack

Holds four standard gallons, lockable. **#916000**



Closed System Wire Rack

Holds three closed system gallons. **#915500**

L-Hooks

Pair of hooks, holds one closed system gallon each. **#924400**

Inserts and Closures

A system of self-venting, captive closures and inserts to use with standard gallons and pails.

GA Insert **#950100** GA Closure **#950400**
PL Insert **#950600** PL Closure **#950800**

KEY	
	Product Available Worldwide
	Certified Kosher
	This product is Green Seal™ Certified.
	Formulated in partnership with the Environmental Protection Agency's Design for the Environment program.

SparClean® Warewash at a Glance

Product Code by Size	5 GA Pail	F-Style GA & Inserts, CS of 4	GA, CS of 4	2-Liter, CS of 4	QT, CS of 12
Super Suds	764805		764804		764803
All Temperature Detergent	765005	765004I	765004		
Chlorinated Detergent	765105	765104I	765104		
Delimer	765505		765504		
Detergent II	764905	764904I	764904		
High Temperature Rinse Aid	765205	765204I	765204		
Low Temperature Rinse Aid	765305	765304I	765304		
Pot and Pan Detergent	765605		765604	484502	765603
Sanitizer	765405	765404I	765404		
Silverware Pre-soak	765705		765704	485002	
Metal Safe Machine Dish Detergent	765805	765804I	765804		



Distributed by:



Spartan Chemical Company, Inc.
 1110 Spartan Drive, Maumee, Ohio 43537
 1-800-537-8990
www.spartanchemical.com