

# SHIMANO

## CITICA

## CI-200IHG

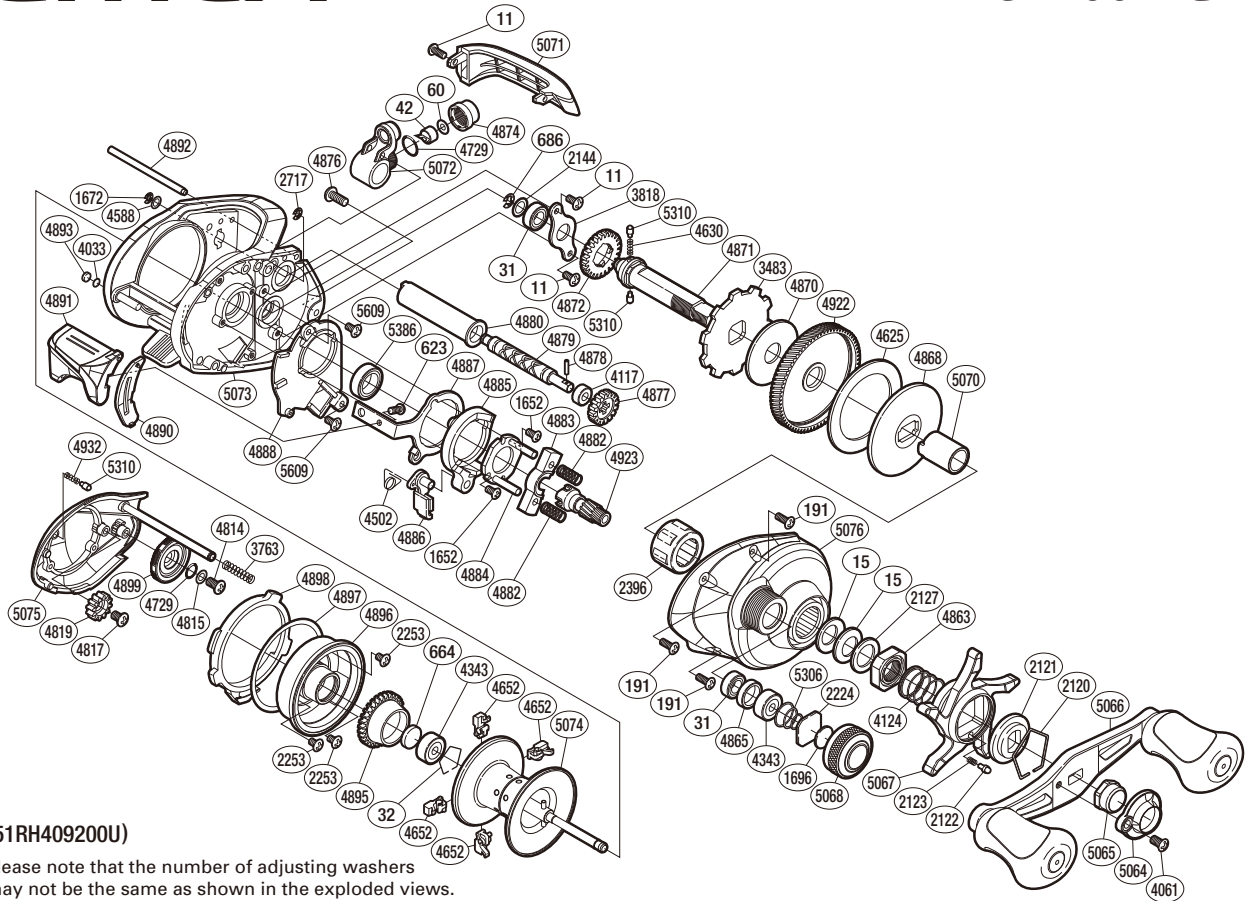

(51RH409200U)

Please note that the number of adjusting washers may not be the same as shown in the exploded views. (Adjustment will vary with each individual product.)

Part No.	Description	Part No.	Description	Part No.	Description
BNT0011	Screw	BNT4502	Clutch Pawl Spring	BNT4892	Stabilizer Bar
BNT0015	Drag Spring Washer	BNT4588	Washer	BNT4893	Anti-Thrust Washer
BNT0031	Ball Bearing	BNT4625	Drag Washer	BNT4895	Brake Ring Gear
BNT0032	Bearing Retainer	BNT4630	Idle Gear Spring	BNT4896	Brake Case
BNT0042	Line Guide Pawl	BNT4652	Brake Shoe	BNT4897	Washer
BNT0060	Spacer	BNT4729	O Ring	BNT4898	Side Plate Cam Lever
BNT0191	Screw	BNT4814	Screw	BNT4899	Brake Dial
BNT0623	Screw	BNT4815	Washer	BNT4922	Drive Gear
BNT0664	Spacer B	BNT4817	Screw	BNT4923	Pinion Gear
BNT0686	E Lock	BNT4819	Idle Gear	BNT4932	Click Spring
BNT1652	Screw	BNT4863	Star Drag Nut	BNT5064	Handle Nut Plate
BNT1672	E Lock	BNT4865	Bearing Spacer	BNT5065	Handle Nut
BNT1696	Cast Control Spacer	BNT4868	Key Washer	BNT5066	Handle Assembly
BNT2120	Click Plate Retainer	BNT4870	Drag Washer	BNT5067	Star Drag
BNT2121	Star Drag Click Plate	BNT4871	Drive Shaft	BNT5068	Cast Control Cap
BNT2122	Click Pin	BNT4872	Idle Gear	BNT5070	Roller Clutch Inner Tube
BNT2123	Click Spring	BNT4874	Pawl Cap	BNT5071	Level Wind Protector
BNT2127	Star Drag Spacer	BNT4876	Screw	BNT5072	Line Guide
BNT2144	Washer	BNT4877	Idle Gear	BNT5073	One-Piece Frame
BNT2224	Spool Tension Spacer	BNT4878	Worm Shaft Pin	BNT5074	Spool Assembly
BNT2253	Screw	BNT4879	Worm Shaft	BNT5075	Left Side Plate
BNT2396	Roller Clutch Bearing	BNT4880	Level Wind Guard	BNT5076	Right Side Plate
BNT2717	E Lock	BNT4882	Yoke Spring	BNT5306	Spool Tension Spring
BNT3483	Anti-Reverse Ratchet	BNT4883	Yoke	BNT5310	Idle Gear Pin
BNT3763	Side Plate Spring	BNT4884	Clutch Cam Retainer	BNT5386	Ball Bearing
BNT3818	Drive Shaft Retainer	BNT4885	Clutch Cam	BNT5609	Screw
BNT4033	Washer	BNT4886	Clutch Pawl		
BNT4061	Screw	BNT4887	Clutch Plate	BNT4652	Brake Shoe (accessory)
BNT4117	Bushing	BNT4888	Clutch Guard		
BNT4124	Star Drag Spring	BNT4890	Clutch Bar Guide		
BNT4343	Ball Bearing	BNT4891	Quick-Fire II Clutch Bar	BNT4692	B-100 Oil (accessory)