

# Jones Stephens' PlumBite® Push to Connect Check Valves

Job Name	_____
Location	_____
Engineer	_____
Contractor	_____
Tag	_____ PO# _____

## Specifications

Jones Stephens' PlumBite® Push to Connect Check Valves are a heat-free method of joining Copper, CPVC, PE-RT or PEX tubing, designed to save time on installation and to connect piping with relative ease and confidence. No soldering, glue, heat or external tools are required to join the pipe. Just insert the pipe and the stainless steel gripper ring, bite down, and hold the pipe tightly while the EPDM o-ring seals against leakage. Disassembly is just as fast using the optional disassembly tool, so fittings can be easily removed and re-used.

## Applications

Jones Stephens' PlumBite® Push to Connect Check Valves are approved for use with commercial and residential potable and non-potable water applications.

**NOTE:** Not for use with PEX-AL-PEX or PEX tubing with an oxygen barrier.  
NOT FOR USE AT OR BELOW GROUND LEVEL.

## Materials

Gasket- EPDM, Peroxide Cured  
Valve Body- Brass

## Dimensions and Product Offering

PART NO. INDIVIDUAL	PART NO. BULK	A NOMINAL (IN.)	B (IN.)	B TOLERANCE +/- (IN.)
C77466LF	-	0.50	2.35	0.08
C77467LF	-	0.75	3.01	0.08

## Performance Specifications

Maximum Temperature - 180°F  
Maximum Pressure - 200 PSI

## Certifications/Listings/Approvals

- NSF/ANSI/CAN 61
- NSF/ANSI/CAN 372
- NSF/ANSI 14
- IAPMO IGC 312-2018a
- SDWA Compliant
- Lead Law Compliant
- MASS Approved
- Vermont Act 193 Compliant

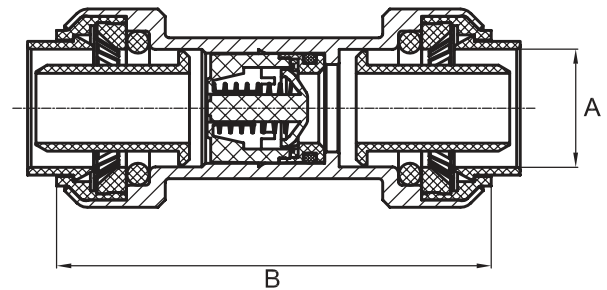

# Jones Stephens' PlumBite® Push to Connect Check Valves

Job Name	_____
Location	_____
Engineer	_____
Contractor	_____
Tag	_____ PO# _____

## Exploded View

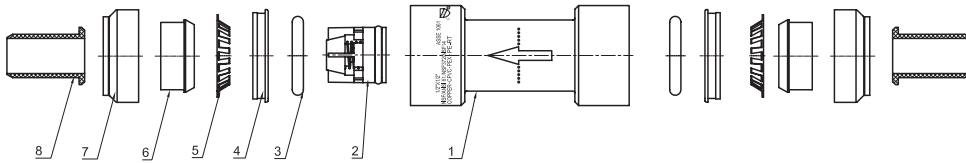

REF NO.	DESCRIPTION	MATERIAL	QTY
1	BODY	LEAD FREE BRASS (C46500)	1
2	VALVE CORE ASSEMBLY	ASSEMBLY (POM+S304+EPDM)	1
3	O-RING	EPDM	2
4	LOCK RING	POM	2
5	GRIPPER RING	STAINLESS STEEL (S304)	2
6	RELEASER	POM	2
7	PROTECTOR	POM	2
8	TUBE SUPPORT	POM	2

## Flow Capacity

