

# KINGSTON

KITCHEN & BATH

## INSTALLATION INSTRUCTIONS

### Extension Tube

This Item is intended to be used as a tailpiece extension.

### Instructions:

1. Measure and cut to the desired length
2. Place rubber washer over the top opening (larger diameter)
3. Lightly thread nut and insert into the sinks drain tailpiece
4. Tighten using a pipe or spud wrench.
5. Insert other end into "P" trap and tighten the compression washer.
6. Run water to test for leaks

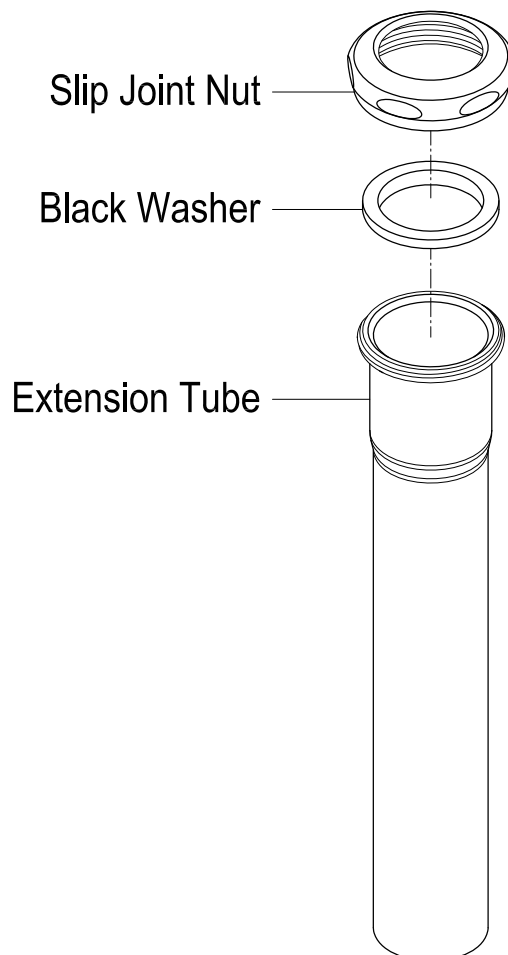

## **NOTICE**

Failure to follow all directions may cause leaks  
which may result in water damage

[www.kingstonbrass.com](http://www.kingstonbrass.com)  
TOLL-FREE CUSTOMER SERVICE: 1-877-2-KBRASS  
TECHNICAL SUPPORT E-mail: [service@kingstonbrass.com](mailto:service@kingstonbrass.com)  
12775 Reservoir Street, Chino, CA 91710