

<b>SIDES</b>	<b>BOTTOM</b>
12 1/2"-3/4" MOON KNOCKOUTS	10 KNOCKOUTS
	10 1/2"-3/4" MOON KNOCKOUTS
Material: Steel-0.0625"-G60 Galvanized	

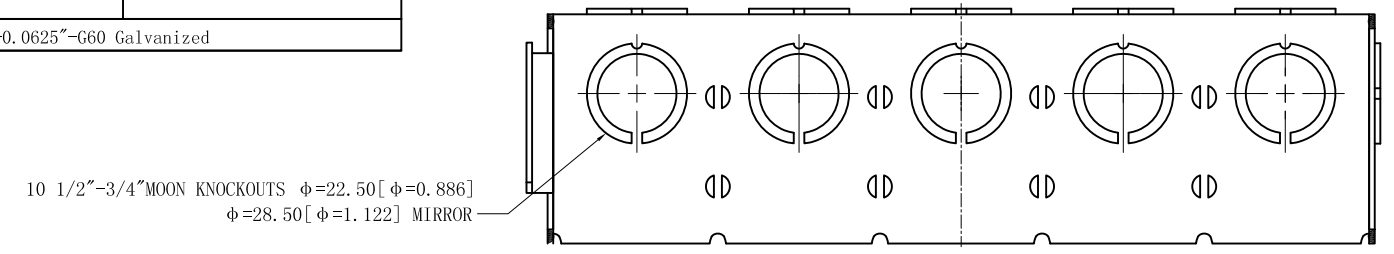

10 1/2"-3/4" MOON KNOCKOUTS  $\phi=22.50$  [ $\phi=0.886$ ]  
 $\phi=28.50$  [ $\phi=1.122$ ] MIRROR

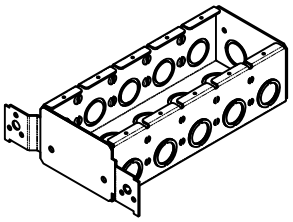
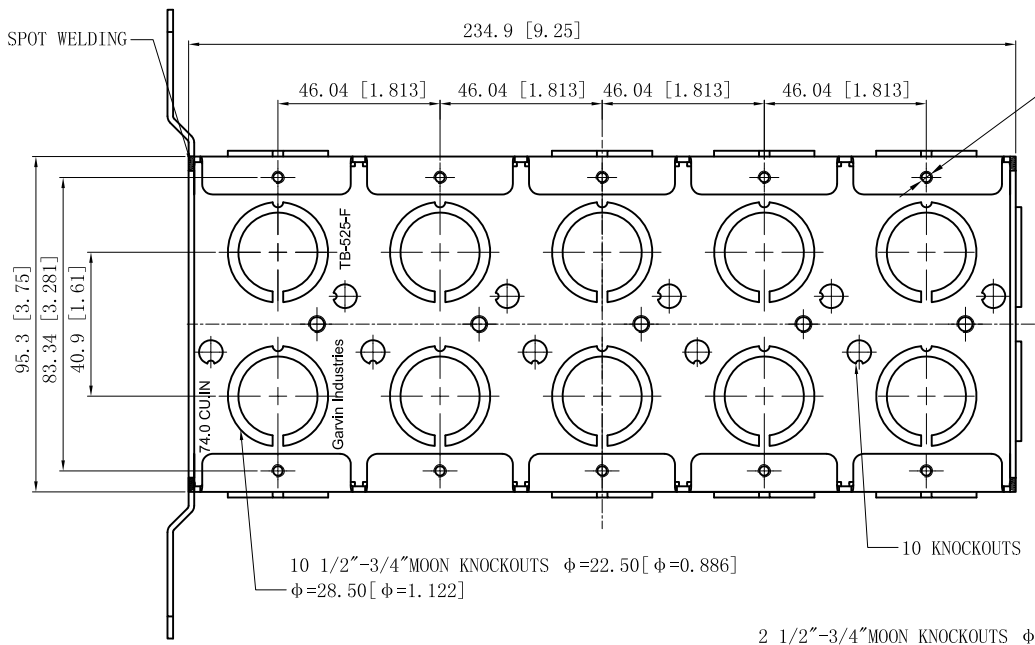
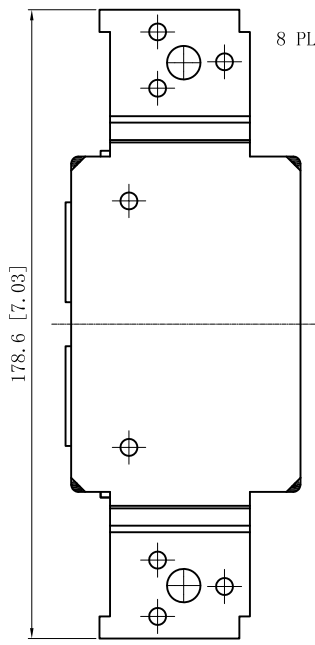

10 1/2"-3/4" MOON KNOCKOUTS  $\phi=22.50$  [ $\phi=0.886$ ]  
 $\phi=28.50$  [ $\phi=1.122$ ]

10 KNOCKOUTS  $\phi=6.75$  [ $\phi=0.266$ ]

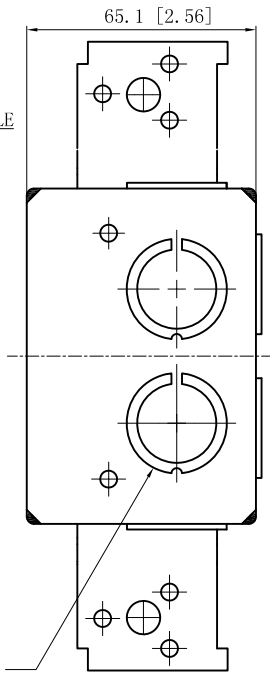

2 1/2"-3/4" MOON KNOCKOUTS  $\phi=22.50$  [ $\phi=0.886$ ]  
 $\phi=28.50$  [ $\phi=1.122$ ] MIRROR

This data sheet is for reference only .GARVIN INDUSTRIES reserves the right to make changes to the design without prior notice.

<b>DESCRIPTION</b>
<b>TRADE REFERENCE TERMS</b>

<b>STANDARD PACKING</b>
5 PCS

<b>GARVIN INDUSTRIES</b>		
TITLE SOLID MASONRY BOXS WITH "F" STYLE BRACKET		
SIZE A4	DWG NO. TB-525-F	REV
DATA SHEET		
www.garvinindustries.com		