

SIMPLIHOME

Avington / Mia / Hayes

Storage Hamper Bench

Model # AXCBSAVN06-WH

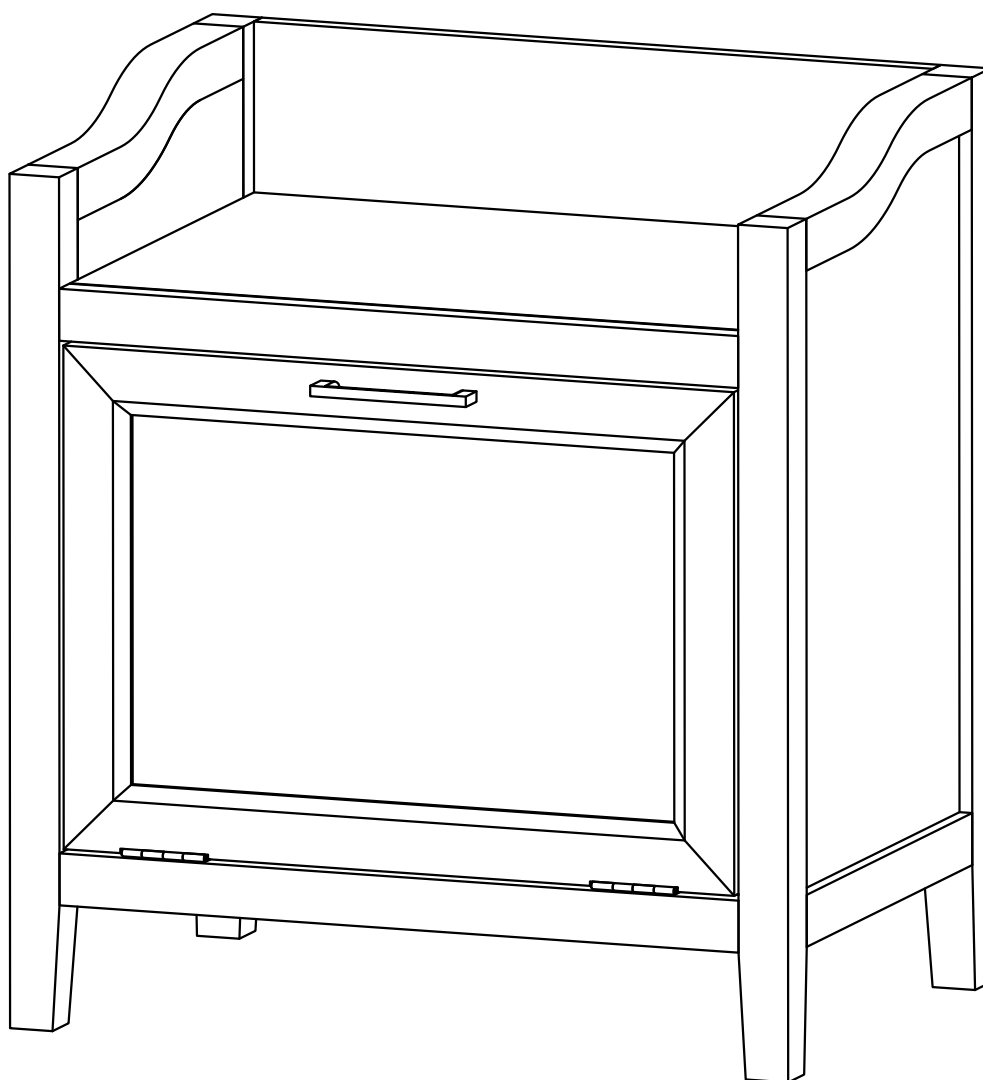

brooklyn + max™

WyndenHall™
HOME DECOR

SIMPLIHOME

Great quality is a right.

Thank you for shopping with Simpli Home,
America's top brand for high-value furniture.



It's time to register your product warranty.

It's quick and easy. And you'll be happy you did.

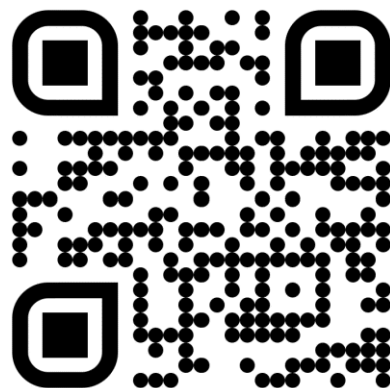

- ✓ Activate your **1-year** warranty
- ✓ Automatic entry to win a **\$500** gift certificate
- ✓ Earn instant rewards and **save**

simpli-home.com/product-registration

SIMPLIHOME

Review your product and collect rewards!

Thank you for your purchase! We hope you enjoy it. We'd love your feedback. Please share a review and get instant rewards!



simpli-home.com/product-review



Share photos and get your cash back!



Send us images or share them on social and qualify for instant rewards. You may even receive store credit on your entire purchase!

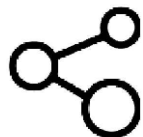

simpli-home.com/share-images

SIMPLIHOME®

For Fastest Customer Service:



1. Open your phone's camera.
2. Point your phone's camera at the QR code to scan.
3. Click on the pop up.
4. You'll be taken to our customer service page.
5. Fill the form with your order information and issue.
6. Submit form.
7. A customer service associate will contact you.

Other ways to contact us...



Email Us

customerservice@simpli-home.com



Visit Us

Visit our site directly at
www.simpli-home.com



Call Us

1-866-518-0120
Monday to Friday
9am to 5pm EST

***If you've purchased from a retailer and you wish to return the product, please contact the retailer directly.**

IMPORTANT : Please read this manual carefully before beginning assembly of this product. Keep this manual for future reference.

Safety Information

This furniture is designed for indoor use.

Identify all the parts and hardware. Do not discard of the packaging until you have checked that you have all of the parts and hardware required.
Hardware package may have spare parts.

WARNING: This item contains small parts which can be swallowed by children and pets. Keep children and pets away during assembly. To avoid danger of suffocation, always keep plastic bags away from children and pets. We recommend that you assemble this unit on a carpeted floor to avoid scratches. If using power tools, set the tool to low torque to avoid damage.

May require 2 people for ease of assembly.

Care & Maintenance

To clean, use a soft or slightly damp cloth, then wipe with a clean, dry cloth.
Dust with a soft dry cloth.
Do not use ammonia-based cleaning products, as they will damage the finish.
Do not leave liquids or damp cloths on this furniture.
To avoid dulling of the finish, do not place this furniture in direct sunlight.
Please inspect and tighten all screws or bolts on a regular basis to ensure proper performance and safety of your item.

Part Description

A

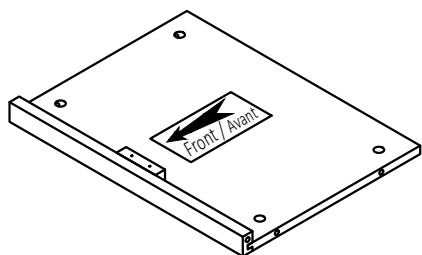

TOP
QTY 1

BL

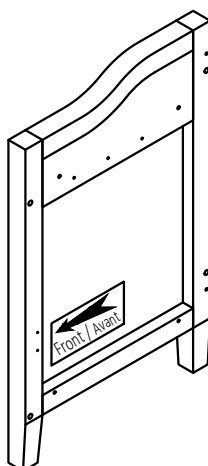

LEFT SIDE
QTY 1

BR

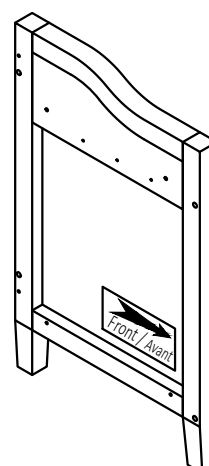

RIGHT SIDE
QTY 1

C

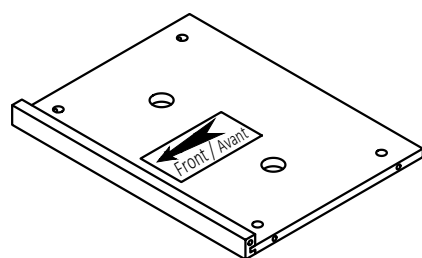

BOTTOM SHELF
QTY 1

D

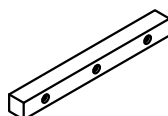

SUPPORT BAR
QTY 2

E

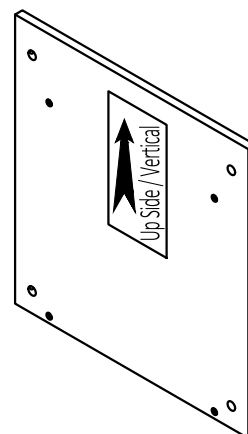

BACK PANEL
QTY 1

F

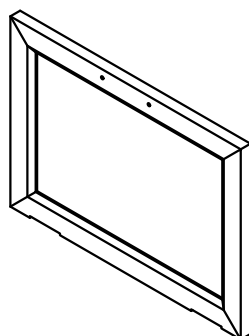

DOOR
QTY 1

Hardware Description

1

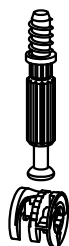

CAM LOCK PIN
CAM LOCK
QTY 12 SETS

2



WOOD DOWEL
Ø8 X 30mm
QTY 8

3

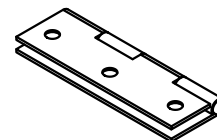

HINGE
QTY 2

4

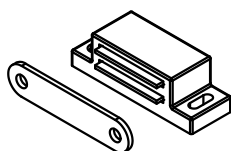

MAGNET AND PLATE
QTY 1 SET

5

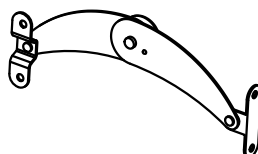

LID SUPPORT
QTY 1

6

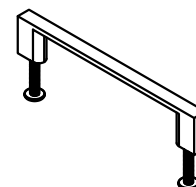

HANDLE
M4 X 25 mm
QTY 1 SET

7



PHILLIPS SCREW
M4 X 40mm
QTY 10

8

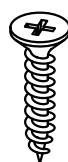

PHILLIPS SCREW
M3 X 15mm
QTY 20

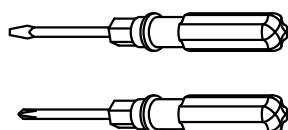

Required -
Flathead screwdriver
Phillips screwdriver
Rubber mallet
Not Included



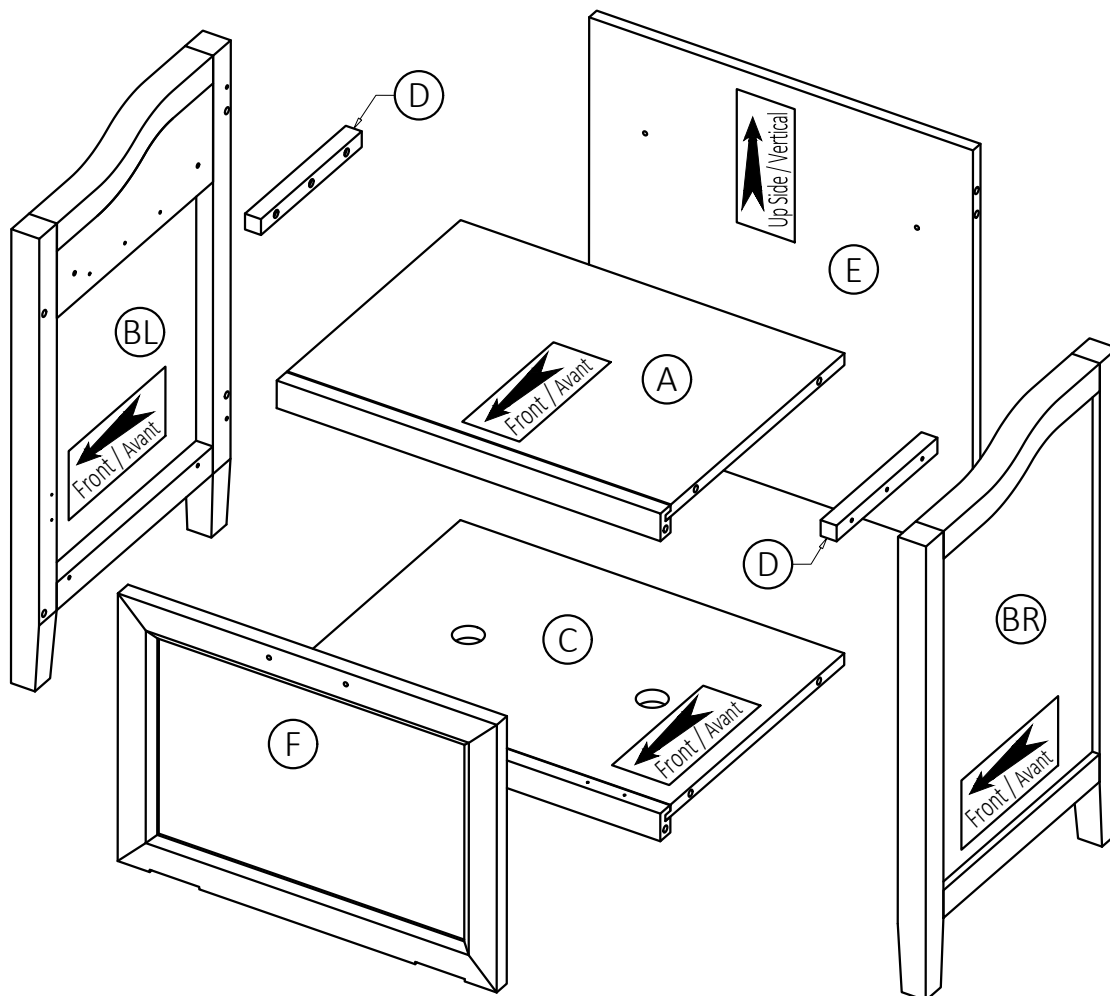

Step 1

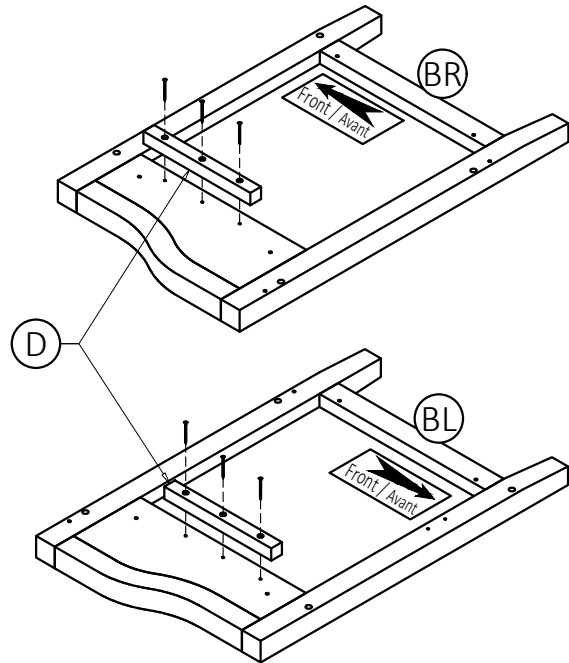
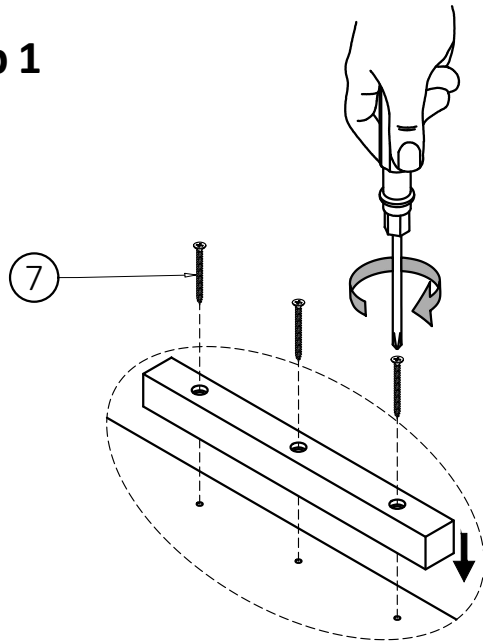

1. Attach Support Bar (D) using three Phillips Screws (7) into pre-drilled holes on sides (BL), (BR).
2. Use Phillips screwdriver to secure Screws. Do not over-tighten.

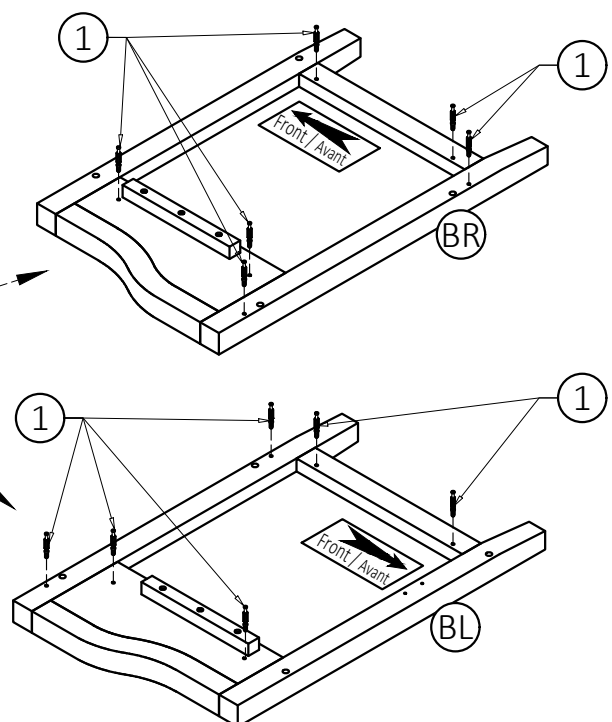
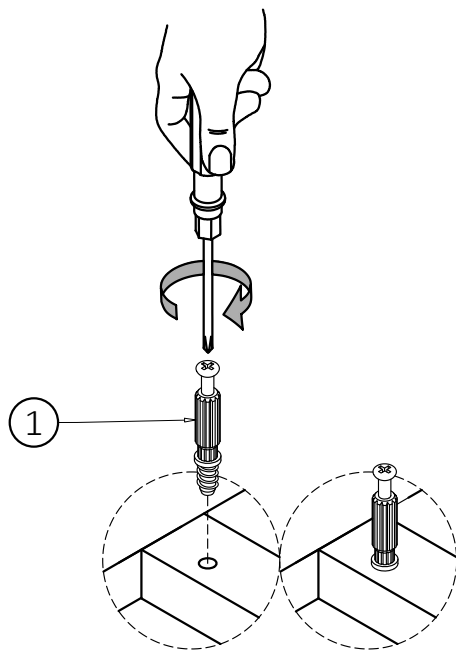
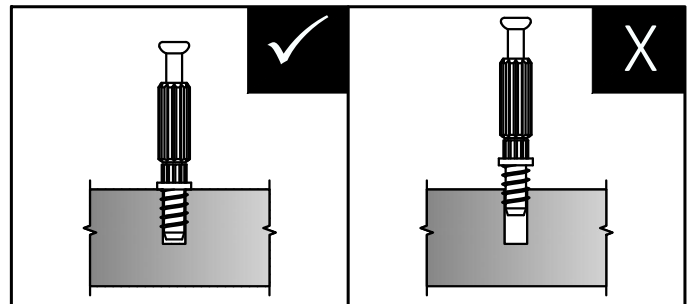

3. Attach Cam Lock Pins (1) into pre-drilled holes on each part (BL), (BR).
4. Use Phillips screwdriver to secure Cam Lock Pins. Do not over-tighten.

Step 2

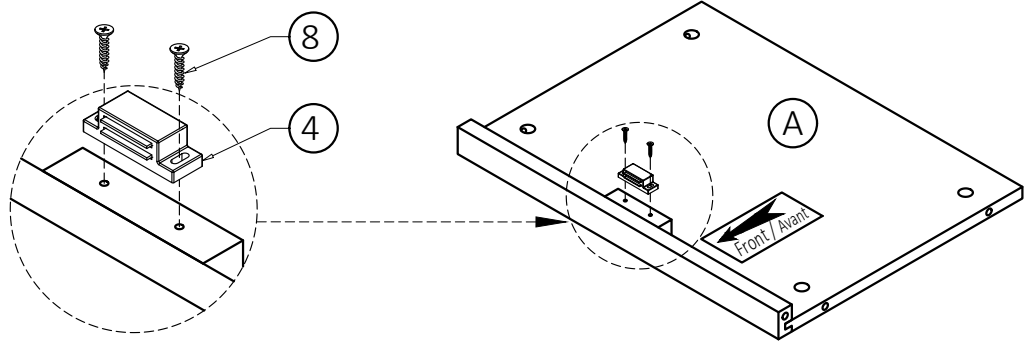

1. Attach Magnet (4) using Phillips Screws (8) into pre-drilled holes on part (A).
2. Use Phillips screwdriver to secure Screws. Do not over-tighten.

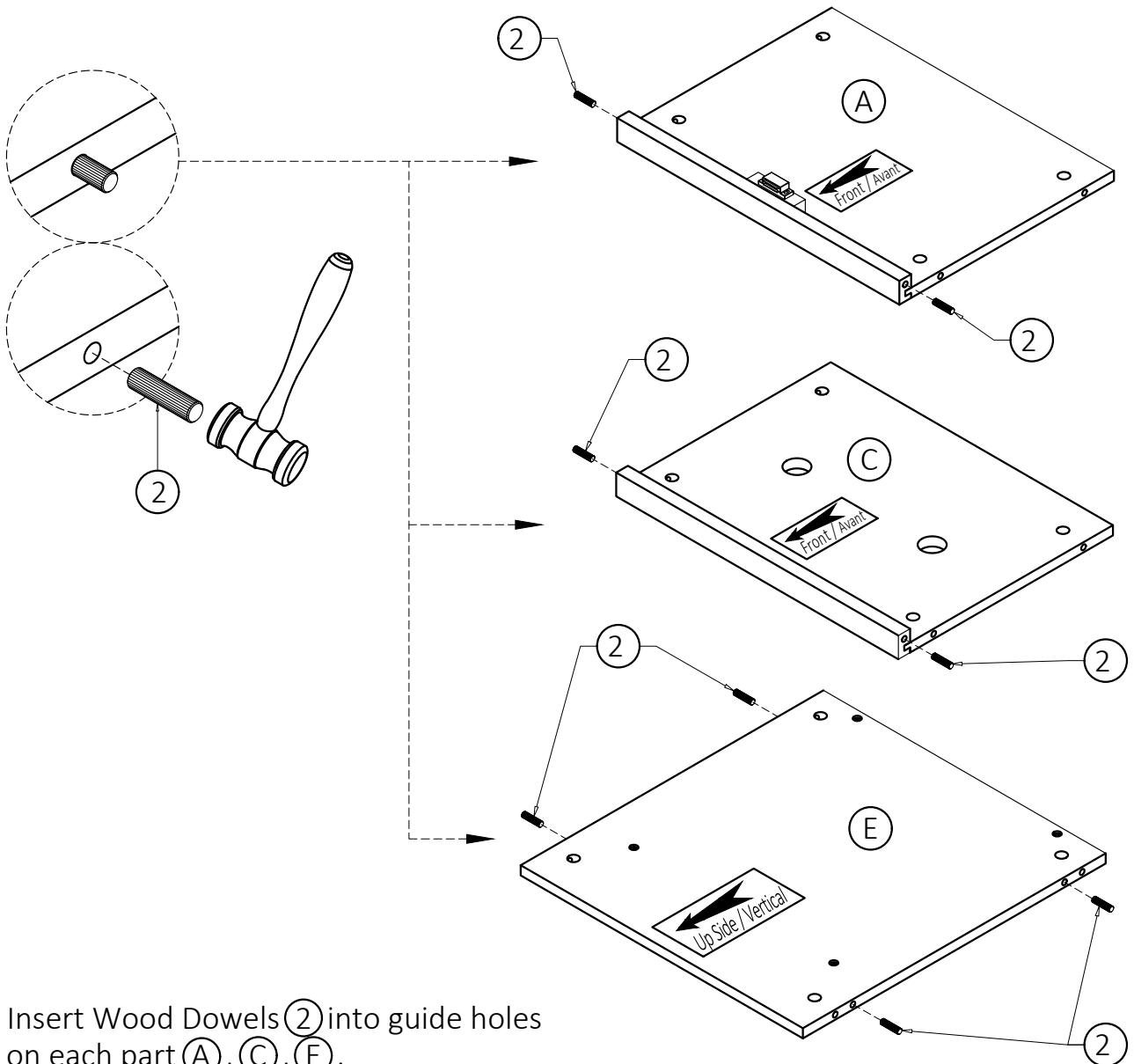

3. Insert Wood Dowels (2) into guide holes on each part (A), (C), (E).
4. Use rubber mallet to tap Dowels (2) into bottom of holes securely. 1/2 length of Dowels should be exposed.

Step 3

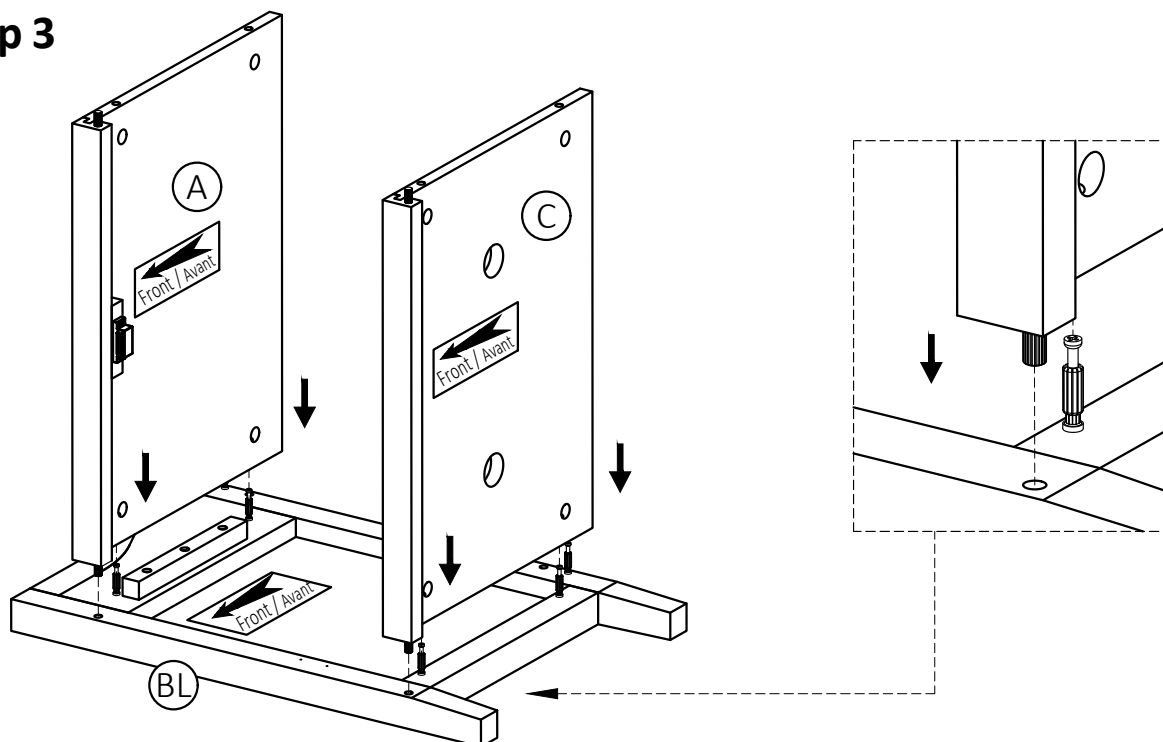

1. Align Wood Dowels and Cam Lock Pins with guide holes and attach parts (A), (C) to Left Side (BL).

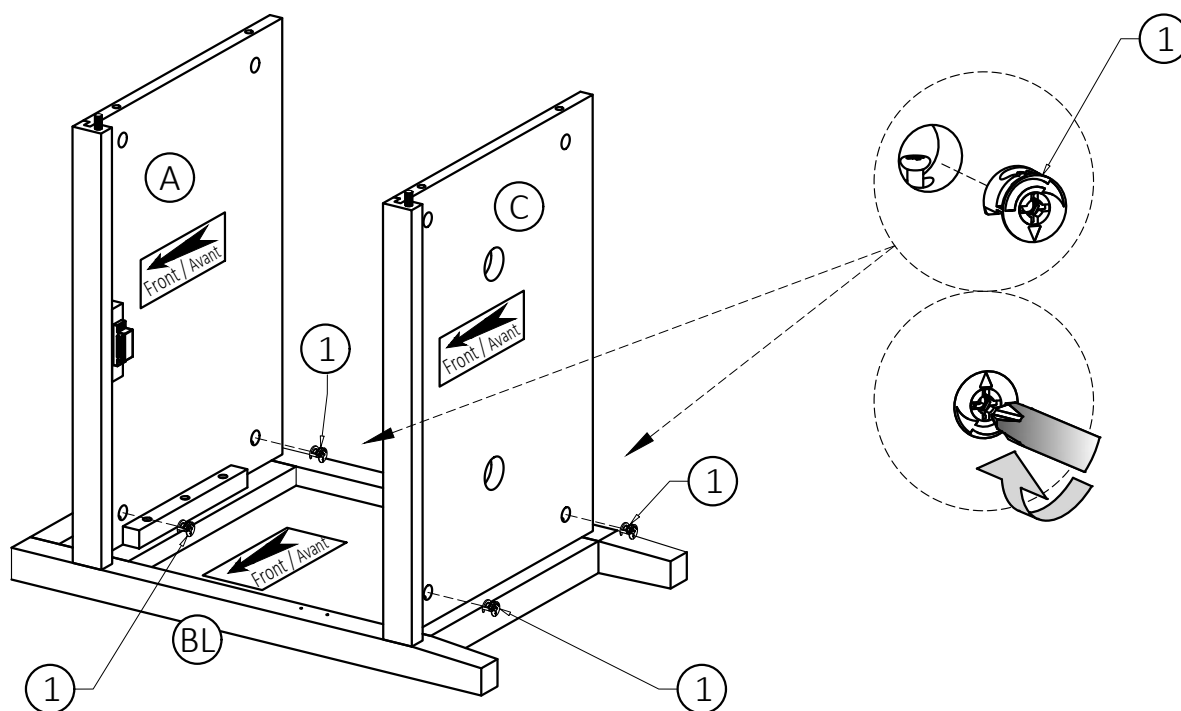

2. Insert two Cam Locks (1) into guide holes on each part (A), (C).
3. Use Phillips screwdriver to secure Cam Locks.

Step 4

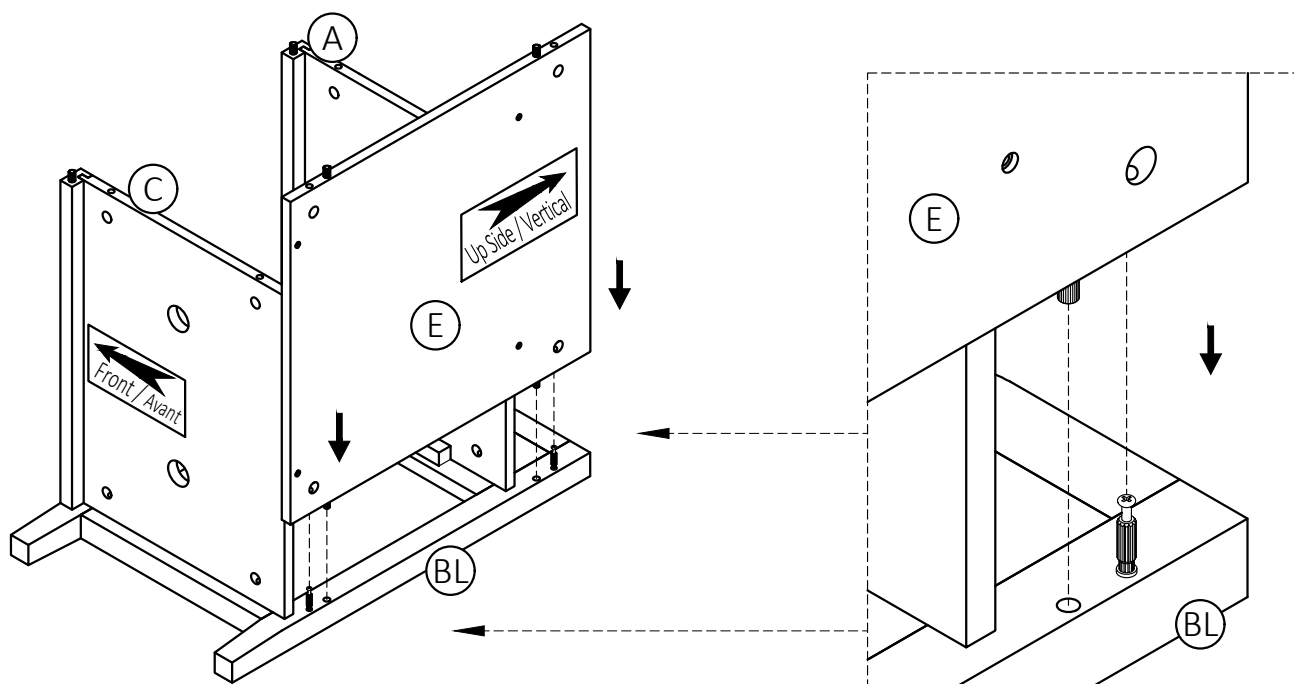

1. Align Wood Dowels and Cam Lock Pins with guide holes and attach part (E) to part (BL).

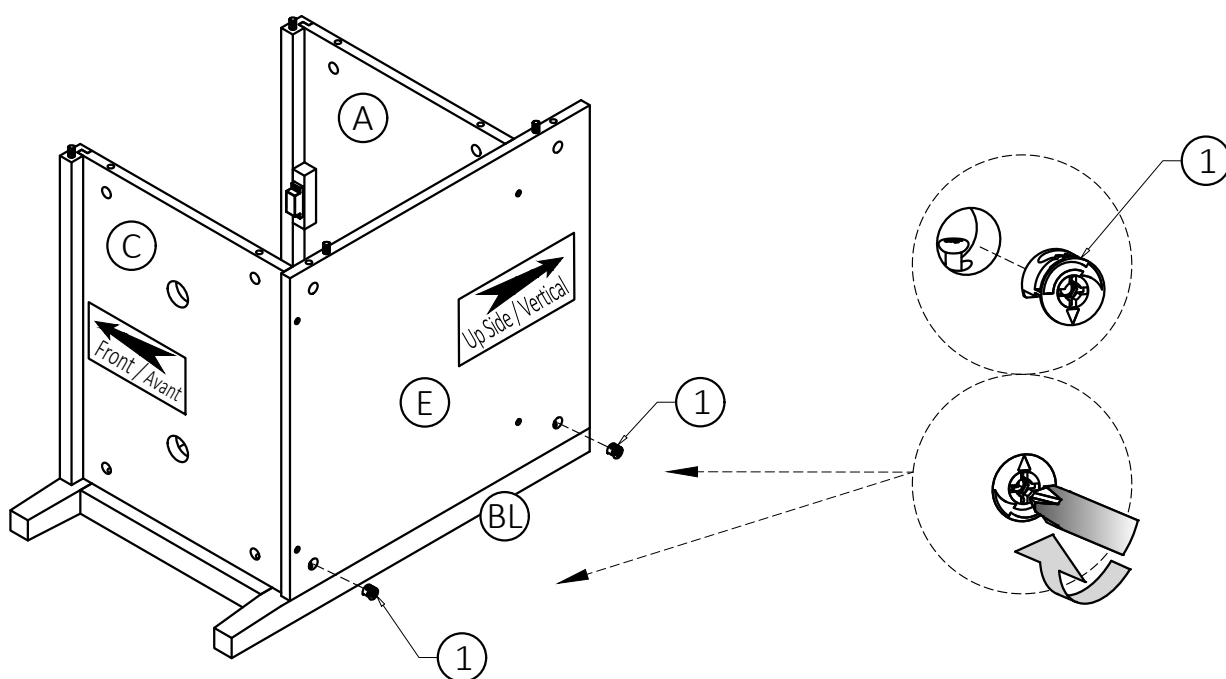

2. Insert two Cam Locks (1) into guide holes on part (E).
3. Use Phillips screwdriver to secure Cam Locks.

Step 5

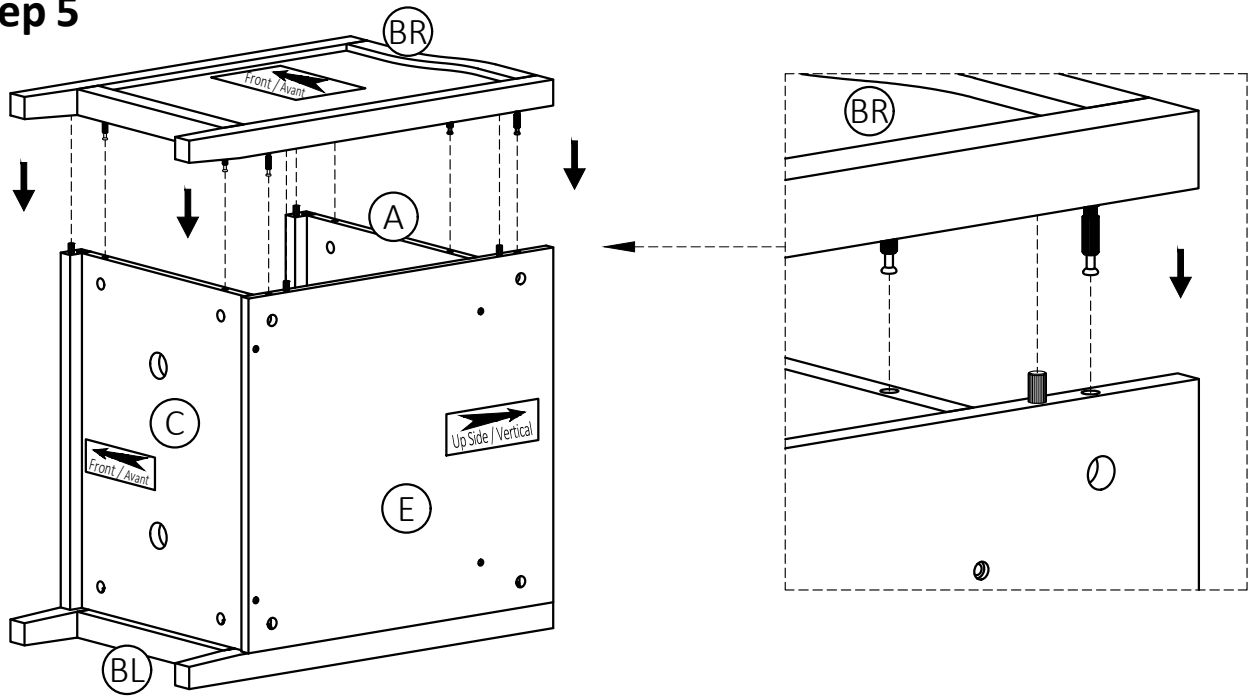

1. Align Wood Dowels and Cam Lock Pins with guide holes and attach parts (A), (C), (E) to Right Side (BR).

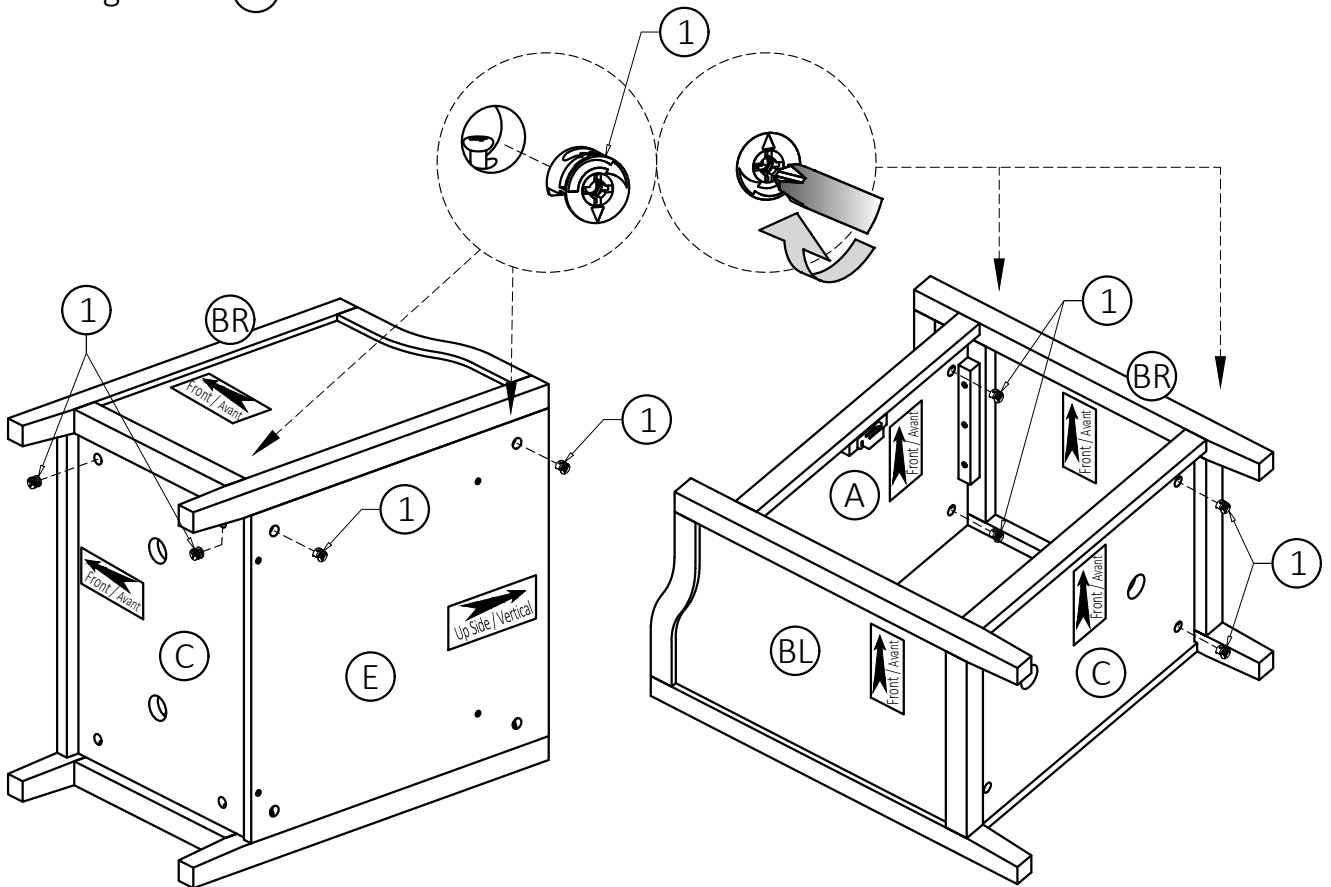

2. Insert two Cam Locks (1) into guide holes on each part (A), (C), (E).
3. Use Phillips screwdriver to secure Cam Locks.

Step 6

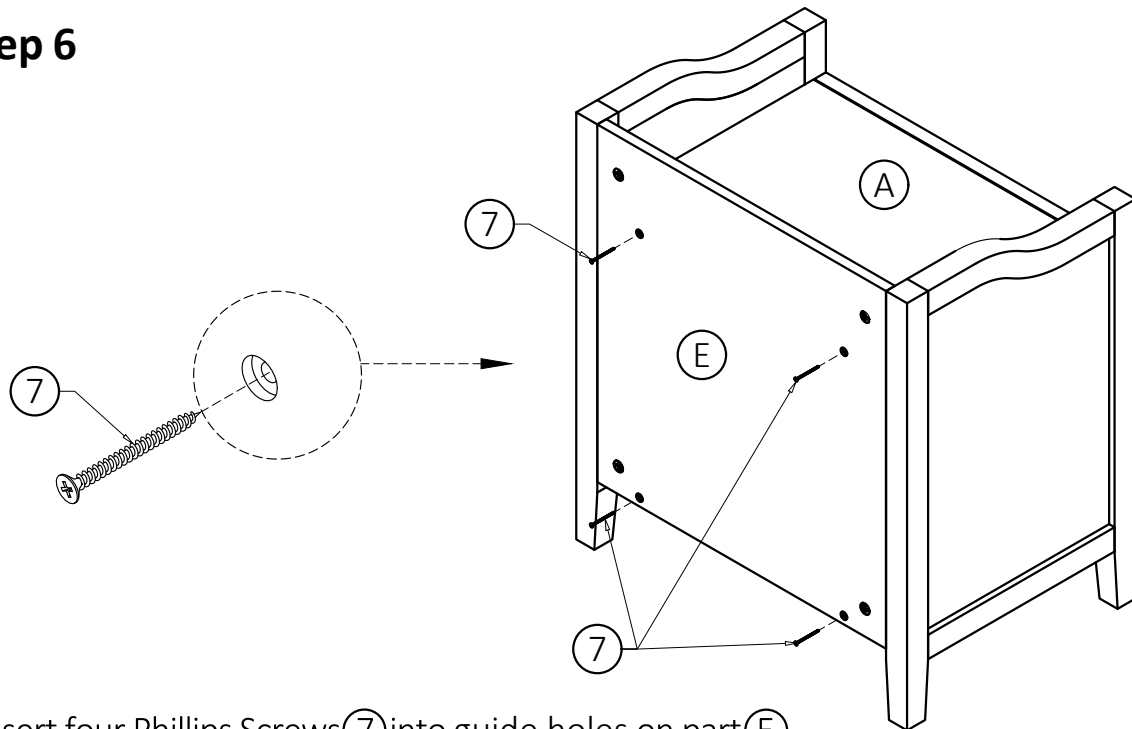

1. Insert four Phillips Screws (7) into guide holes on part (E).
2. Use Phillips screwdriver to secure Screws. Do not over-tighten.

Step 7

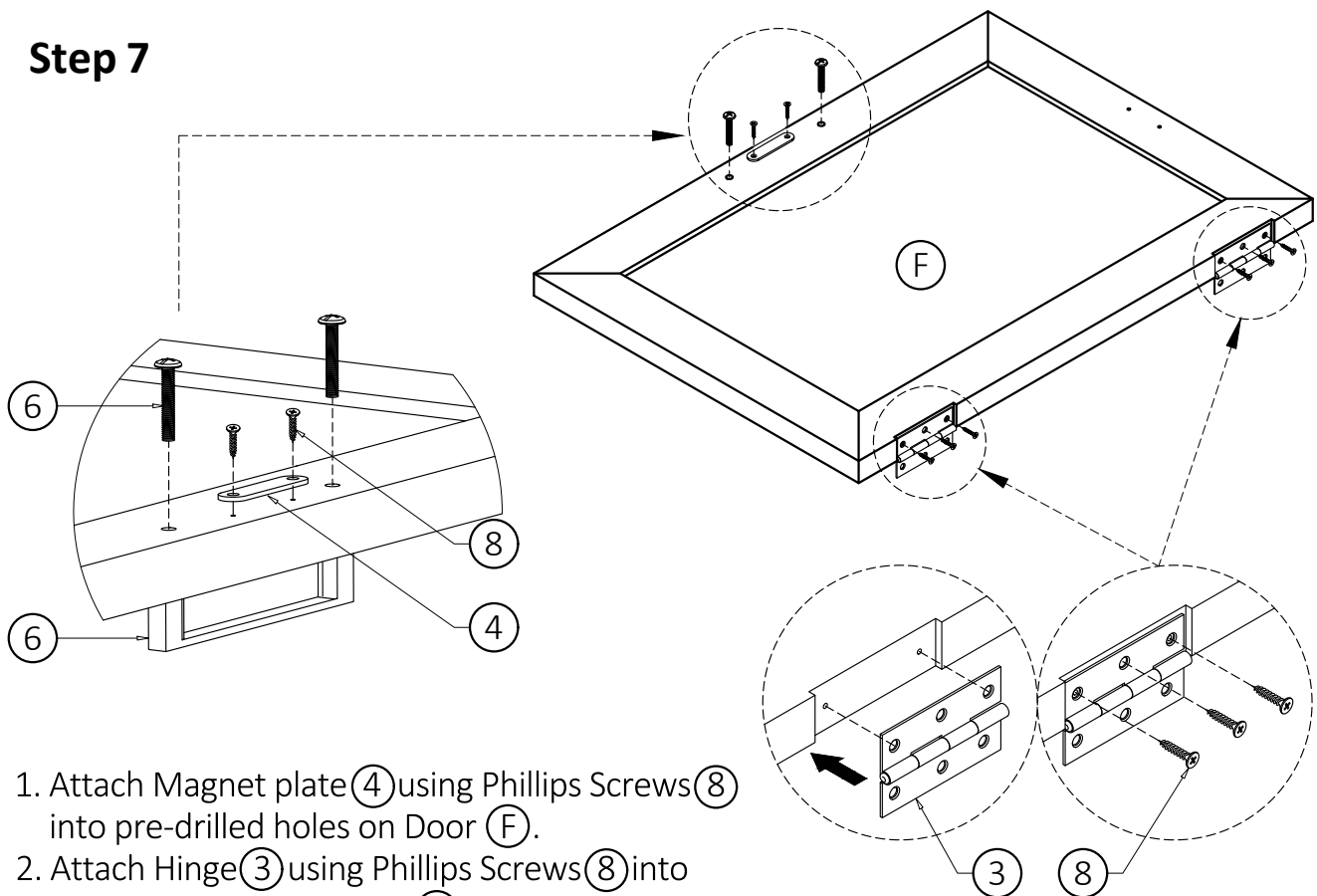

1. Attach Magnet plate (4) using Phillips Screws (8) into pre-drilled holes on Door (F).
2. Attach Hinge (3) using Phillips Screws (8) into pre-drilled holes on Door (F).
3. Use Phillips screwdriver to attach Handle (6) to Door (F).
4. Use Phillips screwdriver to secure Screws. Do not over-tighten.

Step 8

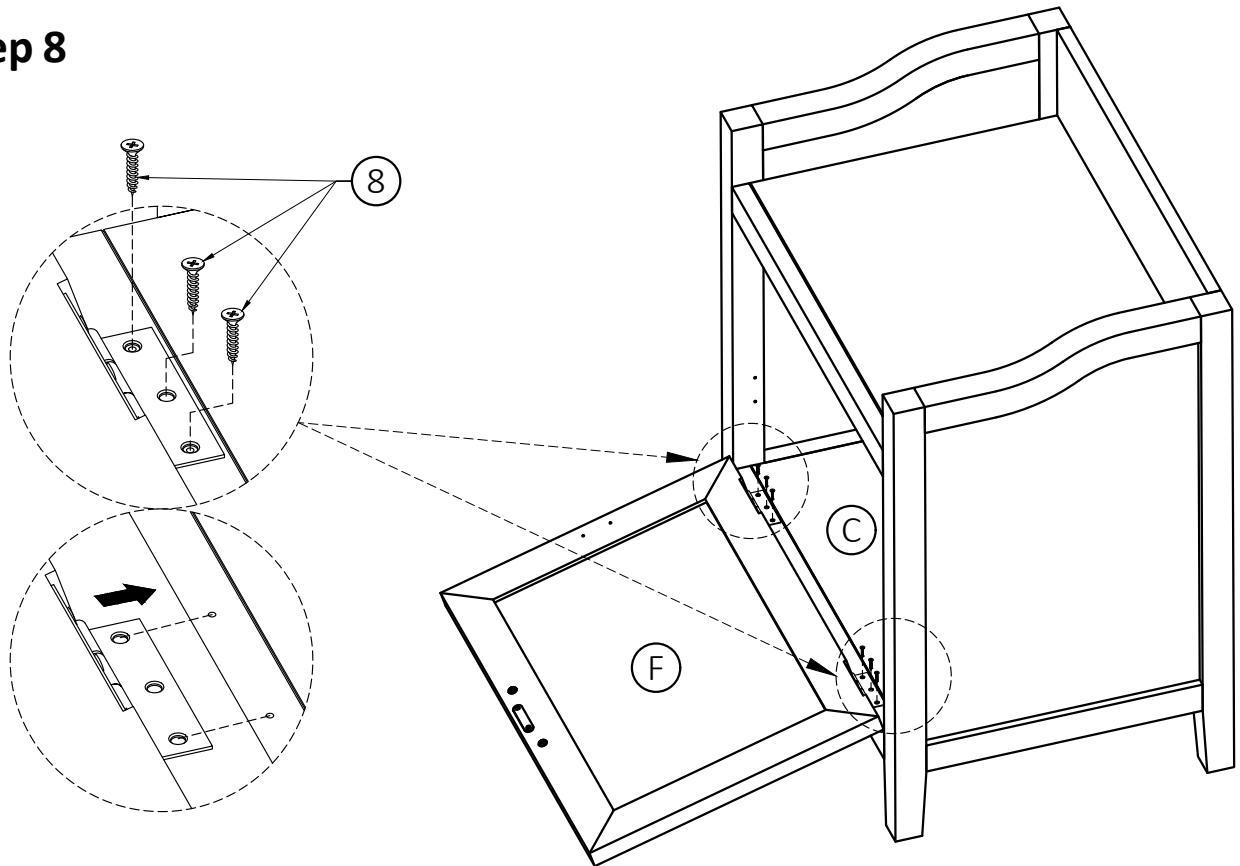

1. Attach Hinge on Door (F) to Bottom Shelf (C) using Phillips Screws (8) into pre-drilled holes on Bottom Shelf (C).
2. Use Phillips screwdriver to secure screws. Do not over-tighten.

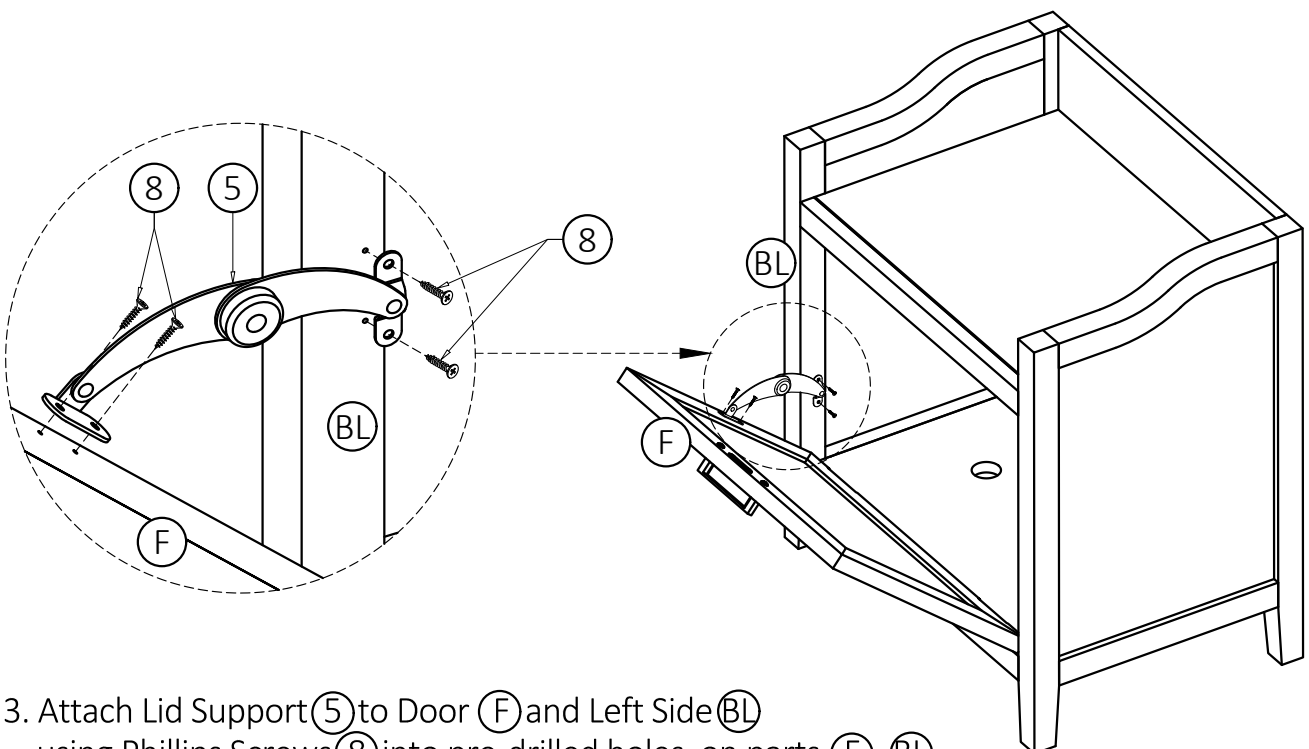

3. Attach Lid Support (5) to Door (F) and Left Side (BL) using Phillips Screws (8) into pre-drilled holes on parts (F), (BL).
4. Use Phillips screwdriver to secure screws. Do not over-tighten.