

SIDES	BOTTOM
Material: Steel-(C1008-C1018) Galvanized	

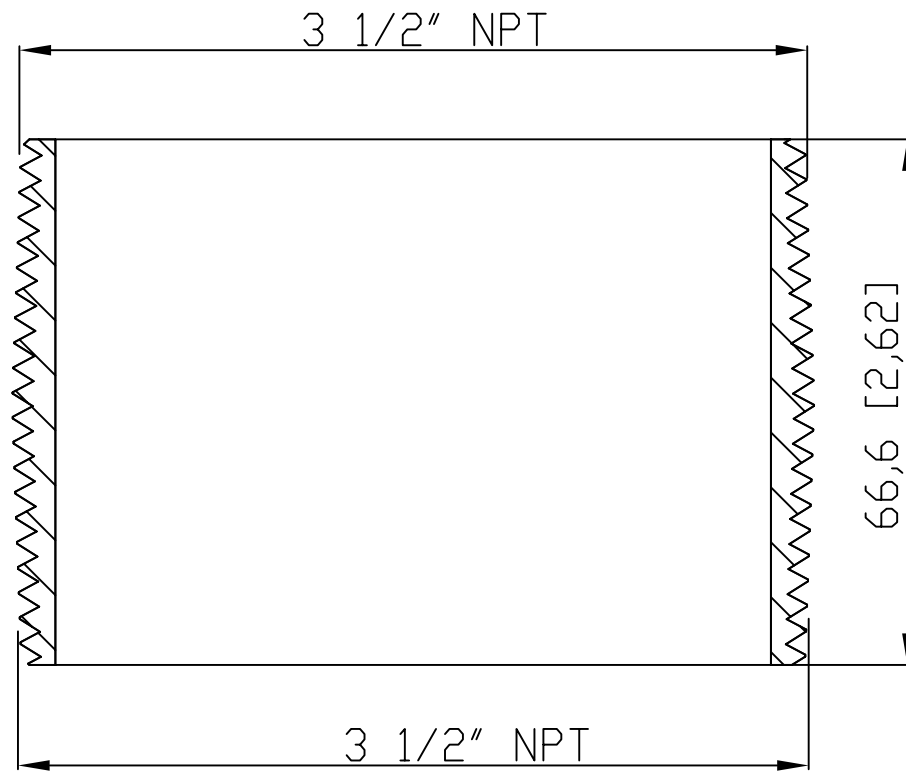

VIEW A-A

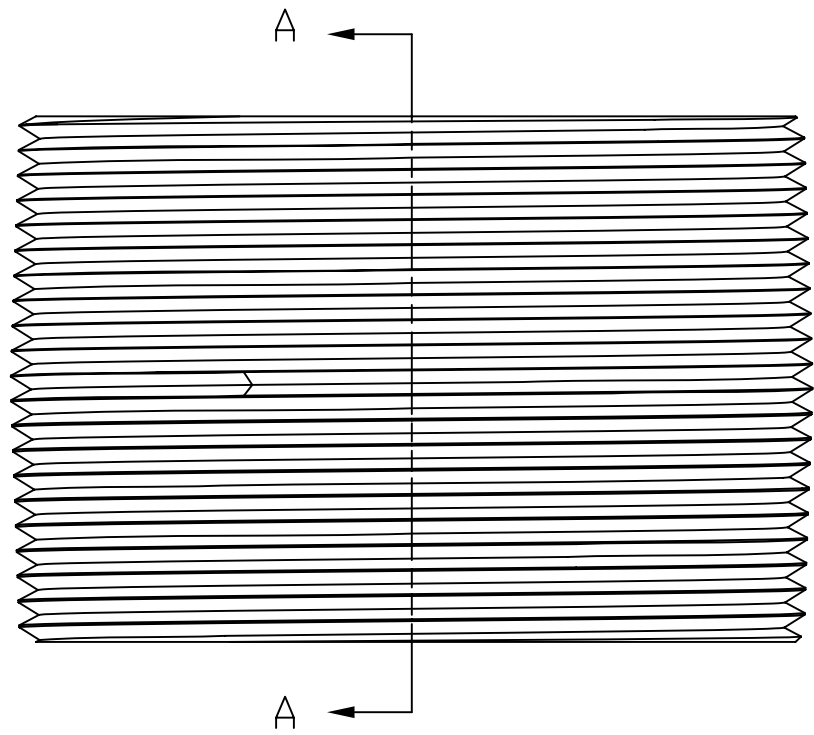
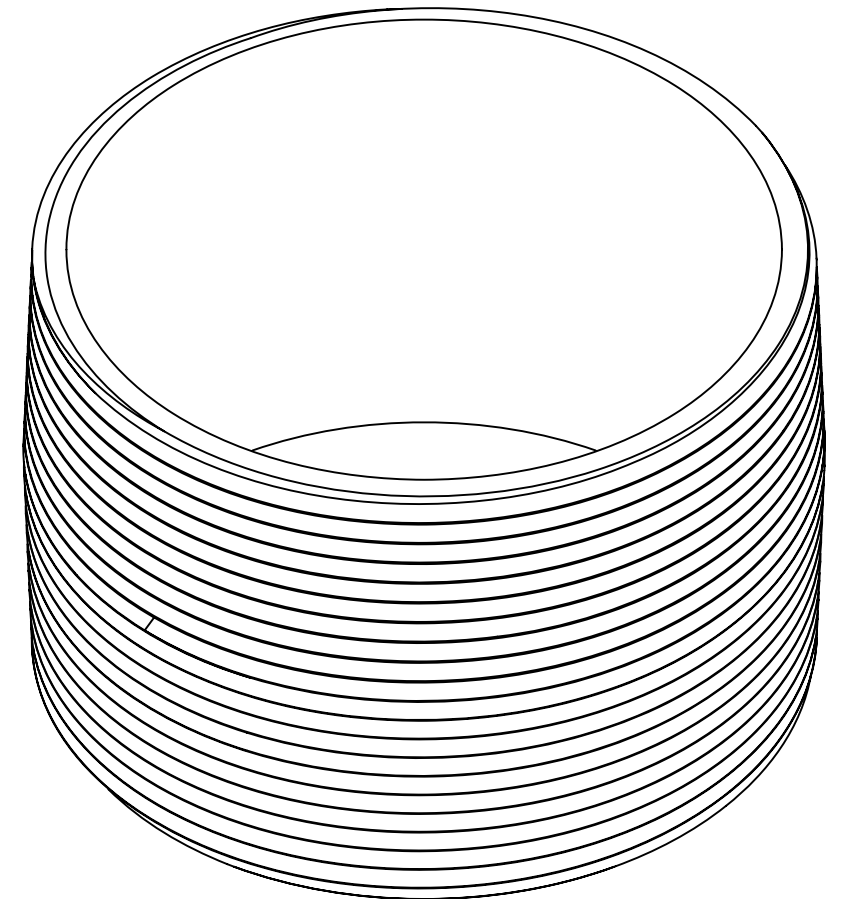

This data sheet is for reference only .GARVIN INDUSTRIES reserves the right to make changes to the design without prior notice.

DESCRIPTION
TRADE REFERENCE TERMS

STANDARD  
PACKING

**GARVIN INDUSTRIES**

TITLE  
RIGID COND NIPPLE

SIZE A4	DWG NO. DS-RN-350-C	REV A
------------	------------------------	----------