

dynarex
Resp-O₂ **My Piggy**
Compressor
Nebulizer

Reorder No. 34404

INSTRUCTION MANUAL



TABLE OF CONTENTS

INSTRUCTIONS..... 1
SAFETY INFORMATION 2
MAIN UNIT 3
PREPARING THE NEBULIZER FOR USE 4
USING THE DEVICE 4
CLEANING 4
CARING FOR THE DEVICE 5
TROUBLESHOOTING 5
WARRANTY 5
CLASSIFICATION 6
SPECIFICATIONS 6

INSTRUCTIONS

Thank you for purchasing the Dynarex Compressor Nebulizer. The compressor forces air to the nebulizer. When the air enters the nebulizer, it converts the prescribed medication into an aerosol of microscopic droplets that can easily be inhaled.

Your compressor nebulizer should be used under the supervision of a licensed physician and/or a respiratory therapist. We encourage you to thoroughly read this guidebook to learn about the features of this product. Any use of this product other than its intended use should always be avoided.

SAFETY INFORMATION

To ensure the correct use of the product, basic safety measures should always be followed, including the warnings and cautions listed in this instruction manual.

WARNING

- Measure the correct dose of medication and other solutions prescribed by your physician or licensed healthcare practitioner.
- Do not cover the compressor with a blanket, towel, or any other type of cover during use. This could result in the compressor overheating or malfunctioning.
- Do not use the device where the device may be exposed to flammable gas or vapors.
- Do not use mineral water in the nebulizer for nebulizing purposes.
- Always dispose of any remaining medication in the medication tank after each use. Use fresh medication each time you use the device.
- Do not leave the device or its parts where it will be exposed to extreme temperatures or changes in humidity, such as leaving the device in a vehicle during warm or hot months, or where it will be exposed to direct sunlight.

CAUTION

- Limit the use of the device to 50 minutes at a time, and wait 50 minutes before using the device again.
- Provide close supervision when this device is used near infants, children or compromised individuals.
- Do not insert any object into the compressor.
- Make sure that the air filter is clean. If the air filter has changed color or has been used for 60 days, replace the filter.
- Make sure that the nebulizer kit is correctly assembled, the air filter is properly installed, and the air tube is correctly connected to the compressor and the nebulizer kit. Air may leak from the air tube during use if not securely connected.
- Inspect the compressor (main unit) and the nebulizer parts each time before using the device. Make sure no parts are damaged, the nozzle and air tube are not blocked and the compressor operates normally.
- Do not use the device if the air tube is bent.
- Do not block the air filter cover.
- Do not alter the baffle, the nozzle in the medication tank or any part of the nebulizer kit.
- Do not add more medication to the medication tank than the maximum capacity indicated under "Specifications."
- Do not run this product unattended.
- Do not operate the device at temperatures greater than 104°F (40°C).
- Do not tilt the nebulizer kit so the angle of the kit is greater than 45°. Medication may flow into the mouth.
- Do not shake the nebulizer kit while using the device.
- Do not subject the compressor, or any of the components, to strong shocks, such as dropping on the floor.
- Do not disassemble or attempt to repair the device or components.
- Use the device only for its intended use as described in this instruction manual. Do not use attachments not recommended by the manufacturer.
- Dispose of the device, components and optional accessories according to applicable local regulations. Unlawful disposal may cause environmental pollution.
- Make sure that the air tube is securely attached to the compressor (main unit) and nebulizing parts, and does not come loose. Twist the air tube slightly when inserting it into the connectors to avoid the tube disconnecting during use.
- Keep the device out of the reach of unsupervised infants and children. The device may contain small parts that can be swallowed.
- Rinse the nebulizer parts after each use. Let parts dry before using.
- Do not store the air tube with moisture or medication remaining in the air tube. This could result in infection as a result of bacteria.
- Store the device and the components in a clean, safe location.
- Do not carry or leave the nebulizer with medication in the medication tank.
- Do not place or attempt to dry the device, components or any of the nebulizer parts in a microwave oven.
- Do not wrap the power cord around the compressor (main unit).
- Do not service or perform maintenance on the device while it is in use with the patient.
- The device may contain small parts that can be swallowed.
- Do not carry or leave the nebulizer with medication in the medication tank.

RISK OF ELECTRICAL SHOCK

- Do not use the compressor (main unit) and the power cord while they are wet.
- Do not plug or unplug the power cord into the electrical outlet with wet hands.
- Do not immerse the compressor (main unit) in water or other liquid.
- Do not spill water or other liquids on the compressor. These parts are not waterproof. If liquid spills on these parts, please unplug the power cord and wipe off the liquid with gauze or other soft absorbent material immediately.
- Do not use or store the device in humid locations or outdoors. Use the device within the operating temperature and humidity.
- Do not overload power outlets. Plug the device into the appropriate voltage outlet.
- Do not use extension cords. Plug the power cord directly into the electrical outlet.
- Unplug the power cord from the electrical outlet after using the device. Never leave this product unattended when plugged in.
- Unplug the power cord from the electrical outlet before cleaning the device.

MAIN UNIT

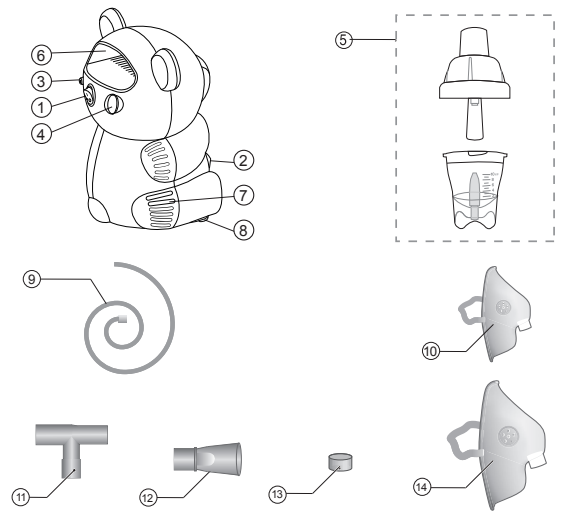

- | | |
|---------------------------|---------------------------|
| 1. Power Switch | 8. Rubber Foot |
| 2. Holder for Nebulizer | 9. Inhalation Tube |
| 3. Air Plug | 10. Mask (Infant) |
| 4. Air Filter Cover | 11. T-type Connector |
| 5. Reusable Nebulizer Kit | 12. Inhalation Mouthpiece |
| 6. Main Unit | 13. 5 Pcs. Air Filter |
| 7. Thermal Via (Vent) | 14. Mask (Pediatric) |

The nebulizer kit and mask, nasal-piece, mouthpiece are applied parts

PREPARING THE NEBULIZER FOR USE

CAUTION

To prevent the risk of cross-infection, different persons should never use the same nebulizer kit.

- Place the device on a stable, sturdy, and flat horizontal surface where you can easily reach the unit while you are seated.
Caution: place the device at least 4 inches (10 cm) distance from wall.
- Make sure that the unit is in the "Off" (O) position.
- Insert the power plug into the electrical outlet.
- Rotate the inhalation tube counterclockwise to remove the inhalation tube from the medication tank.
- Add the correct amount of prescribed medication to the medication tank.
- Turn the inhalation top clockwise until securely closed.
- Attach the desired inhalation accessory.

ATTACHING IN INHALATION TUBE

- Push the air plug on one end of the inhalation tube onto the air connector on the back side of the compressor.
- Push the air plug on the other end of the inhalation tube onto the inhalation tube connector on the bottom of the nebulizer kit.

USING THE DEVICE

- Switch on the power.
- Plug the inhalation tube into the air plug on device.
- Plug the other side of tube into the vent port of bottom of nebulizer kit.
- Plug the nebulizer kit into the holder on the device.
- Add the medicine into the nebulization tank.
- Press the I/O button to turn on device and begin treatment.
- Press the I/O button to safely terminate the operation of nebulizer.
- Unplug the power cord from the electrical outlet after using the device.

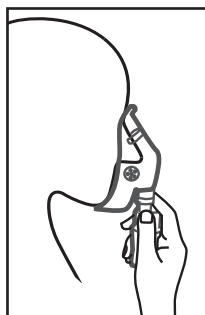

CAUTION

The patient and operator must keep a distance from the device of 20 cm to 50 cm (inches 8-20) in normal use.

USING THE MASK

Place the mask over the nose and mouth. Pull the elastic strap over the head. Gently pull on the strap to securely hold the mask over the nose and mouth. Inhale the medication. Exhale normally through the mask.

CLEANING

CLEANING

Following the cleaning instructions after each use will prevent any remaining medication in the bottle from drying, which can result in the device not nebulizing effectively.

Rinse the nebulizer parts after each use.

- Remove the inhalation accessory (mask, mouthpiece) from the nebulizer kit.
- Disconnect the inhalation tubing from the nebulizer.
- Gently twist the inhalation top counterclockwise and lift to separate the nebulizer into two sections.
- Remove the baffle.
- Discard remaining medication.
- Rinse all the applied parts (nebulizer kit, the mouthpiece and mask) in warm water.
- Air dry only.
- CLEANING THE DEVICE AND THE TUBE'S OUTER SURFACE
Only use a damp cloth.
- Assemble the nebulizer and store the nebulizer kit in a dry, sealed bag.

CAUTION: The nebulizer kit should be replaced every 6 months.

CARING FOR THE DEVICE

To keep your device in the best condition and protect the unit from damage, follow these directions:

CLEANING THE COMPRESSOR

Clean the casing of the main unit by using a soft cloth moistened with water or a mild detergent. Do not use abrasive cleaners. Dry the casing immediately using a soft clean cloth.

CHANGE THE AIR FILTER

Change the air filter every 60 days even if the air filter does not appear dirty. If the air filter appears dirty, or if water or medication has spilled on the air filter, replace with a new air filter immediately.

- Pull the air filter cover to remove from the front side of the compressor.
- Remove the dirty filter by hand.

CAUTION: Do not attempt to wash or clean the air filter. Damp air filters can cause blockages. Do not substitute cotton or any other material for the air filter.

CAUTION: Wash the air filter cover regularly to prevent any blockage in the cover. Do not boil. Make sure the cover is dry before inserting the new air filter.

- Insert a new air filter into the air filter cover.

CAUTION: Before inserting the new air filter, make sure the air filter is clean and free of dust. Do not operate the device without the air filter.

- Put the air filter cover back on the compressor.
- Do not maintain or service the device while it is in use.

TROUBLESHOOTING GUIDE

PROBLEM	CAUSE	SOLUTION
No power on unit when the power switch is on.	The AC power cord is not plugged into an electrical outlet.	Turn the power switch off. Plug the power plug into an electrical outlet. Turn the device on.
No nebulization or low nebulization rate when the power is on.	No medication in the medication tank. Too much or too little medication in the medication tank.	Add the correct amount of prescribed medication to the medication tank.
	The nebulizer kit is not correctly assembled.	Make sure the nebulizer kit is correctly assembled and the inhalation accessory is correctly attached.
	The nebulizer kit is tilted at an incorrect angle.	Hold the nebulizer kit correctly. Do not tilt the nebulizer kit so the angle of the kit is greater than 45 degrees.
	The air tube is incorrectly attached.	Make sure the air tube is correctly attached to the compressor and the nebulizer kit.
The device is very hot.	The air tube is folded or damaged. The air tube is blocked.	Make sure the air tube is not folded, kinked or bent. Inspect the air tube for any damage. Replace the air tube if damaged.
	The compressor is covered. The device has been used for longer than 50 minutes.	Do not cover the compressor with any type of cover during use. Turn the device off. Wait 50 minutes before using the device again.

SPECIFICATIONS

Input	AC 120 V, 60 HZ
Extreme Pressure	>205 kpa
Power Consumption	≤200 VA
Medication Capacity	10 mL
Particle Size	≤5 μm & 60%
MMAD	2.0 μm
Average Nebulization Rate	≥0.2 mL/min
Noise Level	≤ 60 dB
Compressor Pressure Range	30-58 psi
Operation Pressure Range	7-10 psi
Liter Flow Range	6-10 lpm
Operation mode	50 minutes on, 50 minutes off
Operation Temperature Range	50°F to 104°F (10°C to 40°C)
Operation Humidity Range	30 to 75% RH
Storage Temperature Range	14°F to 149°F (-10°C to 65°C)
Storage Humidity Range	10 to 95% RH
Accessories	1 Infant Mask, 1 Pediatric Mask, 1 Reusable Nebulizer Cup, 1 Mouthpiece, 1 T-Piece, 1 7' (2.1 m) Tube, 5 Filters
Dimensions	8.3" × 6.5" × 5.5"

CLASSIFICATION

Equipment Classification with respect to protection from electric shock: CLASS II

Degree of protection from electric shock: TYPE BF

Degree of protection against ingress of water is rated as IPX0.

Equipment not suitable for use in the presence of flammable anesthetic mixture with air, oxygen or nitrous oxide.

Intermittent operation: 50 minutes ON, 50 minutes OFF.

WARRANTY

LIMITED WARRANTY

Your Dynarex Product is warranted to be free of defects in materials and workmanship for three (3) years for the original purchaser. This item was built to exacting standards and carefully inspected prior to shipment. This Limited Lifetime Warranty is an expression of our confidence in the materials and workmanship of our products and our assurance to the consumer of years of dependable service.

The Warranty shall not apply under the following conditions:

- Problems arising from normal wear
- Problems arising from failure to adhere to the product instructions
- Problems arising from misuse, negligence, accident or improper operation, maintenance or storage
- Problems arising from modifications or unauthorized repairs, parts or attachments
- Products where the serial number has been removed or defaced
- Problems with non-durable components, such as rubber accessories, casters, and grips, which are subject to normal wear and need periodic replacement

Dynarex shall not be liable for any consequential or incidental damages whatsoever. Dynarex shall repair or replace defective products at its option. The foregoing warranty is exclusive and in lieu of other express warranties, if any, including the implied warranties of merchantability and fitness of a particular purpose. The remedy for any violation of the implied warranty shall be limited to repair or replacement of the defective product pursuant to the terms contained herein.

If you have a question about your Dynarex device or this warranty, please contact an authorized Dynarex dealer.

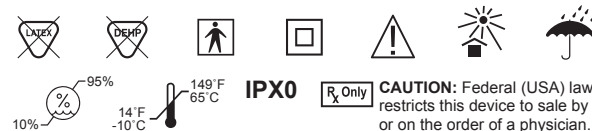

Manufactured for:
Dynarex Corporation
10 Glenshaw Street
Orangeburg, NY 10962
USA • www.dynarex.com

Made in China
R210430

