



ITEM: TL-ST823WH

ANZZI JUNO
SMART TOILET & BIDET

INSTALLATION &
OPERATION MANUAL

V1.0

08/30/2025

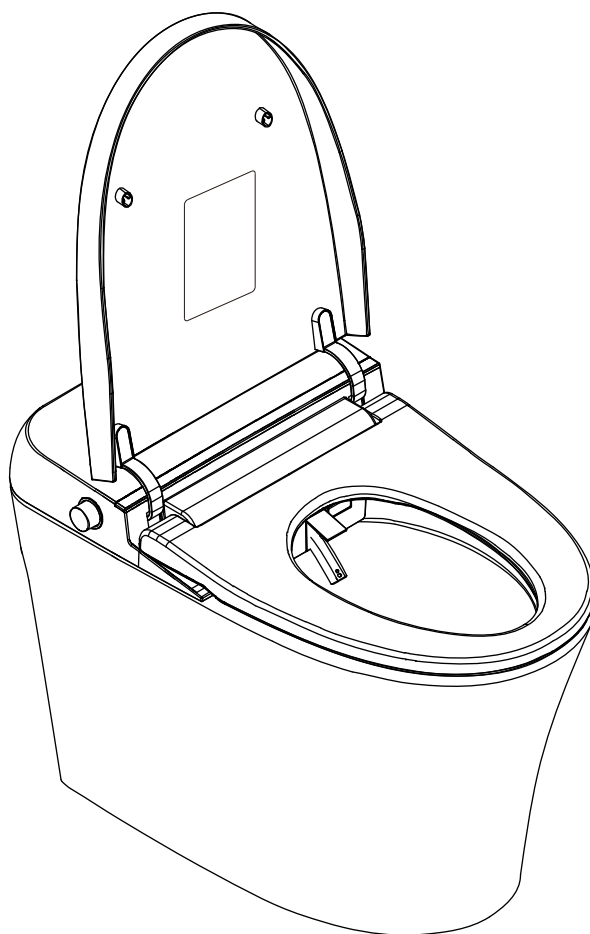

DON'T WAIT! REGISTER NOW!

Register your product within 90 days to ensure it is recognized as a purchase and covered under warranty.

Register online at <https://anzzi.com/pages/register> or scan the QR code on PG. 2.



PRODUCT REGISTRATION*

IMPORTANT: Warranty will not be recognized unless product is registered.

Register online at <https://anzzi.com/pages/register> or Scan the QR code below.
Registering your product maximizes your warranty benefits and ensures prompt service and support.

1

USE YOUR PHONE CAMERA
TO SCAN THE QR CODE

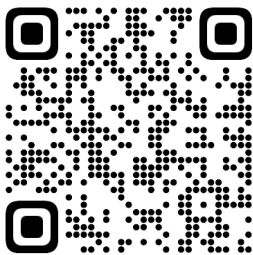

2

FILL IN A QUICK
REGISTRATION FORM

A smartphone mockup displaying a registration form. The screen shows a "Thank you for your purchase!" message, followed by a paragraph about warranty benefits. Below this is a list of input fields: Name*, Email*, City*, Order #*, Installer Name, a vertical ellipsis, Model Purchased*, Installer Phone Number, and Customer Age Range. A blue "Submit" button is at the bottom of the form.

Thank you for your purchase!

Registering your products ensures you maximize your warranty benefits and receive prompt service and support.

Name*

Email*

City*

Order #*

Installer Name

⋮

Model Purchased*

Installer Phone Number

Customer Age Range

Submit

3

CLICK SUBMIT AND
ENJOY PEACE OF MIND

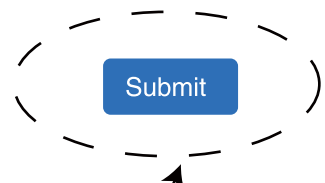

Need help? For technical support call **305-614-4070** or visit us at www.ANZZI.com

PRODUCT SIZE CHART

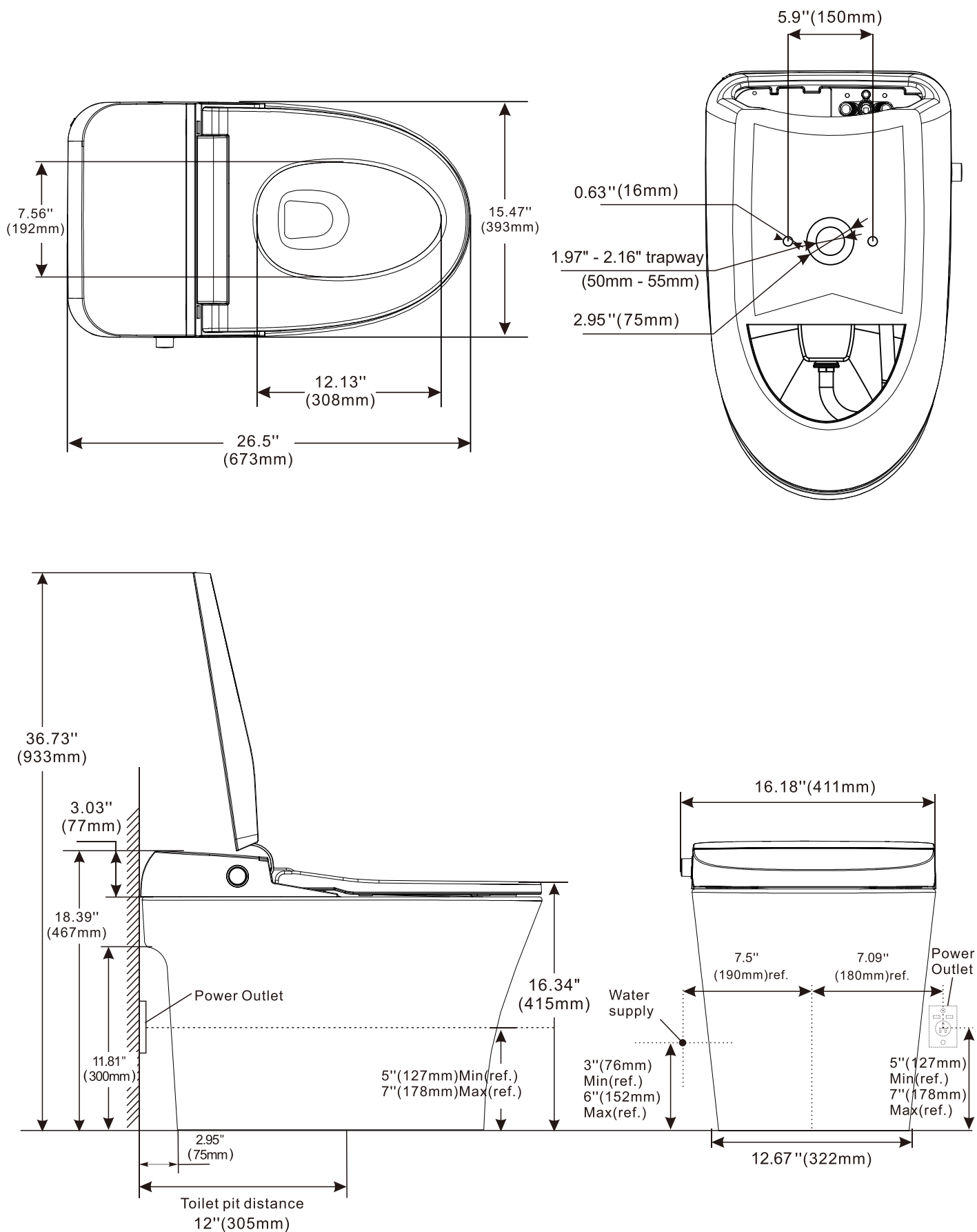

Thank you for choosing ENVO SMART TOILET. Please read and understand this entire manual before attempting to install, assemble or operate this product.

TABLE OF CONTENTS

SAFETY PRECAUTIONS	PG.1
TOILET COMPONENTS	PG.3
TOOLS AND MATERIALS	PG.3
TOILET INSTALLATION	PG.4
STEP1 INSTALL THE SUPPLY STOP AND CONFIRM THE WATER FLOW RATE ----	PG.4
STEP2 INSTALL THE TOILET	PG.5
STEP3 CONNECT THE WATER INLET PIPE	PG.6
STEP4 INSTALL THE RETAINING SEAT	PG.7
STEP5 BATTERY INSTALLATION OF REMOTE CONTROL	PG.7
GUIDELINES FOR FIRST USE	PG.8
REMOTE CONTROL MATCHING	PG.9
OPERATION INSTRUCTIONS OF CONTROL DIAL	PG.9
REMOTE CONTROL KEY DESCRIPTION	PG.10
FOOT SENSORY FLUSHING FUNCTION	PG.12
BEEPING DESCRIPTION	PG.12
CLEANING & MAINTENANCE	PG.12
CLEANING OF TOILET BOWL	PG.12
NOZZLE CLEANING AND MAINTENANCE	PG.12
CLEAN THE FILTER SCREEN	PG.13
LONG-TERM PRESERVATION	PG.14
PRODUCT SPECIFICATIONS	PG.14
TROUBLE SHOOTING	PG.15

SAFETY PRECAUTIONS

Please carefully read the safety precautions before installation. This is important and must be observed.

DANGER

Only connect to a Ground-Fault Circuit-Interrupter(GFCI) protected grounded socket.

Do not remove the ground pin or use a ground adapter.

Otherwise, electric shock will be caused by fault or short circuit.

WARNING

-
- Any modification to your ENVO Smart Toilet will lead to warranty failure. If cables, plugs or other components need to be repaired or replaced, they need to be handled by qualified electricians.
-
- Any replacement shall be provided by ANZZI. The use of a third-party replacement will invalidate the warranty.
-
- Cut off the power supply before maintenance.
-
- Ensure that the bathroom is well ventilated to avoid moisture accumulation. Installing the smart toilet in a humid place may cause electrical failure of the product.
-
- In any case, the socket shall be installed at a position greater than 19-11/16"(500mm) from the bathtub.
-
- Do not touch the power socket with wet hands, **Otherwise it may cause electric shock.**
-
- Do not pour water, hot water or detergent onto the top of the toilet, power supply or plug.
-
- Make sure the toilet is away from flames or combustibles.
-
- Do not put your fingers or anything at the outlet of the heater, **Otherwise it may cause burns or electric shock.**
-
- Do not excessively pull or bend the cable. If there is any damage to the cable or plug, cut off the power supply. Use the cable provided by ANZZI for replacement.
-
- Do not bend or squeeze the water inlet hose hard, **Otherwise it may lead to water leakage or reduce the water inlet pressure.**
-
- When power failure occurs during flushing and the nozzle is not reset, do not push it back by hand. The nozzle will reset itself after the power supply is restored.
-
- If your ENVO Smart Toilet has the following problems, please stop using it. Turn off power supply and supply stop.
 - Pipe, hose or product leaks.
 - Product breakage.
 - The product has abnormal sound or peculiar smell.
 - Smoke from the product.
-

SAFETY PRECAUTIONS



ATTENTION

- If you do not fully understand the grounding instructions or are not sure whether the product has been correctly grounded, please find a qualified electrician or sales and service personnel to check and confirm. Please find a qualified electrician to confirm that the power supply provides the matching voltage and power required by the product.
- Review all local plumbing and building codes related to products.
- Ensure that the water pressure of the water supply is 20PSI(138kPa)-80PSI(552kPa).
- The water supply pipe must be at least 1/2" copper pipe to provide the minimum flow required for the normal operation of the product.
- Carefully check the new toilet for damage.
- Use the water inlet hose and supply stop attached to the product. The old installed hose and supply stop do not match this product.
- If the new toilet is not installed at once, please make sure the toilet sewage outlet on the floor is blocked.
- Do not stand on the toilet seat, toilet lid, toilet ceramic body, or place any heavy objects on your ENVO Smart Toilet.
Otherwise, it may be damaged and cause personal injury or soak the floor.
- Don't expose the toilet to the sun. The product may turn yellow or fade.
- Do not throw anything other than toilet paper into the toilet, otherwise it will cause blockage or flooding.
- Don't lean against the toilet lid.
- When children, the old or disabled people use this toilet, they need to pay close attention. Adjust the appropriate toilet seat temperature for the people mentioned above, as well as the people having allergic skin.
- Do not use this toilet when you are sleepy.
- The toilet requires fresh water only.
- Clean this product with a clean soft cloth. Do not use any irritating detergent to clean this product.
- Any replacement of parts must only be performed by qualified service personnel.

Statement: ENVO does not assume any responsibility for the losses caused by the improper installation and behavior listed above or other improper operations.

TOILET COMPONENTS

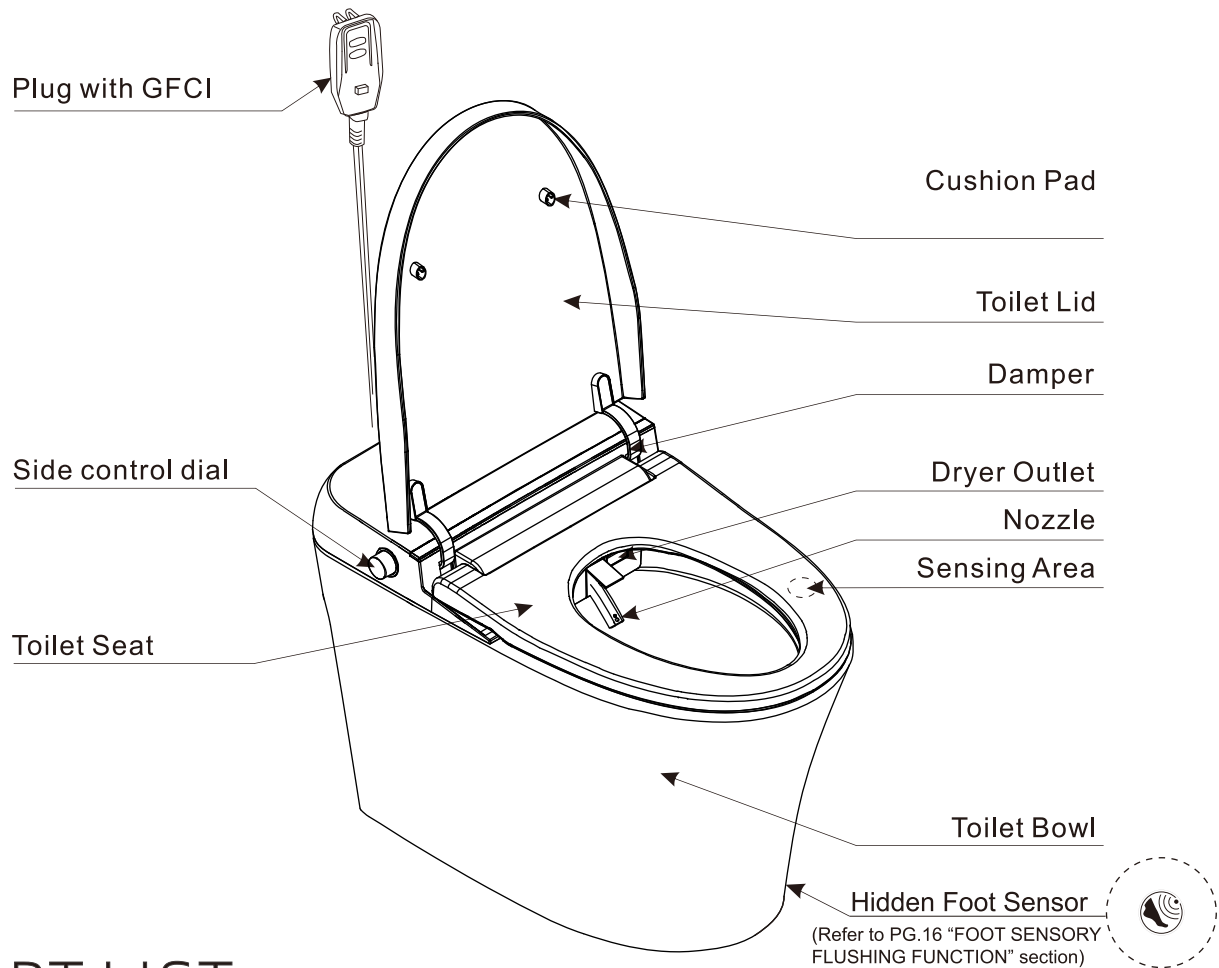

PART LIST



Remote Control Set (1 pc)

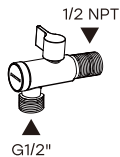

Angle Valve (1 pc)



Adapter (1 pc)



Wax Ring (1 pc)

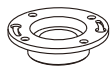

Floor Flange (1 pc)



Spanner

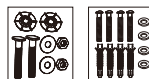

Accessory Pack (2 pcs)

INSTALLATION TOOL

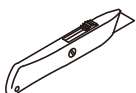

Utility Knife

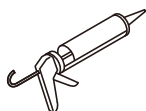

Caulk Gun & Caulk



Sealant Tape



Marker Pen



Wrench



Screwdriver



Tape Measure



Measuring cup

TOILET INSTALLATION

STEP 1 | INSTALL THE SUPPLY STOP AND CONFIRM THE WATER FLOW RATE

SUPPLY STOP INSTALLATION

1. Turn on the old supply stop and flush for 1 minute to remove any debris that could damage the toilet.
2. Turn off the supply stop and remove it.
3. Wrap sealing tape around the 1/2" NPT male thread of the water supply pipe (not included), then screw the adapter onto the pipe to ensure a good seal.
4. Use Teflon tape to wrap from the end of the fitting toward the base to prevent thread seizing. Tighten the joint 1–2 turns beyond finger-tight. Do not overtighten.

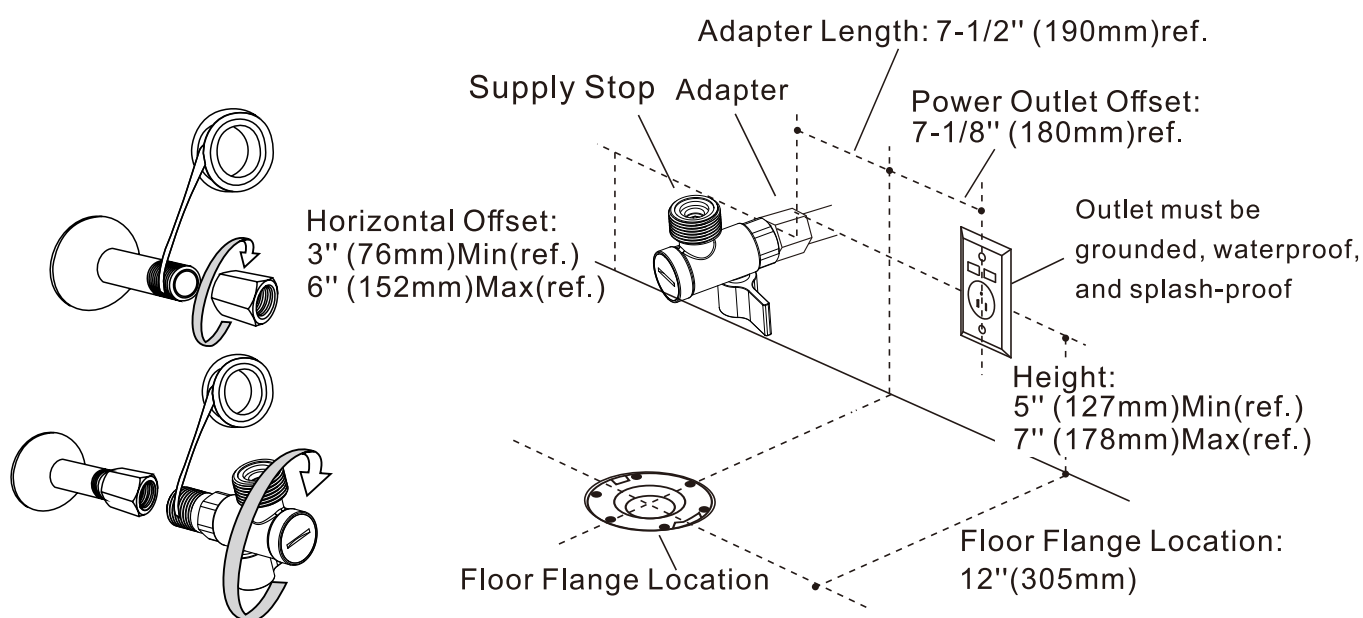

CONFIRM WATER FLOW

5. Install a hose and guide it to a 3-gallon (11.4 L) bucket or larger. If a hose is unavailable, place a cloth over the valve outlet and position a bucket underneath.
6. Turn on the supply stop and confirm that at least 1 gallon flows within 10 seconds.
7. If water pressure is too low, use a booster pump or contact service for further assistance.
8. Turn off the supply stop.
9. Remove the hose.

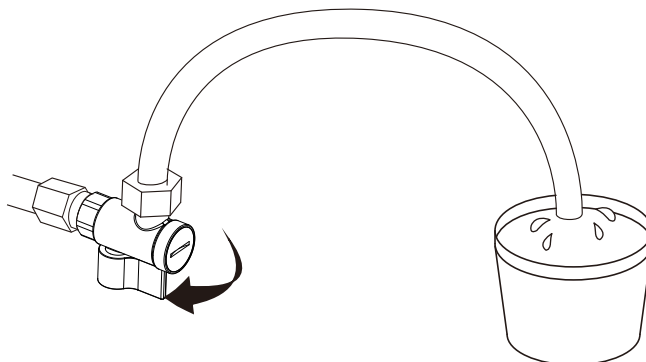

STEP 2 | INSTALL THE TOILET

Note: If the distance between the sewage outlet and the wall surface is less than 12" (305mm), the toilet lid may touch the wall surface when opened.

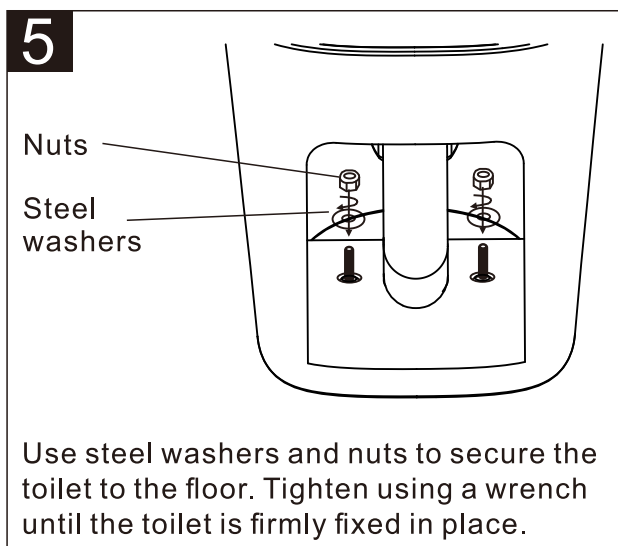
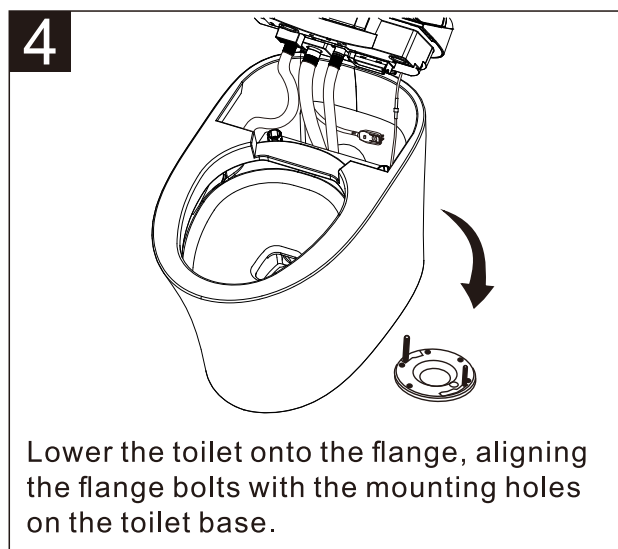
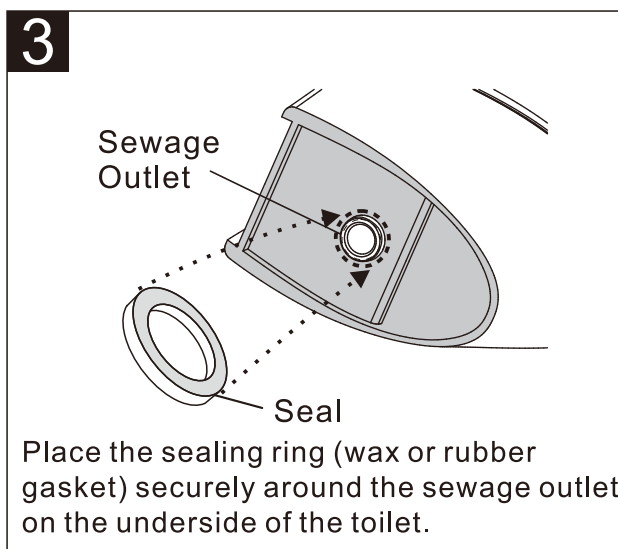
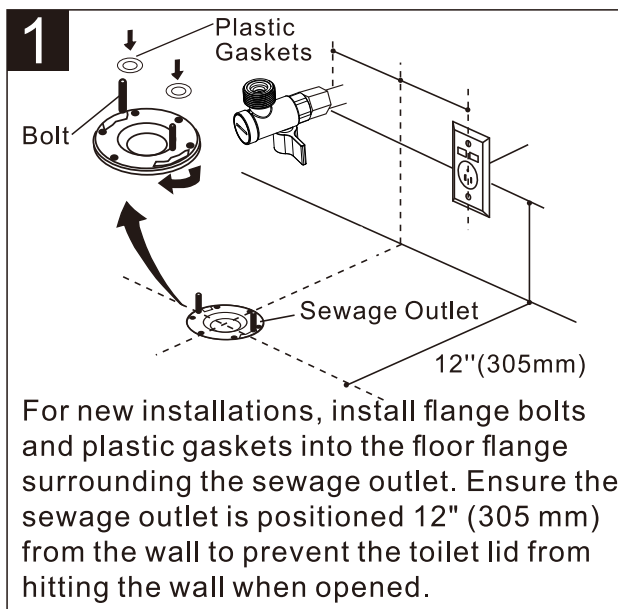

STEP 2

INSTALL THE TOILET

6

Battery Case
at the bottom of
SEAT-LID

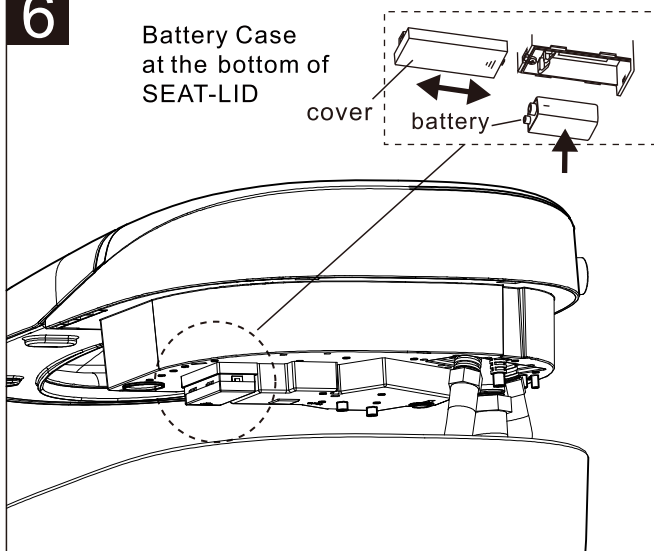

Carefully remove the battery cover from the underside of the toilet seat-lid.

Connect a 9V alkaline battery (not included), insert it into the battery compartment, and replace the cover.

Press the control dial on the side of the toilet to confirm flushing operation.

Note: This battery serves as a backup to maintain flushing functionality during power outages. Dispose of used batteries at a local recycling center—do not throw them in regular trash.

7

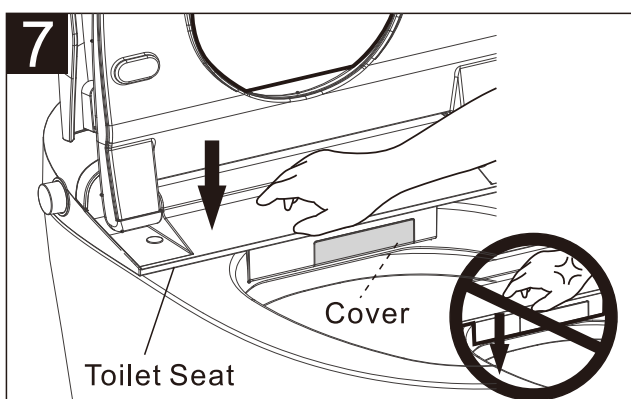

Reinstall the seat-lid assembly onto the toilet. Align the hinges and gently press down to secure.

Note: Do not use excessive force when reinstalling the seat-lid assembly.

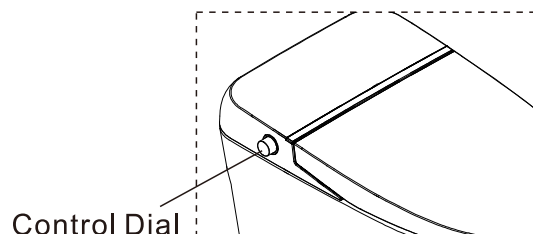

STEP 3

CONNECT THE WATER INLET PIPE

1. Connect the inlet hose to the supply stop and hand-tighten the nut.

Then, use a wrench to turn the nut an additional 1/4 turn to ensure a firm seal.

2. Open the supply stop to allow water to flow into the toilet.

3. Check for leaks around the connection points.

4. Apply a bead of silica gel (caulk) around the base of the toilet where it meets the floor. Allow 24 hours for the sealant to fully dry before use.

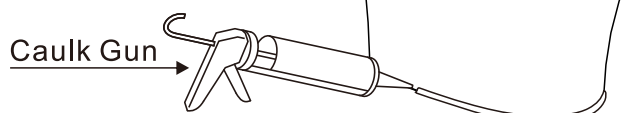
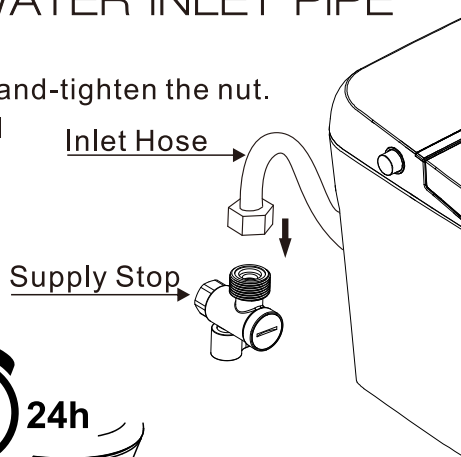

STEP 4 | INSTALL THE RETAINING SEAT

- The following picture shows the installation method.

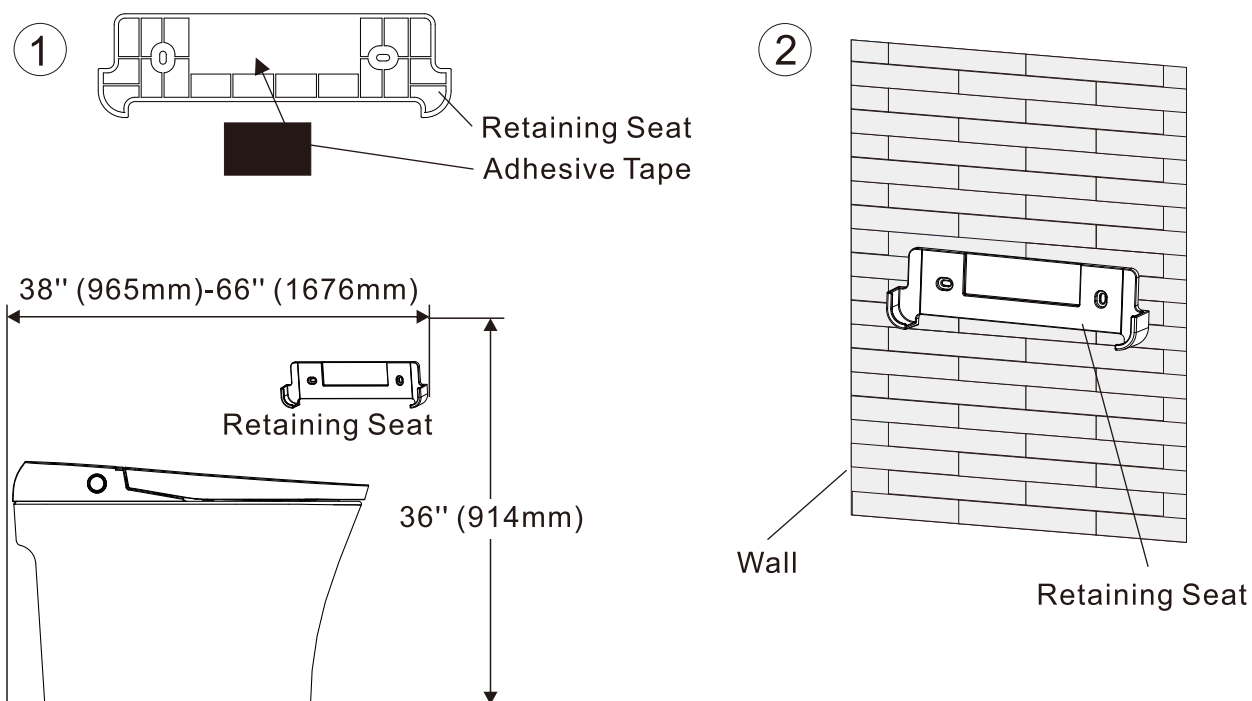

Select a smooth and flat area on the wall, 36" (914mm) above the floor and between 38" (965mm) to 66" (1676mm) from the back of the toilet. Tear off one side of the double-sided adhesive tape and apply it to the back of the remote control retaining seat. Peel off the remaining backing and firmly press the retaining seat onto the wall.

Note: Ensure the surface is clean before installation. Apply firm pressure evenly and allow the adhesive to set for at least 15 minutes before use.

STEP 5 | BATTERY INSTALLATION OF REMOTE CONTROL

Install two new AAA batteries (not included) into the remote control. Locate the battery compartment on the back of the remote and press down on the cover to open. Insert the batteries and close the cover securely.

Note:

- Clean the battery contacts and compartment before installation.
- Remove batteries if the product will not be used for an extended period.
- Do not mix old and new batteries.
- Do not combine alkaline, standard (carbon zinc), or rechargeable (nickel cadmium, nickel manganese) batteries.
- Dispose of used batteries properly at a battery collection center.

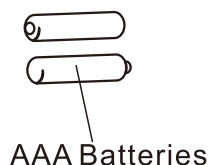
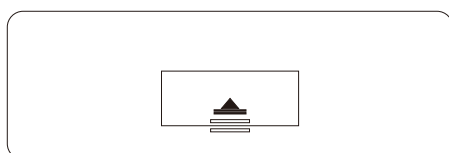

AAA Batteries

GUIDELINES FOR FIRST USE

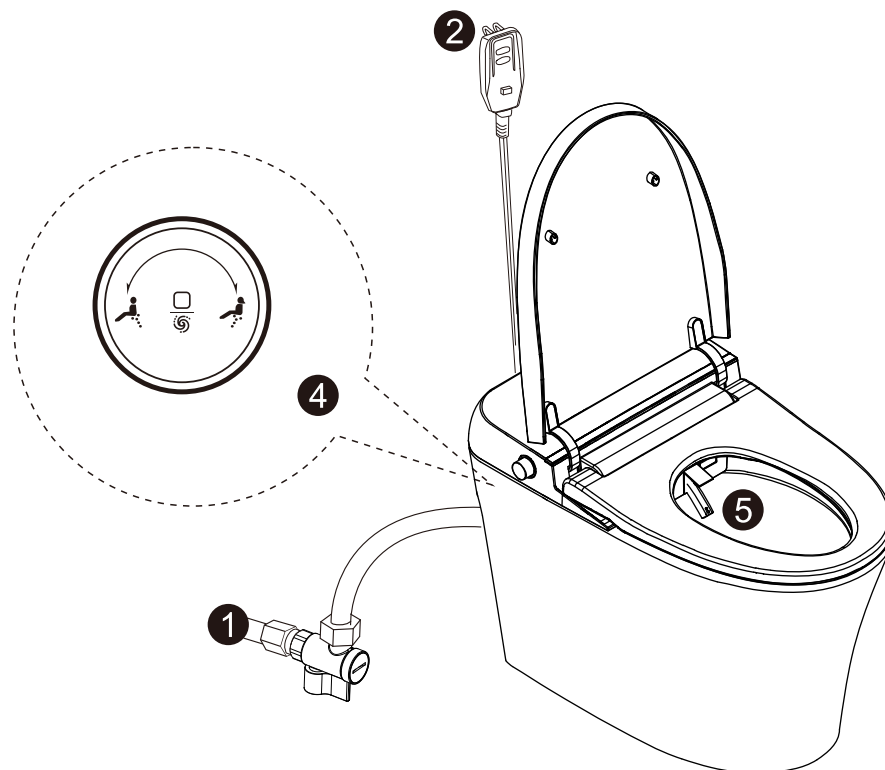

- ❶ Open the supply stop and check for any leaks.
- ❷ Ensure the plug is securely inserted into the socket and the indicator light is on.
 - Press the TEST button: the indicator light should turn off.
 - Press the RESET button: the indicator light should turn on.
 - Do not use the toilet if the TEST & RESET process fails.
- ❸ When powered on, the nozzle will extend and retract automatically. Water will flow briefly to flush the nozzle, and the night light will flash. An initialization beep will sound, completing the startup sequence in approximately 25 seconds.
- ❹ If the toilet does not respond after powering on, press the control dial on the side of the unit to activate the system.
- ❺ Once seated, a small stream of water will be released to pre-wet the inner surface of the ceramic bowl.
- ❻ This smart toilet is equipped with a dual-flush function:
 - Full-flush is recommended for solid waste.
 - Reduced-flush is intended for liquid waste.
 - Full-flush can be activated via the remote control or control dial.
 - Reduced-flush can be activated by the control dial or foot sensor.(For details, see pages 9, 10, and 11.)



Important:
The toilet's automatic features
will only function while someone
is seated.

REMOTE CONTROL MATCHING

If you have multiple ENVO Smart Toilets in the same home, mutual interference may occur. Follow these steps to pair each remote correctly:

1. Unplug the toilet's power cord.
2. On the remote control, press “” and “” hold both the flush and stop buttons simultaneously until the indicator light starts blinking continuously.
3. Plug the smart toilet back in within 5 seconds.
4. Once the indicator light on the remote stops blinking, the matching process is complete.

Note: Matching mode is only active for 10 seconds. If not completed within this time, the process will time out.

OPERATION INSTRUCTIONS OF CONTROL DIAL

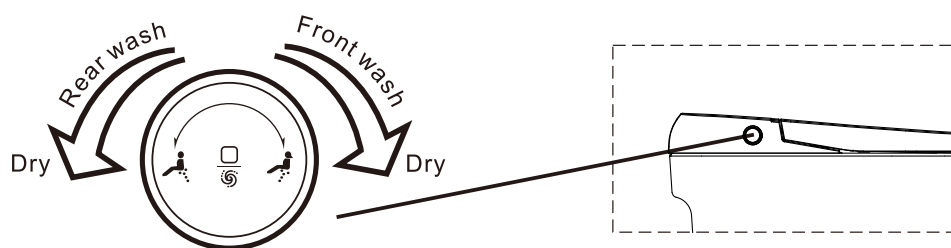

1. Once power is connected, the toilet will initialize. Wait until the control dial light stops flashing before use.
2. Auto-cleaning will not function unless someone is seated on the toilet.
3. To set warm air temperature, press the drying button on the remote control, then press the increase or decrease button. To set water temperature, press the water temperature button while turning the control dial.
4. While seated, turn the control dial forward to start front wash. Rinsing lasts for 1 minute (control dial light = pink), followed by 2 minutes of warm air drying (control dial light = red). Turning the dial forward again during rinsing will stop the wash and start drying.
5. While seated, turn the control dial backward to start rear wash. Rinsing lasts for 1 minute (control dial light = blue), followed by 2 minutes of warm air drying (control dial light = red). Turning the dial backward again during rinsing will stop the wash and start drying.
6. Turning the control dial during washing or drying will stop the current action and place the toilet in standby mode (control dial light = light pink).
7. In standby mode, pressing the control dial once will activate a full flush (control dial light = red).
8. Pressing the control dial twice in quick succession will activate a reduced flush.
9. Press and hold the control dial for 3 seconds to power off the toilet.

REMOTE CONTROL KEY DESCRIPTION

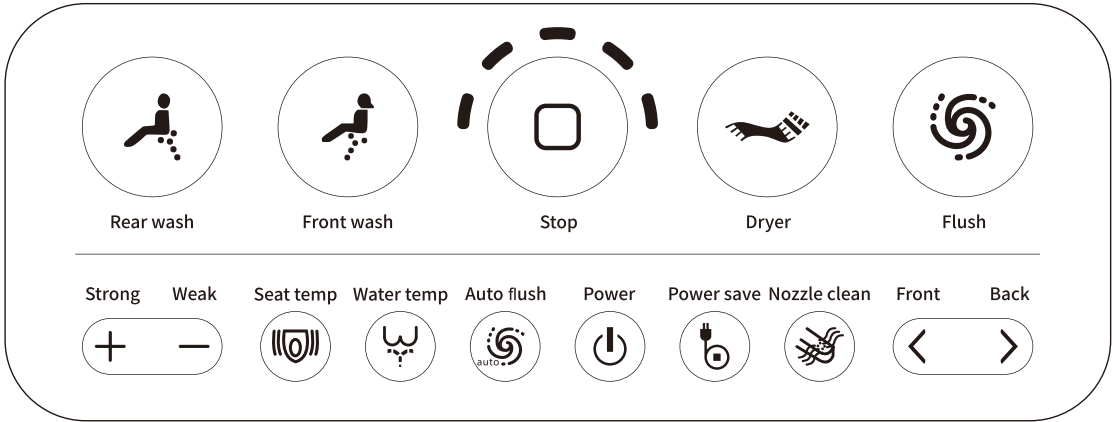

- Only functions when seated. Press to extend the nozzle and rinse the rear area.
- Press again to start swinging clean mode.
 - Press a third time to switch back to standard rear wash.
 - Rinsing automatically stops after 2 minutes.



- Only functions when seated. Press to extend the nozzle and rinse the front area.
- Press again to begin swinging clean mode.
 - Press a third time to return to front wash.
 - Rinsing automatically stops after 2 minutes.



- Only functions when seated. Press to begin warm air drying.
- Press again to move the air outlet back and forth for enhanced drying performance.
 - Drying automatically stops after 4 minutes.



Press once to flush the toilet.



Press at any time to immediately stop washing or drying before the auto-stop.



- Press to adjust cleaning pressure during wash or temperature during drying.
- 4 levels of pressure or temperature are available.



- Press during rinse or dry to adjust nozzle position (5 levels available).
- Note:** Nozzle position cannot be adjusted during swing cleaning or drying.



Water temp

Press to select water temperature for cleaning.

- 4 settings: Off (room temperature) / Low / Medium / High.



Seat temp

Press to select temperature for seat heating.

- 4 settings: Off (room temperature) / Low / Medium / High.



Nozzle
clean

Activates when the user leaves the seat.

- Press to extend the nozzle for automatic self-cleaning.
- You may manually clean the nozzle with a brush.
- Press "Stop" to retract the nozzle.

Note: Nozzle also auto-cleans before front or rear wash cycles.



Power save

Press to activate power-saving mode (auto-activates after 1.5 minutes of no use).

- Press and hold for 3 seconds to shut off the toilet.
- In power save, seat temperature is maintained at 77°F (25°C).
- All settings are saved automatically.
- Power saving indicator on the remote will light up.



Power

Press once to shut down the toilet.

- Press and hold for 3 seconds to turn the control light on/off.



Auto flush

Press to enable or disable automatic flushing.

- When enabled, the toilet will auto-flush once after the user leaves the seat for 5 seconds.

Note: If the toilet is manually flushed using the control dial or this button, it will not auto-flush again after the user gets up.

FOOT SENSORY FLUSHING

To activate flushing, wave your foot across the sensor located at the base of the toilet.

This feature does not operate while someone is seated.

When activated, the toilet will flush in reduced mode.

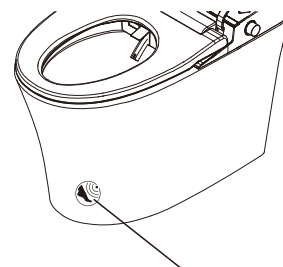

Foot sensor inside ceramic base

BEEP SOUNDS

1 beep: User is seated, all functions available.

2 beeps: User is not seated, limited functions available.

3 or more beeps: Indicates product fault.

To disable the beep sound:

Ensure no one is seated.

Rotate the control dial backward and hold for 3 seconds.

Control dial

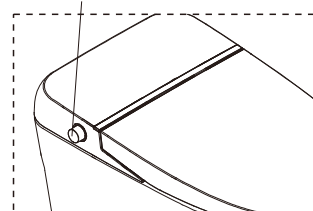

CLEANING & MAINTENANCE

TOILET CLEANING

Unplug the toilet.

Wipe the outer surface with a damp cloth.

Note: Clean dirt promptly to avoid buildup.

NOZZLE CLEANING

Press the "Nozzle Cleaning" button to extend and flush the nozzle.

Use a soft brush to clean as needed.

Note: Do not use steel brushes.

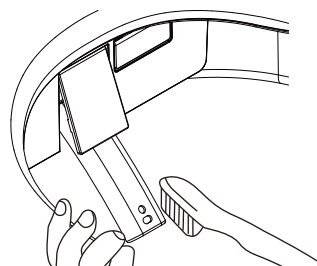

CLEAN THE FILTER SCREEN

If water pressure is too low to operate the toilet properly, clean the filter screen.

STEP 1 | CLOSE THE SUPPLY STOP

Turn off the supply stop.

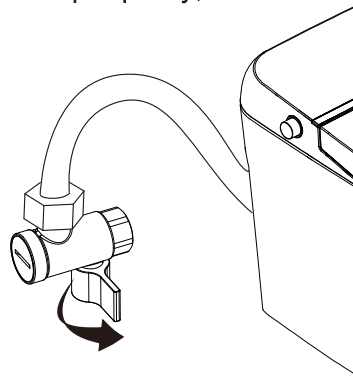
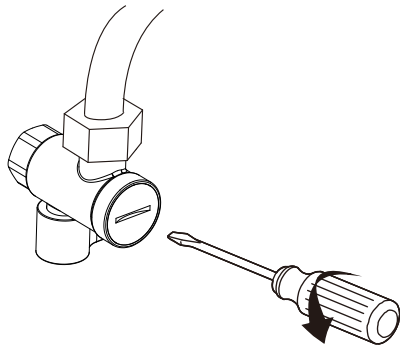

STEP 2 | REMOVE THE FILTER SCREEN

Unscrew the screen cover using a screwdriver and remove the filter screen.

STEP 3 | CLEAN THE FILTER SCREEN

Rinse the screen thoroughly using clean water only.

Note: Do not use detergent. Do not squeeze or deform the screen during cleaning.

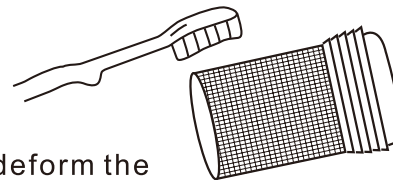

STEP 4 | REINSTALL THE FILTER SCREEN AND OPEN THE SUPPLY STOP

Reinstall the filter screen in the same order it was removed. Turn on the supply stop and check for leaks.

Note: Ensure all components are secure and leak-free.



WARNING

- Do not use any cleaning product that contains chlorine (calcium hypochlorite).
- Always unplug the toilet before cleaning.



IMPORTANT

- Test any cleaning solution on a hidden area before use.
- Rinse and dry immediately after using detergent.
- Do not soak surfaces with cleaner.
- Use a soft, wet cloth or sponge. Avoid brushes, scouring pads, or abrasive tools.

To toggle the buzzer sound: ensure the seat is unoccupied, rotate the knob back, and hold for 3 seconds.

LONG-TERM PRESERVATION

If the toilet will not be used for an extended period, such as during travel or business trips:

1. Turn off the water supply stop. Press the control dial to drain any remaining water from the cavity.
2. Unplug the toilet and remove the backup battery.

PRODUCT SPECIFICATIONS

Ambient temp range		39.2°F-104°F(4°C-40°C)
Inlet water temp range		41°F-95°F(5°C-35°C)
Rated voltage		AC120V 50-60Hz
Rated power		1200W(Inlet water temp:59°F±32.9°F(15°C±0.5°C))
Power cord length		33.4"(0.85m)
Cleansing device	Water pressure range	20PSI(138kPa)(dynamic)-80PSI(552kPa)(static)
	Water pressure adjustment	Adjustable in 4 pressures
	Water temp adjustment	4 levels
	Safety device	Temp sensor control system、Dry burning-resistant protection device、over temp protection system、water and electricity isolation system
	Rear wash	Adjustable pressure
	Front wash	Adjustable pressure
	Strong wash	1 pressure
Seat heating device	Seat temp control	4 Levels
	Seat protective system	Temperature sensing control system/ fuse
Warm air dryer	Warm air temperature	4 Levels
	Safety device	Temperature reset switch/fuse
Remote control		YES
Nozzle Cleaning		YES



**THE TOILET'S FEATURES WILL NOT
WORK UNLESS YOU'RE SITTING
ON THE SEAT!**

TROUBLE SHOOTING

SYMPTOMS	POSSIBLE CAUSES	RECOMMENDED ACTIONS
No power	Plug and socket are not fully connected	Plug in the power cord securely
	GFCI of plug or socket is triggered	Reset the GFCI
No water flows out during flushing or small water flow	Low water supply pressure	Use a water pump to increase pressure
	Inlet filter screen is blocked	Clean the filter screen (See PG.13)
	Inlet hose is kinked	Adjust or reposition the hose
	Water supply is cut off	Wait until water supply is restored
	Supply stop is closed	Open the supply stop
Outlet water from nozzle is abnormal	Product is malfunctioning	Unplug for 1 minute and reconnect
Seat isn't warm	Incorrect seat temperature or power-saving mode	Adjust to desired temperature
Nozzle dripping	Solenoid valve failure	Contact a professional for service
Cleaning function not working	Solenoid valve failure	Contact a professional for service
Drying air is not warm	Drying temperature is off	Adjust using the remote control
	Drying heater is damaged	Contact a professional for service
Loose seat or cover plate	Loose screws	Tighten all screws
No response from remote control	Remote batteries are drained	Replace batteries following the instructions
	Remote control is not matched	Re-pair the remote. If issue persists, contact ENVO for support
Water leakage	Loose joints or broken components	Inspect and secure all connections
Toilet doesn't flush properly	Faulty flushing valve	Contact a professional for repair
Toilet won't flush clean	Low water pressure or blockage	Check water pressure and clear any blockages (See PG.4)

ENVO 
by ANZZI