

# Pop-up Drain

## INSTALLATION INSTRUCTIONS

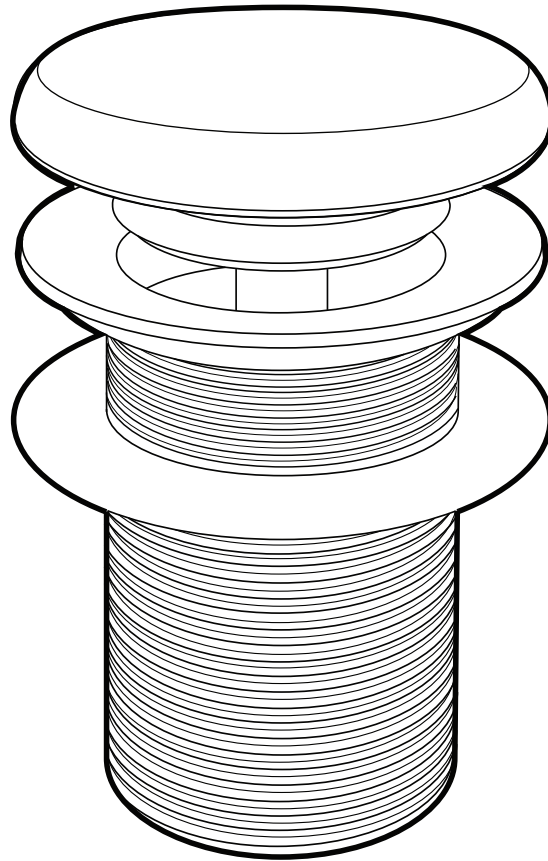



## PRIOR TO INSTALLATION:

- Inspect product to ensure no damages have occurred while in shipping.
- The step-by-step guidelines in the installation instructions are a general reference. Should there be any discrepancies, Swiss Madison cannot be held liable. It is recommended to install all Swiss Madison products by hiring a licensed professional.
- Read installation and maintenance instructions thoroughly before installing. Be sure to use proper tools and always wear proper personal safety accessories for your protection.

## QUESTIONS OR CONCERNS?

Please contact us:

1-434-623-4766

[info@swissmadison.com](mailto:info@swissmadison.com)

## INCLUDED PARTS:

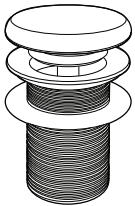

Pop-up Drain

## SUGGESTED TOOLS:



Safety Glasses



Hacksaw

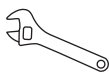

Wrench

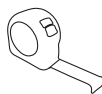

Tape  
Measure

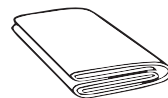

Drop Cloth

**INSTALLATION:**

1. Stopper
2. Drain Body
3. Rubber Gasket
4. Rubber Gasket
5. Washer
6. Locknut
7. Tailpiece

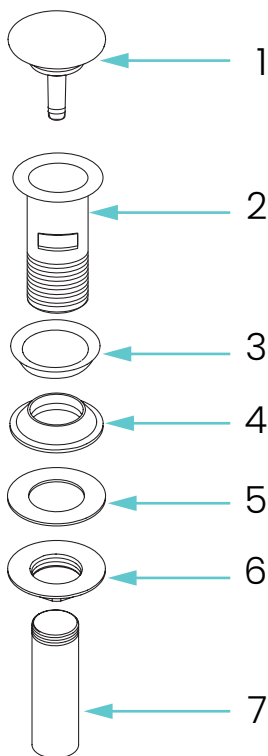
**1 Preparing for instalation**

- Remove the locknut, washer and rubber gasket, from the drain body.

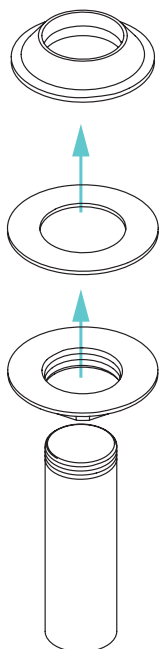
**2 Install pop-up drain**

- Insert the drain assembly (1) (2) (3) (7) downwardly through the drain opening on the bottom of sink.
- The tailpiece (7) and the outer threads of drain body (2) can go all the way through the drain opening and expose beneath the sink.

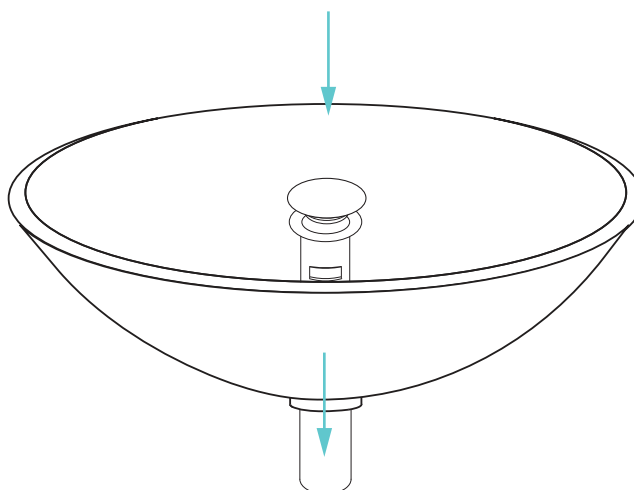

### 3 Adjustment

- Adjust rubber gasket (3) to fit in the drain opening snugly.

**NOTE:** Make sure the taper-surface side of the rubber gasket (3) is downward.

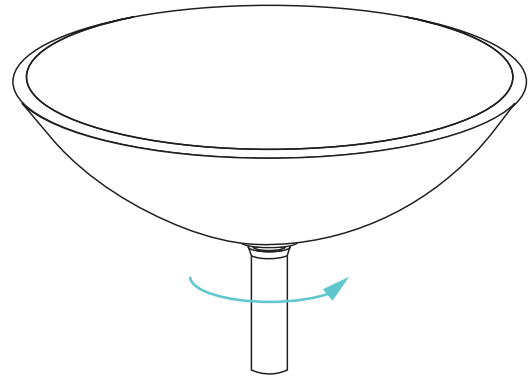

### 4 Securing drain

- Install rubber gasket (4), washer (5) and locknut (6) upwardly onto the drain body (2) from the end of tailpiece (7).

**NOTE:** Make sure the taper-surface side of the rubber gasket (4) is upward.

- Slowly tighten up the locknut (6) with a wrench until the rubber gasket (4) can completely and tightly seal the drain opening beneath the sink.
- Remove tailpiece (7) from drain body (2), apply Teflon tape on the thread of tailpiece (7). Then re-connect it with drain body (2).
- Push the stopper (1) to the close position of the drain body (2), then turn on faucet to full fill water in the sink. Examine and make sure no water come out from the tailpiece (7).
- Push the stopper (1) to the open position to drain water, examine to make sure no water leakage around the rubber gasket (4) or connection with tailpiece (7). If leakage found, adjust the rubber gasket (4) and re-tighten up the locknut (6) or re-connect the tailpiece until no more leakage found.

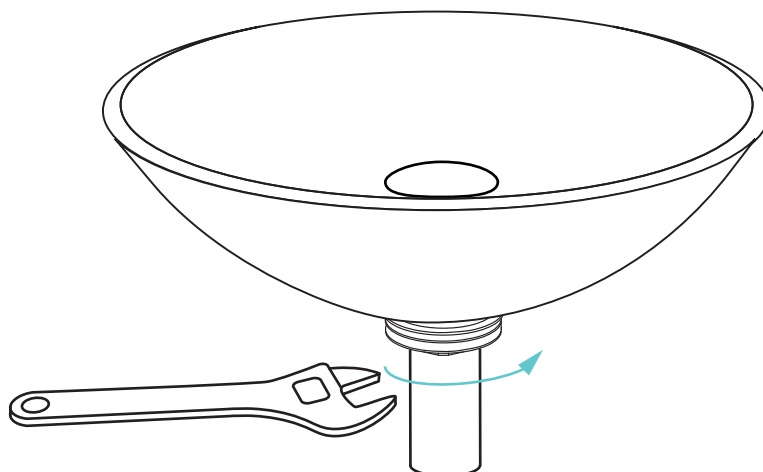

## ONE-YEAR LIMITED WARRANTY

Swiss Madison® products are made with quality materials and excellent craftsmanship to provide our customers with beautiful, durable, long-lasting products. Should there be any defects in materials or craftsmanship under regular use that are discovered within the first year after delivery, Swiss Madison® will provide replacement parts at no charge, or at its discretion, replace any product or part of the product that is deemed defective, under normal installation, use, service or maintenance. This warranty applies only to the original purchaser. Proof of purchase must be submitted with any warranty claim.

Swiss Madison® recommends that all installations of Swiss Madison® products to be conducted by a licensed plumber or contractor. Swiss Madison® will not be held responsible for any damage or product failure due to improper installation, misuse, or failure to utilize a licensed plumber or contractor for installation. Swiss Madison® is not responsible for any installation or removal costs.

### THIS ONE-YEAR LIMITED WARRANTY WILL BE VOIDED IF:

- The installation instructions were not followed by the installer
- The product has been moved from its initial place of installation
- The product has in any way been modified from its original condition
- The product has been subjected to improper maintenance, abuse, misuse, excessive use of chemicals, accidents, or other damages

Swiss Madison® makes no warranty that its products comply with any local building or plumbing codes. It is the consumer's responsibility and obligation to determine local code compliance prior to and during installation.

Swiss Madison® is not responsible for any special, incidental or consequential damages associated with the installation, replacement, return or use of the original purchaser's product. This includes, but is not limited to: freight costs, labor, travel time, lost profit, home damages and other contingent liabilities and costs (including, without limitation, costs associated with 'professionals' or 'experts', investigations, audits, analyses, attorneys and any other professional/hired services). Some states do not allow the exclusion or limitation of incidental or consequential damages, so the above limitation or exclusion may not apply to you.

The Swiss Madison® warranty is a comprehensive and explicit limit of liability. All other warranties are hereby disclaimed and waived.

**QUESTIONS OR CONCERNS?** Please contact us directly at: 1-434-MADISON (623-4766)



### **WARNING:**

Contents of your order may contain sharp and possibly other harmful pieces and may cause hazard to children and adults. Swiss Madison® is not responsible in any way for personal injuries or damages.