

CST746CSMFG.10 MW7463046CSMFG(A).10 MS746124CSMFG.10
 CT746CUFG.10 CT746CUFGT40.10 CT746CUFGT40.10
 ST746SMA ST746SMA ST746SMA

MW7463056CSMFG(A).10
 CT746CUFGT40.10
 ST746SMA

10" Drake®

1.6 & 0.8 Gpf Toilet, Elongated

DYNAMAX TORNADO FLUSH®, Universal Height,
 (including CEFIONTECT®)

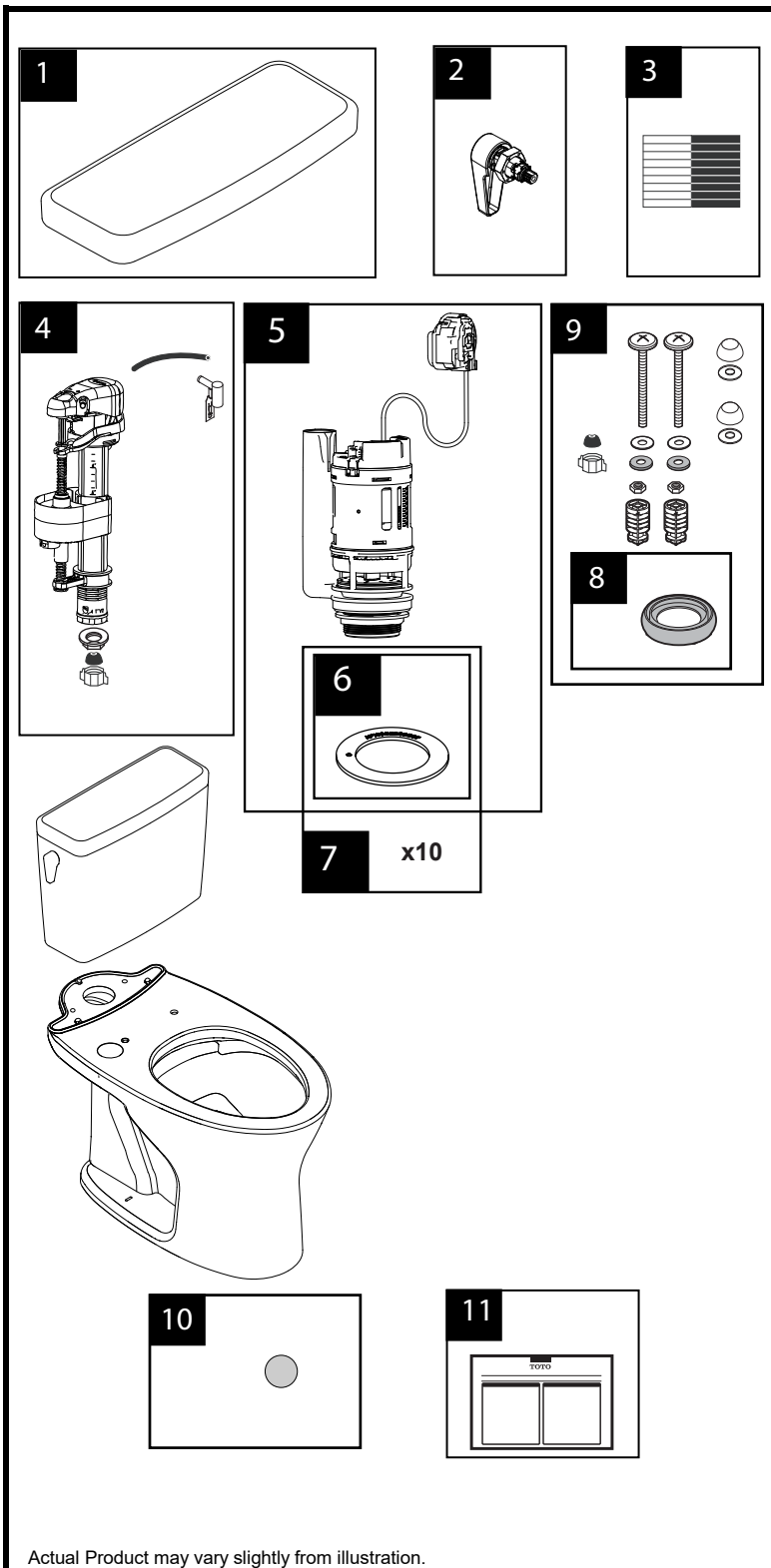

Item	Part	Description
1	TCU746CR#01	Tank Lid w/ Velcro Tape - Cotton
	TCU746CR#03	Tank Lid w/ Velcro Tape - Bone
	TCU746CR#11	Tank Lid w/ Velcro Tape - Colonial White
	TCU746CR#12	Tank Lid w/ Velcro Tape - Sedona Beige
	TCU746CR#51	Tank Lid w/ Velcro Tape - Ebony
2	THU773#CP-A	Trip Lever Handle - Chrome Plated
	THU773#PN-A	Trip Lever Handle - Polished Nickel
	THU773#BN-A	Trip Lever Handle - Brushed Nickel
	THU773#01-A	Trip Lever Handle - Cotton
3	THU107	Velcro Tape
4	TSU823.07-A	Fill Valve Assembly
5	THU777-A	Flush Valve Assembly, 1.6 & 0.8 GPF
6	9BU112E-A	Flush Tower Seal Gasket - 1pc
7	THU744	Flush Tower Seal Gasket - 10 pcs
8	9BU109E-A	Tank to Bowl Gasket
9	THU778#01-A	Tank to Bowl Mounting Hardware - Cotton White
	THU778#03-A	Tank to Bowl Mounting Hardware - Bone
	THU778#11-A	Tank to Bowl Mounting Hardware - Colonial White
	THU778#12-A	Tank to Bowl Mounting Hardware - Sedona Beige
	THU778#51-A	Tank to Bowl Mounting Hardware - Ebony
10	0EU147#01-A	Conceal Sticker - Cotton White
	0EU147#03-A	Conceal Sticker - Bone
	0EU147#11-A	Conceal Sticker - Colonial White
	0EU147#12-A	Conceal Sticker - Sedona Beige
	0EU147#51-A	Conceal Sticker - Ebony
11	0GU193	Installation Instruction

Note:

Product Number Explanations

<u>Two-Piece Toilet</u>	<u>Tank</u>	<u>Bowl</u>
(CST) Gravity Type Toilet	(ST) Tank	(CT) Bowl
(MS) Toilet & Seat Combo	(746) Model	(746) Model
(MW) Toilet & WASHLET® Combo	(S) 1.6 & 0.8 GPF	(C) DYNAMAX
(746) Model	(M) DUAL-MAX®	TORNADO FLUSH®
(C) DYNAMAX	(A) Autoflush	(F) Universal Height
TORNADO FLUSH®	Compatible	(G) CEFIONTECT®
(S) 1.6 & 0.8 GPF		(T40) WASHLET®+
(M) DUAL-MAX®		(.10) 10"
(F) Universal Height		
(G) CEFIONTECT®		
(.10) 10"		

Actual Product may vary slightly from illustration.