

SINCE 1839

**BRINLY**

SINCE 1839

**BRINLY**

# KIT INSTRUCTIONS

## **180° DUMP CONVERSION KIT 10P CART**

### **FDK-10BH**

*Compatible with 10P Cart Models:*

*PCT-100BH, PCT-101BH & PCT-100JD*

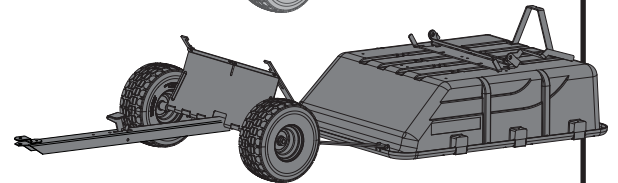
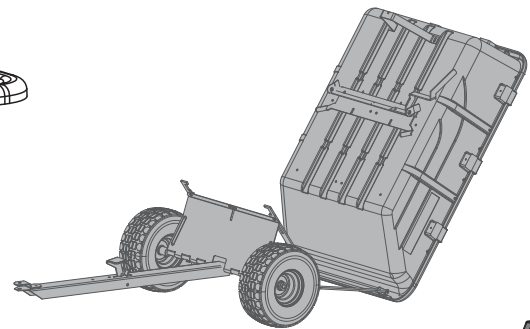
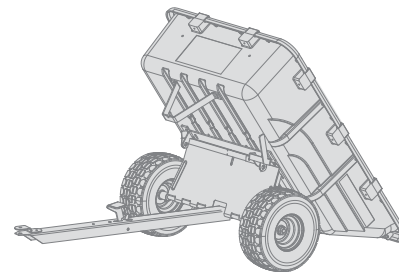
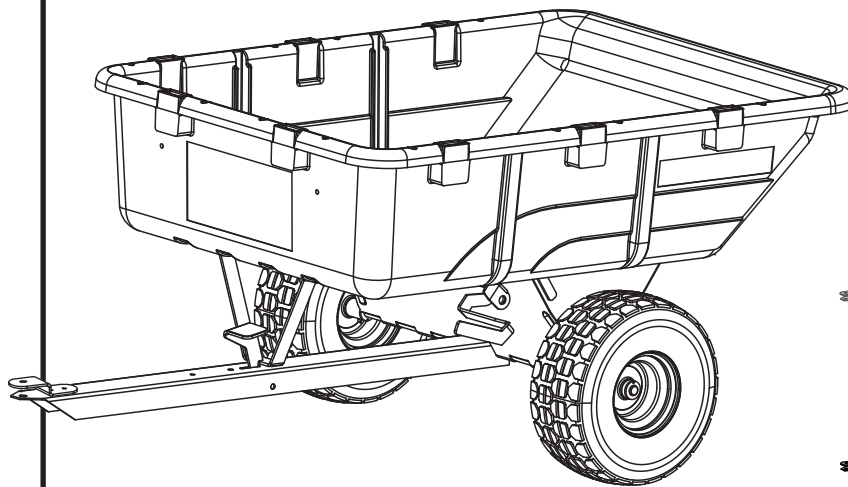

**Call Customer Service, Toll-Free: 877-728-8224**

Visit us on the web!  
[www.brinly.com](http://www.brinly.com)

**Important:** This manual contains information for the safety of persons and property. Read it carefully before assembly and operation of the equipment!

# INDRODUCTION

CONGRATULATIONS on the purchase of your new Brinly-Hardy Roger 180° Dump Kit! This accessory has been designed, engineered and manufactured to give you the best possible dependability and performance.

Should you experience any problem you cannot easily remedy, please do not hesitate to contact our knowledgeable customer service department toll-free at 1-877-728-8224. We have competent, well trained technicians to help you with the assembly and use of your product.



## CUSTOMER RESPONSIBILITIES

- Please read & retain this manual. The instructions will enable to assemble and maintain your product properly.
- Please carefully read and observe the SAFETY SECTION of this manual.
- Follow a regular schedule in maintaining and caring for your Brinly-Hardy product.

## TABLE OF CONTENTS

INTRODUCTION . . . . .	2
SAFETY . . . . .	2
HARDWARE IDENTIFIER . . . . .	3
PART LIST . . . . .	4
ASSEMBLY . . . . .	5 - 15
OPERATION . . . . .	16 - 17
WARRANTY . . . . .	18

## RECORD PURCHASE INFORMATION

Record your purchase information in the spaces provided below:

DATE OF PURCHASE \_\_\_\_\_

COMPANY NAME \_\_\_\_\_

SERIAL NUMBER \_\_\_\_\_

CO. PHONE \_\_\_\_\_

## REQUIRED TOOLS FOR ASSEMBLY

- 1/2" Wrench
- 9/16" Wrench & Ratchet
- Flathead Screwdriver
- Drill (5/16" Bit included with kit)
- Gloves

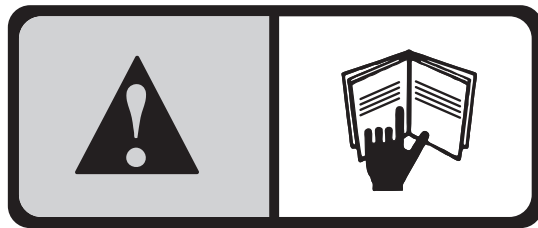

## SAFETY LABELS AND NOTATION



This symbol will help to point out important safety precautions throughout this manual. It means: **ATTENTION! BECOME ALERT! Your safety is involved.**

The safety labels shown in this section are placed in important areas on your product to draw attention to potential safety hazards.

On your product safety labels, the words **DANGER**, **WARNING** and **CAUTION** are used with the safety-alert symbol. **DANGER** identifies the most serious hazards.

The operator's manual also explains any potential safety hazards whenever necessary in special safety messages that are identified with the word, **CAUTION**, and the safety-alert symbol.

# HARDWARE IDENTIFIER

## TEAR OUT THIS PAGE

Illustrations on this page are to-scale for identification of hardware during assembly. **Tear out this page for quick reference.** Simply lay the hardware directly on top of the illustrations below to verify you're using the correct parts.

10 Bushing: Hex Head  
3/8" x 1/2" (x2) .....  
**1001301**

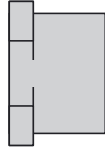

11 Nut: Nylon Lock  
3/8" (x4) .....  
**B-4820**

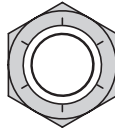

12 Nut: Nylon Lock  
5/16" (x2) .....  
**B-4786**



13 Nut: Hex Head  
5/16" (x14) .....  
**30M1000P**



17 Spring  
(x1) .....  
**B-6300**

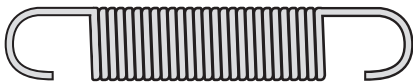

19 Bolt: Hex Head  
3/8 x 1 1/4"  
(x2) .....  
**2M1220P**

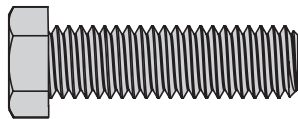

21 Bolt: Hex Head 3/8 x 3" (x2) .....  
**2M1248P**



22 Grip: Flat  
( for Handle )  
(x1) .....  
**R-1882**

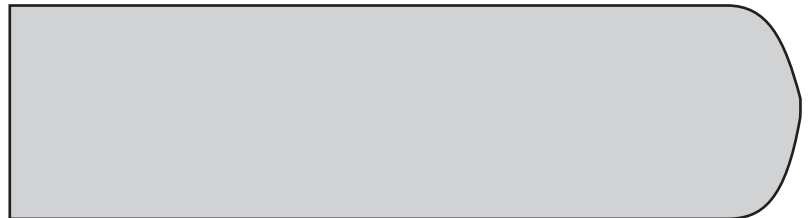

23 Drill Bit (x1) .....  
**1018992**

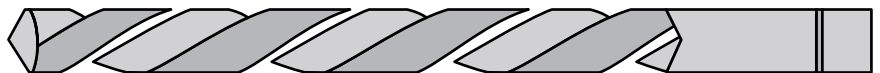

Exterior circumferences of the washers can vary. These dimensions are a measurement of the internal diameter of the washer.

14 Washer: Flat  
3/8" (x2) .....  
**45M1313P**

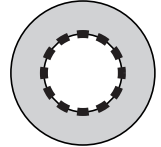

15 Washer: Lock  
5/16" (x14) .....  
**40M1000P**

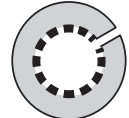

16 Washer: Flat  
5/16" (x8) .....  
**45M1111P**

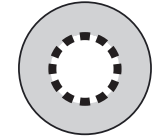

18 Bolt: Carriage  
5/16 x 1" (x8) .....  
**11M1016P**

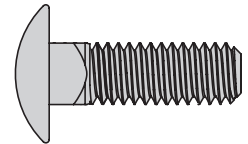

20 Screw:  
Round Head  
5/16 x 1" (x8) .....  
**20M1020P**

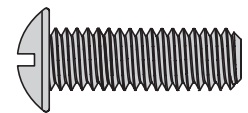

## PARTS

REF	DESCRIPTION	Part#	QTY
1	Rocker Base Plate	1018681	1
2	Pivot Arm; Left	1018698	1
3	Pivot Arm; Right	1018697	1
4	Drilling Template; Pivot Arms	1018696	1
5	Pivot Bracket; Rear	1018684	2
6	A-Frame Support Bracket	1018687	1
7	Rocker Motion Bracket	1018682	1
8	Rocker Handle	1018881	1
9	Label; * "1. Release"	1018836	1

*\*not illustrated*

### Hardware Bag ( 1018946 )

10	Bushing, 3/8" x 1/2"	1001301	2
11	Nut; Nylon Lock, 3/8"	B-4820	4
12	Nut; Nylon Lock, 5/16"	B-4786	2
13	Nut; Hex Head, 5/16"	30M1000P	14
14	Washer; Flat, 3/8"	45M1313P	2
15	Washer; Lock, 5/16"	40M1000P	14
16	Washer; Flat, 5/16"	45M1111P	8
17	Spring	B-6300	1
18	Bolt; Carriage, 5/16" x 1"	11M1016P	8
19	Bolt; Hex Head, 3/8" x 1 1/4"	2M1220P	2
20	Screw; Round Head, 5/16" x 1"	20M1020P	8
21	Bolt; Hex Head, 3/8" x 3"	2M1248P	2
22	Grip, Flat	R-1882	1
23	Drill Bit	1018992	1

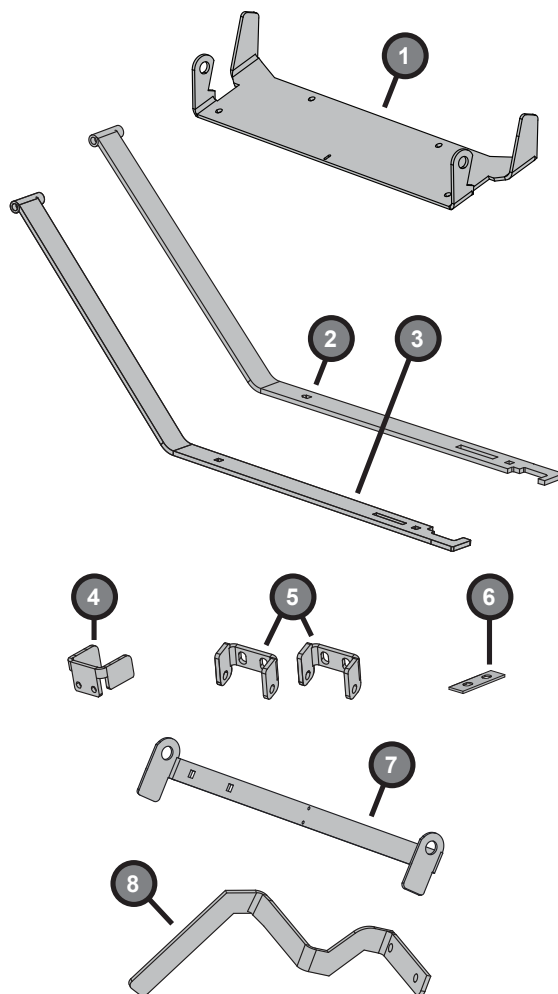

### REQUIRED TOOLS FOR ASSEMBLY



- 1/2" Wrench
- 9/16" Wrench & Ratchet
- Flathead Screwdriver
- Drill (5/16" Bit included with kit)
- Gloves

If you have any installation questions, are missing parts or need replacement parts, don't go back to the store! Please contact our Customer Service department:



Call, Toll-Free: **877-728-8224**



Chat online: **www.brinly.com**



Email: **customerservice@brinly.com**

# ASSEMBLY

## STEP 1

Tear out the Hardware Identifier (page 3) for a faster assembly time.

Illustrations on this page are to-scale for identification of the hardware during assembly.

Simply lay the hardware directly on top of the illustrations to verify you're assembling with the correct parts.

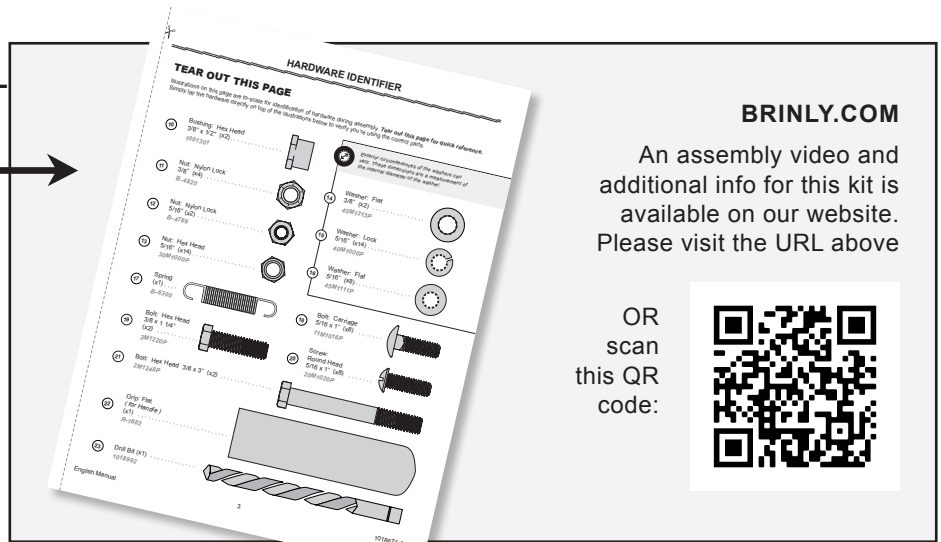

## STEP 2

### REMOVING A-FRAME

Remove the hardware connecting your current cart bed to the A-frame.

**NOTE:** Hardware necessary to be removed is illustrated here. (A total of 8 nuts, 8 bolts and 8 washers).

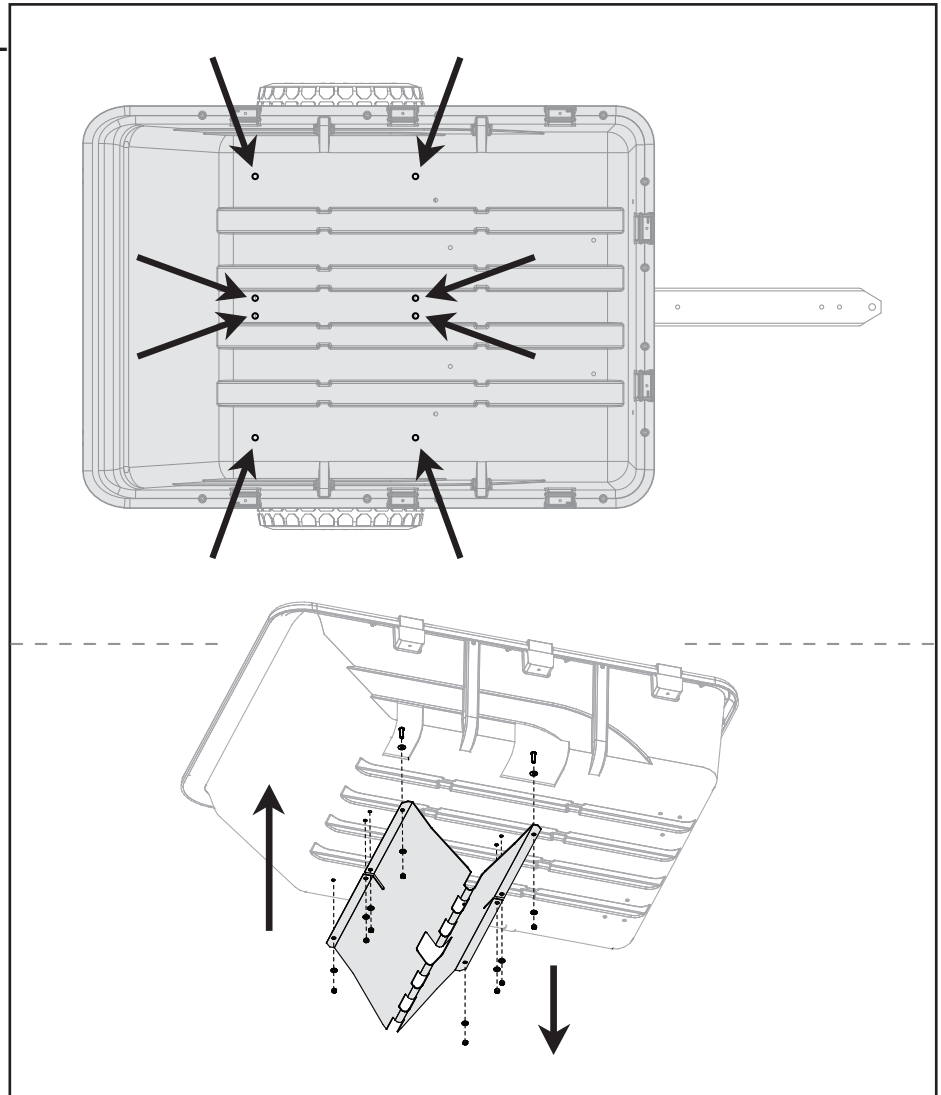

# ASSEMBLY

## STEP 3-A

### Find this hardware:

- x4 Round Head Screws (20)  
5/16" x 1"

Place the rocker Base Plate (1) against the bed of the cart.

**NOTE:**  
Alignment of this part  
**HAPPENS HERE**

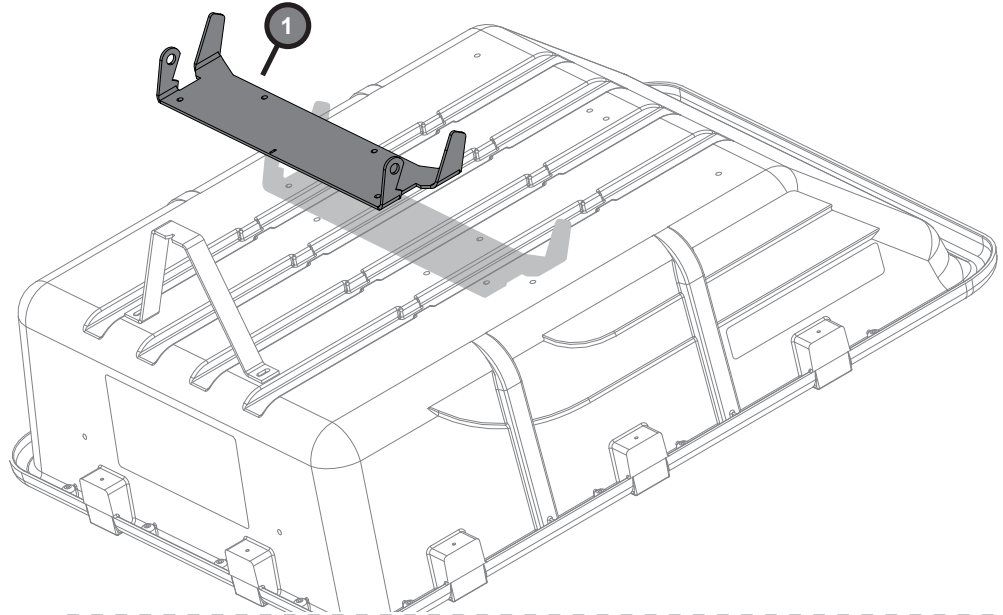

For alignment and drilling purposes, temporarily add the pivot arms (2 and 3) as illustrated.

Using four of the existing cart holes, slide four 5/16" x 1" Round Head Screws (20) in place.

*Note: No need to tighten with a nut, you will remove the pivot arms after this step.*

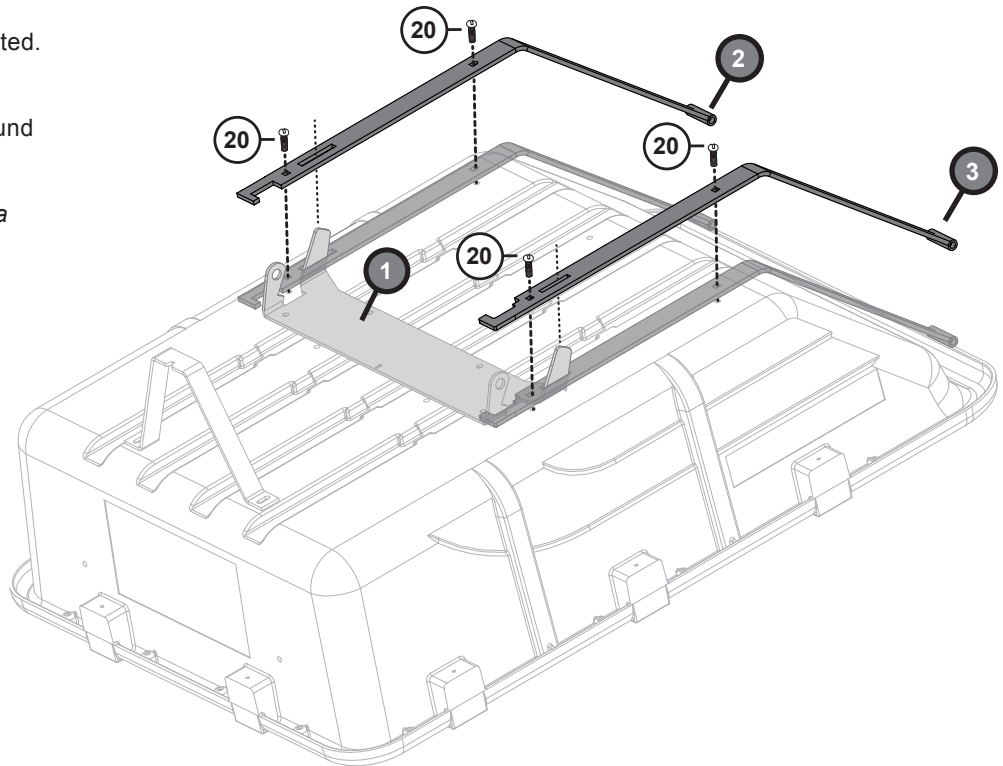

# ASSEMBLY

## STEP 3-B (Drilling)

Find the provided Drill Bit (23).

Using the remaining circular holes of the rocker plate (1) as a template, drill four holes through the cart.

 Drill Bit (23)

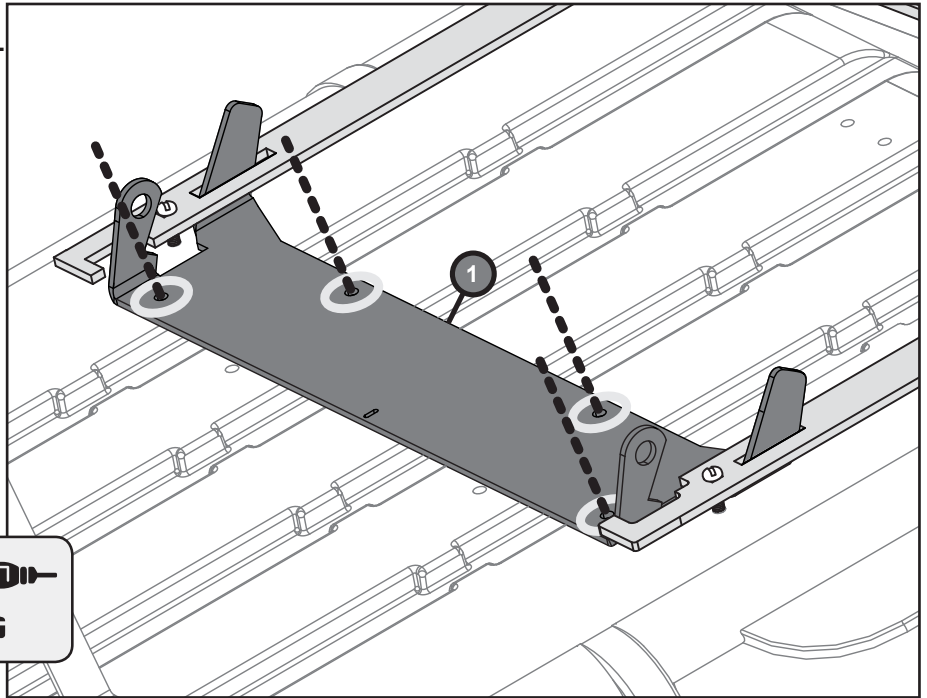

## STEP 3-C (Drilling)

**On the other end of the pivot arms (where the cart rim and pivot arms meet) you'll need to drill four holes that will connect the pivot arms to the bed of the cart.**

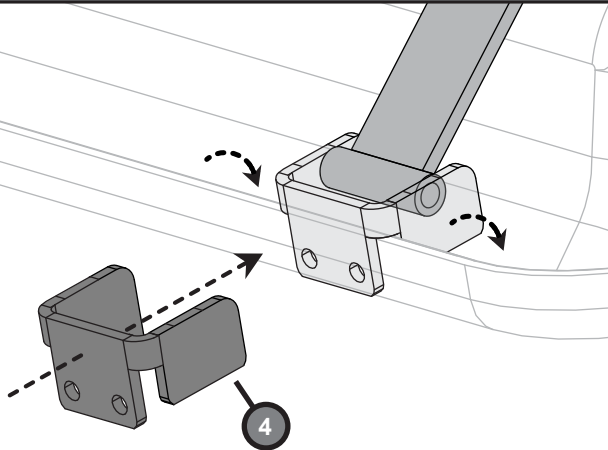

Slide the drilling template (4) in place as illustrated and center it over the end of the pivot arm.

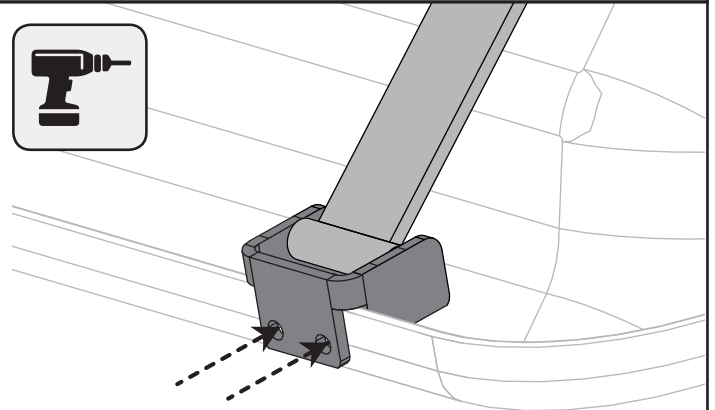

Drill through the template holes, straight into the bed of the cart. **Repeat this step with the other pivot arm.**

**Remove and set aside the four Round Head Screws (20) added on Step 3-A, the Drilling Template (4) as well as the Pivot Arms (2 & 3).**

# ASSEMBLY

## STEP 4

### Find this hardware:

- x4 Screws; Round Head (20) - 5/16" x 1"
- x4 Washer; Flat (16) - 5/16"
- x4 Washer; Lock (15) - 5/16"
- x4 Nut; Hex Head (13) - 5/16"

Add a Flat Washer (16) to each Round Head Screw (20). Align the Pivot Bracket (5) as illustrated to the right.

Secure the Pivot brackets (5) underneath in place by adding a Lock Washer (15) and Nut (13) to the end of the screw.

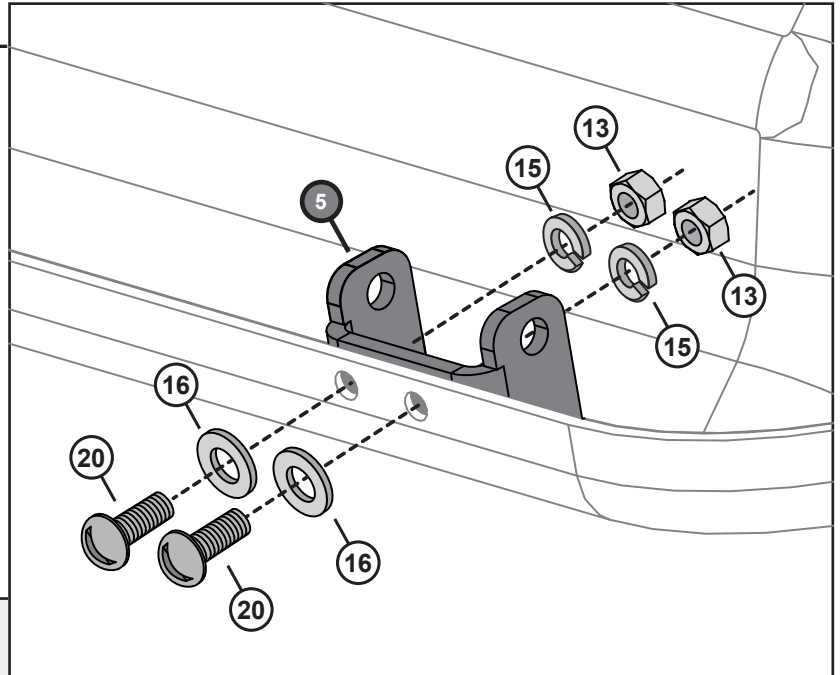

## STEP 5-A

### Find this hardware:

- x2 Bolt; Carriage (18) - 5/16" x 1"
- x2 Washer; Lock (15) - 5/16"
- x2 Nut; Hex Head (13) - 5/16"

Align holes of the Right Pivot Arm (3) with the A-frame.

**NOTE: Hooks of the Pivot Arms will face toward center of the cart.**

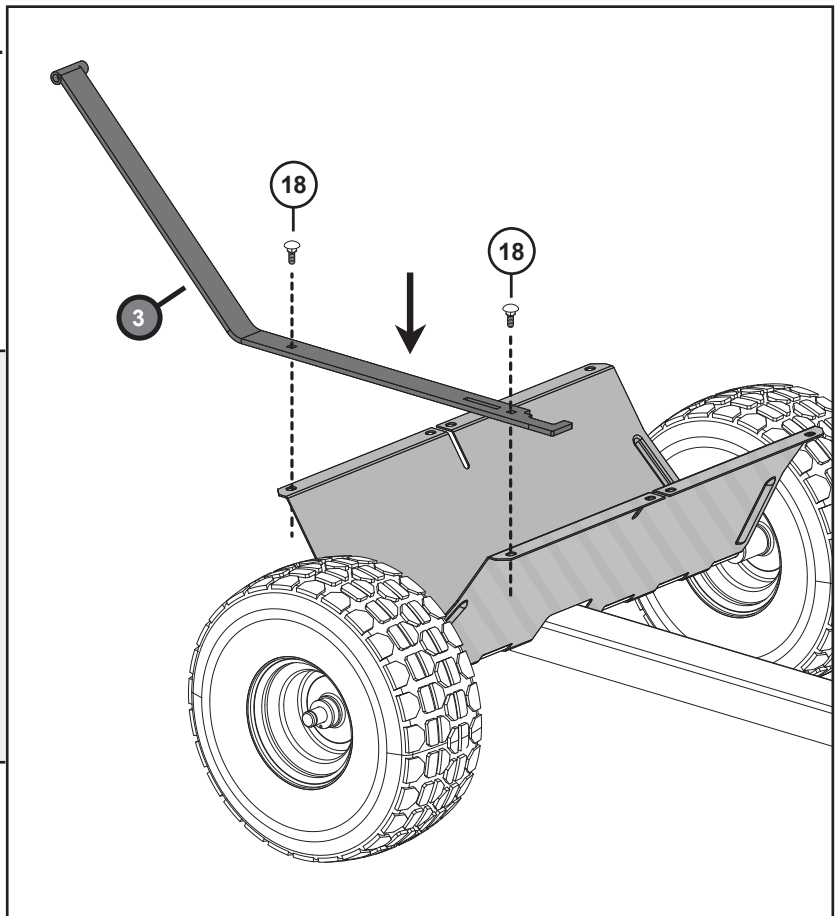
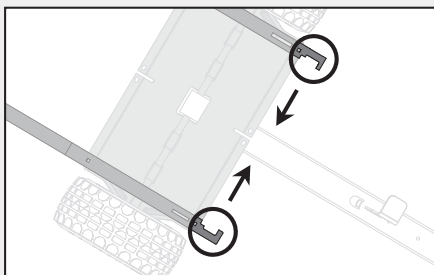

Add both carriage bolts (18) to the Pivot Arm (3) and A-Frame as illustrated here.



# ASSEMBLY

## STEP 5-A (Continued)

Beneath the cart A-frame, start to add two 5/16" lock washers (15) and 5/16" nuts (13) on the outside edges of the tray and plates.

**DO NOT tighten the nuts (13) fully YET.**

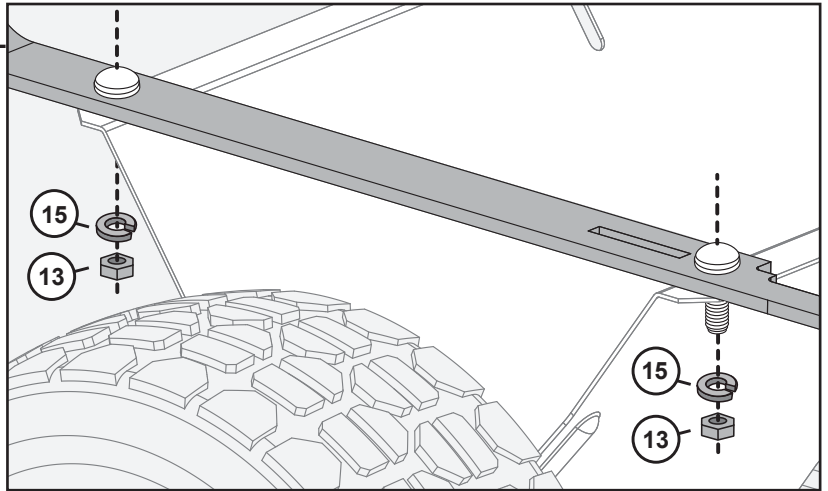

## STEP 5-B

### Find this hardware:

- x2 Bolt; Carriage (18) - 5/16" x 1"
- x2 Washer; Lock (15) - 5/16"
- x2 Nut; Hex Head (13) - 5/16"

Align holes of the Left Pivot Arm (2) with the A-frame.

**NOTE: Hooks of the Pivot Arms will face toward center of the cart.**

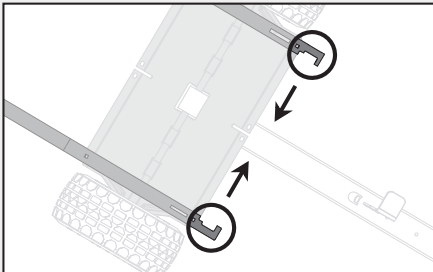

Add both carriage bolts (18) to the Pivot Arm (2) and A-Frame as illustrated here.

Beneath the cart A-frame, start to add two 5/16" lock washers (15) and 5/16" nuts (13) on the outside edges of the tray and plates.

**DO NOT tighten the nuts (13) fully YET.**

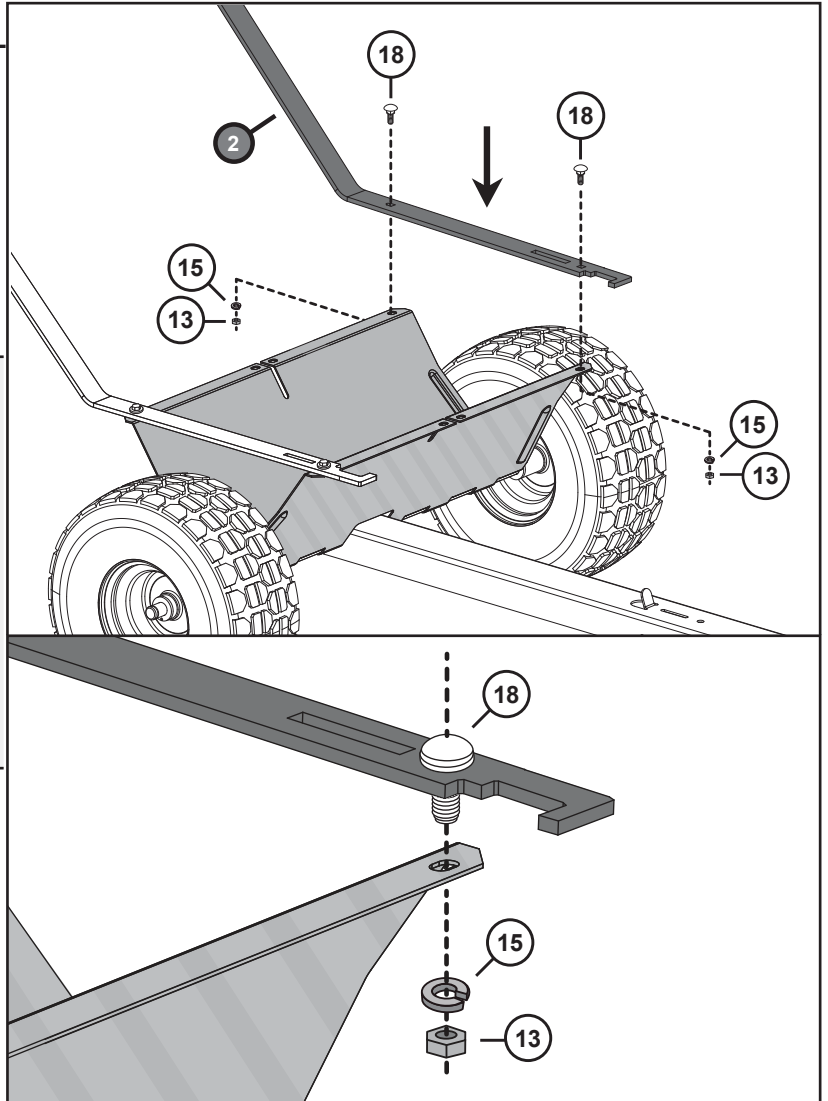

# ASSEMBLY

## STEP 5-C

### Aligning the Pivot Arms

Temporarily slide the rocker base (1) into the slots of the pivot arms (2) and (3).

See Illustration.

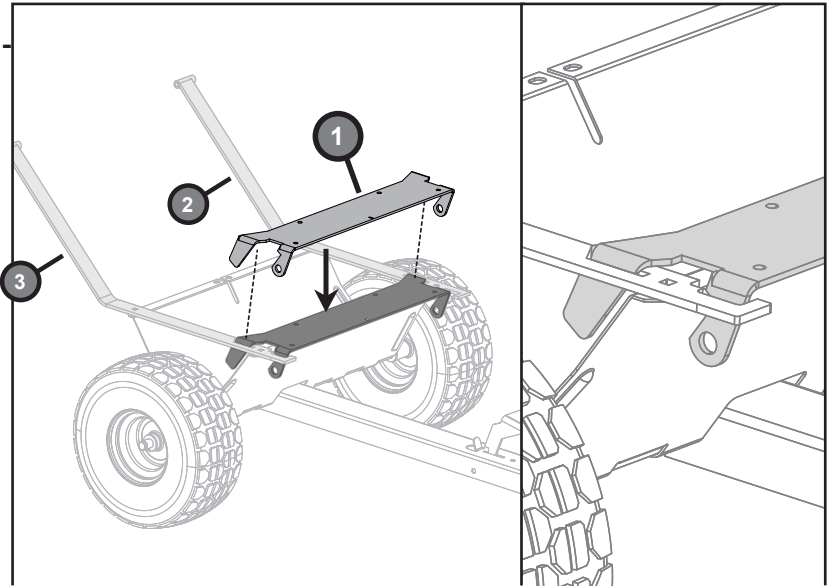

**Tighten the four 5/16" nuts (18) from Steps 5-A and 5-B (reference pages 8-9).**

Remove the rocker base (1) from the assembly (this will be used on step 6, page 11).

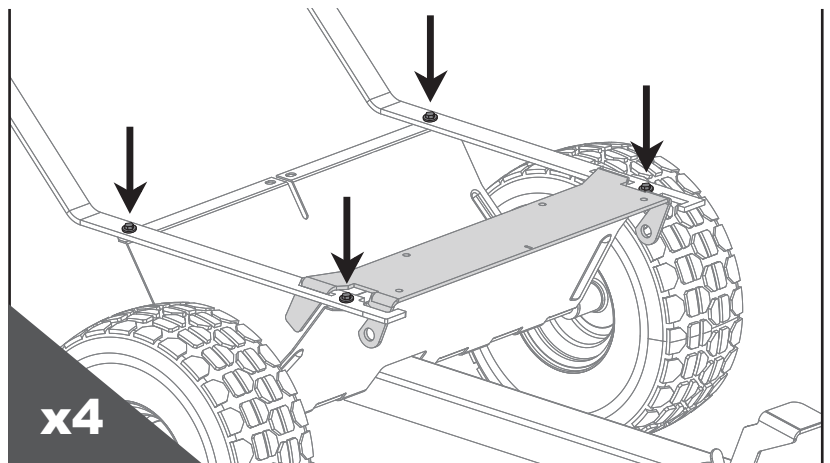

## STEP 5-D

### Find this hardware:

- x2 Bolt; Carriage (18) - 5/16" x 1"
- x2 Washer; Lock (15) - 5/16"
- x2 Nut; Hex Head (13) - 5/16"

Align the A-frame support bracket (6) from above the axle and run each bolt through.

Add a lock washer (15) to both bolts (18) and secure fully under the A-frame with two Nuts (13).

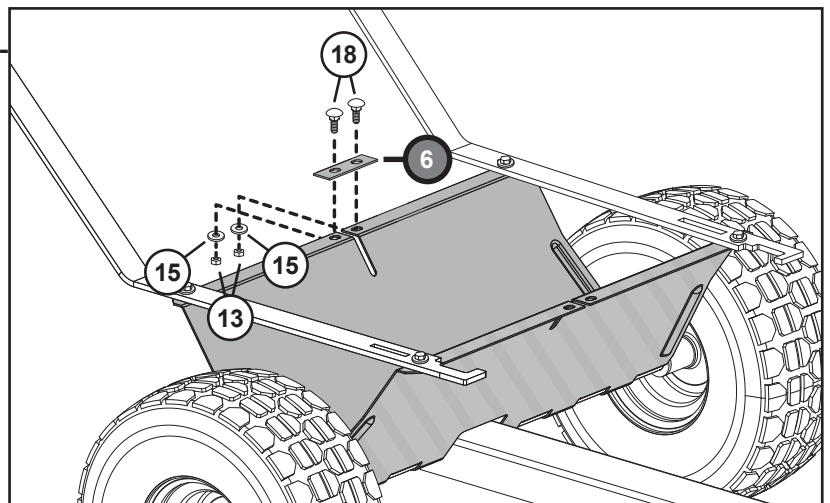

# ASSEMBLY

## STEP 6

### Find this hardware:

- x4 Screw; Round Head (20) - 5/16" x 1"
- x4 Washer; Flat (16) - 5/16"
- x4 Washer; Lock (15) - 5/16"
- x4 Nut; Hex Head (13) - 5/16"

### For Ease of Assembly:

Stand the cart bed upright and lean it against the lock bracket as illustrated.

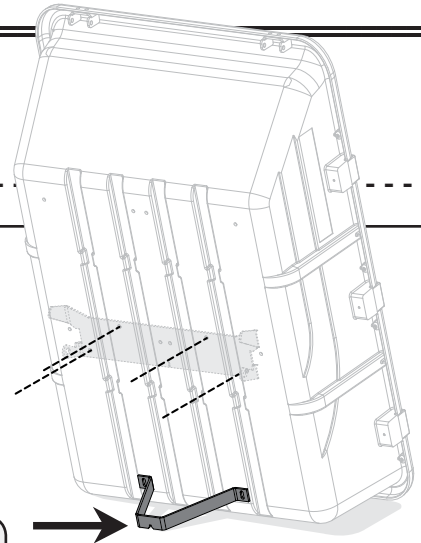

Align the new drilled cart holes and rocker plate.

Attach the rocker base plate (1) to the cart bed as illustrated here using the hardware listed.

NOTE: Heads of the screw should start from inside the cart.

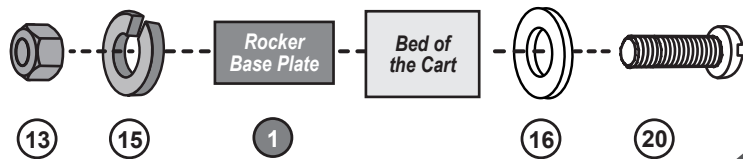

x4

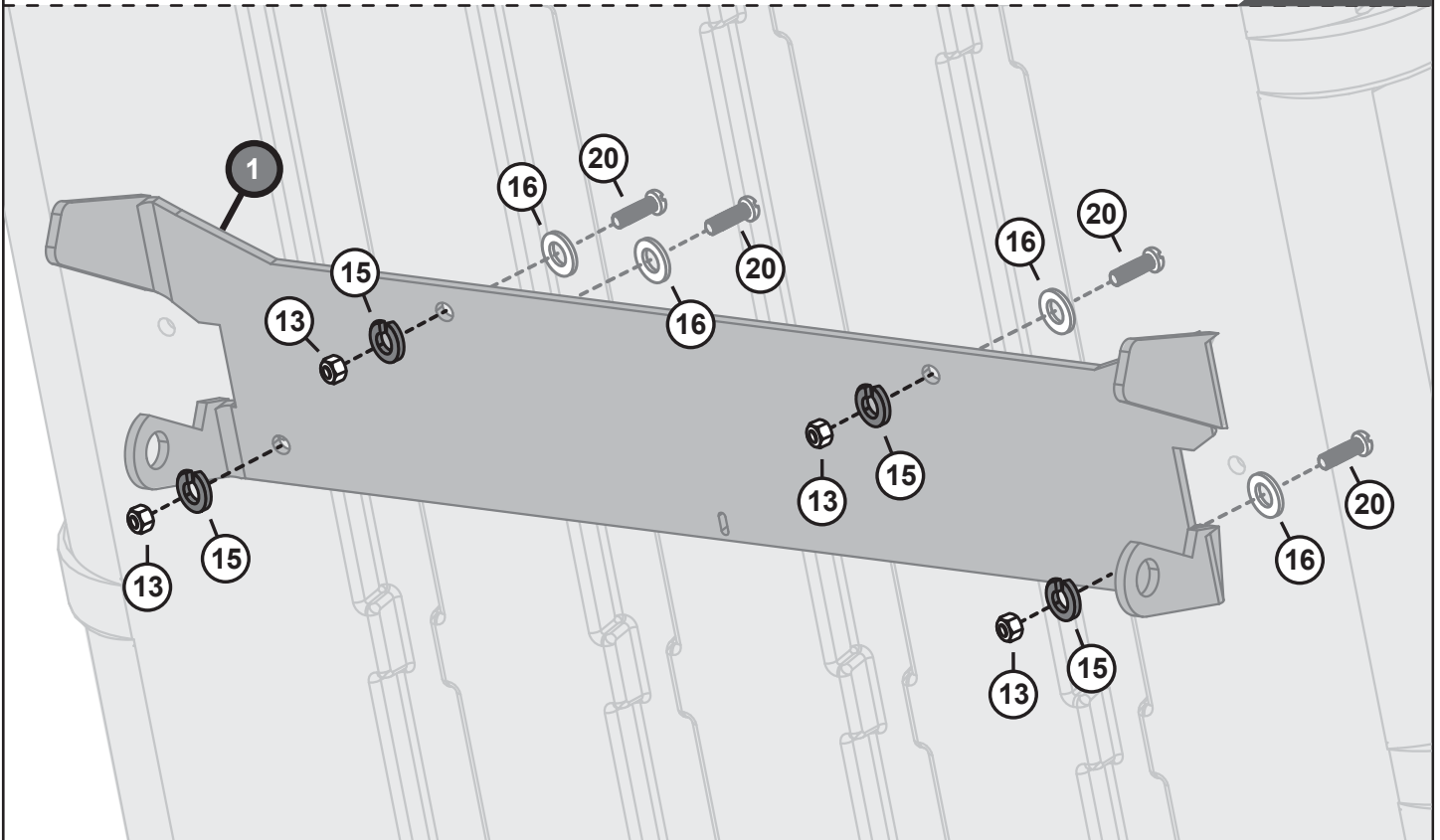

# ASSEMBLY

## STEP 7

1. Lay the cart bed down.
2. Hook one end of the spring (17) through the hole of the Rocker Motion Bracket (7) as illustrated here.
3. Expanding the spring (17), pull to hook the other end through the small center hole along the edge of the Base Plate Rocker (1).

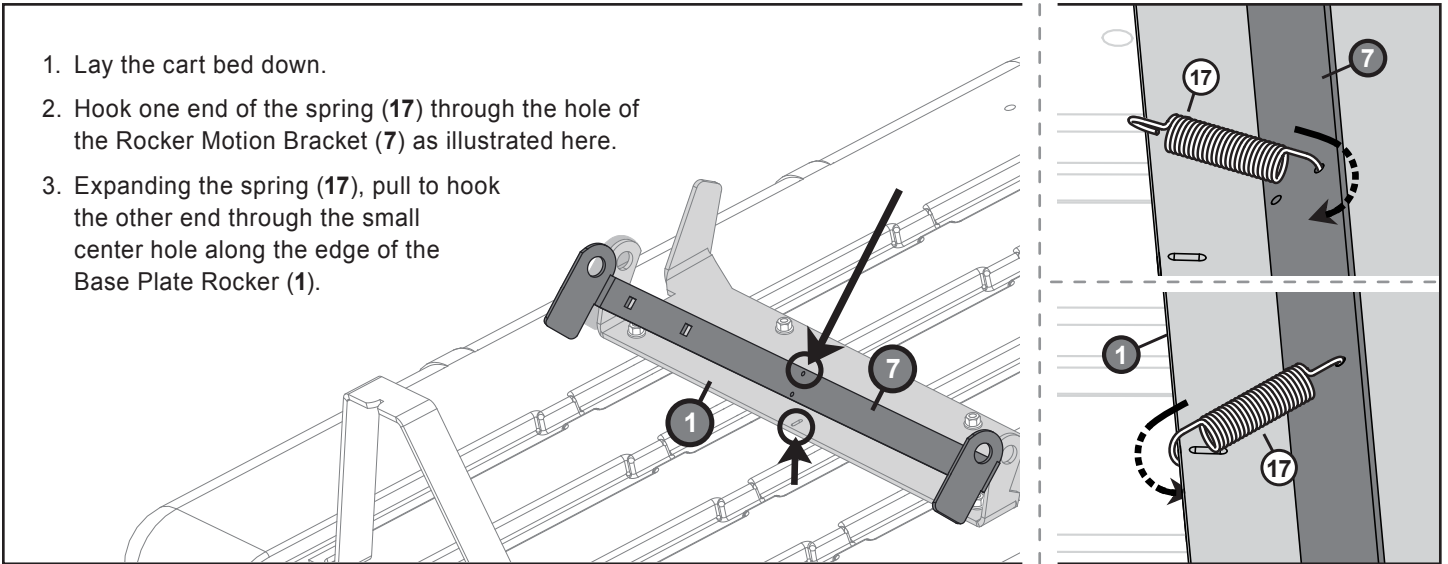

## STEP 8-A

Lift the motion bracket (7) up and over the first set of extended arms of the base plate (1).

- Align the two rocker parts:
- x1 Base Plate (1)
  - x1 Motion Bracket (7)

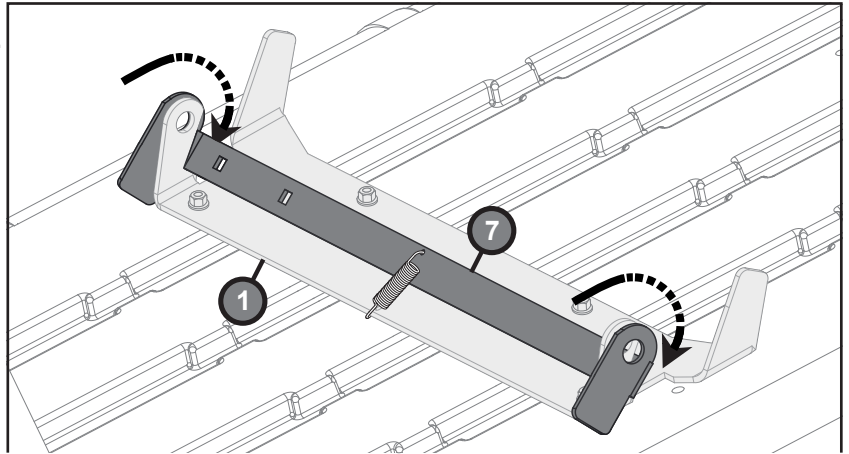

Slide two bushings (10) in place as illustrated.

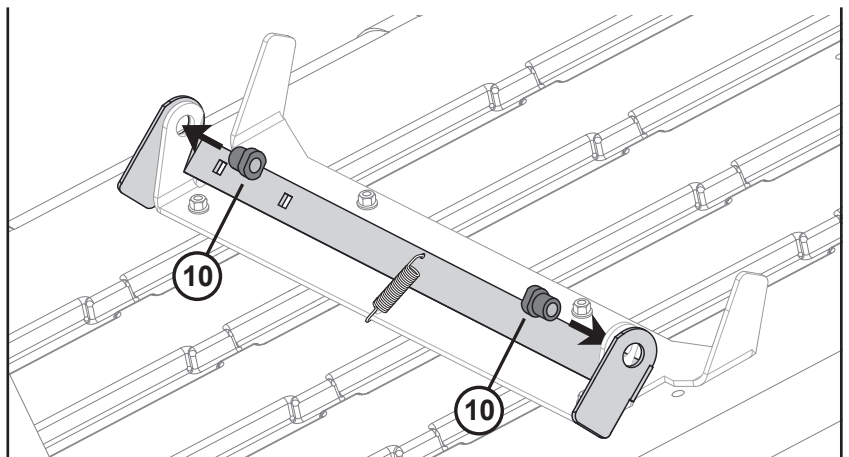

# ASSEMBLY

## STEP 8-B

### Find this hardware:

- x2 Bolt; Hex Head (19)  
3/8" x 1 1/4"
- x2 Washer; Flat (14) - 3/8"
- x2 Nut; Nylon lock,  
3/8" (11) - 3/8"

Add a washer (14) to each bolt (19). As illustrated here, run these bolts through the bushings that were added on step 8-A.

Be sure to allow movement, however, loosely secure in place with two Hex Head Locking Nuts (11).

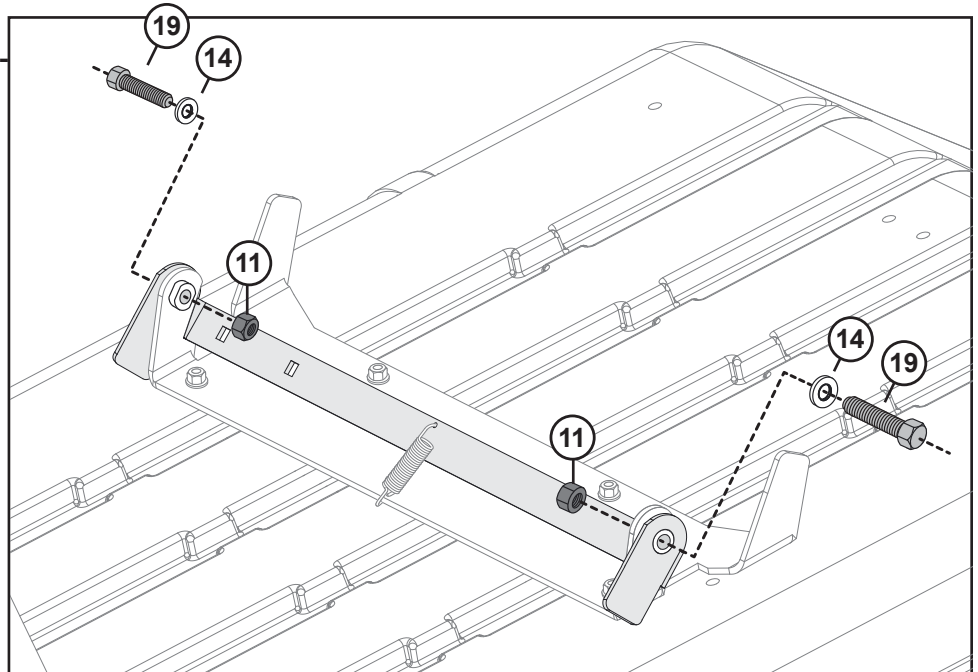

## STEP 9

### Find this hardware:

- x2 Bolt; Carriage (18) - 5/16" x 1"
- x2 Nut; Nylon Lock (12) - 5/16"

Align the Rocker Handle (8) with the square holes of the Rocker Motion Bracket (7) as illustrated here.

Add both Bolts (18) from beneath the Rocker Motion Bracket (7), through the handle (8) and secure in place with a Nylon Lock Nut (12).

Finally, slide the grip (22) over the end of the handle (8).

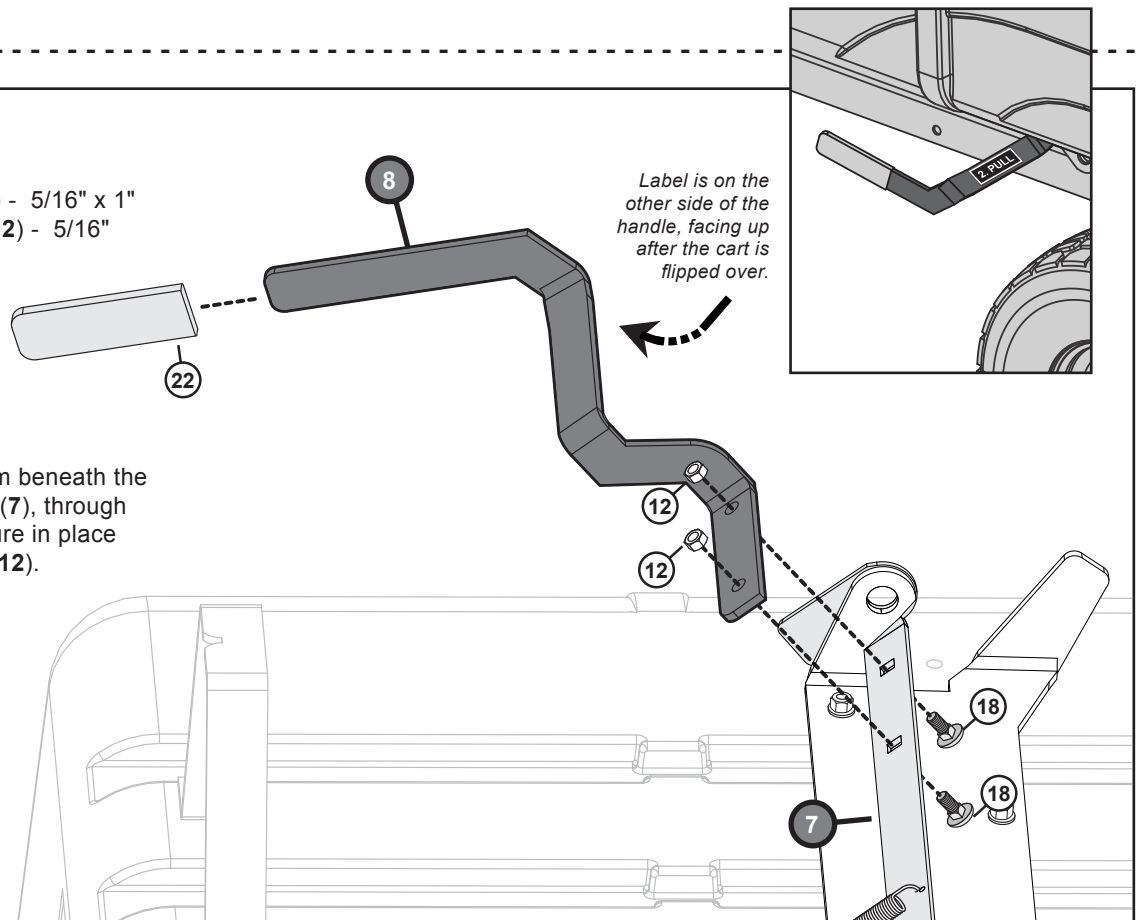

# ASSEMBLY

## STEP 10

Align the bed of the cart with the rest of the assembly as illustrated here.

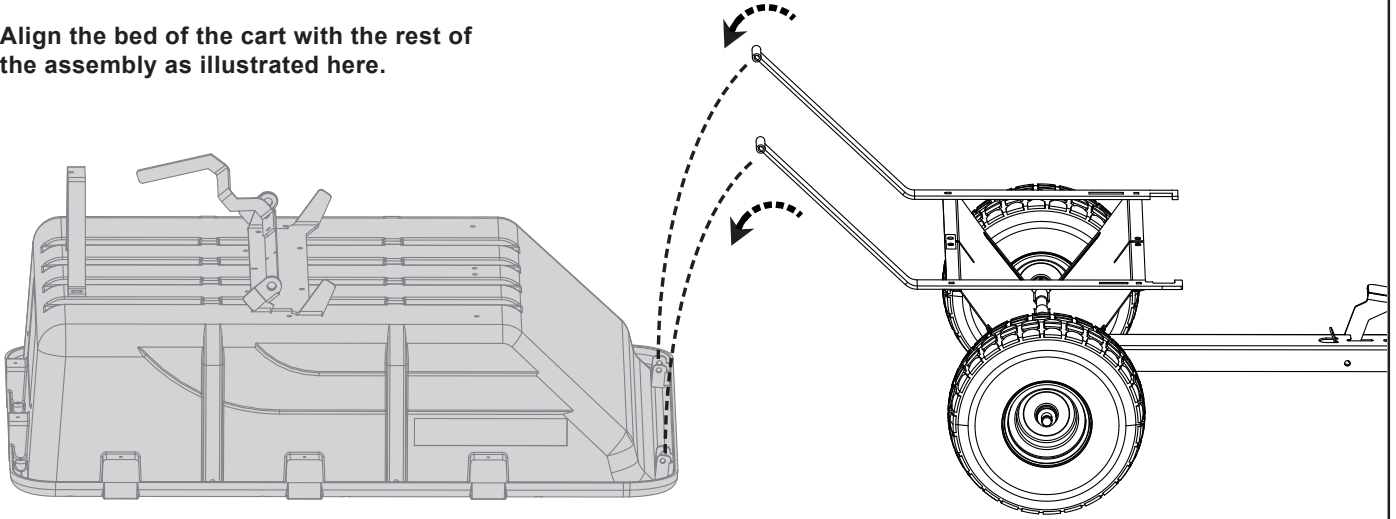

Lower the pivot arms in place, resting within the pivot brackets (5) that were installed on step 4 (pg 8).

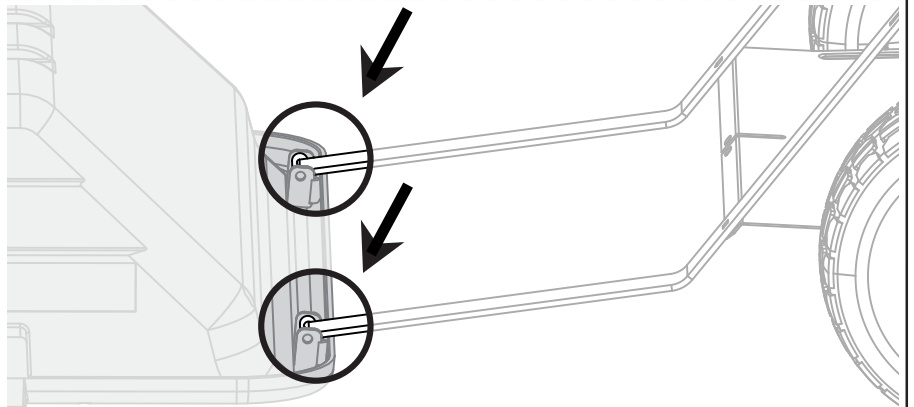

### Find this hardware:

- x2 Bolts (21) - 3/8" x 3"
- x2 Nuts; Nylon Lock, 3/8" (11)

Secure both Pivot Arms to the Pivot Brackets (17) with a Bolt (21) and Nylon lock nut (11).

**DON'T OVERTIGHTEN**  
Allow movement.

*Repeat this step for the other pivot arm.*

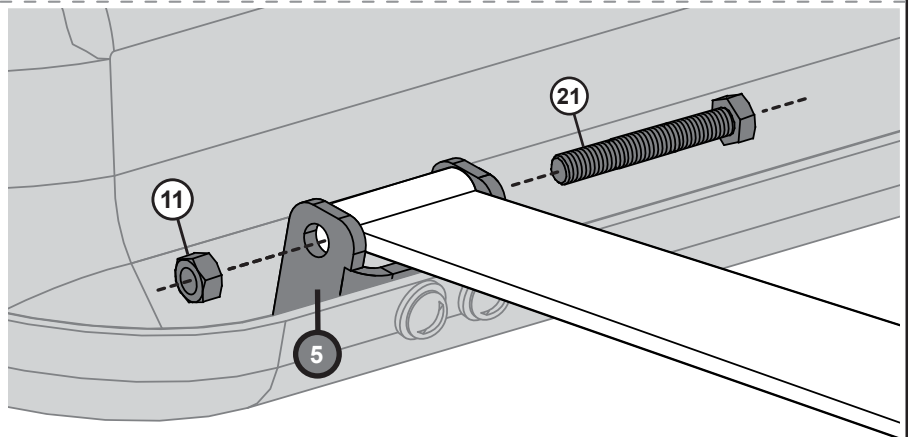

# ASSEMBLY

## STEP 11

Rotate the cart bed to its' transport position by lifting it slowly back toward the A-Frame and tow bar.

Make sure the lock bracket clicks in place with the foot pedal for alignment.

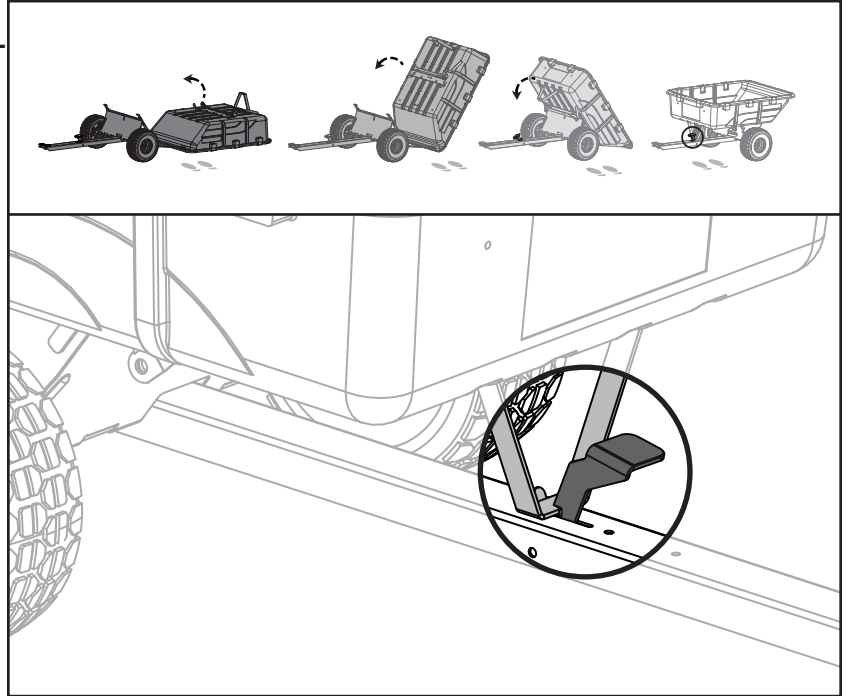

## STEP 12

Peel the paper backing off of the "1. RELEASE" label (9) and place it on the tow bar as illustrated here.

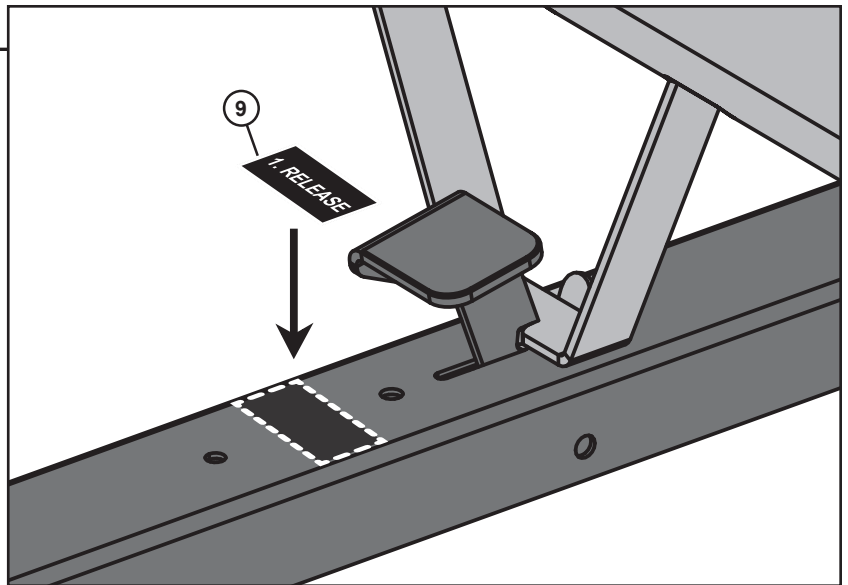
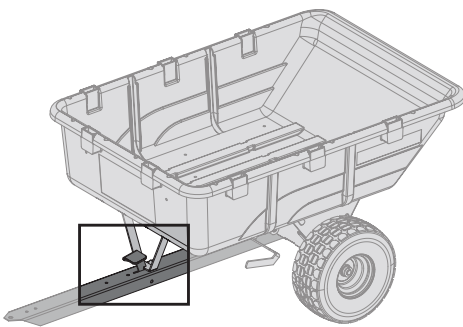

**ASSEMBLY IS COMPLETE!**

# OPERATION



**CAUTION:**  
Avoid injury!

- Before dumping cart, park machine safely.
- Before backing up, make sure the area is clear of bystanders, especially children.
- Make sure cart is installed to the towing machine.
- Keep hands, feet and other body parts away from unloading areas and locking points to prevent injury from hauled materials or the cart itself.

## STEP 1

Press down on the foot pedal to release the lock and rotate cart to the standard unloading position.

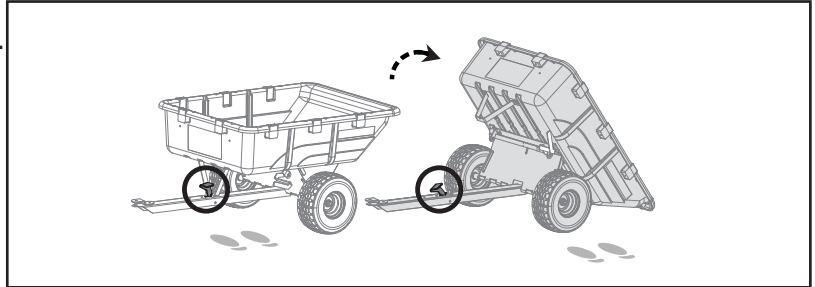

## STEP 2

Pull the lever and continue to guide the range of motion, flipping the bed of the cart toward an 180° unload.

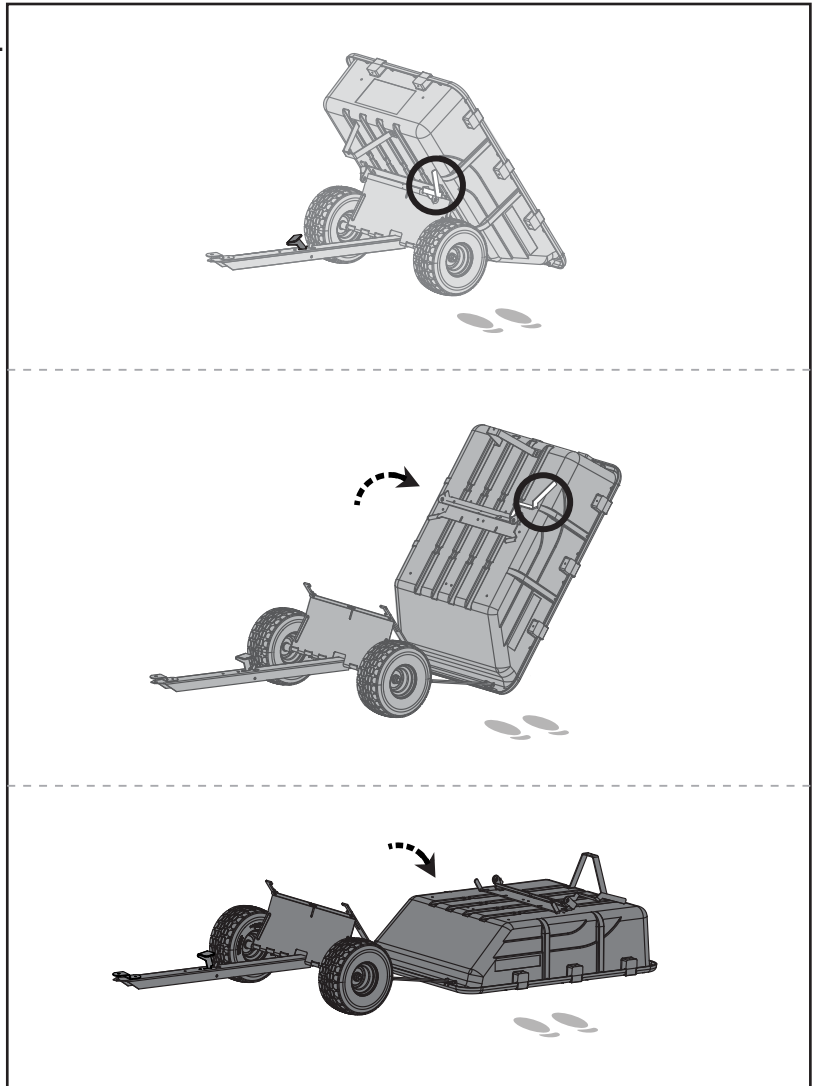



# OPERATION

## STEP 3

After unloading the cart, be sure to return it to the normal transport position and lock securely in place.

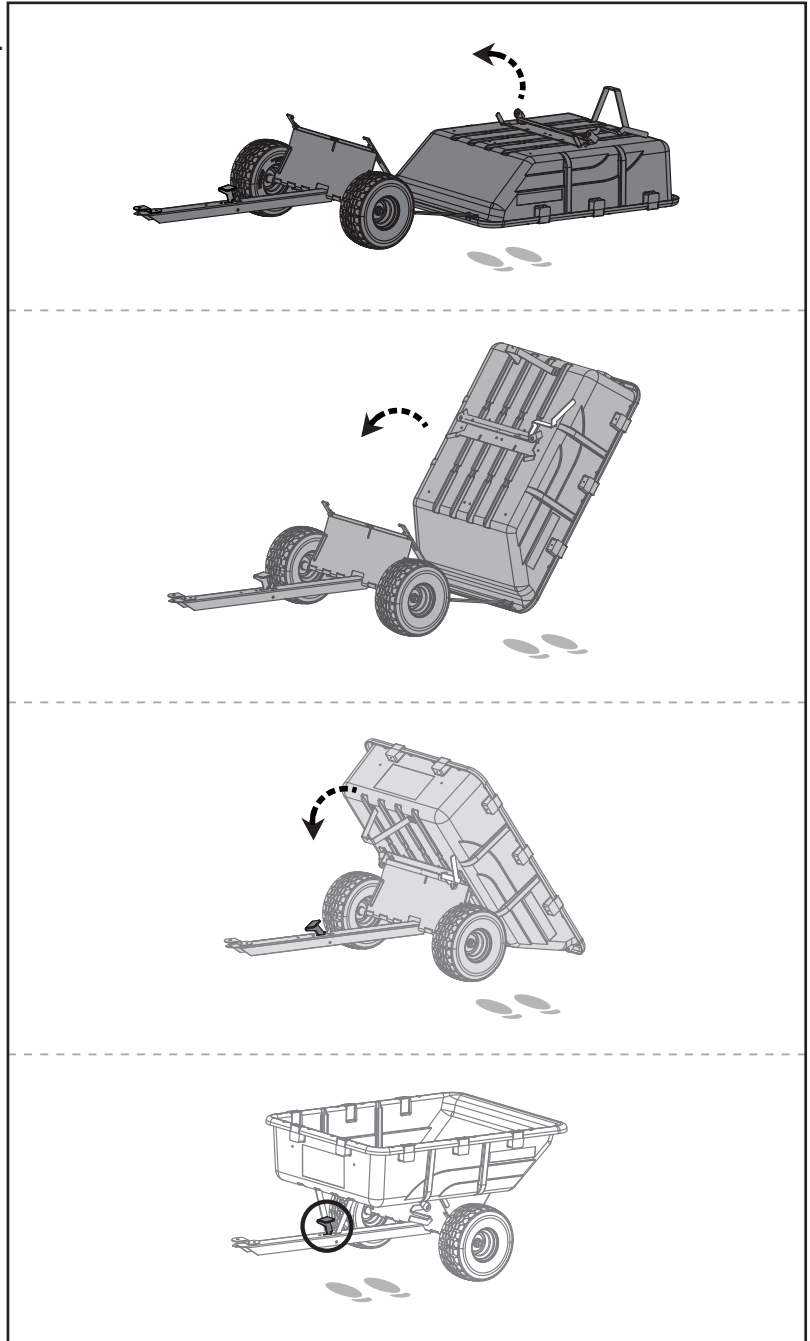

**INSTALLATION QUESTIONS? MISSING PARTS? NEED REPLACEMENT PARTS?**

**DON'T GO BACK TO THE STORE!**

Please call Customer Service Department Toll Free 877-728-8224 **OR** Email: [customerservice@brinly.com](mailto:customerservice@brinly.com)

Brinly-Hardy Company • 3230 Industrial Parkway • Jeffersonville, IN 47130 • (877) 728-8224



## MANUFACTURER'S LIMITED WARRANTY FOR BRINLY PULL-BEHIND ACCESSORIES

The limited warranty set forth below is given by Brinly-Hardy Company with respect to new merchandise purchased and used in the United States, its possessions and territories.

Brinly-Hardy Company warrants the products listed below against defects in material and workmanship, and will at its option, repair or replace, free of charge, any part found to be defective in materials or workmanship. This limited warranty shall only apply if this product has been assembled, operated, and maintained in accordance with the Operator's manual furnished with the product, and has not been subject to misuse, abuse, commercial use, neglect, accident, improper maintenance, alteration, vandalism, theft, fire, water, or damage because of other peril or natural disaster.

Parts found to be defective within the warranty period will be replaced at our expense. Our obligation under this warranty is expressly limited to the replacement or repair, at our option, of parts found to be defective in material and workmanship.

**HOW TO OBTAIN SERVICE:** Warranty parts replacements are available, **ONLY WITH PROOF OF PURCHASE**, through our Customer Service Department. Call 877-728-8224.

This limited warranty does not provide coverage in the following cases:

- a) Routine maintenance items such as lubricants and filters.
- b) Normal deterioration of the exterior finish due to use or exposure.
- c) Transportation and/or labor charges.
- d) The warranty does not include commercial and/or rental use.

**No implied warranty, including any implied warranty of merchantability of fitness for a particular purpose, applies after the applicable period of express written warranty above as to the part as identified below. No other express warranty whether written or oral, except as mentioned above, given by any person or entity, including a dealer or retailer, with respect to any product, shall bind Brinly-Hardy Co. During the period of the warranty, the exclusive remedy is repair or replacement of the product as set forth above.**

**The provisions as set forth in this warranty provide the sole and exclusive remedy arising from the sale. Brinly-Hardy Co. shall not be liable for incidental or consequential loss or damage including, without limitation, expenses incurred for substitute or replacement lawn care services or for rental expenses to temporarily replace a warranted product.**

Some states do not allow the exclusion or limitation of incidental or consequential damages, or limitations on how long an implied warranty lasts, so the above exclusions or limitations may not apply to you.

During the warranty period, the exclusive remedy is replacement of the part. In no event shall recovery of any kind be greater than the amount of the purchase price of the product sold. Alteration of safety features of the product shall void this warranty. You assume the risk and liability for loss, damage, or injury to you and your property and/or to others and their property arising out of the misuse or inability to use this product.

This limited warranty shall not extend to anyone other than the original purchaser or to the person for whom it was purchased as a gift.

### **HOW STATE LAW RELATES TO THIS WARRANTY:**

This limited warranty gives you specific legal rights, and you may also have other rights which vary from state to state.

### **IMPORTANT:**

The Warranty period stated below begins with the **PROOF OF PURCHASE**. Without the proof of purchase, the Warranty period begins from the date of manufacture determined by the serial number manufacturing date.

### **WARRANTY PERIOD:**

The warranty period for the parts included in this kit are as follows: Steel Frame Parts: consumer - 2 Years, commercial - 90 days.