

# SHIMANO

## TRAX

## TRX201AHG

The (5765) Bearing, (6074) Spool clutch pin, and (4225) Roller clutch cannot be replaced by the customer. To replace these parts, please request after-sales service.

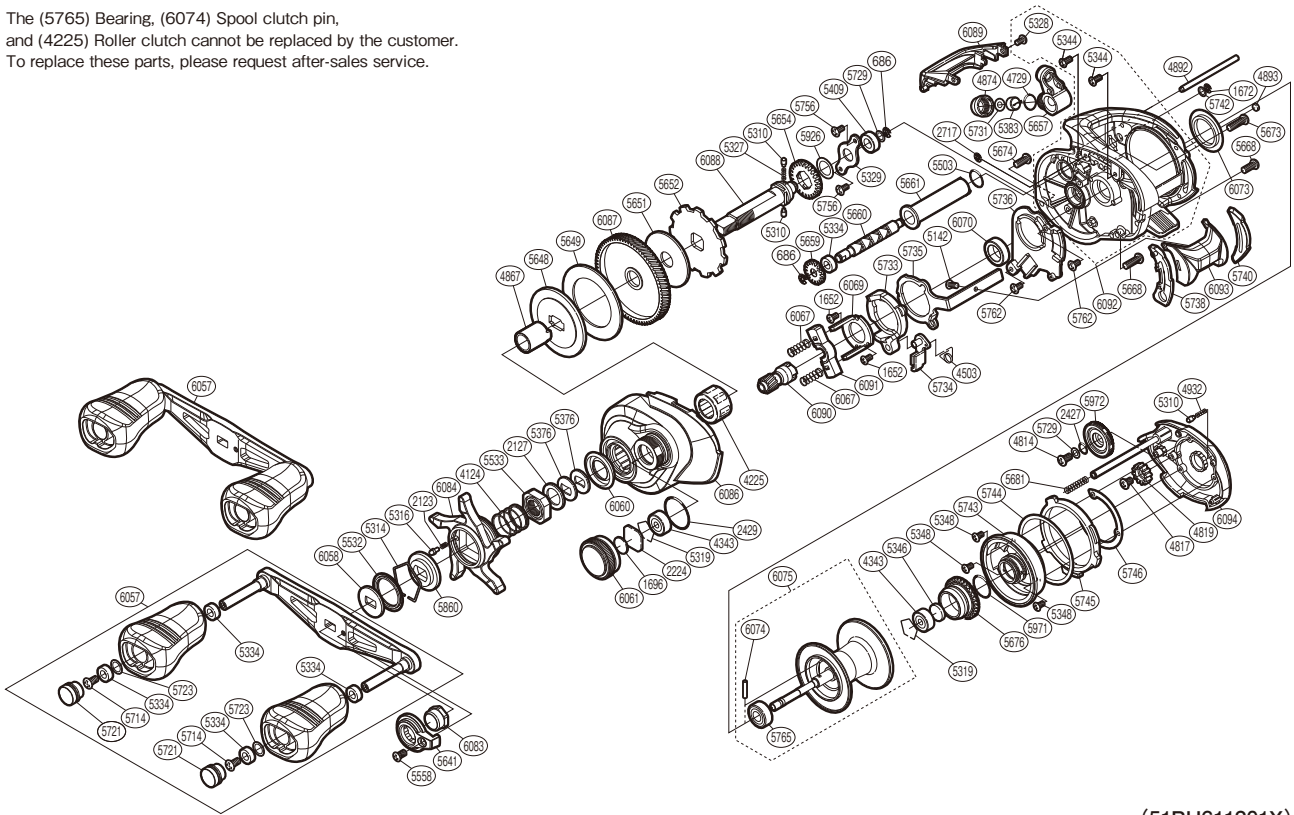

(51RH611201X)

#	Part No.	Description	#	Part No.	Description	#	Part No.	Description
686	105NK	E Lock	5376	109F5	Drag Spring Washer	5744	10042	Washer
1652	10LVE	Screw	5383	10BHQ	Line Guide Pawl	5745	10EB7	Right Side Plate Cam Lever
1672	105NC	E Lock	5409	10DQF	Drive Shaft Bushing	5746	10040	Washer
1696	10896	Cast Control Spacer B	5503	101GT	O Ring	5756	10S3Y	Screw
2123	10BT2	Click Spring	5532	10QVP	Star Drag Seal	5762	10S57	Screw
2127	10J1N	Star Drag Spacer	5533	10SRQ	Star Drag Nut	5765	105CA	Ball Bearing
2224	1085F	Spool Tension Spacer A	5558	10R1Q	Screw	5860	10J26	Star Drag Click Plate
2427	108WS	O Ring	5641	10SSK	Handle Nut Plate	5926	1023S	Washer
2429	108WK	O Ring	5648	10SSR	Key Washer	5971	100GW	O Ring
2717	105NB	E Lock	5649	10SSF	Drag Washer	5972	10263	Brake Dial
4124	10A70	Star Drag Spring	5651	1023U	Drag Washer	6057	10E8U	Handle Assembly
4225	10F3C	Roller Clutch Bearing	5652	10SSJ	Anti-Reverse Ratchet	6058	10SAW	Drive Shaft Shield
4343	105C3	Ball Bearing	5654	101K8	Idle Gear	6060	10DR	Roller Clutch Water Proof
4503	104CCQ	Clutch Pawl Spring	5657	101E0	Line Guide Assembly	6061	10T9X	Cast Control Cap
4729	108WQ	O Ring	5659	10SRL	Idle Gear	6067	10SAS	Yoke Spring
4814	103LE	Screw	5660	10ST0	Worm Shaft	6069	10DRF	Clutch Cam Retainer
4817	103L7	Screw	5661	10SSP	Level Wind Guard	6070	10DRK	Pinion Gear Bushing
4819	10CLF	Idle Gear	5668	10SXB	Screw	6073	10SAR	Frame Center Seal
4867	10CCN	Roller Clutch Inner Tube	5673	10LHY	Screw	6074	10P68	Spool Clutch Pin
4874	10FJB	Pawl Cap	5674	10SXA	Screw	6075	100ZK	Spool Assembly
4892	10QSE	Stabilizer Bar	5676	101DR	Brake Ring Gear Assembly	6083	10DRJ	Handle Nut
4893	108PY	Anti-Thrust Washer	5681	10KNH	Spring	6084	10EDS	Star Drag
4932	10GQZ	Click Spring	5714	10LFA	Screw	6086	10SFT	Left Side Plate
5142	10559	Screw	5721	1022Z	Handle Knob Seal	6087	10SJ7	Drive Gear
5310	10HJG	Idle Gear Pin	5723	1003Z	Washer	6088	10SJ8	Drive Shaft
5314	10KXW	Click Plate Retainer	5729	1003V	Spacer	6089	10SV1	Level Wind Protector
5316	10MFC	Click Pin	5731	1003S	Spacer	6090	10SJ6	Pinion Gear
5319	1054D	Bearing Retainer	5733	10EB3	Clutch Cam	6091	10RRD	Yoke
5327	10JDY	Idle Gear Spring	5734	1003W	Clutch Pawl Assembly	6092	10RED	Frame Assembly
5328	10LCQ	Screw	5735	10EBC	Clutch Plate	6093	10REF	Clutch Button Assembly
5329	109T1	Drive Shaft Retainer	5736	10EBG	Clutch Guard	6094	10REE	Right Side Plate Assembly
5334	10PXZ	Bushing	5738	10EBK	Clutch Bar Guide B			
5344	10MPD	Screw	5740	10EB4	Clutch Bar Guide A			
5346	10EX5	Spacer B	5742	10S42	Washer			
5348	10L1Q	Screw	5743	10041	Brake Case Assembly			

Please note that the number of adjusting washers may not be the same as shown in the exploded views. (Adjustment will vary with each individual product.)

(241029)\_008