

# Aimpoint®

## TwistMount™ User manual

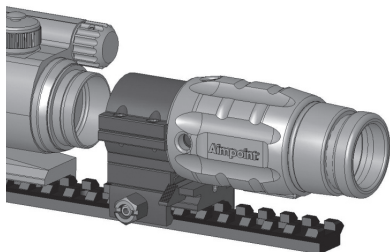

## 1 INTRODUCTION

The Aimpoint® TwistMount is a quick attach/detach mount that can be quickly removed from the optical axis. The TwistMount is designed primarily for use with Aimpoint® magnifiers but can also be used to mount other optical equipment with a 30 mm diameter tube.

The standard configuration allows for an optical axis height of 30 mm. With the optional spacer, the TwistMount can be used with sights with an optical axis height of 39 mm measured from the top surface of the Picatinny rail.

## 2 OVERVIEW

Base	1
Middle part	2
Top	3
Clamp	4
Nut	5
Locking handle	6
Shaft	7
Screw, 4 pcs (Note: Inch thread)	8
Hex key (Note: Inch size)	9

OPTIONAL (not shown): spacer incl. long screws for 39 mm optical axis height

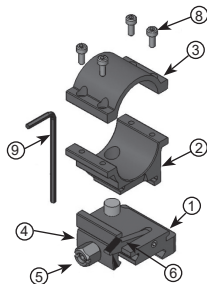

## 3 TECHNICAL SPECIFICATION

Weight	110 g (3.8 oz)
Total height	48 mm (1.9") over rail, 56.5 mm (2.2") with optional spacer
Height of "optical axis"	30 mm (1.2") over rail 39 mm (1.5") with optional spacer
Length	40 mm (1.6")
Width	48 mm (1.9")

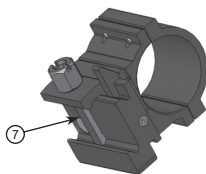

## 4 MOUNTING

**WARNING:** Ensure the weapon is unloaded and the safety selector is in the “safe” position before attempting to install, remove or perform maintenance.

### Preparations:

Select a groove in the Picatinny rail. Ensure the groove to be used is clean and free from dirt. Ensure there is clearance between the ocular end of the sight and the objective (front) of the optic to prevent interference during rotation of the TwistMount (when attaching / detaching).

The TwistMount base should be positioned for a magnifier or other optic to be mounted with proper eye relief. See manufacturer’s instruction for recommended eye relief.

### Mounting instruction:

1. Install the TwistMount base on the rail. Ensure that the shaft (=recoil stop) (7) is in the selected groove. The clamp (4) and the nut (5) should be on the left hand side of the receiver when viewed from the rear.
2. Hand-tighten the nut and then tighten with an appropriate tool an additional 1/8–1/4 turn. Do not over tighten. Check the nut after a few rounds and retighten with the same torque if necessary.
3. Remove the four screws (8) using the supplied hex key (9). If using the optional spacer, place it in the bottom half of the TwistMount ring, and replace the short screws with the long ones included with the spacer. Install the optic and the top half of the TwistMount with the appropriate screws. Before tightening the screws, align the optic according to the manufacturer’s instructions. Tighten the screws in a crosswise pattern.

## 5 OPERATION

### To detach the TwistMount™:

1. Press and hold down the locking handle (6).
2. Grab and turn the TwistMount ring and the attached optic 45° counterclockwise (seen from the top).
3. Lift the TwistMount ring and the attached optic upwards and remove it from the base (1).

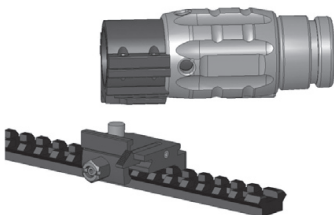

**To attach the TwistMount™:** perform above procedure in reverse order.

### Aimpoint AB

Jägershillgatan 15  
SE- 213 75 Malmö, Sweden  
Phone: +46 (0)40 671 50 20  
Fax: +46 (0)40 21 92 38  
e-mail: info@aimpoint.se

### Aimpoint Inc.

7309 Gateway Court  
Manassas, VA 20109, USA  
Phone: +1 703-263-9795  
Fax: +1 703-263-9463  
e-mail: info@aimpoint.com

**WWW.AIMPOINT.COM**

© 2005, 2017 Aimpoint AB. [11368-2]

