

Model: 424 Mesh Back Guest Chair

Parts Listing

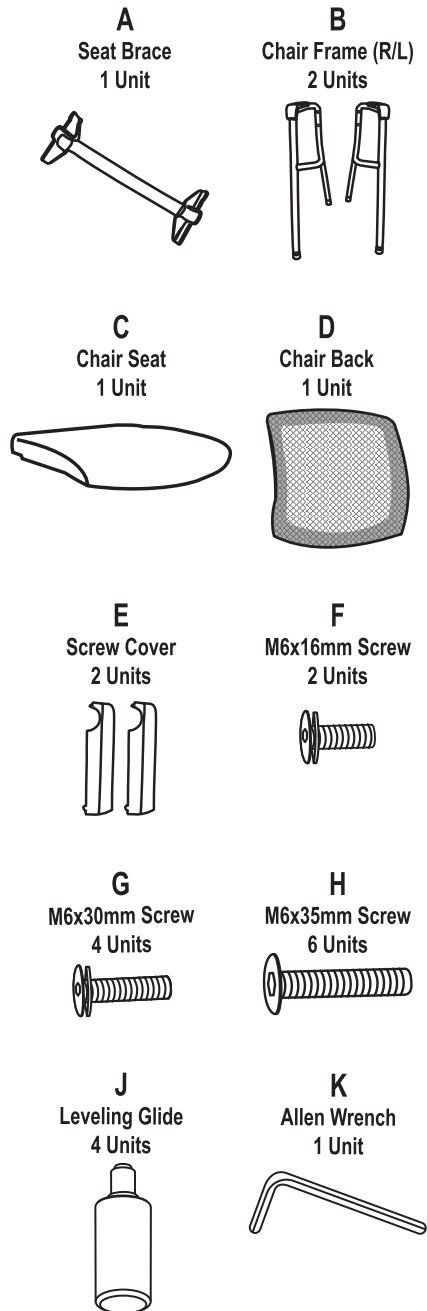

Assembly Instructions

Tools Needed: Allen Wrench - Included

Please read all instructions before assembly.

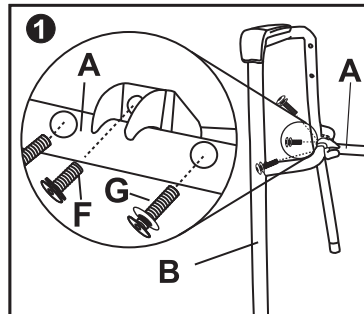
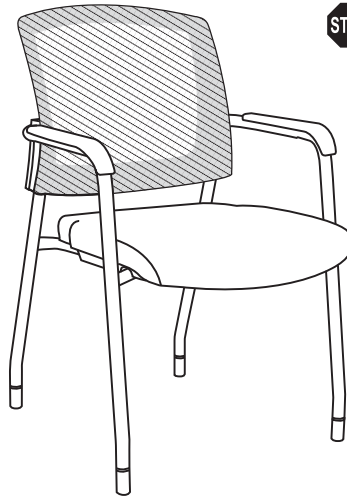

Step 1: Stand Chair Frame (B) up while aligning Seat Brace (A) with the holes in the Chair Frame (B). Insert M6x16mm Screw (F) into the center bracket attached to the Chair Frame (B) then into the corresponding center hole in Seat Brace (A) and secure using Allen Wrench (K). Insert 2 M6x30mm Screws (G) in remaining holes to secure and tighten loosely with Allen Wrench (K). They will be tightened when all screws are in place. **Repeat this for the other side.**

Step 2: Working from behind the chair, attach Chair Back (D) to Chair Frame (B) by placing the channel in the Chair Back (D) over the Chair Frame (B) and lining up the holes. If aligning is difficult, try loosening the screws in the Seat Brace (A) slightly. Secure using 4 M6x35mm Screws (H) that go through the Chair Frame (B) and into Chair Back (D). Tighten all screws including screws in Seat Brace (A) at this time using Allen Wrench (K) because once step 3 is done, screws cannot be tightened without removing Chair Seat (C).

Step 3: Position chair so that the back is facing you. Now lay it down so that the top of the Chair Back (D) and the arms of the Chair Frame (B) are lying on a smooth clean surface. Take the Chair Seat (C) and slide it under the Seat Brace (A) and Chair Frame (B) and lift it up so that the channel in the bottom of the Chair Seat (C) fits over the Seat Brace (A) and Chair Frame (B). While holding the Chair Seat (C) in place, insert 2 M6x35mm Screws (H) through the Chair Frame (B) and into the bottom of the Chair Seat (C). Tighten using Allen Wrench (K).

Step 4: Stand Chair up with the back facing you. Attach Screw Covers (E) over Chair Frame (B) screws by lining up the Screw Covers (E) with the shape of the channel in the Chair Back (D) and pressing in on them until they snap into place.

Step 5: To attach Leveling Glides (J), position chair so that the back is facing you. Lay it down so that the top of the Chair Back (D) and the arms of the Chair Frame (B) are lying on a smooth clean surface. Insert glides into bottom of legs by pushing down into holes until they stop. To detach, pull up on glides until they are removed. Follow this same process to install and remove optional casters.

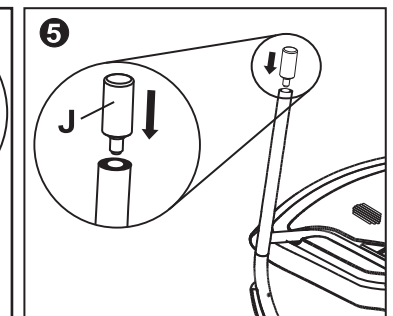
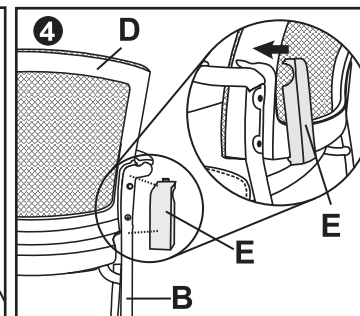
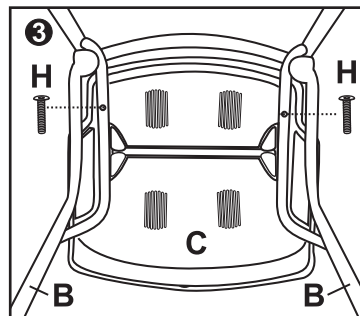
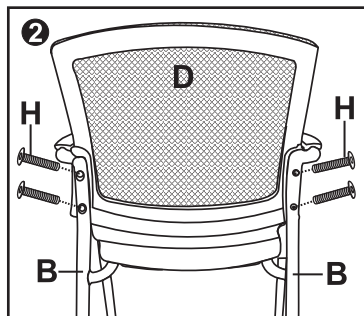

WEIGHT CAPACITY: 225 lbs.

Assembly Notes:

During assembly, hand tighten screws only. When all screws are in place, you may then tighten all screws completely.

CAUTION:

1. Do not use this chair as a step ladder.
2. Check for loose screws and tighten them every 6 months.

ofm
Furniture For The Real Office™

161 Tradition Trail, Holly Springs, NC, 27540
800-520-7471 (voice) • 919-362-4765 (fax)
919-303-6389 (voice) • www.ofminc.com
support@ofminc.com