

INSTRUCTIONS FOR MODELS

RPG05-106848 MOUNTING HARDWARE

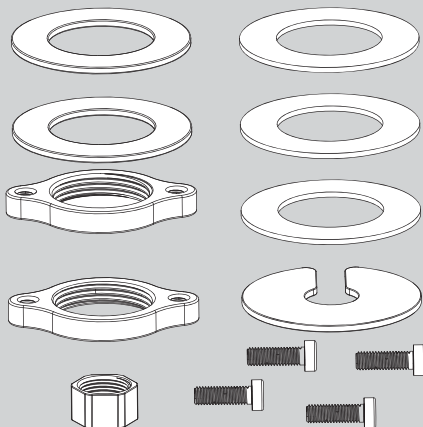

NEED HELP?

For additional assistance or service please contact:

SPEAKMAN® Company
400 Anchor Mill Road
New Castle, DE 19720

800-537-2107

customerservice@speakman.com

www.speakman.com

92-RPG05-106848-01

TOOLS AND SUPPLIES

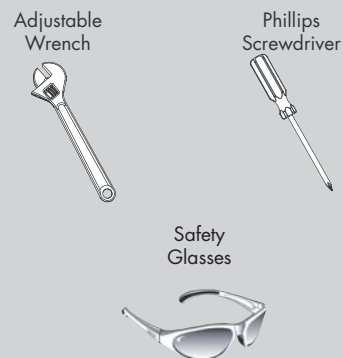

IMPORTANT



- Do not over-tighten any connections or damage may occur.
- Be sure to read instructions thoroughly before beginning installation.
- This faucet has an operating range of 20-80 psi.

SAFETY TIPS



Cover your drain to prevent loss of parts. Be sure to wear eye protection while cutting pipe.

MAINTENANCE



Your new Speakman Product is designed for years of trouble-free performance. Keep it looking new by cleaning it periodically with a soft cloth. The use of harsh chemicals and abrasives on any of the Speakman custom finish products may damage the finish and void the product warranty. Please be sure to only use approved cleaners. Please contact Speakman for any clarification of acceptable cleaners.

WARRANTY



Additional warranty information can be found at:
www.speakman.com

1

Identify which component (Metal Washer (2), Rubber Washer (1), or Nut (3)) needs to be replaced on Spout and/or End body threaded shanks located under countertop.

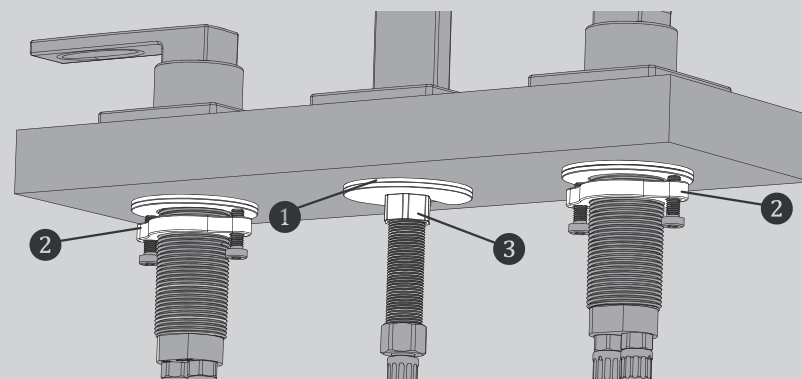
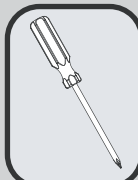

2

Remove all existing components and configure new components accordingly.

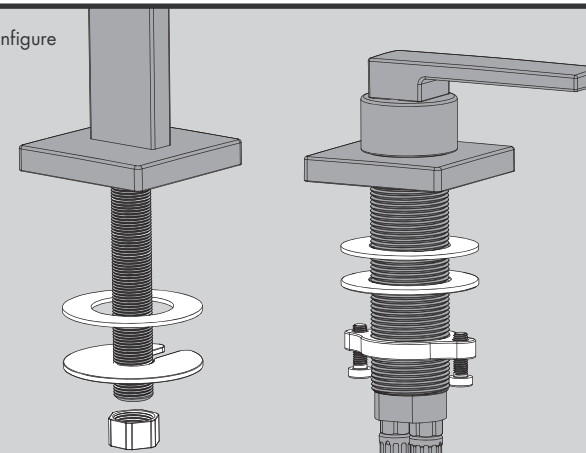

3

Confirm handle & spout deck flanges are aligned properly. Tighten Nut (1) to secure spout. Tighten Screws (2) to secure handles.

