

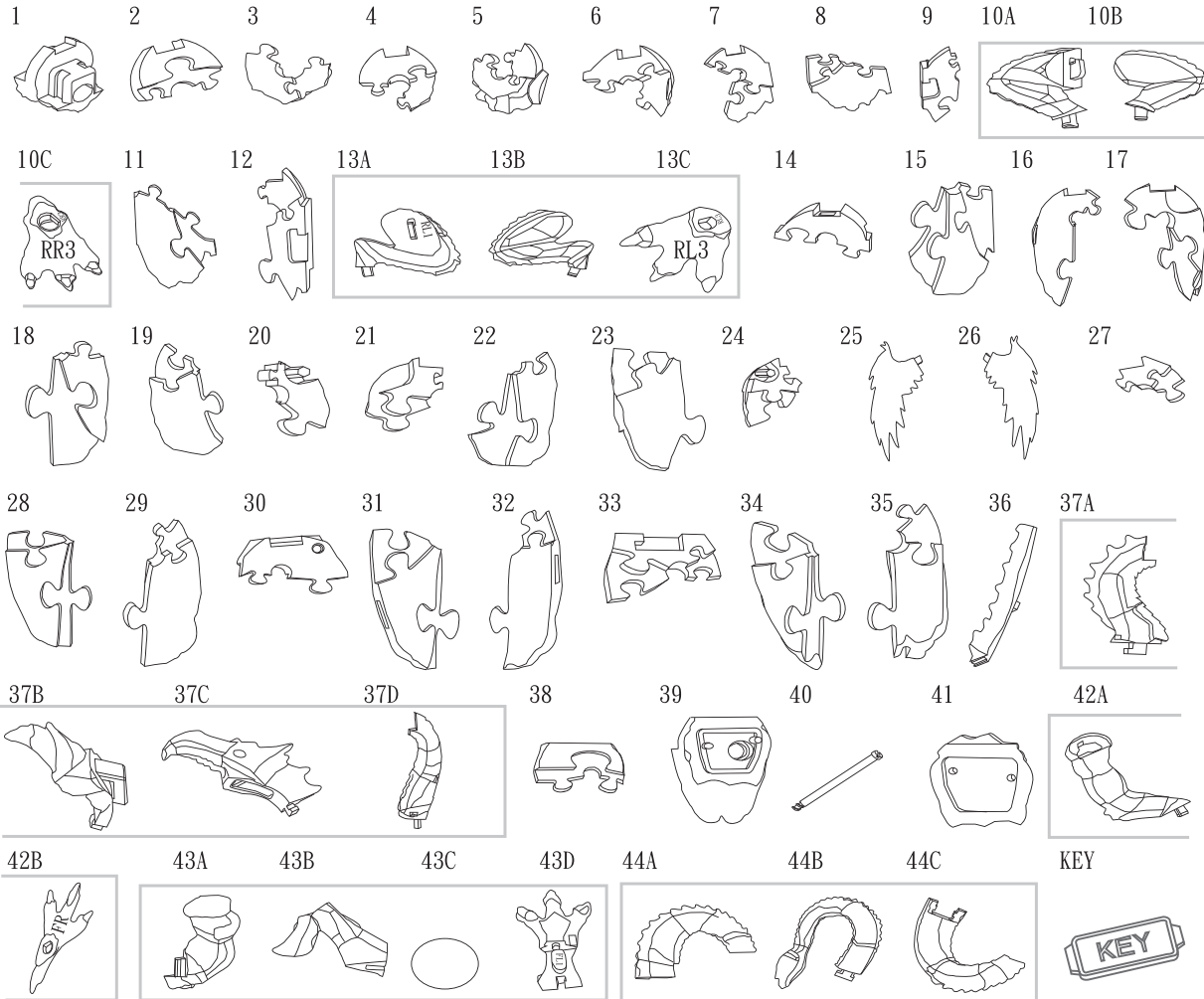

INSTRUCTIONS

1. Please count and make sure all pieces are present before assembly.
2. The pole pieces are delicate. To prevent damage, do not use excessive force.
3. Assemble crystal puzzle by putting the puzzle pieces together in the order shown below.
4. Missing a piece? Email [info@ugames.com](mailto:info@ugames.com) or call (415) 503-1600 with missing piece number.



HINTS

**1**

Face outside  
Point towards front  
Face inside  
Point towards front

Make sure wings are pointed in the correct direction, as indicated above.

**2**

10ABC  
37ABCD  
42AB  
13ABC  
43ABCD  
44ABC

Combine the head, neck, tail and legs before mounting pieces onto the body.

**3**

RR3  
RL3  
FR

Note the markings on the three legs distinguishing front, rear, left and right.

**4**

After assembling piece #39, insert center pole #40 through the front and screw it down with the screw included with the key.

