



## ISLAND KING LARGE FLAME TORCH

# INSTRUCTION AND USE MANUAL

### Safety information

### ⚠ DANGER



<p><b>TORCH FUEL IS HARMFUL OR FATAL IF SWALLOWED. CONTAINS PETROLEUM HYDROCARBONS. COMBUSTIBLE. READ WARNINGS ON TORCH FUEL BOTTLE CAREFULLY.</b></p>	<p><b>DO NOT USE GASOLINE OR OTHER FLAMMABLE FUEL. USE ONLY TIKI® BRAND TORCH FUEL.</b></p>
<p><b>READ AND UNDERSTAND THESE INSTRUCTIONS BEFORE USE.</b></p>	<p><b>HOT WHILE IN USE.</b></p>
<p><b>FAILURE TO FOLLOW WARNINGS AND INSTRUCTIONS MAY RESULT IN SERIOUS INJURY OR PROPERTY DAMAGE.</b></p>	<p><b>KEEP CLOTHING, HAIR, AND FACE AWAY FROM FLAME.</b></p>
<p><b>FOR OUTDOOR USE ONLY.</b></p>	<p><b>DO NOT LEAVE A BURNING TORCH UNATTENDED.</b></p>
<p><b>DO NOT PLACE TORCH UNDER COVERED SHELTER OR UMBRELLA, NEAR PEDESTRIAN TRAFFIC, OR NEAR COMBUSTIBLES SUCH AS WOOD STRUCTURES, FUEL, CLOTHING, OR DRY VEGETATION.</b></p>	<p><b>DO NOT MOVE THE TORCH WHILE IT IS BURNING.</b></p>
<p><b>INSERT POLE INTO THE GROUND AT A MINIMUM DEPTH OF 6 INCHES UNTIL SECURE.</b></p>	<p><b>DO NOT TIP TORCH, AS FUEL CAN SPILL AND CAUSE FIRE OR SERIOUS INJURY.</b></p>
<p><b>KEEP OUT OF REACH OF CHILDREN AND PETS.</b></p>	<p><b>DO NOT ATTEMPT TO REFILL A BURNING TORCH. SNUFF THE FLAME AND WAIT 30 MINUTES FOR THE TORCH TO COOL.</b></p>
<p><b>USE ONLY IN A WELL-VENTILATED AREA.</b></p>	<p><b>DO NOT BLOW OUT THE FLAME.</b></p>
<p><b>DO NOT USE WHILE UNDER THE INFLUENCE OF DRUGS OR ALCOHOL.</b></p>	

**RETAIN THESE INSTRUCTIONS FOR FUTURE USE.**

©2020 LAMPLIGHT FARMS INC.

TIKI® and ISLAND KING® are trademarks of Lamplight Farms Inc.  
W140 N4900 Lilly Rd., Menomonee Falls, WI 53051 • [www.tikibrand.com](http://www.tikibrand.com)

# Package Contents

- A Vessel
- B Pole Sections (4)
- C Snuffer

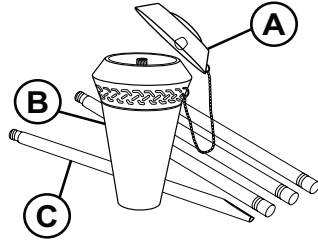

## 1 ASSEMBLING THE TORCH

The Top pole section has a chain. The Bottom pole section has the angled end and, if included, a hinged step. (Fig. 1)

1. Screw the pole sections together for the height you want. (Fig. 2)

Torch Height	Pole Sections
Full Size	4
Garden	3

2. Add the torch head to the assembled pole. (Fig. 3)
3. Position the assembled torch before you fill the torch head with fuel. Flip the step down into position, if included.
4. Insert the pole into the ground.
5. Press the pole into the ground at least 6 inches or until the step is against the ground. (Fig. 4)

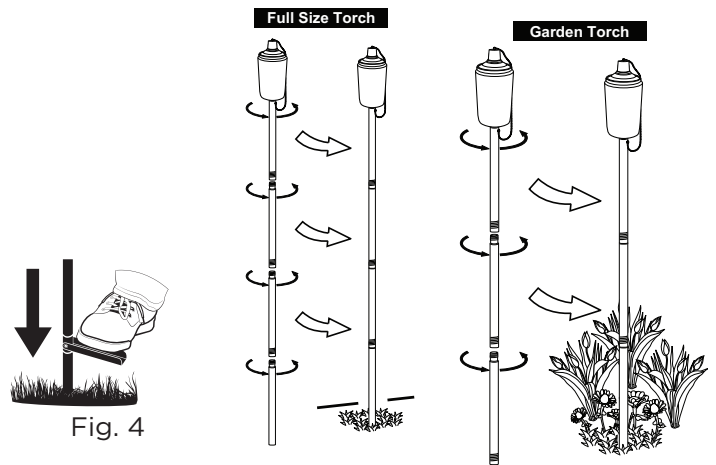
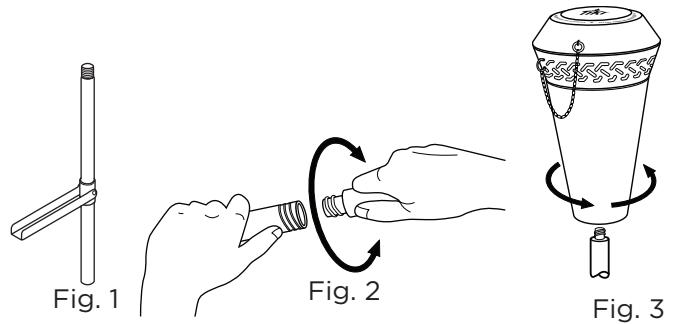

## 2 FILLING AND LIGHTING THE TORCH

1. Unscrew the torch head from the pole.
2. Remove the magnetic snuffer.
3. Hold the base of the torch head with one hand and rotate the flameguard to open the fuel filler opening. (Fig. 5).

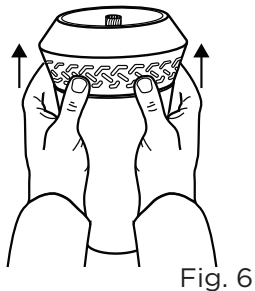
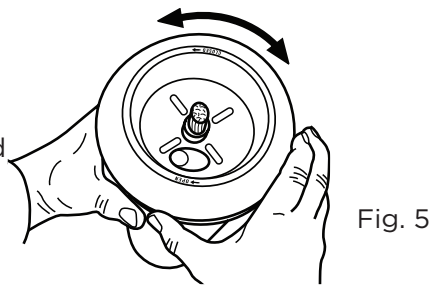

Fig. 6

**NOTE:** After the first time the torch is used, soot might prevent the flameguard from rotating. Hold the flameguard as shown in Fig. 6 and push up gently. Then rotate the flameguard.

4. Fill the torch head with TIKI® Brand Torch Fuel to the level indicator. DO NOT OVERFILL. (Fig. 7)
5. Adjust the wick to expose a maximum of 1/2 in. (13 mm). (Fig. 8)

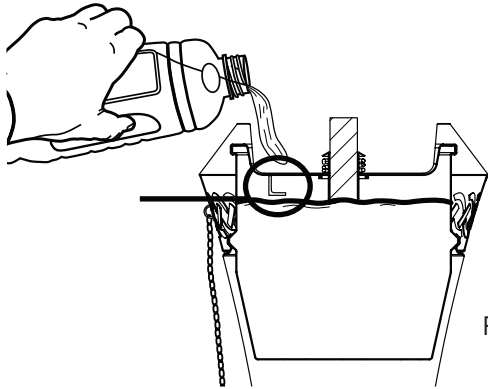

Fig. 7

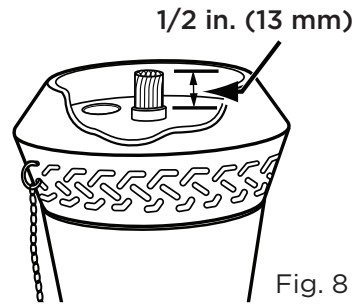

Fig. 8

6. Hold the base of the torch head and rotate the flameguard to close the fuel filter opening.
7. Wipe away any spilled fuel before lighting.
8. Allow the wick to become saturated with fuel.
9. Use a long lighter or long fireplace match to light the torch.

### 3 EXTINGUISHING THE TORCH

1. Place the snuffer over the wick. When the flame is extinguished, remove the snuffer. (Fig. 9)
2. Allow the torch to cool for 30 minutes.
3. Place the snuffer over the wick to protect it from moisture.

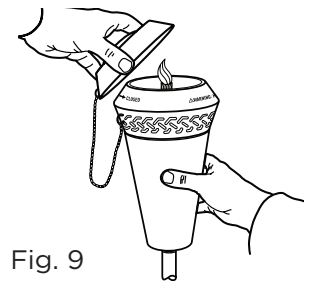

Fig. 9

If fuel becomes contaminated with water or the wick gets wet with water, you must replace the wick or fuel. Dispose of the contaminated fuel and wick in accordance with local laws and regulations.

### 4 STORING TORCHES

1. Store fuel in original bottle with cap secured.
2. For each torch, check that the snuffer is in place. If the torch has a child-resistant cap, verify that it is tight.
3. Verify that the fuel filling opening is closed.
4. Store torches upright in a dry location, away from weather conditions.



Questions, problems, missing parts? Call Customer Service:  
1-888-473-1088

[TIKIBRAND.COM](http://TIKIBRAND.COM)