

ORDER BY PART NUMBER

ILLUSTRATED PARTS

503

16" Reach Wall Mount Shower Arm

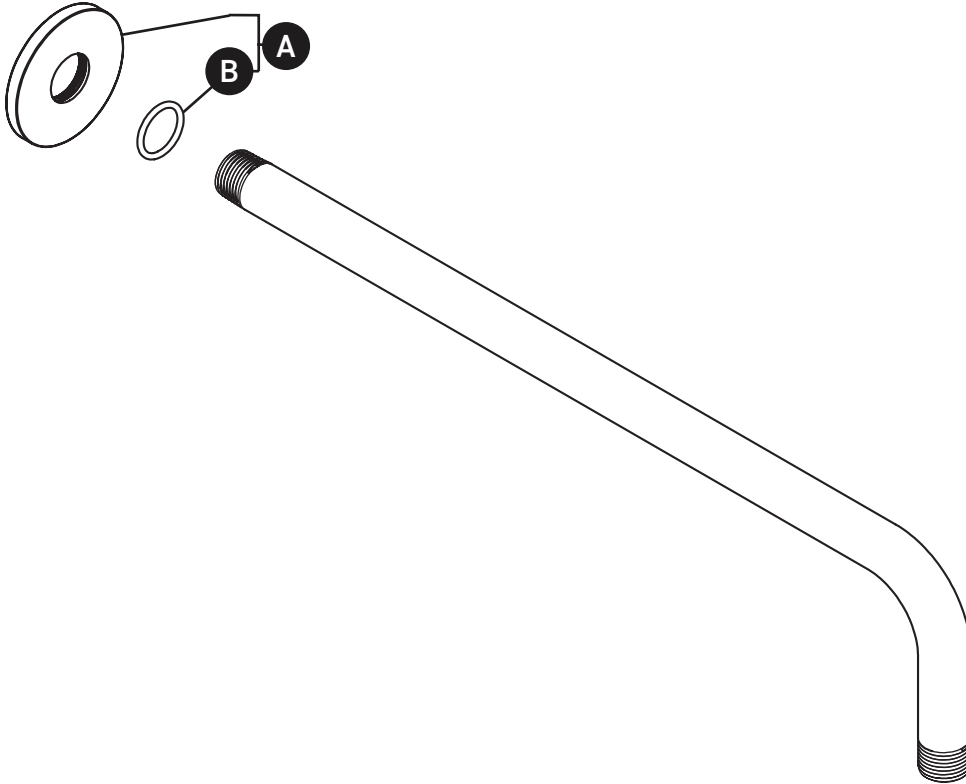

ID	Kit Number	Finish
A*	2402	See below
B	225-200	N/A

*Finish Determined by Suffix	
<u>Finish</u>	<u>Description</u>
C	Chrome
BG	Brushed Gold
BK	Black
BN	Brushed Nickel
PN	Polished Nickel

For warranty or additional information, contact:

U.S.A.
houseofrohl.com/support
1-800-777-9762

QUEBEC / MARITIMES / WESTERN CANADA
QUÉBEC / MARITIMES / OUEST CANADIEN
QUEBEC / MARITIMOS / CANADA OCCIDENTAL
houseofrohl.ca/support
1-866-473-8442

ONTARIO
houseofrohl.ca/support
1-800-287-5354

VEUILLEZ EFFECTUER VOTRE COMMANDE
PAR NO DE RÉFÉRENCE

ILLUSTRATIONS DES PIÈCES

503

Bras de douche mural de 40 cm (16")

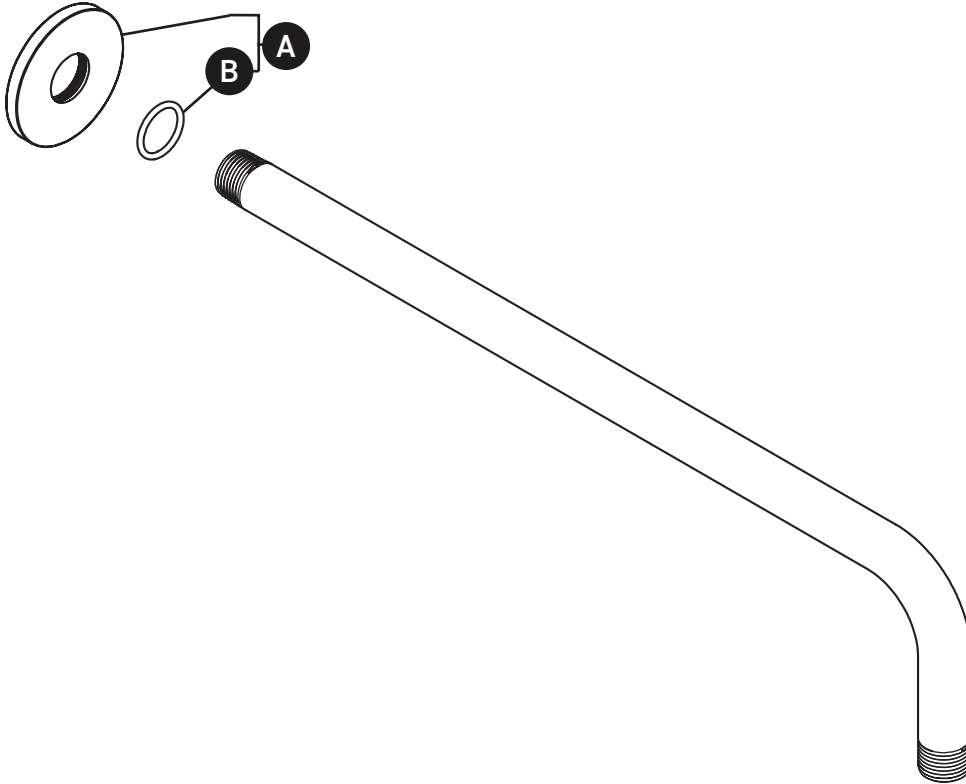

ID	Référence du kit	Finition
A*	2402	Voir ci-dessous
B	225-200	N/A

*Finition déterminée par le Suffixe	
Finition	Description
C	Chrome
BG	Or brossé
BK	Noir
BN	Nickel brossé
PN	Nickel poli

For warranty or additional information, contact:

U.S.A.
houseofrohl.com/support
1-800-777-9762

QUEBEC / MARITIMES / WESTERN CANADA
QUÉBEC / MARITIMES / OUEST CANADIEN
QUEBEC / MARITIMOS / CANADA OCCIDENTAL
houseofrohl.ca/support
1-866-473-8442

ONTARIO
houseofrohl.ca/support
1-800-287-5354

PEDIR POR NÚMERO DE REFERENCIA

PIEZAS ILUSTRADAS

503

Brazo de ducha de montaje en pared de 16" de alcance

ID	Referencia del kit	Acabado
A*	2402	Ver más abajo
B	225-200	N/A

*Acabado determinado por el sufijo	
<u>Acabado</u>	<u>Descripción</u>
C	Cromo
BG	Oro cepillado
BK	Negro
BN	Níquel pulido
PN	Níquel pulido

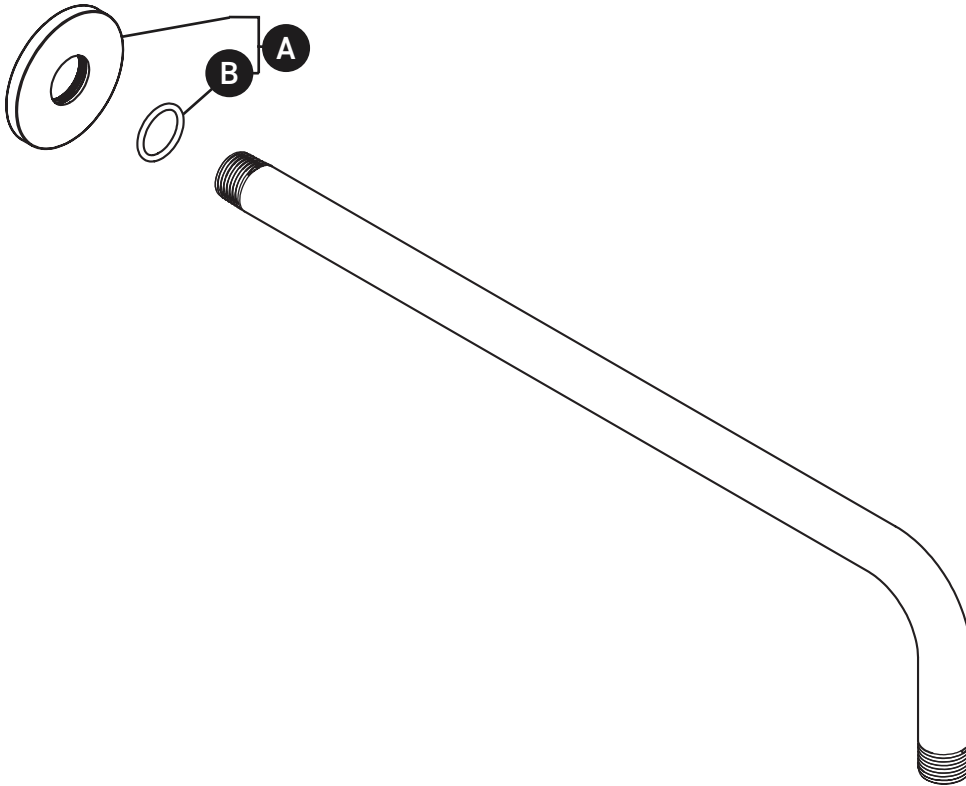

For warranty or additional information, contact:

U.S.A.
houseofrohl.com/support
1-800-777-9762

QUEBEC / MARITIMES / WESTERN CANADA
QUÉBEC / MARITIMES / OUEST CANADIEN
QUEBEC / MARITIMOS / CANADA OCCIDENTAL
houseofrohl.ca/support
1-866-473-8442

ONTARIO
houseofrohl.ca/support
1-800-287-5354