

# DECORATIVE WALL LIGHT

---

## IMPORTANT SAFETY INSTRUCTIONS AND INSTALLATION GUIDE

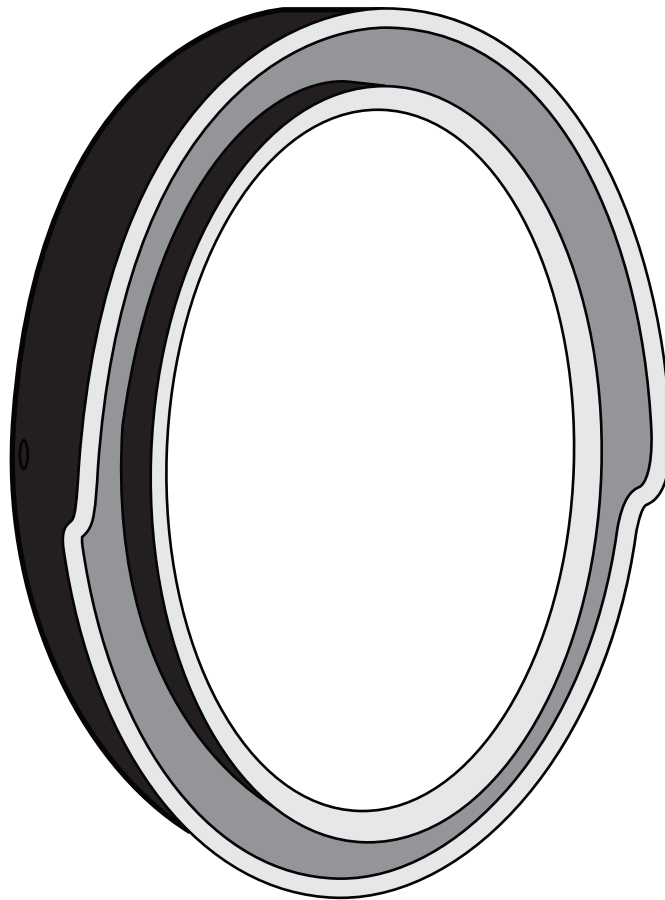

**READ BEFORE INSTALLATION**  
**SAVE THESE INSTRUCTIONS**



# Table of Contents

Table of Contents .....	2
Safety Information .....	2
Warranty .....	2
Pre-Installation .....	3
Tools Required .....	3
Hardware Included .....	3
Installation .....	4
Operation .....	5
Troubleshooting .....	5

## Safety Information

For your safety, please observe the following precautions:

- ❑ Turn off the power supply at the fuse or circuit breaker box before you install the fixture.
- ❑ Ground the fixture to avoid potential electric shock and to ensure reliable starting.
- ❑ Double-check all connections to be sure they are tight and correct.
- ❑ Wear rubber soled shoes and work on a sturdy wooden ladder.
- ❑ Account for small parts and destroy packing material, as these may be hazardous to children.

This fixture is designed for use in a circuit protected by a fuse or circuit breaker. It is also designed to be installed in accordance with local electrical codes. If you are unsure about your wiring, consult a qualified electrician or local electrical inspector, and check your local electrical code.

Account for small parts and destroy packing material, as these may be hazardous to children.

**NOTICE:** All electrical connections must be in accordance with local and National Electrical Code (N.E.C.) standards. If you are unfamiliar with proper electrical wiring connections obtain the services of a qualified electrician.  
Remove the fixture and the mounting package from the box and make sure that no parts are missing by referencing the illustrations on the installation instructions.

### Product Specifications

- 120VAC, 60Hz, 17W
- Suitable for wet locations



**WARNING: RISK OF SHOCK.** House electric current can cause painful shock or serious injury unless handled properly.



**CAUTION:** Turn off the main power at the circuit breaker before installing the fixture, in order to prevent possible shock.



**WARNING:** Changes or modifications to this unit not expressly approved by the party responsible for compliance could void the user's authority to operate the equipment.



**WARNING: RISK OF CUTS.** Some metal parts in the fixture may have sharp edges. To prevent cuts and scrapes, wear gloves when handling the parts.

### Dusk to Dawn Operation:

The light will turn on at dusk and remain on through the night until dawn. The light will remain off throughout the day, until dusk.

## FCC STATEMENT

### Supplier's Declaration of Conformity:

47 CFR § 2.1077 Compliance Information

**Responsible Party:** Feit Electric Company

4901 Gregg Road, Pico Rivera, CA 90660, USA

www.feit.com

**Unique Identifier:** S100WM/5CCT/DD/BZ

This device complies with part 15 of the FCC Rules. Operation is subject to the following two conditions: (1) This device may not cause harmful interference, and (2) this device must accept any interference received, including interference that may cause undesired operation. Note: This equipment has been tested and found to comply with the limits for a Class B digital device, pursuant to part 15 of the FCC Rules. These limits are designed to provide reasonable protection against harmful interference in a residential installation. This equipment generates, uses and can radiate radio frequency energy and, if not installed and used in accordance with the instructions, may cause harmful interference to radio communications. However, there is no guarantee that interference will not occur in a particular installation. If this equipment does cause harmful interference to radio or television reception, which can be determined by turning the equipment off and on, the user is encouraged to try to correct the interference by one or more of the following measures: Reorient or relocate the receiving antenna. Increase the separation between the equipment and receiver. Connect the equipment into an outlet on a circuit different from that to which the receiver is connected. Consult the dealer or an experienced radio/TV technician for help. Any changes or modifications not expressly approved by the manufacturer could void the user's authority to operate the equipment.

## Limited Warranty

This product is warrantied to be free from defects in workmanship and materials for up to 3 years from date of purchase. If the product fails within the warranty period, please contact Feit Electric at info@feit.com, visit [feit.com/contact-us](http://feit.com/contact-us) for instructions on replacement or refund. REPLACEMENT OR REFUND IS YOUR SOLE REMEDY. EXCEPT TO THE EXTENT PROHIBITED BY APPLICABLE LAW, ANY IMPLIED WARRANTIES ARE LIMITED IN DURATION TO THE DURATION OF THIS WARRANTY. LIABILITY FOR INCIDENTAL OR CONSEQUENTIAL DAMAGES IS HEREBY EXPRESSLY EXCLUDED. Some states and provinces do not allow the exclusion of incidental or consequential damages, so the above limitation or exclusion may not apply to you. This warranty gives you specific legal rights, and you may also have other rights which vary from state to state or province to province.

TOOLS REQUIRED (NOT INCLUDED)

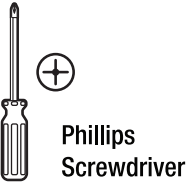

HARDWARE INCLUDED



NOTE: Hardware not shown to actual size.

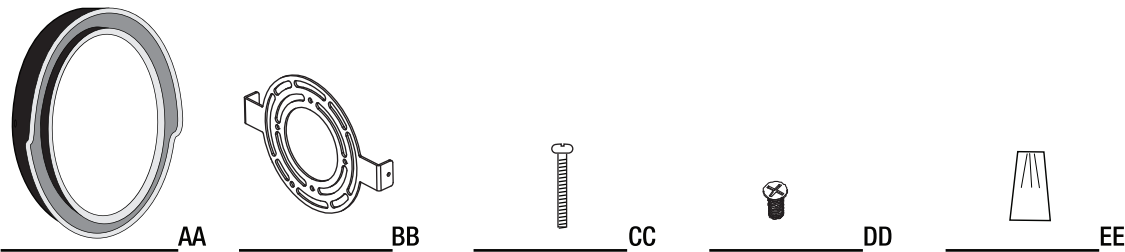

Part	Description	Quantity
AA	Fixture	1
BB	Mounting Plate	1
CC	J-Box Mounting Screws (8-32 x 1")	2
DD	Fixture Mounting Screws (4-40 x 0.75")	2
EE	Wire Nuts	3

## 1 Turning off the Power

- Turn the power OFF at the switch and fusebox or the circuit breaker.

## 2 Installing the Mounting Plate

- Feed the J-Box supply wire through the center hole of Mounting Plate (BB) and secure onto the J-Box using the two J-Box Mounting Screws (CC).

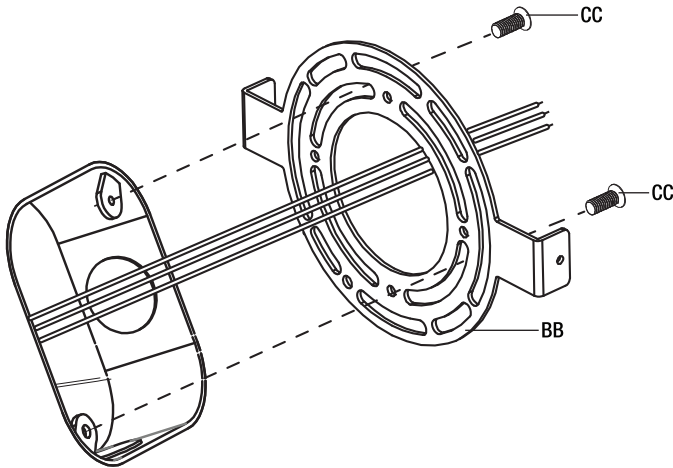

## 3 Connecting the Wires

- Use the Wire Nuts (EE) to connect the green grounding wire from the Fixture (AA) to the house ground, the Fixture (AA) white wire to the neutral house wire and the Fixture (AA) black wire to the black power supply wire.

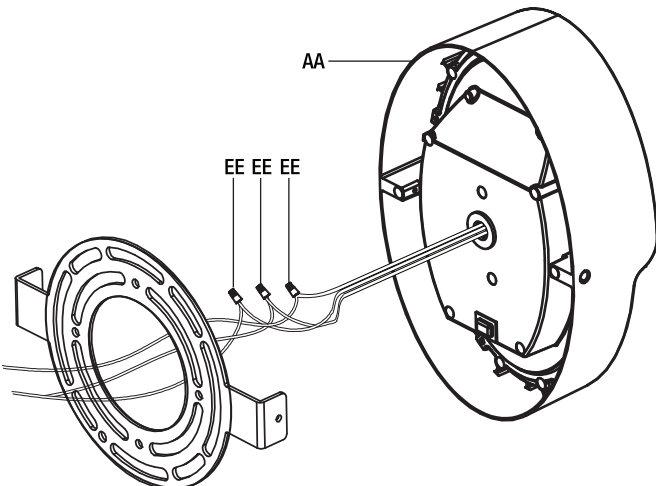

## 4 Choosing your Shade of White

- Before installing the Fixture (AA), use the switch on the back of the Fixture (AA) to select the desired color temperature.

- 3K – 3000K (Soft white)
- 35K – 3500K (Neutral white)
- 4K – 4000K (Bright white)
- 5K – 5000K (Daylight)
- 65K – 6500K (Daylight deluxe)

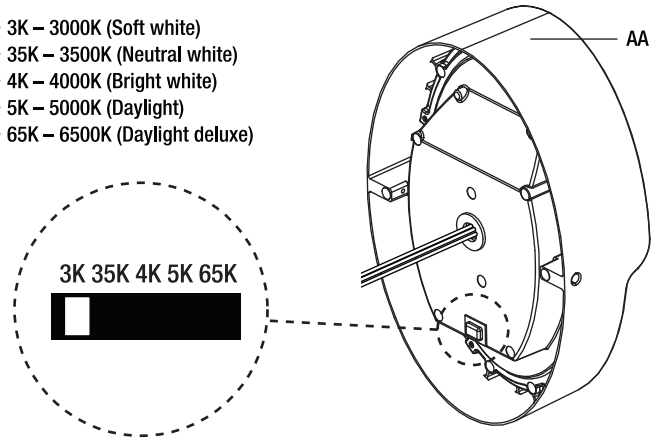

## 5 Installing the Fixture

- Align the Fixture (AA) side holes to the Mounting Plate (BB) side holes.
- Tighten the Fixture Mounting Screws (DD) to secure the Fixture (AA) to the Mounting Plate (BB).

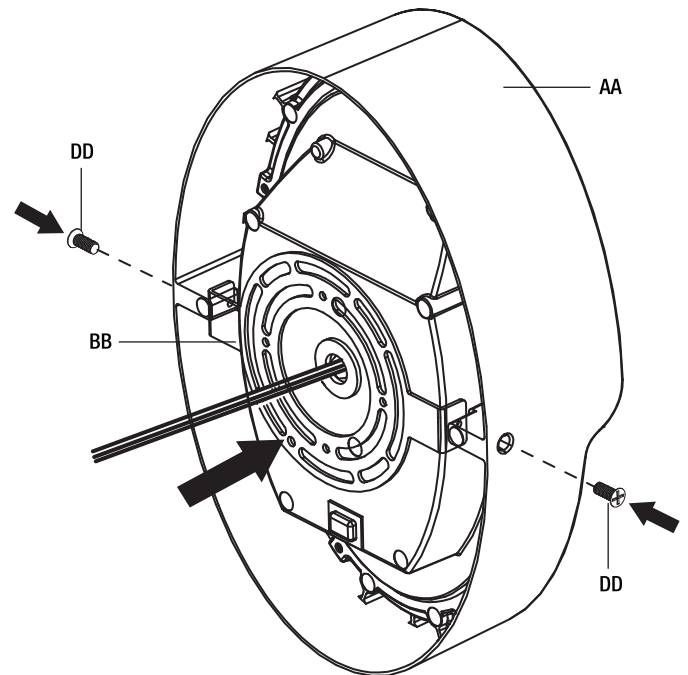

## 6 Apply Sealant (not included)

- Once the fixture is tightly secured to the wall, apply silicone sealant around the base of the fixture to prevent moisture from reaching the connections.

## 7 Turning the Power On

- Turn the power ON at the wall switch, fusebox or the circuit breaker.

Dusk to Dawn Operation

- The light will turn on at dusk.
- The light will remain on through the night until dawn.
- At dawn, the light will turn off.



**NOTE:** To make sure this function works properly, always keep the wall switch in the “ON” position.

Changing Color Settings

Use the switch on the back of the Fixture (AA) to select the desired color temperature.

- 3K – 3000K (Soft white)
- 35K – 3500K (Neutral white)
- 4K – 4000K (Bright white)
- 5K – 5000K (Daylight)
- 65K – 6500K (Daylight deluxe)

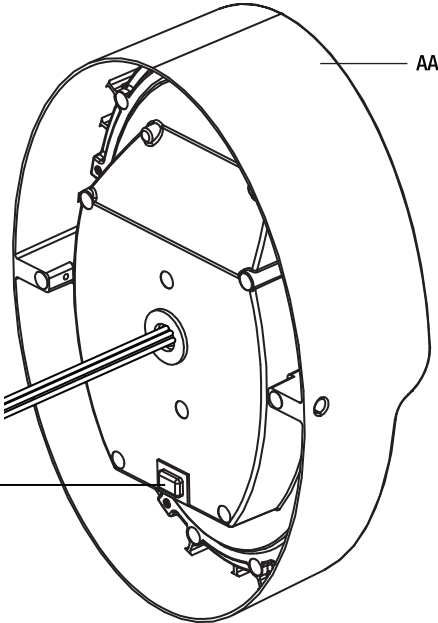

Troubleshooting

Problem	Possible Cause	Solution
The light will not illuminate.	The power is off.	Make sure the power supply is on.
	There is a faulty wire connection.	Check the wiring. Contact a qualified and licensed electrician if you are not comfortable troubleshooting wiring problems.
	There is a faulty wire switch.	Test or replace the switch.
The light does not automatically turn off during daylight hours.	The fixture’s front lens is covered. (This fixture is provided with an internal photocell located behind the lens).	Remove any debris and clean the fixture’s lens.
	The fixture is in a dark or shaded area.	Allow the fixture’s lens to receive direct sunlight.